

49575 BCY Dance Along Blue - instruction sheet
Color: Black
Size: A4 (double sided print)
Date: Jan. 10, 2020 (TN)
R2: added highlight on Blue's eyes
R3: updated music legal, Mar 05 2020

CAUTION : Changes or modification, not expressly approved by the party responsible for compliance could void the user's ability to operate the equipment.

Note: This equipment has been tested and found to comply with the limits for a Class B digital device, pursuant to Part 15 of the FCC Rules. These limits are designed to provide reasonable protection against harmful interference in a residential installation. This equipment generates, uses, and can radiate radio frequency energy and, if not installed and used in accordance with the instructions, may cause harmful interference to radio communications. However, there is no guarantee that interference will not occur in a particular installation. If this equipment does not cause harmful interference to radio or television reception, which can be determined by turning the equipment off and on, the user is encouraged to try to correct the interference by one or more of the following measures:

Reorient or relocate the receiving antenna.
Increase the separation between the equipment and receiver.
Connect the equipment into an outlet on a circuit different from that to which the receiver is connected.
Consult the dealer or an experience radio/TV technician for help.

This device complies with part 15 of the FCC Rules. Operation is subject to the following two conditions:
(1) This device may not cause harmful interference, and
(2) This device must accept any interference received, including interference that may cause undesired operation.

Composition: "Blue's Clues & You Theme"
Writer: Peter Zizzo
©2018 Music By Nickelodeon, Inc. BMI
Used by permission of Sony/ATV Music Publishing LLC,
424 Church Street, Suite 1200, Nashville, TN 37219
All rights reserved.



©Nickelodeon
Nickelodeon.com
JUST PLAY LOGO
©2020 JUST PLAY, LLC.
4850 T-REX AVE, SUITE 100
BOCA RATON, FL 33431, USA

© 2020 Viacom International Inc. All Rights Reserved. Nickelodeon, Blue's Clues & You!, and all related titles, logos, and characters are trademarks of Viacom International Inc.

In the interest of better quality and value, we are constantly improving and updating our products. Consequently, pictures on this package may sometimes vary from the product enclosed.

Please retain this address for future reference.

CAUTION: Have an adult remove and dispose of all packaging, ties and fasteners before use.

WARNING: DO NOT LEAVE CHILD UNATTENDED WITH THIS ITEM DUE TO SIZE AND WEIGHT.

PRINTED IN CHINA

For questions or comments please call:
1-800-317-3245
Or write: customerservice@justplayproducts.com
Visit us at: www.justplayproducts.com

CONFORMS TO THE SAFETY REQUIREMENTS OF ASTM F963.

Follow Just Play on:

justplayproducts.com

<https://facebook.com/JustPlay>

<https://twitter.com/JustPlayToys>

<http://instagram.com/justplayproducts>

<https://pinterest.com/JustPlayToys>



Dance-Along Blue

Instruction Manual



Blue plush requires 4 x AA/LR6 batteries (included)
Handy Dandy Guitar requires 2 x AAA/ batteries (included)

3+

Battery Safety Information

Blue comes in Try Me mode with batteries in Blue and the Handy Dandy Guitar. When you get Blue home, please replace the batteries.

Blue requires 4 x AA/LR6 batteries (included). Handy Dandy Guitar requires 2 x AAA/LR03 batteries (included).

The toy is packaged in Try Me mode. When you bring the toy home, you can activate the full range of features by opening the pocket on Blue's belly and changing the switch from "TRY ME" to "ON."

Battery Instructions

Handy Dandy Guitar Controller

Unscrew the battery compartment of the Handy Dandy Guitar controller with a small Phillips head screwdriver. Insert 2 x AAA/LR03 batteries as shown in the diagram below.

Blue

Unscrew the battery compartment on Blue's belly with a small Phillips head screwdriver. Insert 4 x AA/LR6 batteries as shown in the diagram below.

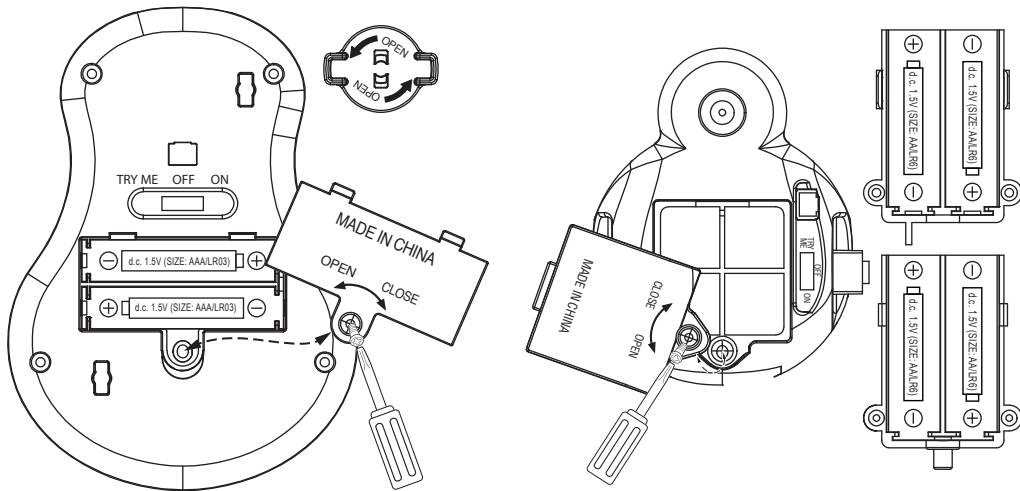

ATTENTION: The batteries included in this unit are only intended for in-store demonstration. It is possible that they may become weak or discharged prior to purchase and the customer may find it necessary to replace the included batteries with fresh cells to ensure proper operation.

Blue requires 4 x AA/LR6 batteries (included)
Handy Dandy Guitar requires 2 x AAA/LR03 batteries (included)
Replacement of batteries must be done by an adult.
Dispose of batteries safely.
Never dispose of batteries in fire, as they may leak and explode.

Battery Instructions

1. Remove batteries when not in use or discharged.
2. Do not mix old and new batteries.
3. Do not use rechargeable batteries.
4. Do not mix alkaline, standard (carbon-zinc), or rechargeable (nickel-cadmium) batteries.

Time to Play

Turn both the Handy Dandy Guitar and Blue switch to the ON position. Press any of the buttons on the Handy Dandy Guitar to activate sounds & motion.

Play 3 ways with the Handy Dandy Guitar, (while located closely to the plush)

- Press the top button ① for sounds/function.
- Press the music note button ② to start the music/dance.
- Press the "strings" ③ to speed up/slow down the music/function. Blue will increase speed twice, and then will decrease speed with additional presses, until returning to the starting speed. You can play through this cycle as many times as you like. While music is playing, control the speed by pressing the strings. The more you press, the faster she will dance.

You can also activate the song/dance motion by pressing the button on Blue's back. This will only activate the play, and you will not be able to control the speed. Press again to play again.

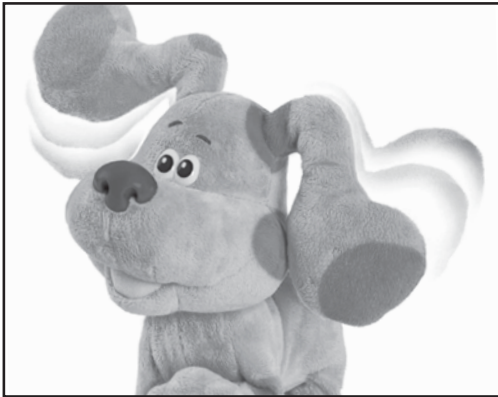
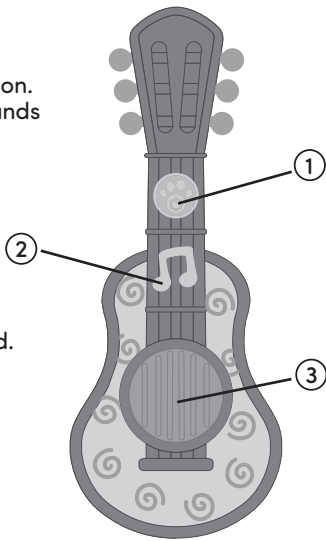

Ears move up & down



Leg Kicks



Bottom Wiggles

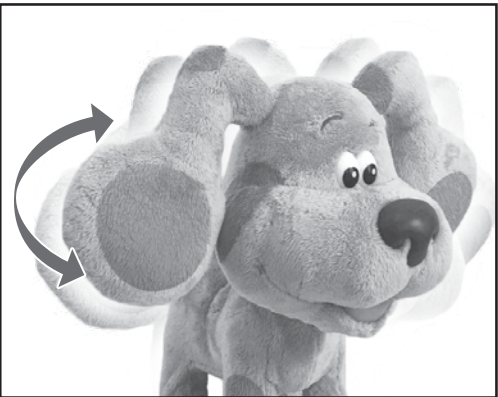

Head Rolls