

Low or No Water Pressure From Pump

- Make sure batteries are fresh and inserted correctly.
- Remove lid on shower unit and fill with clean water.
Do not exceed max fill line inside reservoir.
- Ensure the hose is not pinched.

Maximizing Bubble Performance

- Make sure batteries are fresh and inserted correctly.
- Make sure water level is not above or below 1".
- Bubble Tracks may need cleaning (see instructions on page 7).
- Make sure lid is on properly and locked into in place.
The lid of the Whirlpool, Bubbling Spa & Shower unit MUST be completely sealed **and locked in place for sufficient airflow to maximize bubble performance.** (see instructions for "Proper Lid Assembly" on page 4).
- Be sure to install Whirlpool, Bubbling Spa & Shower unit onto tub and firmly press down on unit to assure nozzle completely nests into rubber connector on tub (**Figure T**).
- Check that the Bubble Track is properly connected to the plastic connector that snaps along the tub wall. Make sure Bubble Track is nested in the tub properly. **Press firmly with your finger along the length** of the track. This will prevent air loss to the Bubble Tracks.

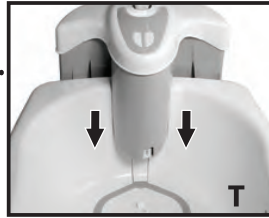

NOTE: The Bubble Track has been designed with bubble-producing holes. Air from the pump travels to the holes to produce bubbles.

Maximizing Whirlpool Function

- Make sure batteries are fresh and inserted correctly.
- Make sure water level is not above or below 1".
- Make sure lid is on properly and locked in place.
- Adjust the whirlpool nozzle to match Figure U.
You may need to nudge the nozzle to the right or left for proper alignment.

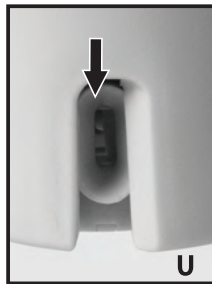

We're here to help!

If you have questions or need assistance, please contact our Consumer Relations Team at 401-671-6551 or www.summerinfant.com/contact



Please read the following instructions and warnings carefully. Keep this instruction manual for future reference.

Tools required:
Phillips head screwdriver (not included).
Requires: 4 "D" batteries (not included).
For use with children birth to 2 years.
Adult Assembly Required.

OWNER'S GUIDE

LIL' LUXURIES® WHIRLPOOL, BUBBLING SPA & SHOWER

Thank you for purchasing the Lil' Luxuries Whirlpool, Bubbling Spa & Shower from Summer Infant. Your little one will enjoy a soothing spa experience during each and every bath.



⚠ WARNING

Drowning Hazard: Babies have **drowned** while using infant bath tubs and bath slings.

To prevent drowning:

- **Stay in arm's reach** of your baby.
- **Never** rely on a toddler or preschooler to help your baby or alert you to trouble. Babies have drowned even with other children in or near bath tub.
- Babies can drown in as little as **1 inch** of water.
Use as little water as possible to bathe your baby.
- Use in **empty** adult tub or sink.
- Keep drain **open** in adult tub or sink.
- **NEVER** bathe baby until you have tested the water temperature.
ALWAYS check water temperature before placing child into tub.
- Bath water should be between 90°F and 100°F (32.2°C and 37.8°C).
- This product is not a toy. **DO NOT** allow children to play with it.
- Bath sling suitable for babies from birth (0-3 months, up to 10 lbs.).

Fall Hazard: Babies have suffered **head injuries** falling from infant bath tubs and bath slings.

To prevent falls:

- Place product **only** in adult tub or sink.
- **Never lift or carry** baby in tub and/or bath sling.
- **Never** use on uneven or elevated surfaces.
- **NEVER** leave children unattended.
- Discontinue use of product if damaged, broken, or disassembled.

⚠ BATTERY WARNING

- Do not mix old and new batteries.
- Do not mix alkaline, standard, (carbon-zinc), or rechargeable (nickel-cadmium) batteries.
- Remove batteries when product is stored for long period of time or when batteries are exhausted.
- Dispose of exhausted batteries according to instructions.
- Do not recharge non-rechargeable batteries.
- Batteries are to be inserted with correct polarity.
- **CAUTION:** Risk of explosion if battery is replaced by an incorrect type.
- Keep all batteries away from children.

REMOVING EXCESS WATER

1. Remove Whirlpool, Bubbling Spa & Shower Unit from Infant Tub.
2. Drain **all** water out of infant tub, by either opening drain plug in the floor of tub or turning tub over.
3. Lift Bubble Track from floor of Infant Tub (**Figure S**).
4. Elevate tub and allow excess water to drain through drain plug.



CLEANING & STORAGE

Tub

Clean the tub and shower unit with a damp cloth, mild soap and warm water. Air dry.

Bubble Track

Lift the bubble track. Use cotton swabs to clean any soap buildup under tracks with mild soap and warm water. Air dry.

Sling

Clean with a damp cloth, mild soap and warm water.
Position the bath support upright in bath tub to dry.

Shower Unit

Clean water reservoir: Rinse with clean, warm water and air dry.
Lid/Shower: Clean with a damp cloth, mild soap and warm water. Do not rinse.
Do not submerge in water.

BASIC MAINTENANCE

- Make sure **all** hose connections are not pinched nor too tight.
- Make sure **all** screws on the battery compartment are tight.
- Do not use Whirlpool, Bubbling Spa & Shower or sling if any components are missing or damaged.

ASSEMBLING THE BATH SLING

⚠ WARNING

To prevent injuries, make sure sling is always assembled properly before every use.

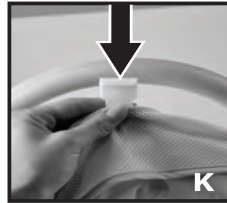

Assembling the Bath Sling

FALL HAZARD: Babies have suffered head injuries falling from infant bath tubs and slings. Product can collapse if lifted or carried with your child in it. Your child can fall out and suffer a serious head injury.

NEVER lift or carry product with child in it. Always secure fabric to frame with clip provided.

1. Remove Bath Sling from plastic bag. Insert bottom portion of plastic frame into back pocket of Bath Sling (Figure J).

2. Locate clip (Figure K).

3. Hook clip on frame (Figures L & M).

4. Flip fabric over frame (Figure N). Loop elastic bands on side of fabric sling onto plastic frame notches (Figure O), both sides.

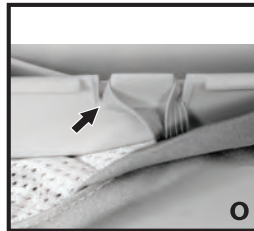
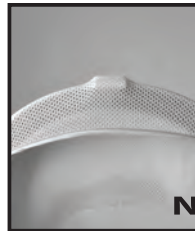
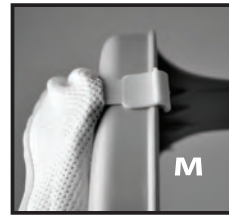

Newborn Use

Bath sling suitable for babies from birth (0-3 months, up to 10 lbs.).

Position bath sling on the bottom of the sink. Place newborn on bath sling to bathe (Figure P). **NEVER leave child unattended while in sink.**



To Use in Infant Tub

1. Position Infant Tub in a full-size bathroom tub.
2. Position bath sling on the bottom of the Infant Tub.
3. Place infant on sling to bathe (Figure Q). **Never leave child unattended while in tub.**



Whirlpool & Shower Unit in Full-Sized Tub

Position the Whirlpool & Shower Unit on the bottom of the full-sized tub where you are bathing your child (Figure R). **Never use more than 1" of water in tub when bathing child.**

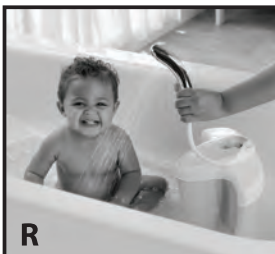

COMPONENTS

Infant Tub



Bath Sling Frame



Spa Connector



Fabric Bath Sling

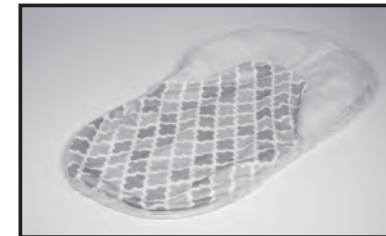

Shower, Whirlpool & Bubbling Spa Unit

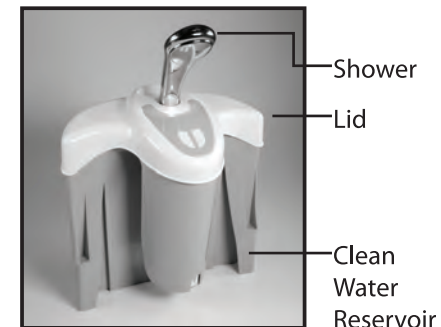

Shower

Lid

Clean Water Reservoir

Bubble Track Insert



INSTALLING THE BATTERIES

Shower, Bubbling Spa & Whirlpool Unit

1. To remove Shower, Bubbling Spa & Whirlpool Unit lid, hold top of lid and push reservoir back until you hear a click (**Figure A**).

Pull lid from the back edge until it releases.

2. Use screwdriver to open battery compartment door (**Figure B**).

3. Insert 4 new alkaline "D" batteries into battery compartment.
 • *Be sure to install the batteries properly and in the right direction.*
 • *The battery compartment is marked with + and -.*
 • *Make sure the markings on the batteries match the markings on the battery compartment (Figure C).*

4. Close battery compartment doors and tighten the 2 screws.

DO NOT OVERTIGHTEN.

Proper Lid Assembly

1. Attach lid onto reservoir.

• *Be sure to firmly push lid down until you hear a loud click on both sides (Figure D).*

• *Make sure the lid is on tight by gently pulling up on either end.*
 • *Lid should not lift up off reservoir.*

NOTE: Front portion of lid will not lock shut; it will close when tub and unit are assembled.

• *Locking the back portion of the lid onto the reservoir is critical for proper bubble performance.*

• *Do not lift by the lid.*

• *Lift from bottom of reservoir to prevent any spills.*

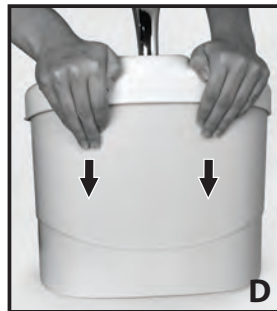
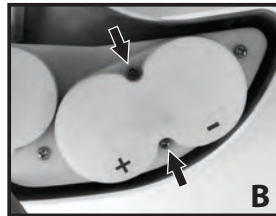

SETTING UP BUBBLE TRACK & SPA CONNECTOR

Bubble Track

1. Line rubber Bubble Track into channels on bottom of the tub (**Figure E**).

2. Start in the back of the tub and work the Bubbling Track into the slots, working forward toward the tub's drain plug.

Spa Connector

1. Attach the Spa Connector to the tub wall.

2. Snap the top of the Spa Connector piece into the top of the tub wall (**Figure F**).

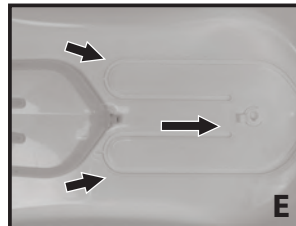

USING THE SHOWER, BUBBLING SPA & WHIRLPOOL UNIT

1. Remove lid and fill with clean water.
 Do not exceed max fill line inside of reservoir (**Figure G**).

CAUTION: Do not carry filled reservoir by the lid.

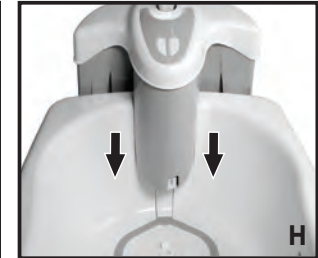
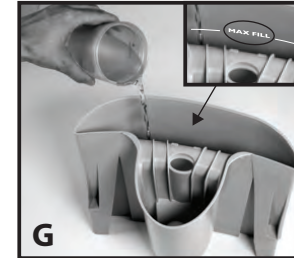

2. Attach the Shower, Bubbling Spa & Whirlpool Unit onto outside of tub.

Be sure unit is aligned correctly to allow maximum air flow to Bubble Track (Figure H).

NOTE:

- Never place more than 1" of water in the tub.
- Always keep the drain open in the adult bath tub or sink.

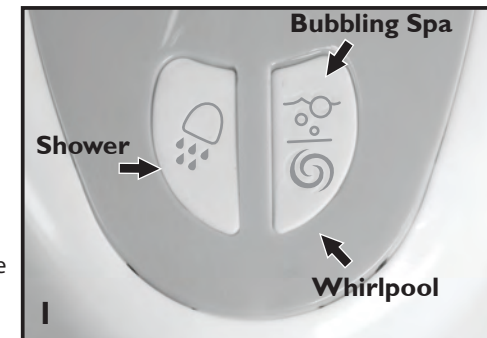

Shower Mode

- To turn shower on, press left button 1 time
- To turn off, press the left button 1 more time (**Figure I**).

Bubbling Spa Mode

- To turn bubbles on, press the right button 1 time.
- To turn bubbles off, press the right button 2 more times until bubbles shut off (**Figure I**).

NOTE:

Allow a few moments for maximum bubbling action.
 No bubbles? See Tips & Troubleshooting on Page 8.

Whirlpool Mode

- Press the right button 2 times to turn the Whirlpool on.
- To turn off, press the right button 1 more time (Figure I).

IMPORTANT NOTE: When in whirlpool mode, the whirlpool nozzle may become misaligned when the reservoir lid is reinstalled onto the reservoir. **This is not a product defect.** Please remove the reservoir lid and readjust the whirlpool nozzle to the correct location for sufficient whirlpool function.