

SINCE 1839

BRINLY

SINCE 1839

BRINLY

OWNER'S MANUAL

POLY CART, 17 CUBIC FOOT

MODEL:

PCT-17BH

PCT-17BHEXP

- Assembly
- Installation
- Operation
- Repair Parts

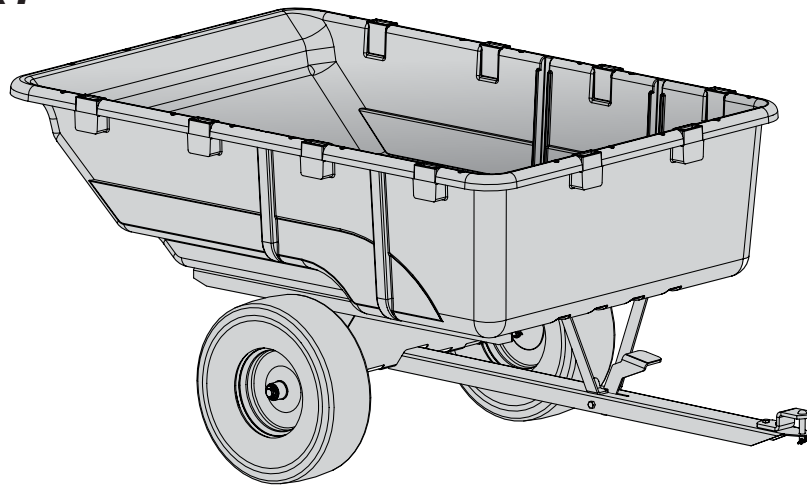

This utility cart is designed
for use with lawn tractors and
lawn and garden tractors.



Call Customer Service, Toll-Free: 877-728-8224

Visit us on the web!
www.brinly.com

Important: This manual contains information for the safety of persons and property. Read it carefully before assembly and operation of the equipment!

INTRODUCTION AND SAFETY

CONGRATULATIONS on your new Brinly-Hardy Lawn Cart! This accessory has been designed, engineered and manufactured to give you the best possible dependability and performance.

Should you experience any problem you cannot easily remedy, please do not hesitate to contact our knowledgeable customer service department toll-free at 1-877-728-8224. We have competent, well trained technicians to help you with the assembly and use of your Cart.



CUSTOMER RESPONSIBILITIES

- Please read & retain this manual. The instructions will enable to assemble and maintain your product properly.
- Please carefully read and observe the SAFETY SECTION of this manual.
- Follow a regular schedule in maintaining and caring for your Brinly-Hardy product.

TABLE OF CONTENTS

Introduction, Safety and Required Tools	2 - 4
Parts	5 - 6
Assembly	7 - 13
USE AND CARE	
Specifications	15
Installing / Removing	15
Operation	16
Maintenance	16
DIY: Side-Stakes	17 - 19
Accessories	19
Service	19
Warranty	20

SPECIFICATIONS

Maximum Towing Speed	8 mph
Bed Capacity	17 Cu. Ft.
Maximum Load	850 lbs
Maximum Tongue Weight	100 lbs
Empty Weight	107 lbs
Tire; Size	16 x 6.5

SAFETY LABELS



This symbol will help to point out important safety precautions throughout this manual. It means: **ATTENTION! BECOME ALERT! YOUR SAFETY IS INVOLVED.**

The safety labels shown in this section are placed in important areas on your product to draw attention to potential safety hazards.

On your product safety labels, the words DANGER, WARNING and CAUTION are used with the safety-alert symbol. DANGER identifies the most serious hazards.

The operator's manual also explains any potential safety hazards whenever necessary in special safety messages that are identified with the word, CAUTION, and the safety-alert symbol.

TOOLS REQUIRED FOR ASSEMBLY:



- 1/2" Wrench (2)
- 9/16" Wrench (2)
- Pliers
- Gloves

SAFETY

CAUTION

⚠ CAUTION

TO HELP PREVENT BODILY INJURY DUE TO LOSS OF STABILITY OR CONTROL

- Do not exceed maximum towing capacity of towing vehicle listed in the vehicle operator's manual
- Do not exceed maximum cart load capacity listed in cart operator's manual
- Reduce loaded cart weight on slopes and/or slippery surfaces
- Do not exceed 8 mph (13 kph) when towing cart

⚠ ATTENTION

POUR ÉVITER LES BLESSURES CAUSÉES PAR UNE PERTE DE STABILITÉ OU DE CONTRÔLE

- Ne pas dépasser la capacité de remorquage maximum du véhicule remorqueur indiquée dans le livret d'entretien du véhicule
- Ne pas dépasser la capacité de charge maximum du chariot indiquée dans le livret d'entretien du chariot
- Réduire la charge du chariot sur les pentes et/ou les surfaces glissantes
- Ne pas dépasser 8 mph (13 km/h) lors du remorquage du chariot

M151136

B-6535

WARNING



⚠ WARNING

AVOID INJURY FROM EXPLOSION

- Do not place gas container in cart when filling

RIDERS CAN FALL OFF AND BE KILLED

- No riders in cart

⚠ ATTENTION

POUR ÉVITER TOUTE BLESSURE PAR SUITE D'EXPLOSION

- Ne pas conserver le bidon à essence dans le chariot lors du remplissage

LES PASSAGERS PEUVENT TOMBER ET ENCOURIR DES BLESSURES MORTELLES

- Ne pas transporter de personnes dans le chariot

B-7084

B-7084

TO HELP PREVENT BODILY INJURY DUE TO LOSS OF STABILITY OR CONTROL

- Do not exceed maximum towing capacity of towing vehicle listed in the vehicle operator's manual.
- Do not exceed maximum cart load capacity listed in cart operator's manual.
- Reduce loaded cart weight on slopes &/or slippery surfaces.
- Do not exceed 8 mph (13 kph) when towing cart.

AVOID INJURY FROM EXPLOSION

- Do not place gas container in cart when filling

RIDERS CAN FALL OFF AND BE KILLED

- No riders in cart

GENERAL SAFETY NOTES (Operation)

Caution should be taken when towing and/or using any attachment. This attachment combined with the weight distribution, turning radius, and speed of towing vehicle can result in severe injury or death to operator, damage to towing vehicle, and/or attachment if not used properly. Follow all towing safety precautions noted in the towing vehicle owner's manual, including the following precautions:

- Do not exceed maximum towing capacity of towing vehicle listed in the vehicle operator's manual.
- Do not exceed maximum cart load capacity listed in the cart operator's manual.
- Reduce loaded cart weight on slopes and/or slippery surfaces.
- Do not exceed 8 mph when towing cart.
- Do not tow cart behind a ZTR (Zero Turn Radius) Mower.
- Do not tow cart behind a motor vehicle such as a car, truck, ATV or UTV.

Safety

- Read the general safety operating precautions in your machine operator's manual for additional safety information.

Operate Safely

- Use cart for intended purpose only.
- This machine is intended for use in lawn care and home applications. Do not tow behind a vehicle on a highway or in any high speed applications. Do not tow at speeds higher than maximum recommended towing speed.

SAFETY

GENERAL SAFETY NOTES (Operation)

Operate Safely (...continued)

- Towing speed should always be slow enough to maintain control. Travel slowly over rough ground.
- Do not let children or an untrained person operate the towing vehicle or this machine.
- Do not let anyone, especially children, ride on the towing vehicle, this machine or attachment. Riders are subject to injury such as being struck by foreign objects and being thrown off. Riders may also obstruct the operator's view, resulting in the machine being operated in an unsafe manner.
- Check towing vehicle brake action before you operate. Adjust or service brakes as necessary.
- Keep all parts in good condition and properly installed. Fix damage immediately. Replace worn or broken parts. Replace all worn or damaged safety and instruction decals.
- Do not modify the towing vehicle, this machine or safety devices. Unauthorized modifications to the machine or attachment may impair its function and safety.
- Securely anchor all loads to prevent loads from falling out during use.
- Keep all nuts, bolts and screws tight.
- Do not over inflate tires.
- Do not restrict operator visibility during use.
- Ensure the operator is at a safe distance when dumping cart! The Lock Bar that releases the bed has the potential to release quickly.
- Do not modify hitch/trailer connection on cart.
- Distribute load evenly for safe travel and unloading of cart.

Towing Loads Safely

- Stopping distance increases with speed and weight of towed load. Travel slowly and allow extra time and distance to stop.
- Total towed weight must not exceed limits specified in towing vehicle operator's manual.
- Excessive towed load can cause loss of traction and loss of control on slopes. Reduce towed weight when operating on slopes.
- Never allow children or others in or on towed equipment.
- Use only approved hitches. Tow only with a machine that has a hitch designed for towing. Do not attach towed equipment except at the approved hitch point.
- Follow the manufacturer's recommendations for weight limits for towed equipment and towing on slopes. Use counterweights or wheel weights as described in the towing vehicle operator's manual.
- Do not turn sharply. Use additional caution when turning or operating under adverse surface conditions. Use care when reversing. To avoid jack-knifing, do not allow towing vehicle wheels to contact drawbar.
- Do not shift to neutral and coast downhill.

Protect Bystanders

- Keep bystanders away when you operate a towed attachment.
- Before you back machine and attachment, look carefully behind attachment for bystanders.
- Before you dump cart, look carefully behind attachment for bystanders.

Keep Riders Off Towed Attachment

- Keep riders off of a towed attachment.
- Riders on a towed attachment are subject to injury, such as being struck by objects and being thrown off the attachment during sudden starts, stops and turns.
- Riders obstruct the operator's view, resulting in the attachment being used in an unsafe manner.
- Keep riders off of hitch bracket.

Keep Body Parts From Under Drawbar.

Before you disconnect this machine from towing vehicle hitch plate:

- Unload cart. Stop on level ground.
- Stop machine engine.
- Lock machine park brake.
- Block attachment wheels.
- Make sure body parts are not under drawbar.

Cart Assembly

When assembling the cart, do the following:

- Do not discard the inner packing sleeve. A template can be cut from the sleeve to make dividers for the cart.
- Place pieces of carton under the cart bed to avoid scratches.
- Put all bolt heads to the inside of the cart bed.

Poly Cart Specific Safety Instructions

- Do not tow cart with bed raised.

Installation Questions?
Missing Parts? Replacement Parts?

**DON'T GO BACK TO
THE STORE!**

Please call our Customer Service
Department, Toll Free: 877-728-8224
or customerservice@brinly.com



PARTS

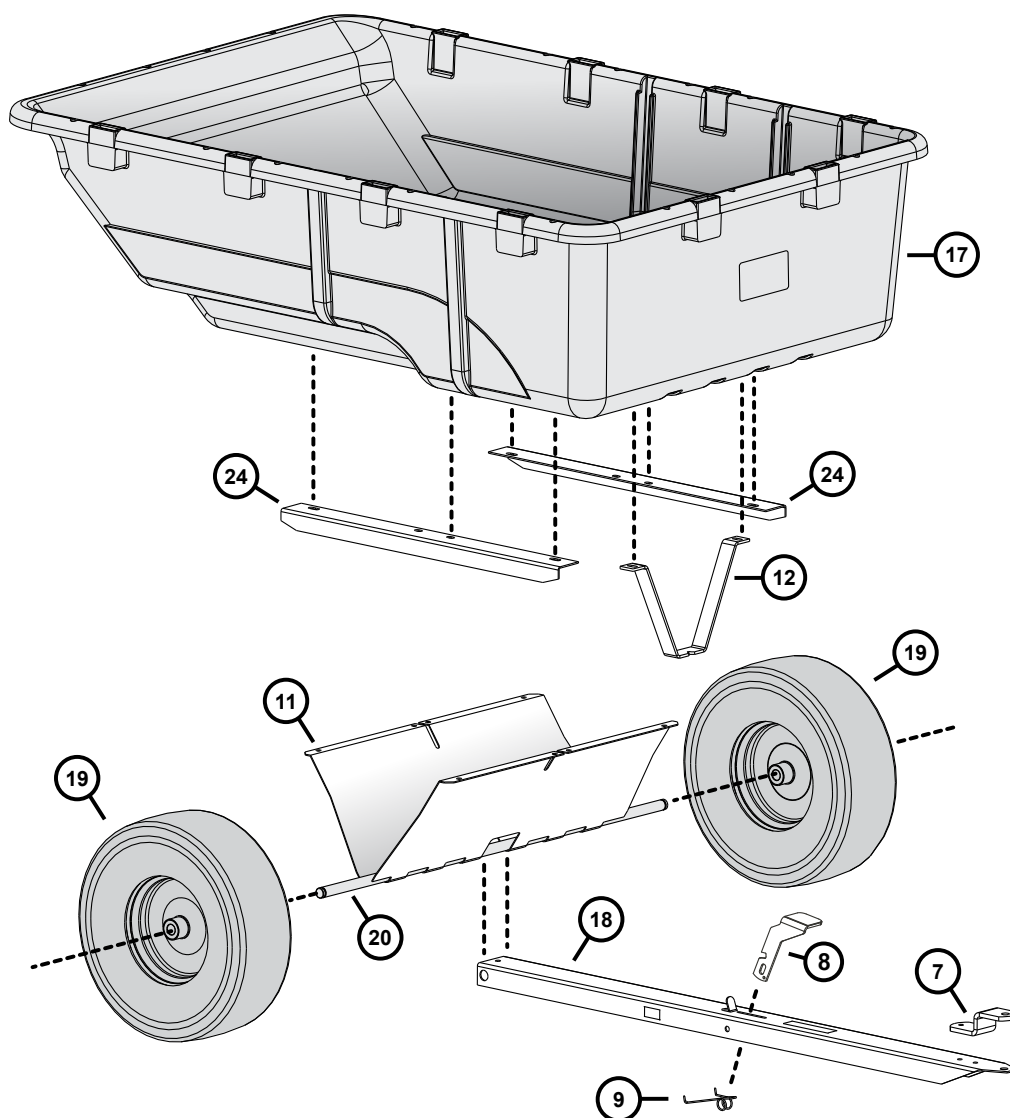

Ref.	Description	Part Number	Qty.	Ref.	Description	Part Number	Qty.
7	Clevis	B-3034-10	1	28	Caution Label *	B-6535	1
8	Foot Pedal	1008604	1	29	Warning Label *	B-7084	1
9	Spring (Foot Pedal)	B-3303	1	30	Grip Tape *	1008603	1
11	Axle Support Bracket	B-3308-10	1	31	Manual Group *	L-1821ASM	1
12	Lock Bracket	B-3520-10	1	32	Hardware Pack *	Z-1873	1
17	Bed	1007473	1		<i>Contents listed on the following pg.</i>		
18	Drawbar	B-6957-10	1				
19	Wheel	1009143	2	-	Parts Bag *	1019853	1
20	Axle	B-6967	1		<i>Contains Parts:</i>		
24	Longitudinal Support	B-8026-10	2		<i>7, 8, 9, 12, 30, 31 & 32</i>		

* Not Illustrated

HARDWARE IDENTIFIER

Illustrations on this page are to scale for faster identification of hardware during assembly.

DO NOT RETURN PRODUCT IF YOU ARE MISSING PARTS.

Please Call: 1 (877) 728-8224

④ Nut: Hex Head
5/16" (x12)
30M1000P



⑭ Retaining Ring
3/4" (x2)
B-4305

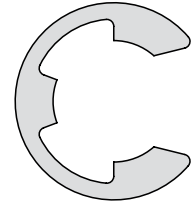

⑩ Nut: Keps
3/8" (x2)
B-6299

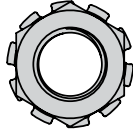

⑮ Machine Bushing
3/4" (x6)
B-5606

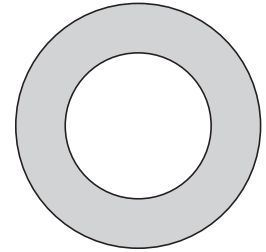

⑳ Nut: Lock
5/16" (x2)
B-1674P

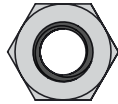

㉓ Nut: Lock
3/8" (x1)
B-1675P

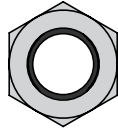

㉑ Wheel Spacer
(x2)
B-6978-01

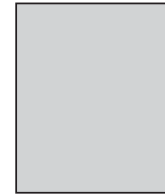

⑤ Washer: Lock
5/16" (x12)
40M1000P

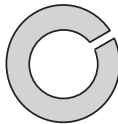

㉕ Hitch Pin Cotter (x1)
D-146P

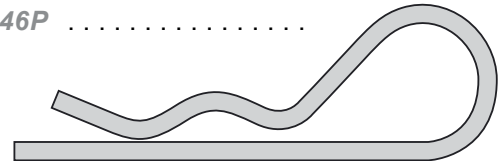

⑥ Washer: Flat
5/16" (x24)
45M1111P

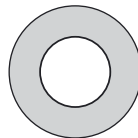

③ Bolt: Hex Head
3/8 x 3 3/4" (x1)
B-6298

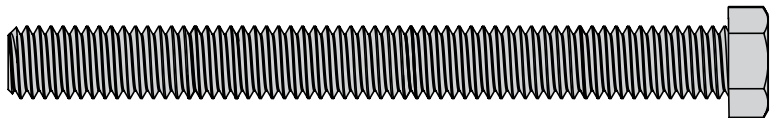

② Bolt: Hex Head,
5/16 x 3/4" (x2)
2M1012P

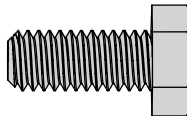

⑳ Screw: Round Head
5/16 x 1 1/4" (x12)
20M1020P

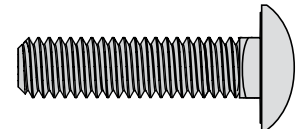

⑬ Hitch Pin: 1/2" x 2 1/2" (x1)
B-3861

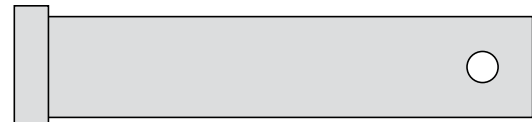

ASSEMBLY

Assembly Tips

BEFORE ASSEMBLY:

- It is recommended that you carefully read this owner's manual before starting assembly of the unit.
- NOTE: *Right hand (RH) and Left hand (LH) are determined from the Operator's position while seated on the tractor.*

DURING ASSEMBLY:

- **Illustrations on page 6 are to-scale.** To confirm the identification of any hardware during the assembly process, items can be compared to these illustrations.
- Securely tighten all fasteners only **AFTER** assembly has been completed, *unless noted otherwise.*

BRINLY.COM Additional info and videos are available on our website, or by scanning this QR code:

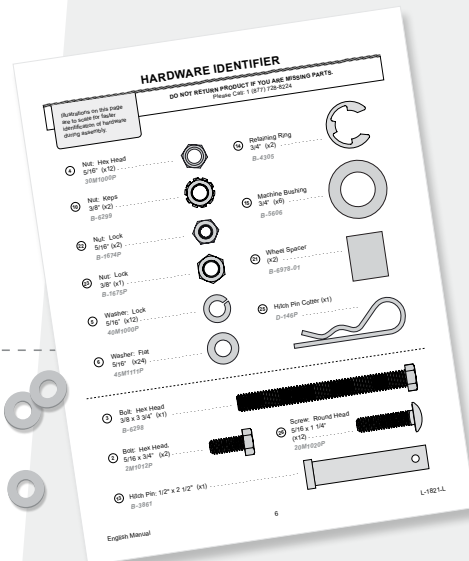

Assembly Step 1

Install Supports

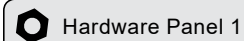

1. Position the Longitudinal Supports (24) over the bed, as shown.
2. Secure each support from inside the cart bed (17) with one 5/16 x 1 1/4" Round Head Screw (26), and 5/16" Flat Washer (6).

From the outside, add another 5/16" Flat Washer (6), one 5/16" Lock Washer (5) and one 5/16" Hex Nut (4), as shown. Assemble finger tight until all screws are installed.

3. Do **NOT** tighten nuts (yet).

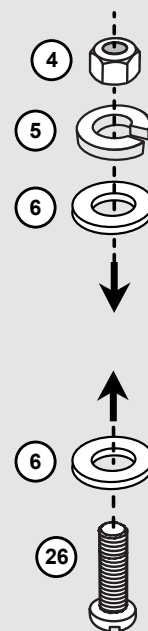
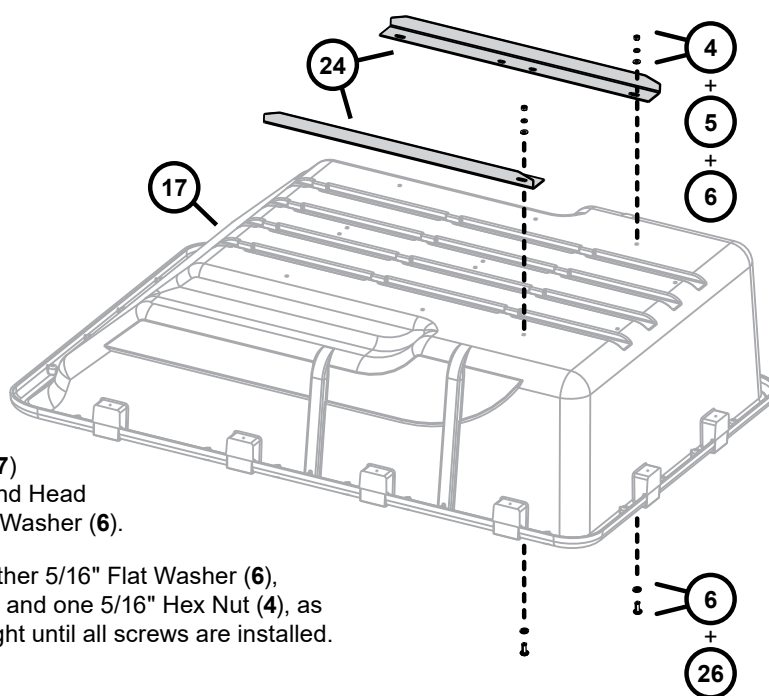

x2

ASSEMBLY

Assembly Step 2

Install Axle Support

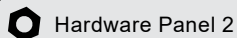

1. Position the Axle Support (11) over slotted holes over the Longitudinal Supports (24) and bed (17).
2. Secure in place from inside the cart bed (17) with one 5/16 x 1 1/4" Round Head Screw (26), and 5/16" Flat Washer (6). From the outside, add another 5/16" Flat Washer (6), one 5/16" Lock Washer (5) and one 5/16" Hex Nut (4), as shown. Assemble finger tight until all screws are installed.
3. Tighten all nuts from Steps 1 and 2.

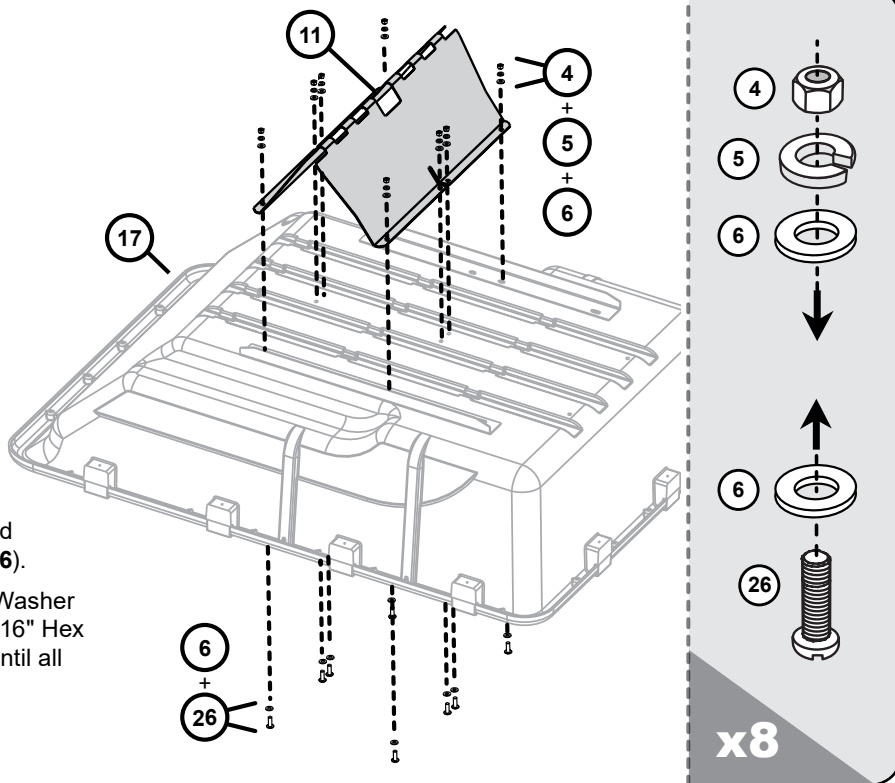

Assembly Step 3

1. Align the cart foot pedal (8) through slot in drawbar (18) with the notch in the foot pedal oriented towards the raised tongue on the drawbar. See illustration.
2. While holding the foot pedal (8) in place, flip the drawbar (18) over.

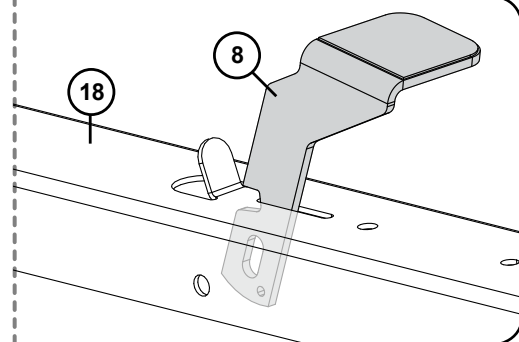

Assembly Step 4-A

Squeeze in the latch spring (9) arms and slide in place, as illustrated.

ALIGNMENT NOTES:

- The widest portion of the spring will straddle the larger of the two drawbar (18) openings.
- The loop of the spring is slightly raised away from the drawbar and aligns with base of the foot pedal (8).
- Narrow end of the spring rests against the drawbar (18).

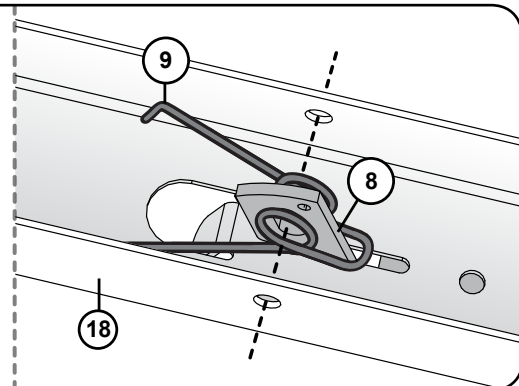

ASSEMBLY

Assembly Step 4-B

Hardware Panel 3

Begin to slide the 3/8 x 3-3/4 in. bolt (3) through the drawbar (18).

Between the drawbar and the latch spring (9), add one 3/8 in. keps nut (10) to the bolt (3) as illustrated.

NOTE: Foot pedal can be adjusted slightly while installing bolt (3). This will help to align the bolt with the hole on the other side of the drawbar.

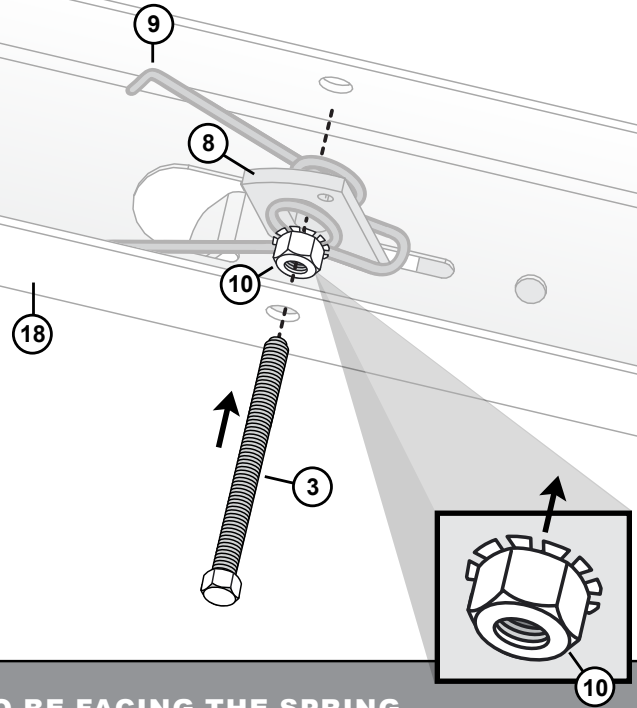

STARRED EDGE OF THE WASHER NEEDS TO BE FACING THE SPRING.

Assembly Step 4-C

Hardware Panel 3

Continue to run the bolt (3) through the latch spring (9) and foot pedal (8).

Between the latch spring (9) and drawbar, add one 3/8 in. keps nut (10) to the bolt (3) as illustrated. Finally, run the end of the bolt (3) through the other side of the drawbar (18).

NOTE: Foot pedal can be adjusted slightly while installing bolt (3). This will help to align the bolt with the hole on the other side of the drawbar.

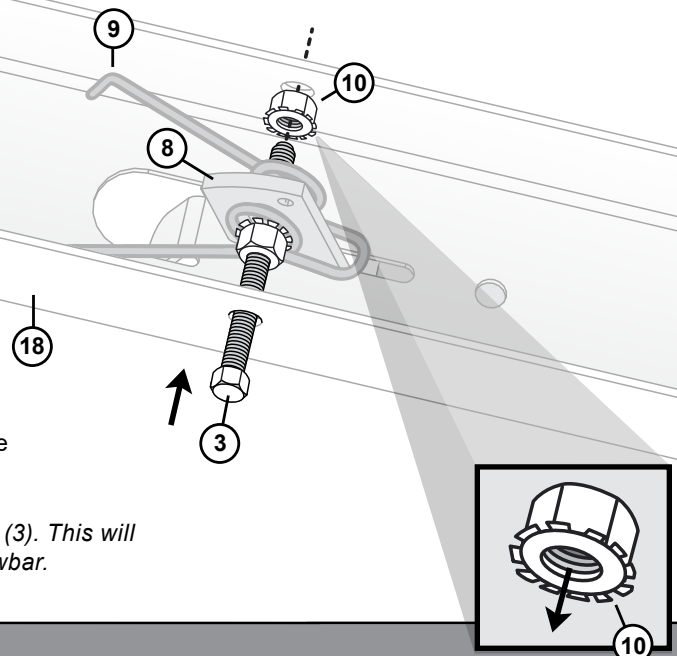

STARRED EDGE OF THE WASHER NEEDS TO BE FACING THE SPRING.

ASSEMBLY

Assembly Step 4-D

 Hardware Panel 3

1. On the outside of the drawbar, add bolt (3) with a 3/8 in. hex head locking nut (23) so that the foot pedal moves forward and backward freely.
2. Tighten nuts (10) toward the spring, but allow movement.

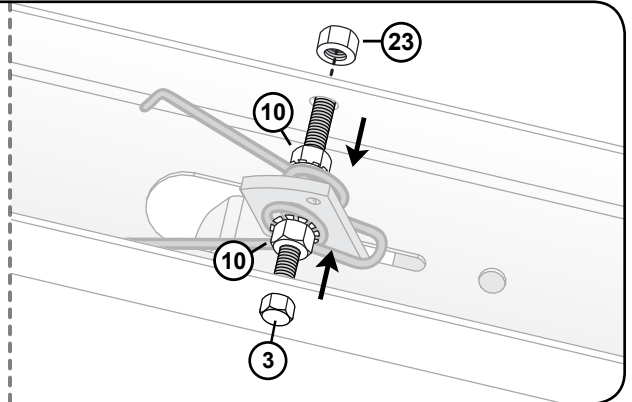

Assembly Step 4-E

1. Pull the arms of the latch spring (9) up and over the edges of the drawbar (18), as shown.

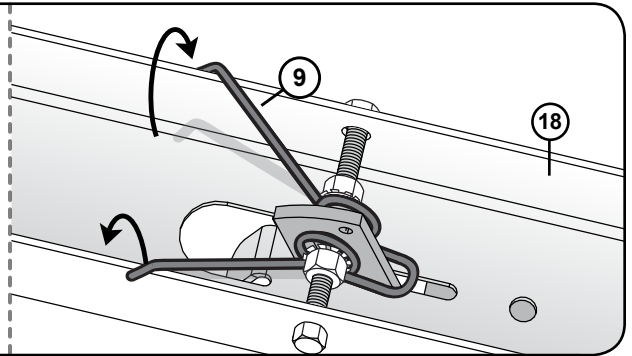

Assembly Step 5

Install Lock Bracket

 Hardware Panel 3

1. Position the Lock Bracket (12) over the bed, as shown.
2. Secure the bracket (12) from inside the cart bed (17) with one 5/16 x 1 1/4" Round Head Screw (26), and 5/16" Flat washer (6).

From the outside, add another 5/16" Flat Washer (6), one 5/16" Lock Washer (5) and one 5/16" Hex Nut (4), as shown. Assemble finger tight until all screws are installed.
3. Do NOT tighten nuts.

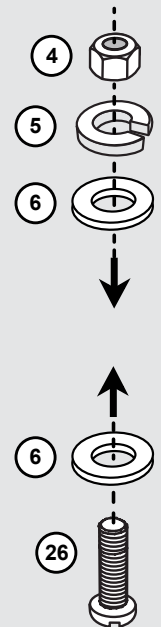
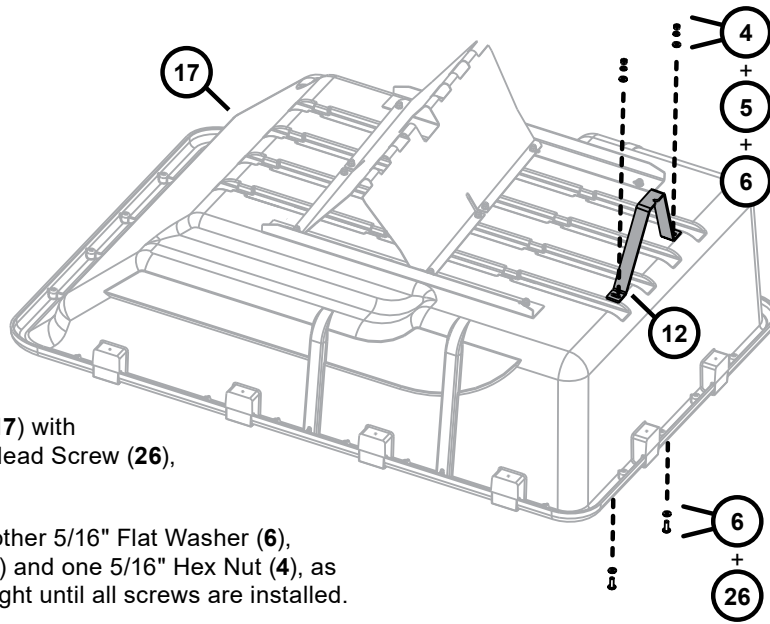

x2

ASSEMBLY

Assembly Step 6

Install Clevis

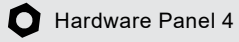

1. Position clevis (7) on the cart drawbar (18) as illustrated.
2. Slide two 5/16 x 3/4 in. hex head bolts (2) through the clevis (7) and the drawbar (18).
Secure beneath the drawbar (18) with two 5/16 in. nuts (22).

3. Install the clevis pin (13) through clevis and cart drawbar.
Secure with 1/8 in. hairpin cotter (25).

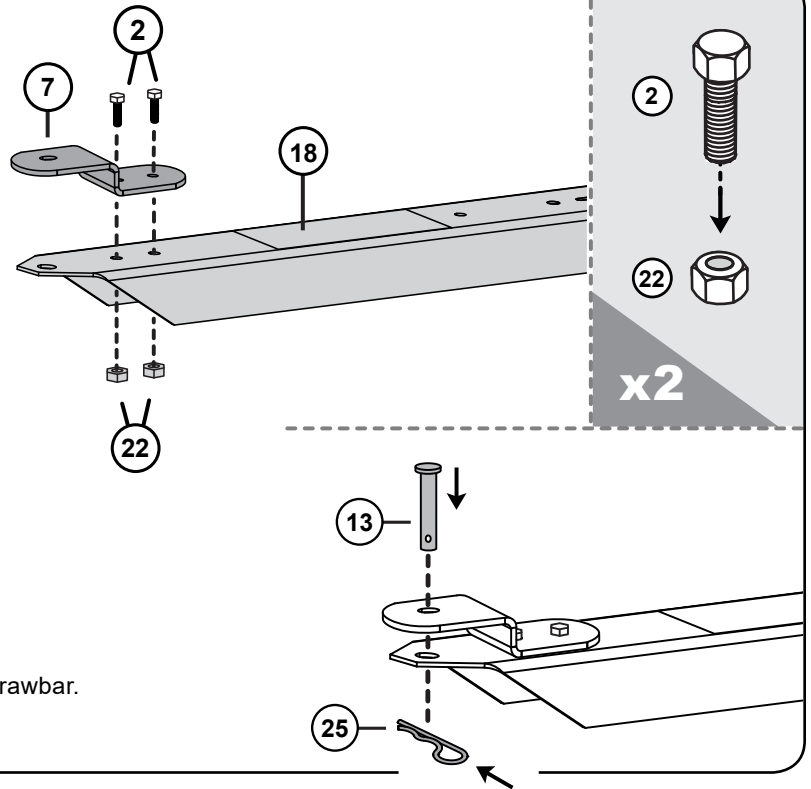

Assembly Step 7

Install Drawbar

Add the Drawbar Assembly (18) in place as shown.

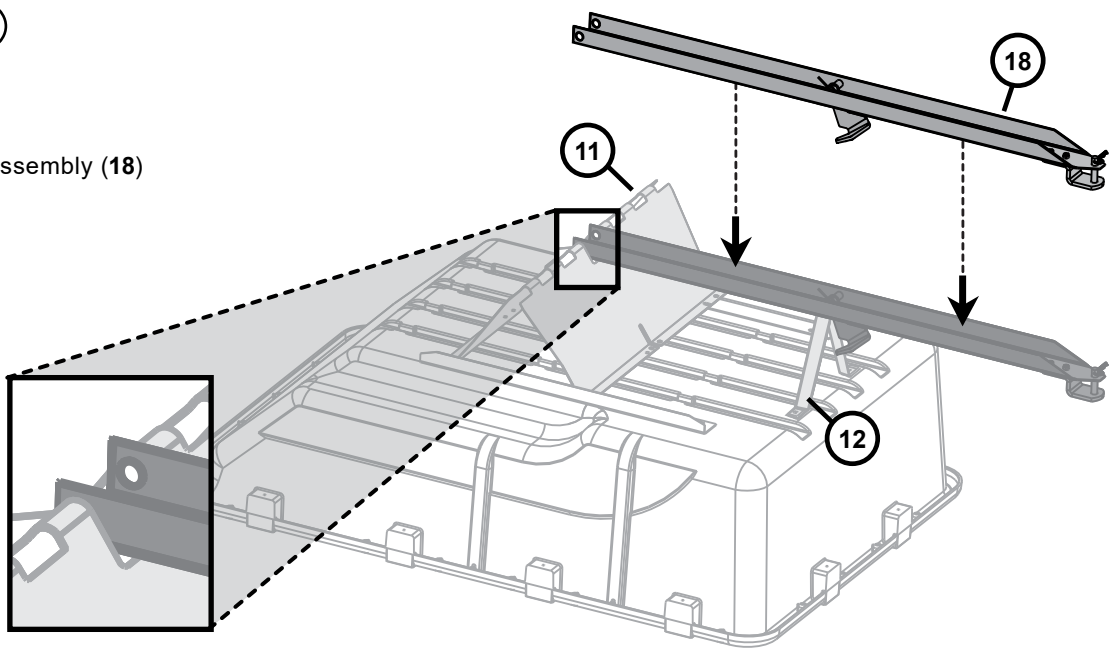

ASSEMBLY

Assembly Step 8

Install Axle

1. Slide the Axle (20) through the Axle Support (11) as illustrated.

A light coating of grease or oil will aid in inserting the Axle (20) through the Axle Support (11).

2. Verify that the lock bracket (12) engages the foot pedal (8).

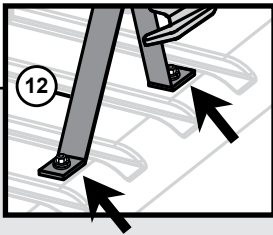

NOTE: Adjustment can be made by loosening the two screws that secure the lock bracket (12) and moving the lock bracket forward or back to change engagement and / or ease of operation.

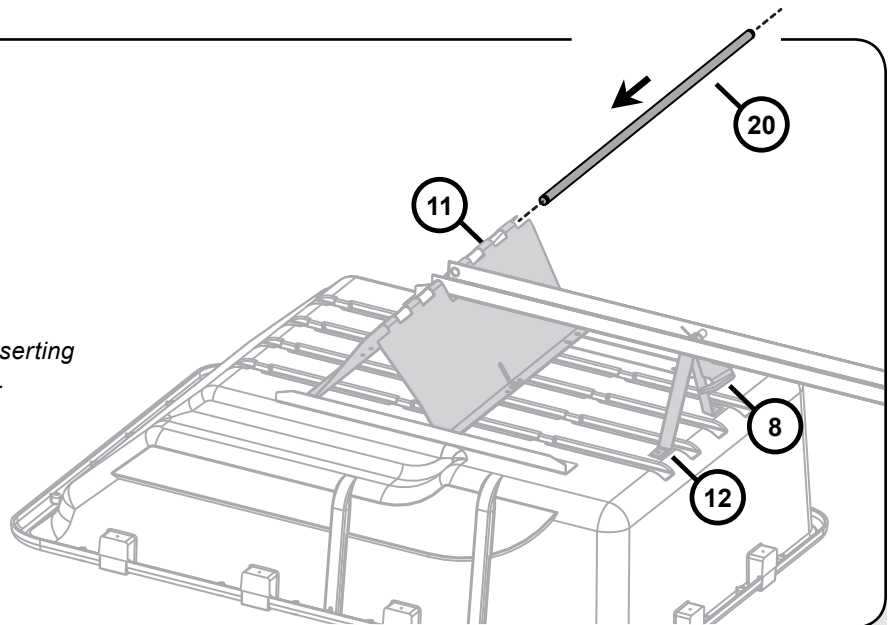

Assembly Step 9-A

 Hardware Panel 6

To install wheels, assemble parts on the axle (20) as follows:

- Wheel Spacer (21)
- Bushing (15)
- Wheel (19)
- Bushing (15)

NOTE:
Install the wheels so that the grease fitting faces out.

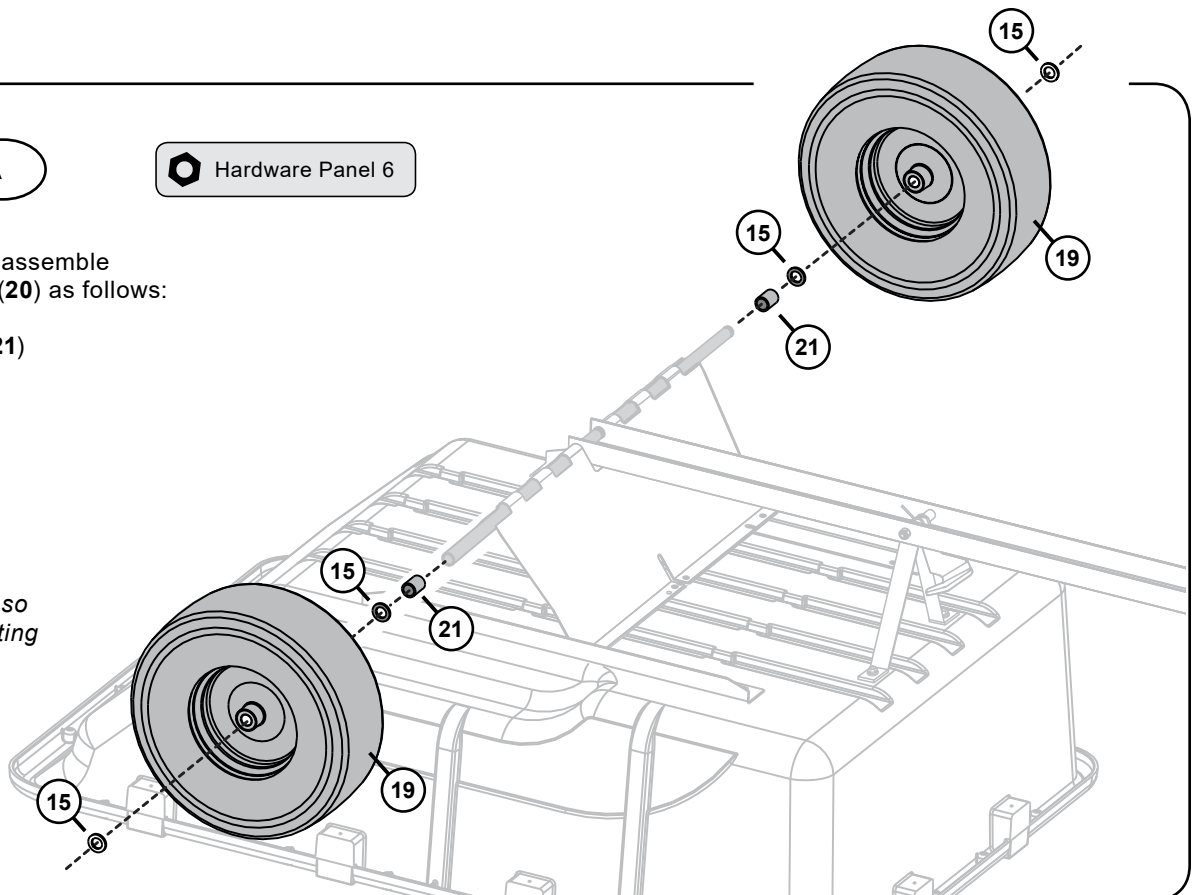

ASSEMBLY

Assembly Step 9-B

Hardware Panel 6

Use pliers to snap retaining ring (14) in to groove on axle (20). Two extra bushings (15) are also provided in case you need to take up end play on Axle (20).

NOTE: Wheels come without grease in them!

Use a grease gun to lubricate wheels and axle assembly prior to use. Pump grease until grease starts coming out around bearing either inside hub or outside hub.

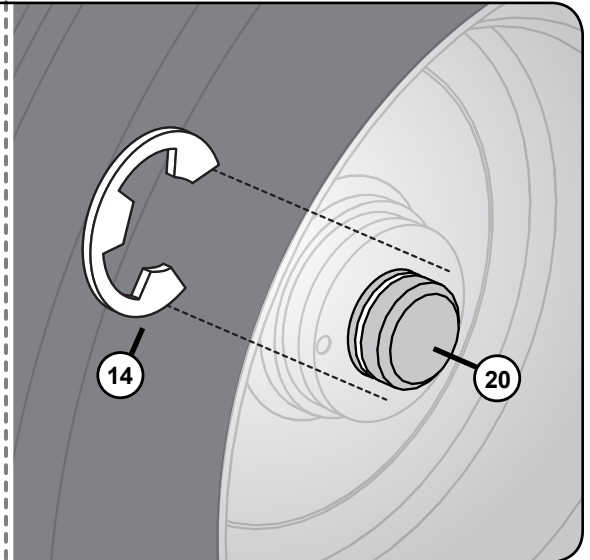

Assembly Step 10

Gently flip the cart over.

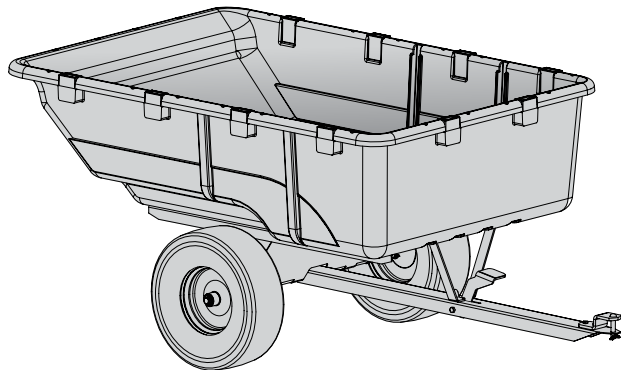

Assembly is Complete!

Continue reading for details on Operation, Maintenance, Service and Accessory options.

*Additional info and videos are available on our website (brinly.com)
OR you can scan this QR code:*



USE AND CARE

MODEL:

PCT-17BH CART USE & CARE SECTION

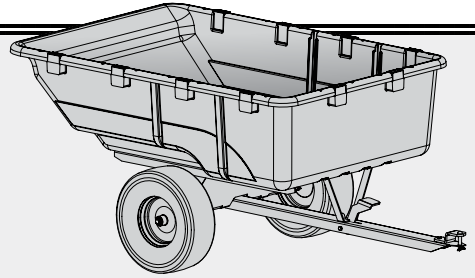

SPECIFICATIONS

Cart Bed
Capacity 17 cu ft

Maximum
Towing Speed 8 mph

MAXIMUM

Tire Pressure 28 PSI

Tire pressure may be reduced to increase wheel traction or to reduce shock, although it should not be reduced to below 70% of the maximum rated pressure.

WEIGHT

Maximum Load . . . 850 lbs

Maximum

Tongue Weight . . . 100 lbs

Empty Weight . . . 107 lbs

INSTALLING CART



CAUTION: AVOID INJURY!

Before installing cart, make sure dump lever is locked.

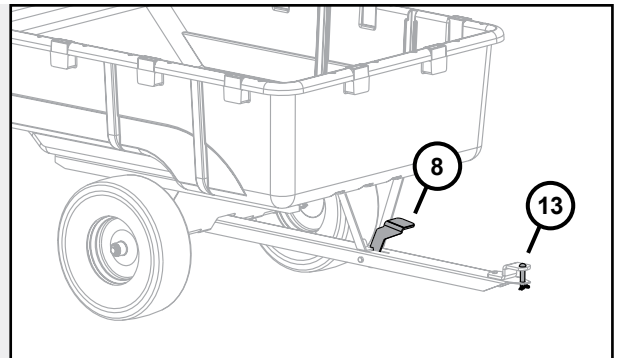

1. Lock cart in place: Lock bracket + foot pedal (8).
2. Park towing vehicle safely (See *Towing Vehicle Manual*).
3. Align cart drawbar with towing vehicle drawbar.
4. Install hitch pin (13) through cart drawbar and towing vehicle hitch. Secure clevis pin with 1/8 in. spring locking pin.

REMOVING CART



CAUTION: AVOID INJURY

Before installing cart, make sure transport latch is facing toward cart dump lever and dump lever is locked in place.

NOTE: Refer to illustrations in the *Installing Section*, earlier in this manual.

1. Park towing vehicle safely (See *Towing Vehicle Manual*).
2. Unload cart.



CAUTION: AVOID INJURY!

Keep body parts from under drawbar.

3. Remove cotter pin and drawbar pin.
4. Push cart away from towing vehicle. Block cart wheels.
5. Install drawbar pin and cotter pin in cart drawbar for storage.

USE AND CARE

UNLOADING CART

1. Park towing vehicle safely
(See *Towing Vehicle Manual*).

CAUTION: Avoid Injury!
BEFORE DUMPING CART:
Park towing vehicle safely.



Before backing up, make sure area is clear of bystanders, especially children. Make sure cart is installed to the towing vehicle. Evenly distribute load before releasing lock bar.

Ensure the operator is at a safe distance when dumping cart! *The Lock Bar that releases the bed has the potential to release quickly!*

2. Move lock bar forward to release cart box.
3. Tilt cart bed back to unload cart.
4. Push cart down & move cart lock bar toward cart & lock into place.

MAINTENANCE



1. Lubricate each wheel bearing with a multipurpose grease or an equivalent.
2. Wash cart bed after each use to avoid damage to the bed or hardware.
3. Unload cart before performing any maintenance to cart assembly, including changing flat tires, etc.

DETERMINING WEIGHT FOR CART



CAUTION: AVOID INJURY! Excessive towed load can cause loss of traction and loss of control on slopes. Stopping distance increases with speed and weight of towed load.

Total towed weight must not exceed combined weight of the towing vehicle, ballast and operator.

The following is the maximum loaded cart weight:

Model Cart:
17P

Loaded Weight
Capacity:
850 lbs.

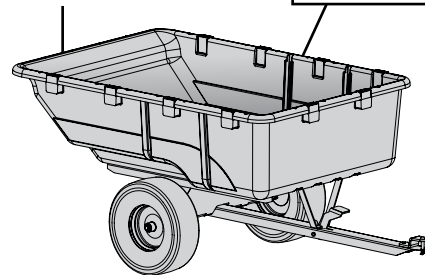

CAUTION: Avoid injury!

If additional weight is required when towing a cart, add weight at or forward of the rear wheels. Adding weight behind the rear wheels can affect machine steering.

Cart capacity will vary with weight of towing vehicle and operator. Add the weight of your towing vehicle to operator weight to find the maximum capacity of the cart.

With all cart usage, the cart load should be reduced when operating on slopes or slippery surfaces to maintain stability.

EXAMPLE: *If Towing Vehicle Weighs:* 500 lbs.
Add Your Weight: 200 lbs.
Combined weight Equals: 700 lbs.

To maintain stability using the cart in this example, you cannot safely carry more than 700 lbs. without first adding additional ballast to the towing vehicle.

USE AND CARE

DIY: DIRECTIONS FOR CUSTOM-BUILT SIDE STAKES

SAFETY NOTES:

- Read and follow the operating instructions for your machine and your Brinly Poly Cart.
- The stake side kit is for transporting light debris only, such as leaves, straw, and sticks.
- Do not load material higher than the top of the stake side rails.
- Do not use the stake side rails to increase the weight capacity of your cart. (*Refer to your cart manual for cart weight capacity.*)
- To minimize cart tip hazard, do not load heavy material like sand or firewood above the top of the cart bed.
- Distribute the load evenly for safe travel and for unloading the cart.
- Do not reach through the stake side rails with hands, arms, or head as these could become caught and cause injury.
- Do not let children or any untrained person operate the machine. Do not let anyone especially children ride on or in the cart during operation. Riders can be subject to injury from foreign objects and being thrown off the cart. Riders can also obstruct the operators view resulting in the machine being operated in an unsafe manner.
- Do not secure loads to the stake side rails. Securely anchor all loads to the cart bed to prevent them from shifting and breaking the stake side rails.
- Do not use the stake side rails as a ladder, platform, or table.
- When using the stake side rails be sure to use all three sides together. Do not use only one side or just two sides.
- Inspect wood for rot and fasteners for rust before use and replace rotted, rusted, or worn parts as needed.

SHOPPING LIST / MATERIALS NEEDED:

Ref.	Description:	Qty.	Ref.	Description:	Qty.
Long Pressure Treated Wood:			Hardware:		
1	1" x 2" x 13-1/2"	10	4	1/4"-20 x 2" Pan Head Bolt	20
2	1" x 4" x 39"	2	5	1/4" Fender Washer	40
3	1" x 4" x 55-3/4"	4	6	1/4"-20 Nylon Locking Hex Nut	20
			7	#10 x 1" Wood Screw	10

Material Notes:

- It is recommended that all fasteners are plated grade 5.
- All material listed can be purchased at a standard hardware store.

Step 1.

Drill two 9/32" holes in each 13-1/2" side stake (1), located as illustrated here.

Sand down the 3/4" thickness of each side stake (1) for a slip fit into the cart pocket to reduce the risk of cracking the pocket at rail installation.

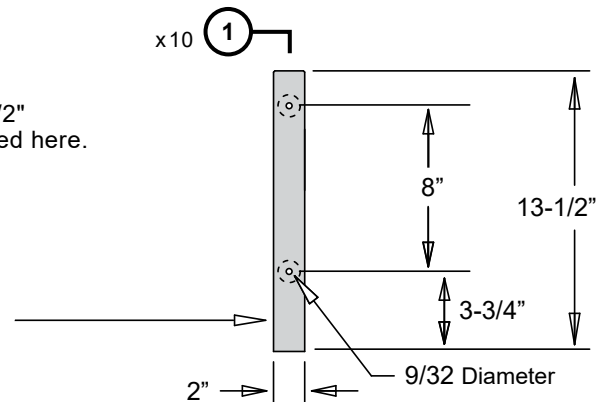

Step 2.

Drill two 9/32" holes in each of the 39" wood panels for part (2). Holes must be aligned as illustrated here:

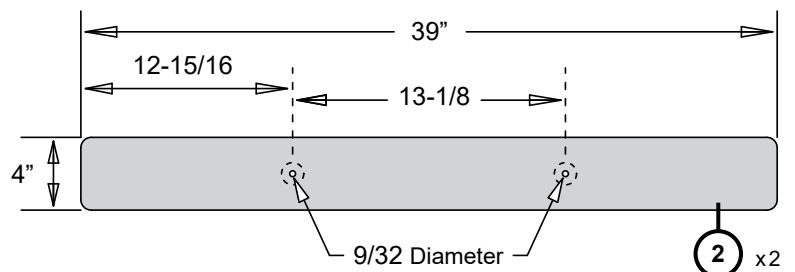

USE AND CARE

DIY: DIRECTIONS FOR CUSTOM-BUILT SIDE STAKES, *Continued*

Step 3.

Drill four 9/32" holes in the 55-3/4" wood panels for part (3).
Holes must be aligned as illustrated here:

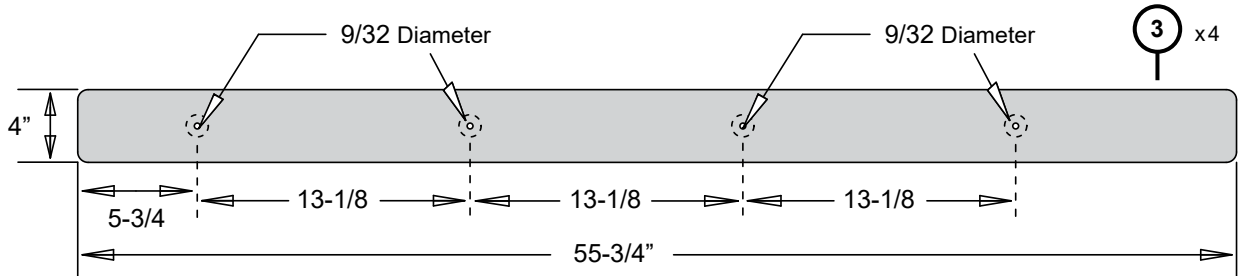

Step 4.

Building the Stake Side Rails

Assemble the side stakes as illustrated here.

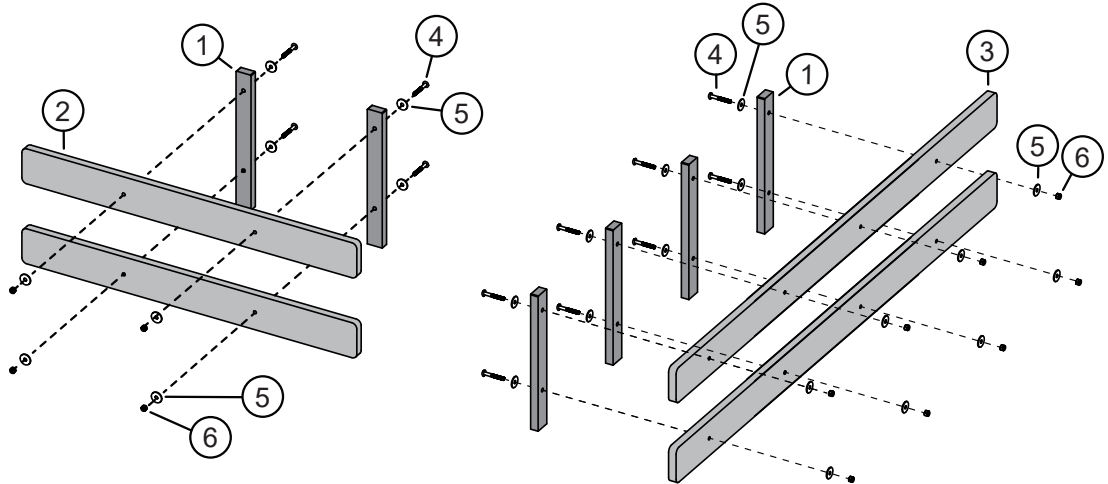

Step 5.

Drilling Location (if needed)

Some cart pockets may have a hole provided at the base of each pocket **OR** a 1/8" diameter hole from the outside of the cart pocket into the Stake Side Rail.

NOTE: The hole must be centered right to left on the cart pocket and 1-3/4" up from the pocket bottom.

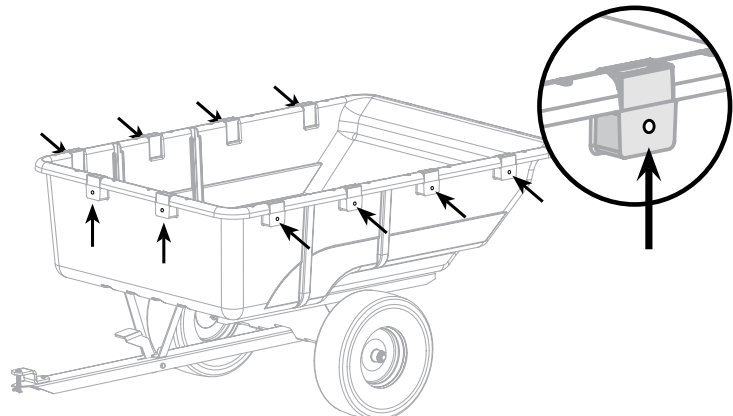

USE AND CARE

DIY: DIRECTIONS FOR CUSTOM-BUILT SIDE STAKES, *Continued*

Step 6.

Securing the Stake Side Rails

Slide the assembled stake rails in place, as illustrated here.

Using the existing or previously drilled holes, secure each rail to your cart with a #10 x 1" wood screw (7).

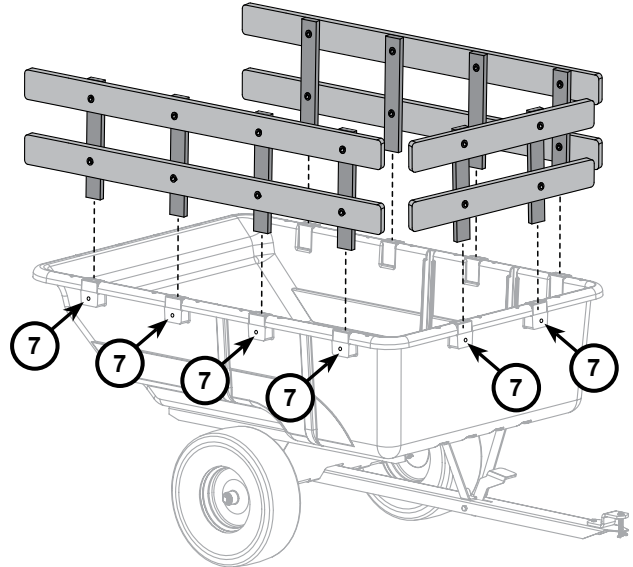

OPTIONAL ACCESSORIES

MAGNETIC HITCH PIN MHPK-12BH

This quick-connect magnetic hitch pin can replace a regular cotter pin for an extra-strong, convenient upgrade.

- Diameter: 1/2"
- Pin Length: 3"

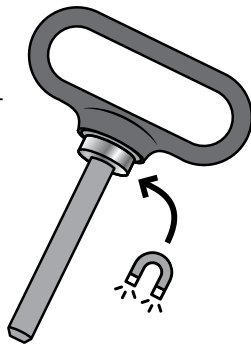

NOTE: Additional accessories are also available in our Parts Store online: shop.brinly.com

SERVICE

QUALITY CONTINUES WITH QUALITY SERVICE

If you have installation questions, are missing parts or need replacement parts, don't go back to the store! Please find your product serial number and model number, then contact our Customer Service department:



In North America and Canada
call Toll-Free: **877-728-8224**



Chat online: www.brinly.com



Email: customerservice@brinly.com

ONLINE: BRINLY.COM

Additional info and videos are available on our website. Please visit the URL above OR scan this QR code.



PCT-17BH





MANUFACTURER'S LIMITED WARRANTY
CARTS

The limited warranty set forth below is given by Brinly-Hardy Company with respect to new merchandise purchased and used in the United States (its possessions and territories) and Canada.

Brinly-Hardy Company warrants the products listed below against defects in material and workmanship, and will at its option, repair or replace, free of charge, any part found to be defective in materials or workmanship. This limited warranty shall only apply if this product has been assembled, operated, and maintained in accordance with the Operator's manual furnished with the product, and has not been subject to misuse, abuse, commercial use, neglect, accident, improper maintenance, alteration, vandalism, theft, fire, water, or damage because of other peril or natural disaster.

Parts found to be defective within the warranty period will be replaced at our expense. Our obligation under this warranty is expressly limited to the replacement or repair, at our option, of parts found to be defective in material and workmanship.

HOW TO OBTAIN SERVICE: Warranty parts replacements are available, only with proof of purchase, through our Customer Service Department. Call 877-728-8224.

This limited warranty does not provide coverage in the following cases:

- a. Routine maintenance items such as lubricants & filters.
- b. Normal deterioration of exterior finish due to use or exposure.
- c. Transportation and/or labor charges.
- d. The warranty does not include commercial and/or rental use.

No implied warranty, including any implied warranty of merchantability of fitness for a particular purpose, applies after the applicable period of express written warranty above as to the part as identified below. No other express warranty whether written or oral, except as mentioned above, given by any person or entity, including a dealer or retailer, with respect to any product, shall bind Brinly-Hardy Co. During the period of the warranty, the exclusive remedy is repair or replacement of the product as set forth above.

The provisions as set forth in this warranty provide the sole and exclusive remedy arising from the sale. Brinly-Hardy Co. shall not be liable for incidental or consequential loss or damage including, without limitation, expenses incurred for substitute or replacement lawn care services or for rental expenses to temporarily replace a warranted product.

Some states do not allow the exclusion or limitation of incidental or consequential damages, or limitations on how long an implied warranty lasts, so the above exclusions or limitations may not apply to you.

During the warranty period, the exclusive remedy is replacement of the part. In no event shall recovery of any kind be greater than the amount of the purchase price of the product sold. Alteration of safety features of the product shall void this warranty. You assume the risk and liability for loss, damage, or injury to you and your property and/or to others and their property arising out of the misuse or inability

to use this product. **NOTE:** *This limited warranty shall not extend to anyone other than the original purchaser or to the person for whom it was purchased as a gift.*

This limited warranty lasts as long you own your product purchased from an authorized seller. **Coverage terminates once you sell or otherwise transfer the product.**

This limited warranty does not cover any purchaser other than the original purchaser of the product, nor does it cover any product purchased from an unauthorized third-party. If you are not the original purchaser of this product, your product is not covered by our limited warranty and you take the product "AS IS" and "with all faults."

We may require proof of purchase from you demonstrating that you are the original purchaser of the product, purchased the product from an authorized dealer, and are eligible to make a valid claim under this limited warranty.

How state law relates to this warranty: This limited warranty gives you specific legal rights, and you may also have other rights which vary from state to state.

IMPORTANT:

The Warranty period stated below begins with the proof of purchase. Without the proof of purchase, the Warranty period begins from the date of manufacture determined by the serial number manufacturing date. All parts replaced under warranty will be considered as part of the original product, and any warranty on the replaced parts will expire coincident with the original product warranty.

WARRANTY PERIOD:

See applicable parts listed below.

Standard / Residential Use:

- Steel Frame & Steel Parts 2 years
- Cart Bed 2 years
- Tires / Wheels 90 days

All other normal wear parts or component failures will be covered on this product for a period of 90 days.

If this equipment is being used in a commercial application and / or for multiple properties, the warranty is 90 days after purchase for all parts.