

W Walker[®]
Edison
furniture company

Item # : OR4RWSC
Assembly Instructions



Please visit our website for the most current instructions, assembly tips, report damage, or request parts. www.walkeredison.com

Revised 01/2018

General Assembly Guidelines

- I. Ensure that all parts and hardware are available before beginning assembly.
- II. Follow each step carefully to ensure the proper assembly of this product.
- III. Two people are recommended for ease in the assembly of this product.
- IV. The three main types of hardware used to assemble this product are : wood dowels , screws and bolts.
- V. The provided glue is to secure wood dowels in place . When first inserting dowels , locate the appropriate hole for the dowel , place a small amount of glue in the hole and insert the dowel . Wipe away excess glue immediately.

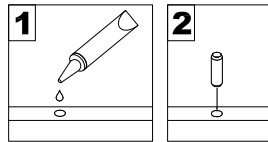

In future assembly steps when dowels are necessary to attach assembly parts together , place a small amount of glue on the end of the dowel before attaching parts together . Wipe away excess glue immediately.

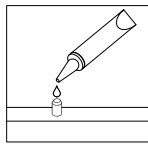

- VI. A Phillips head screwdriver is required for the assembly of this product .

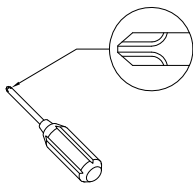

- VII. Power tools should not be used to assemble this product .

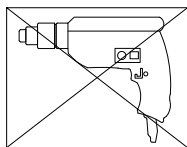

Parts List

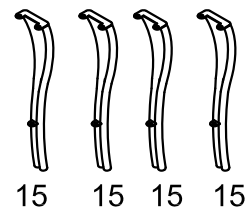
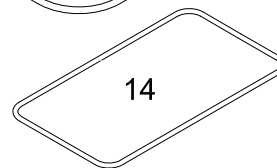
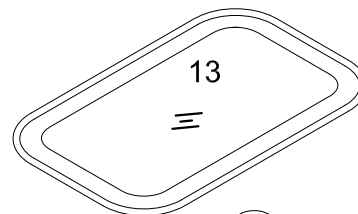
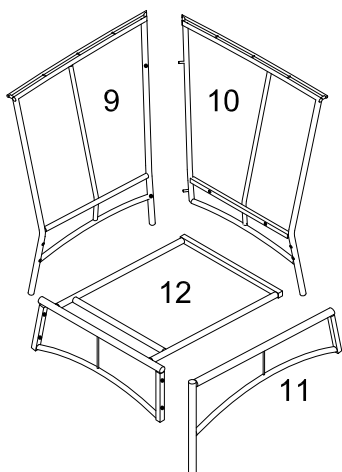
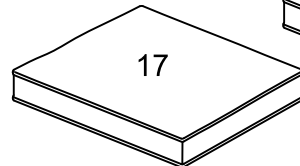
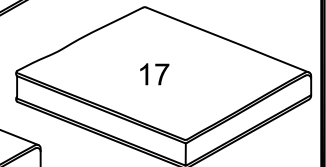
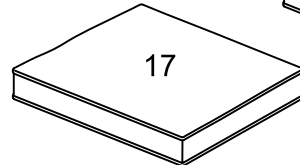
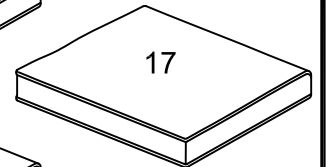
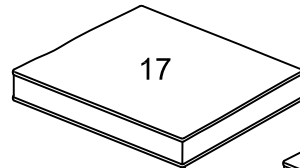
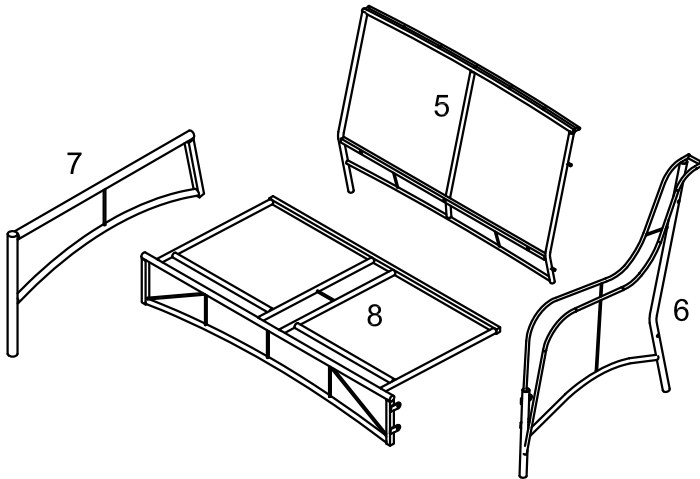
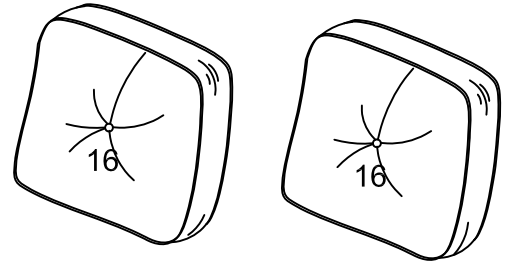
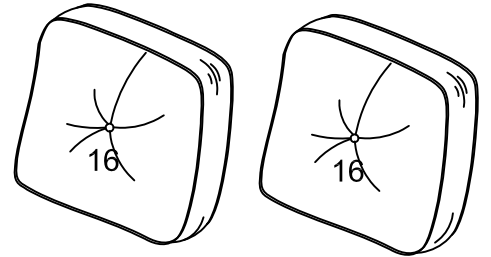
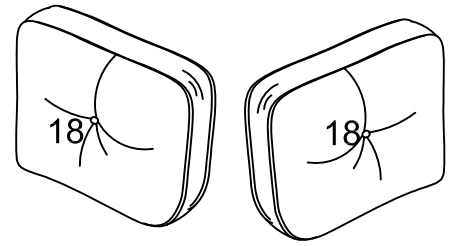
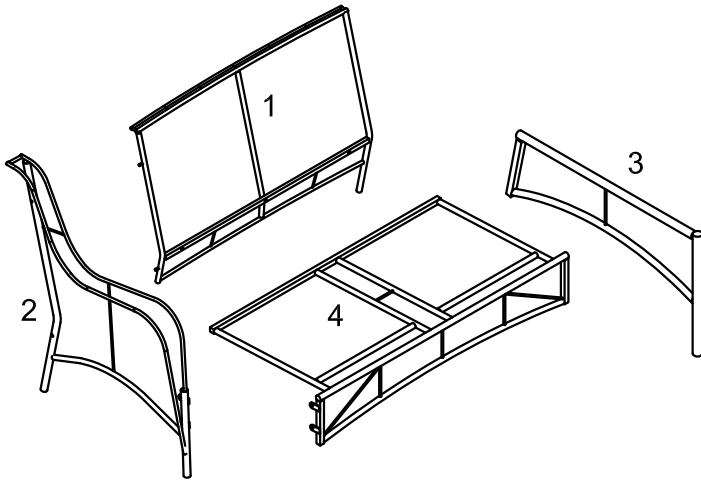

Hardware List

A		Ø6x15mm	Bolt	22 pcs
B		Ø6x35mm	Bolt	22 pcs
C			Washer	44 pcs
D		M4	Wrench	1 pc

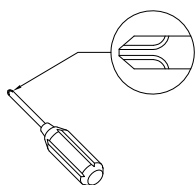

Philips head screwdriver required for assembly
(not included)

*The hardware quantities listed above are required for proper assembly.
Some extra hardware may also have been included.*

Step 1

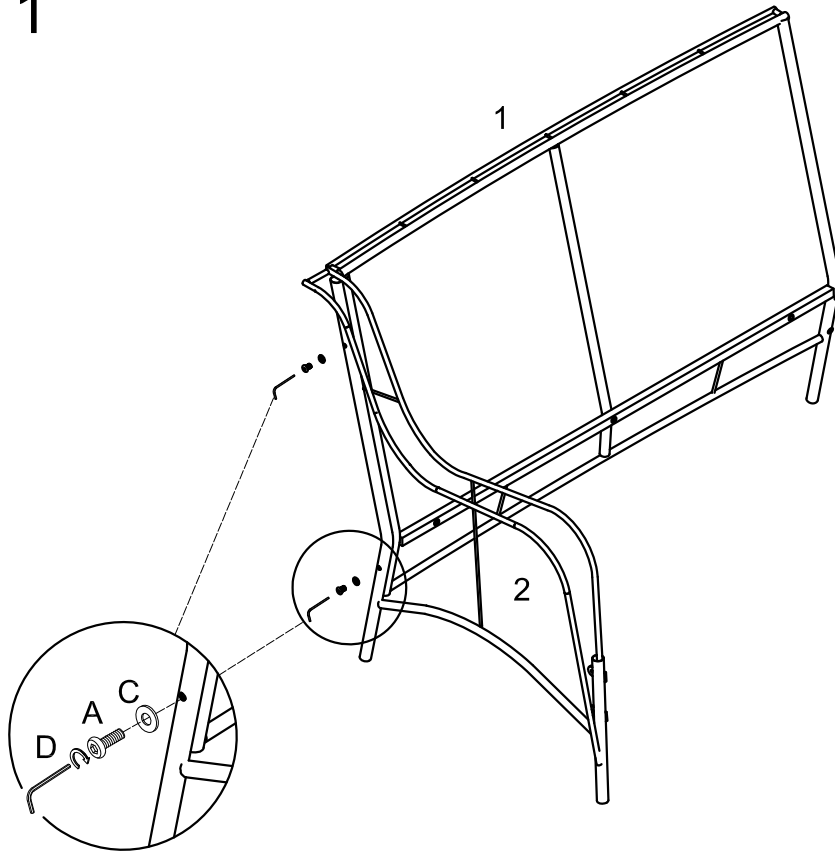

Use wrench (D) to secure love seat side frame (2) to love seat back frame (1) with bolt (A) and washer (C).

Step 2

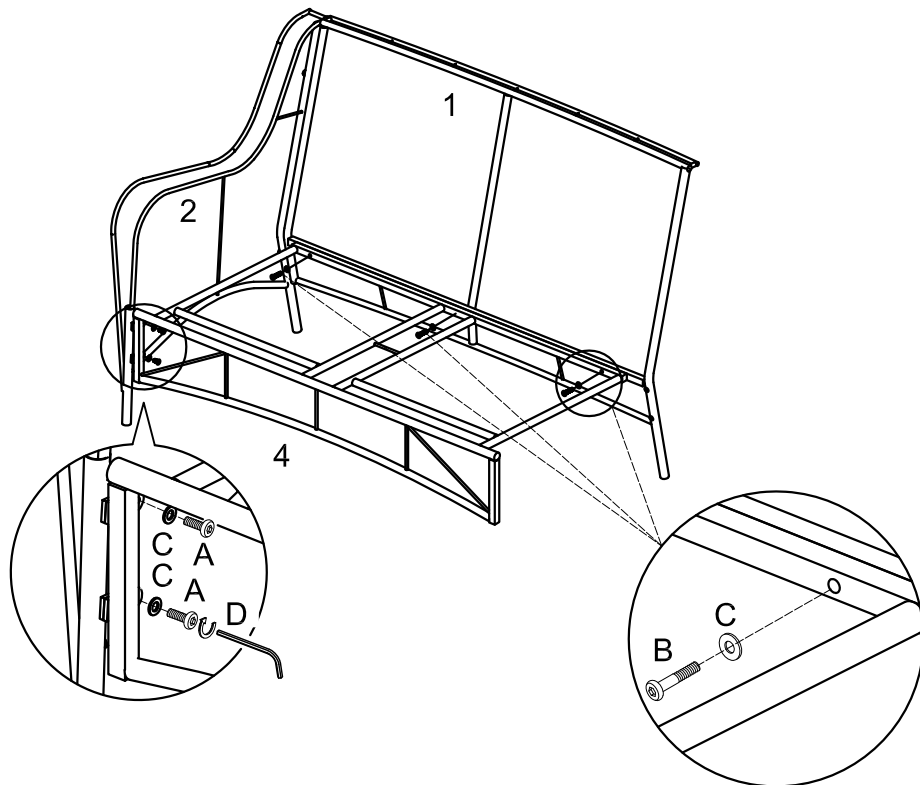

Use wrench (D) to secure love seat's seat frame (4) to love seat side frame (2) with bolt (A) and washer (C), and secure love seat's seat frame (4) to love seat back frame (1) with bolt (B) and washer (C).

Step 3

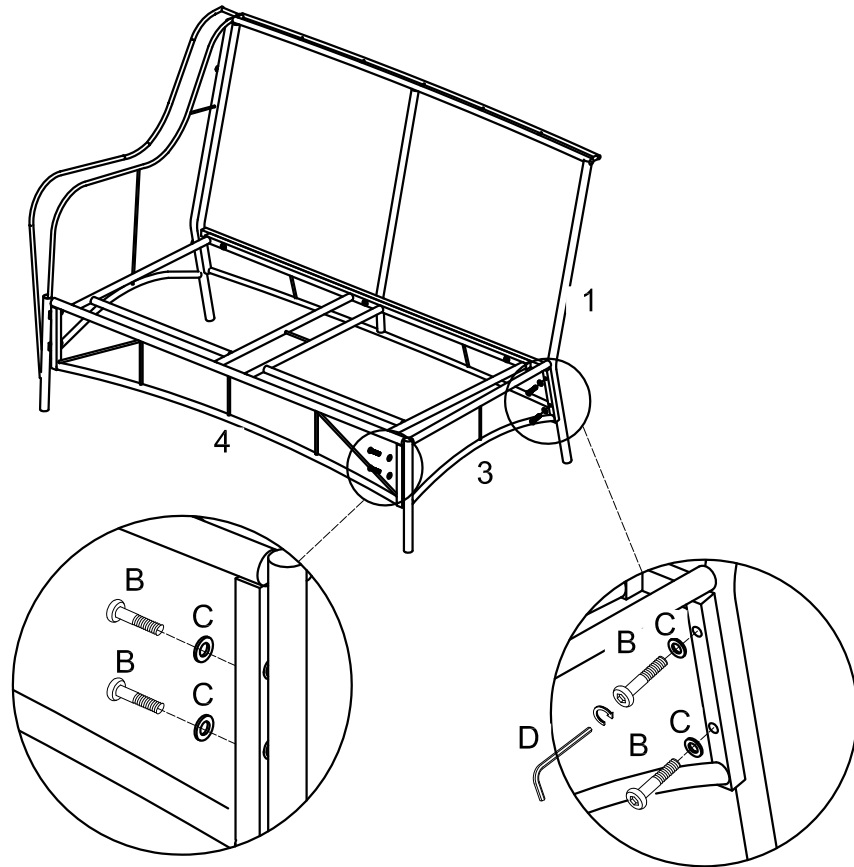

Use wrench (D) to secure love seat side frame (3) to love seat's seat frame (4) and love seat back frame (1) with bolt (B) and washer (C).

Step 4

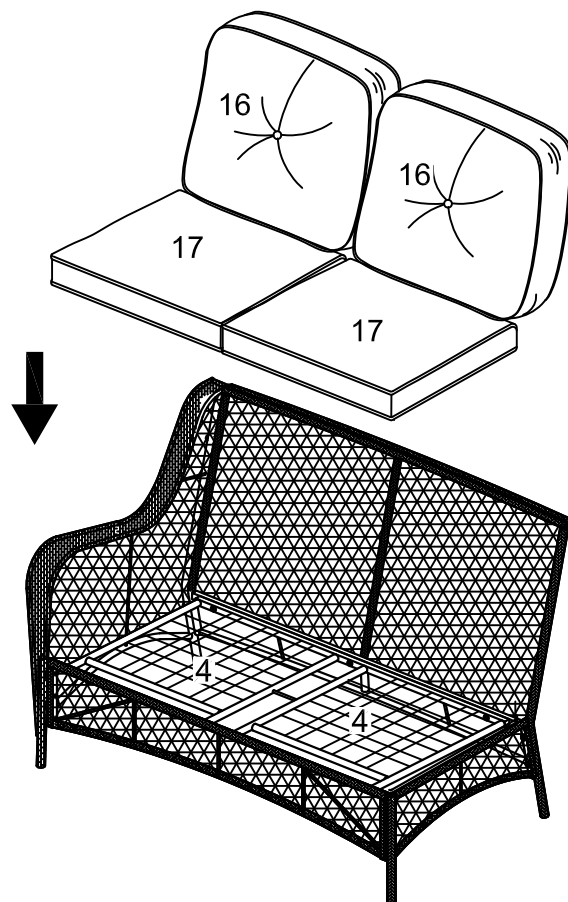

Place cushion (16,17) on top of love seat's seat frame (4).

Step 5

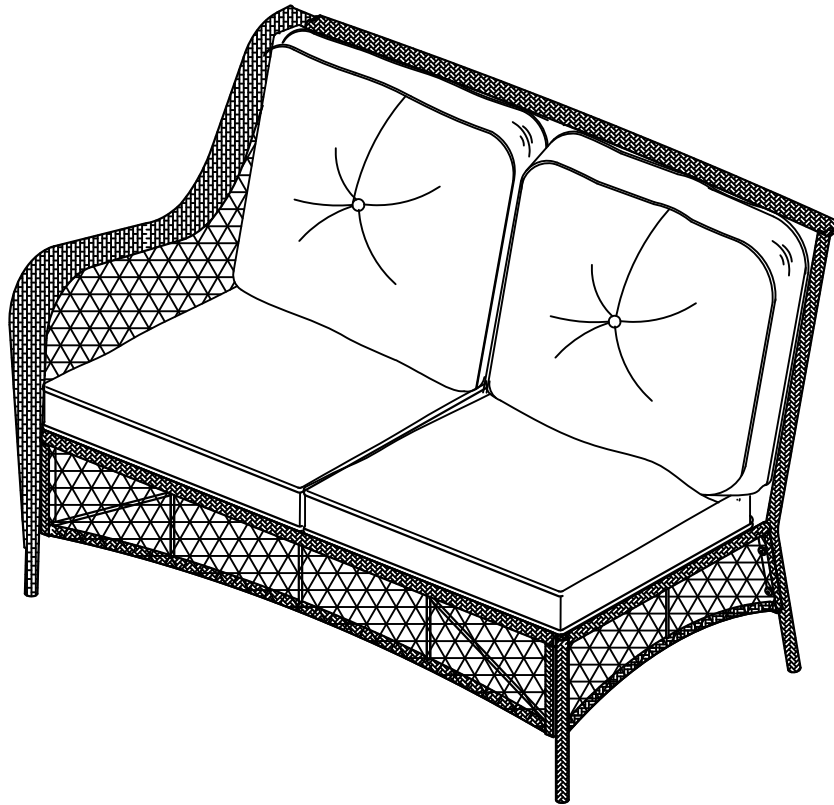

Left side of Love Seat assembly complete.

Step 6

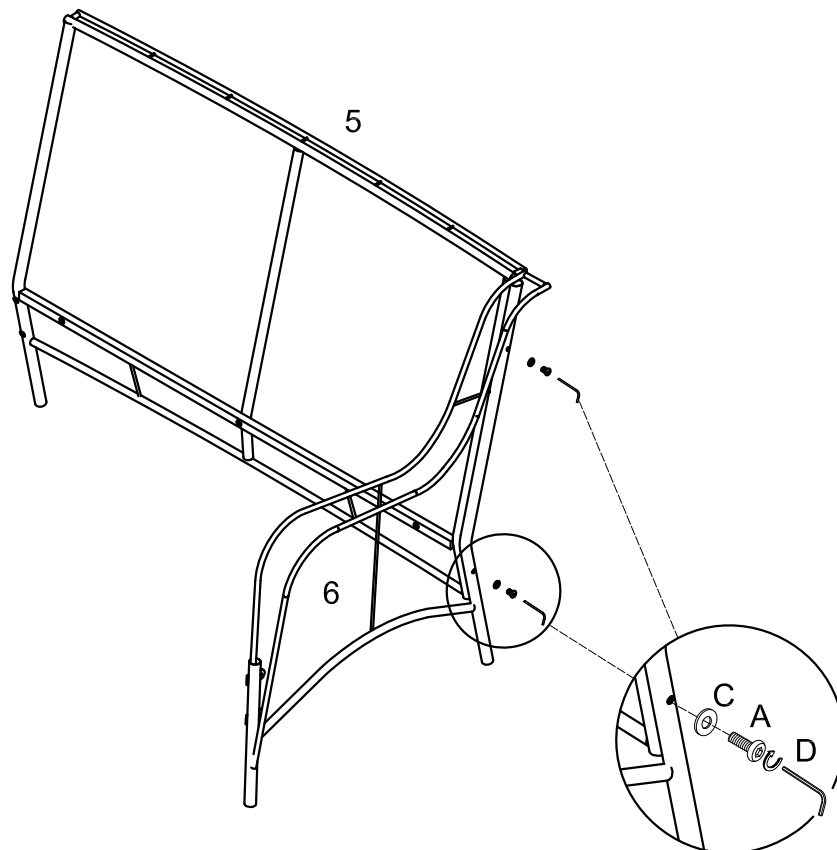

Use wrench (D) to secure love seat side frame (6) to love seat back frame (5) with bolt (A) and washer (C).

Step 7

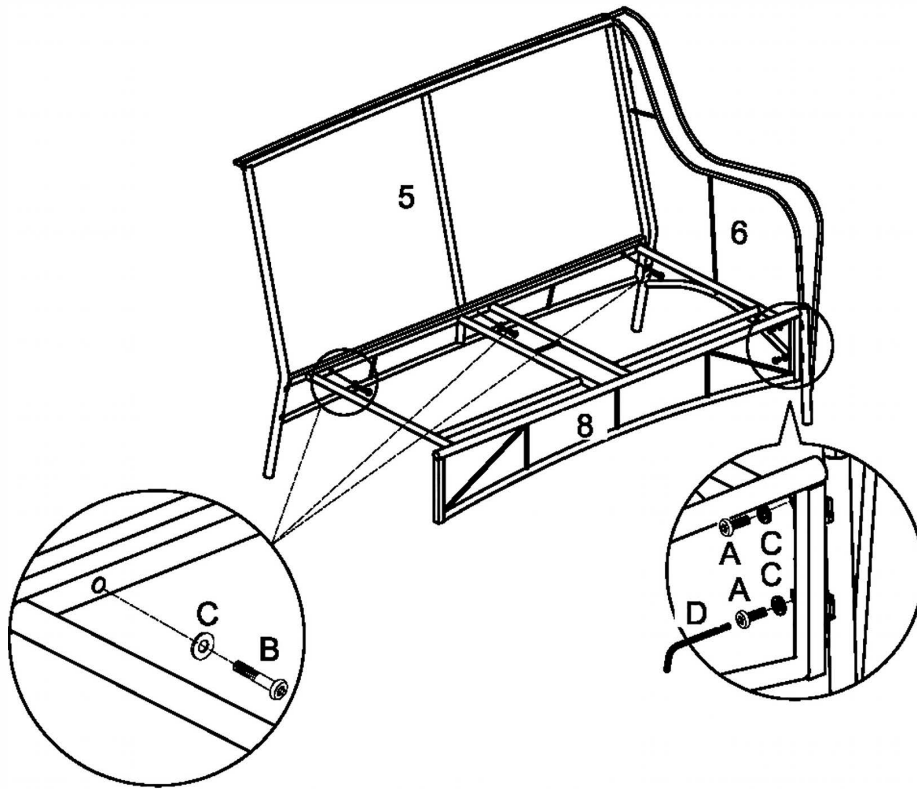

Use wrench (D) to secure love seat's seat frame (8) to love seat side frame (6) with bolt (A) and washer (C), and secure love seat's seat frame (8) to love seat back frame (5) with bolt (B) and washer (C).

Step 8

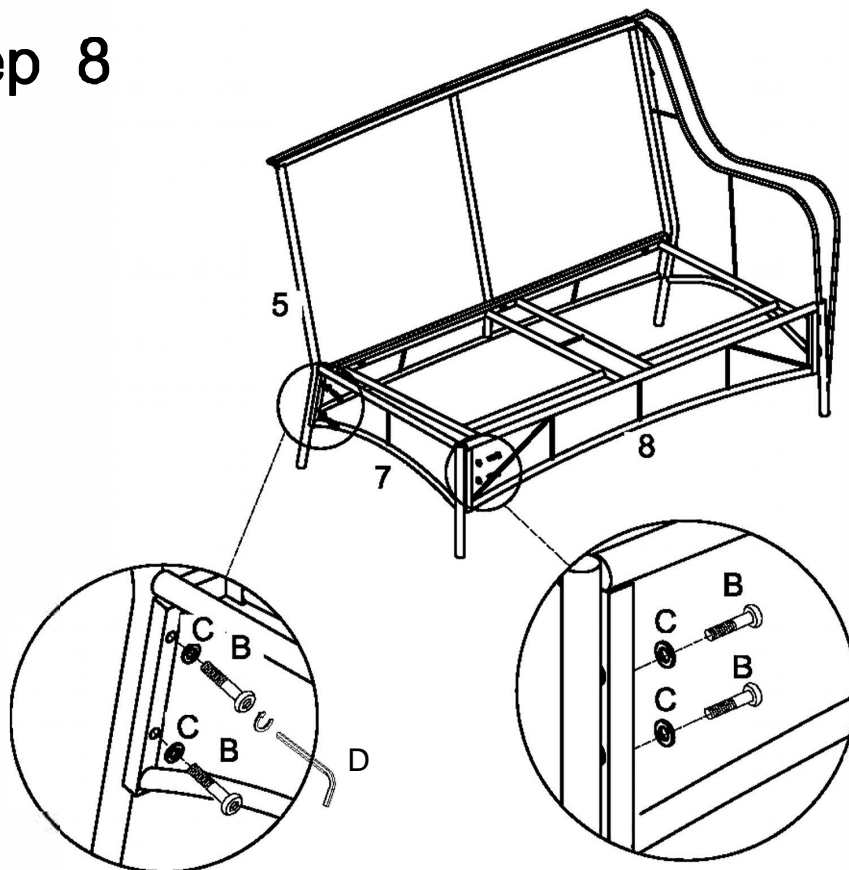

Use wrench (D) to secure love seat side frame (7) to love seat's seat frame (8) and love seat back frame (5) with bolt (B) and washer (C).

Step 9

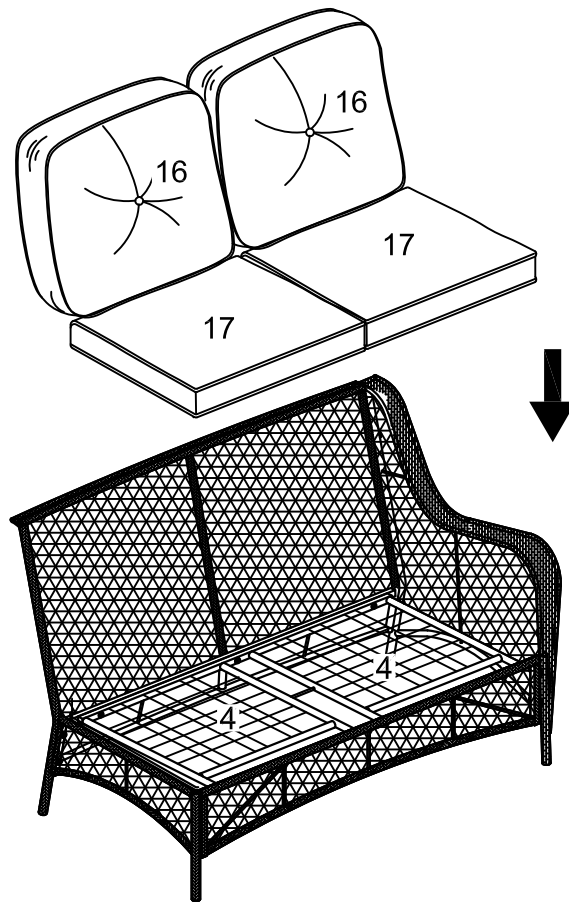

Place cushion (16,17) on top of love seat's seat frame (8).

Step 10

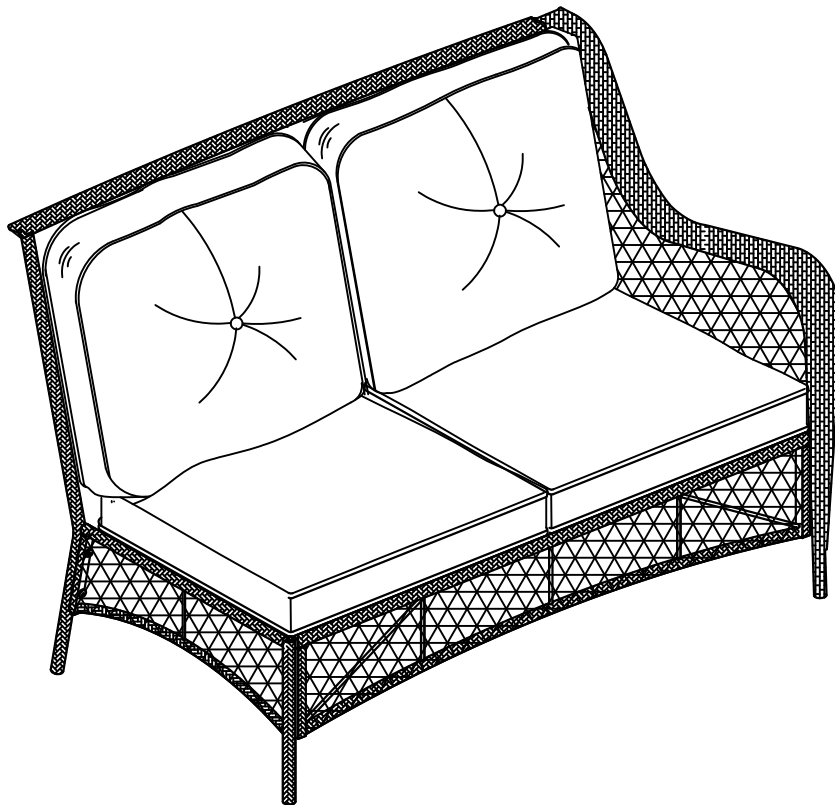

Right side of Love Seat assembly complete.

Step 11

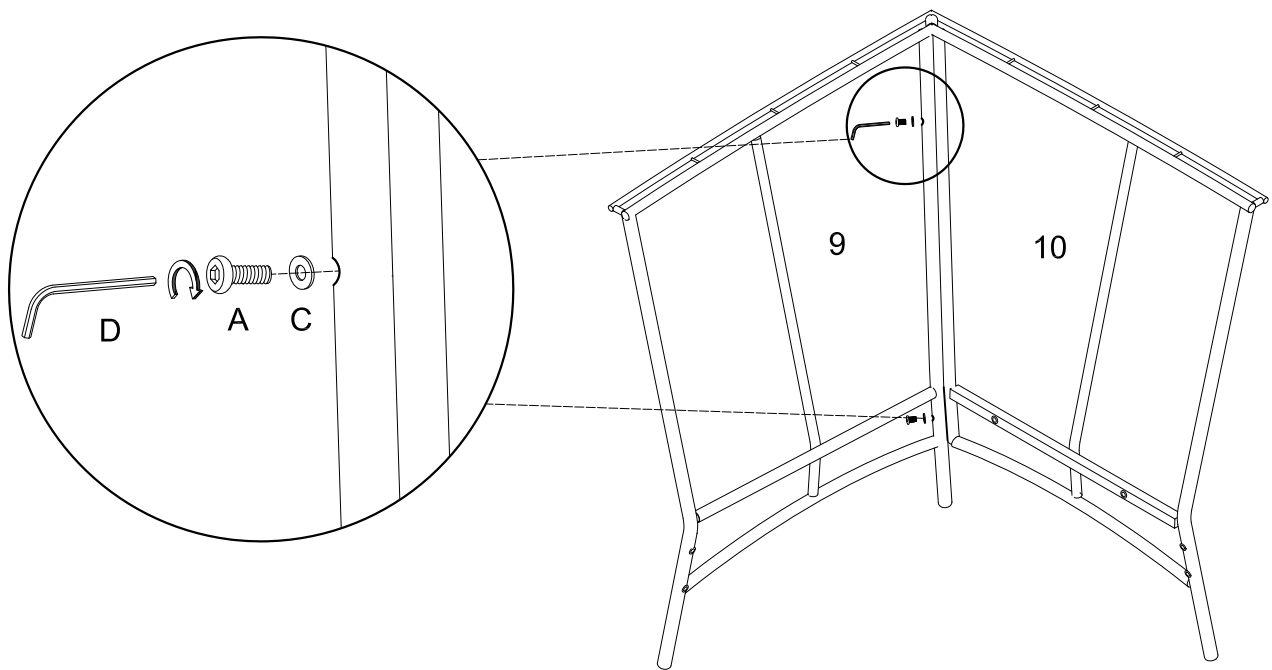

Use wrench (D) to secure corner seat back frame (9,10) together with bolt (A) and washer (C).

Step 12

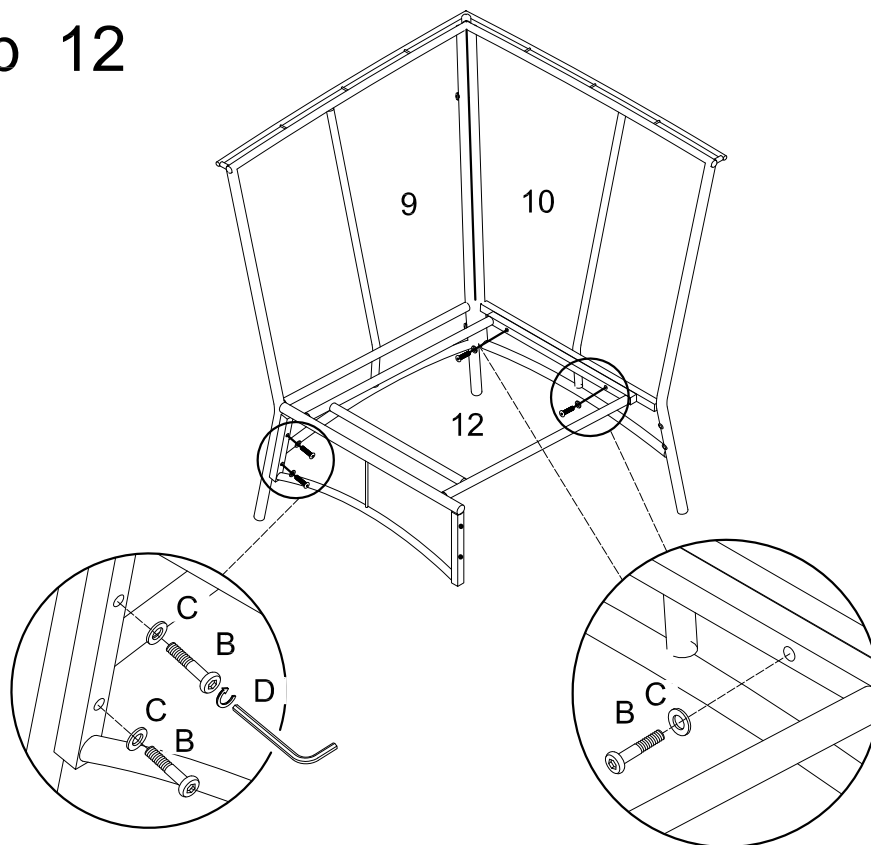

Use wrench (D) to secure corner seat's seat frame (12) to corner seat back frame (9,10) with bolt (B) and washer (C).

Step 13

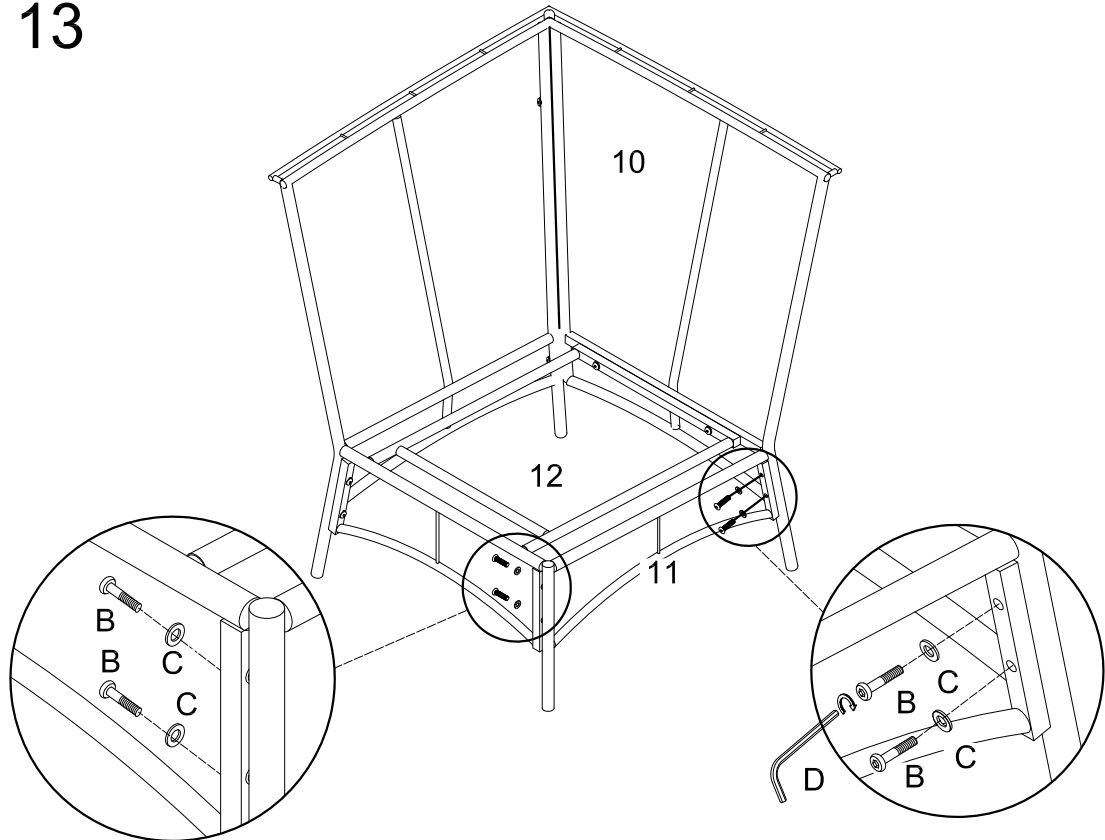

Use wrench (D) to secure corner seat side frame (11) to corner seat's seat frame (12) and corner seat back frame (10) with bolt (B) and washer (C).

Step 14

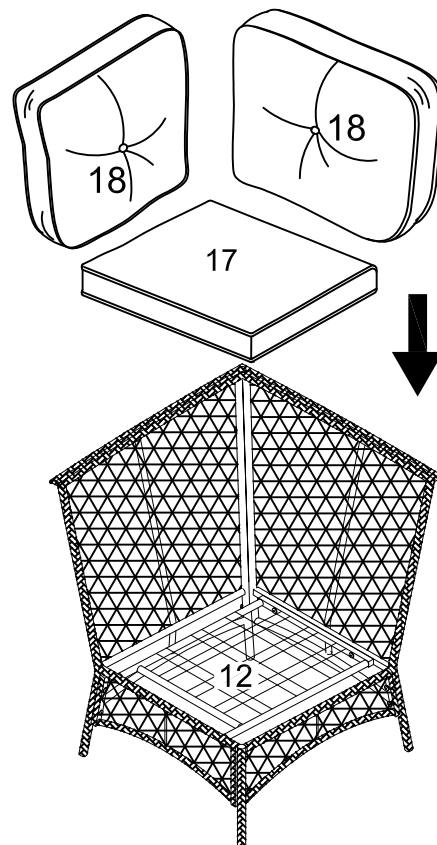

Place corner cushions (17,18) on top of corner seat's seat frame (12).

Step 15

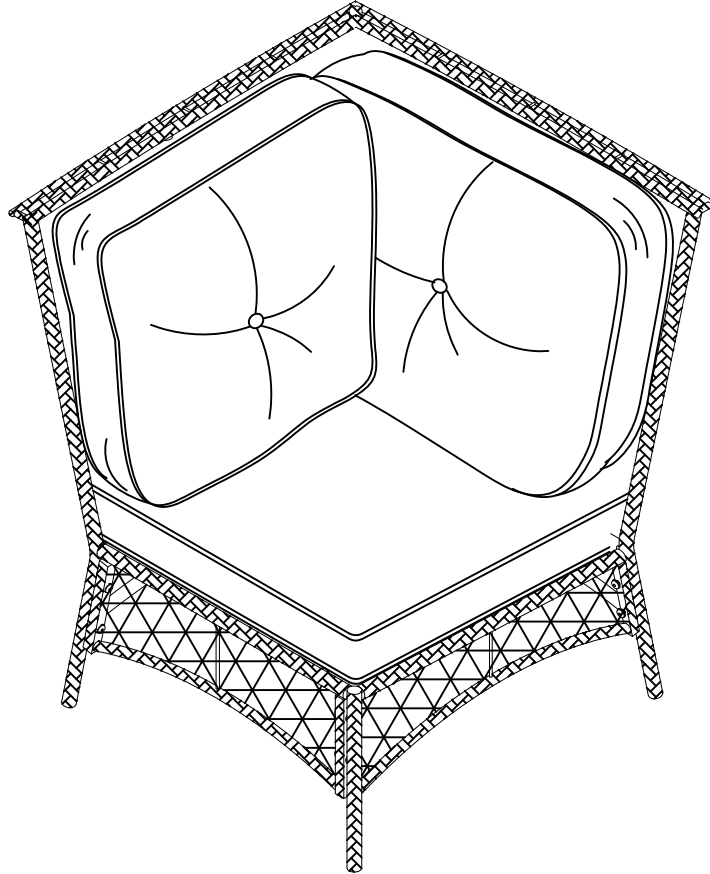

Corner seat assembly finished.

Step 16

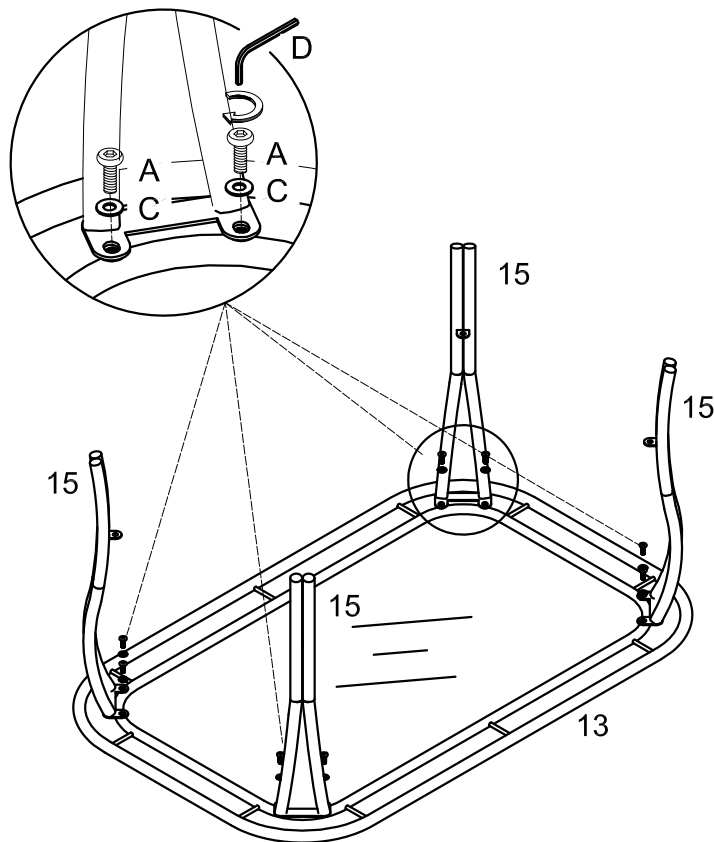

Use wrench (D) to secure leg (15) to table top (13) with bolt (A) and washer (C).

Step 17

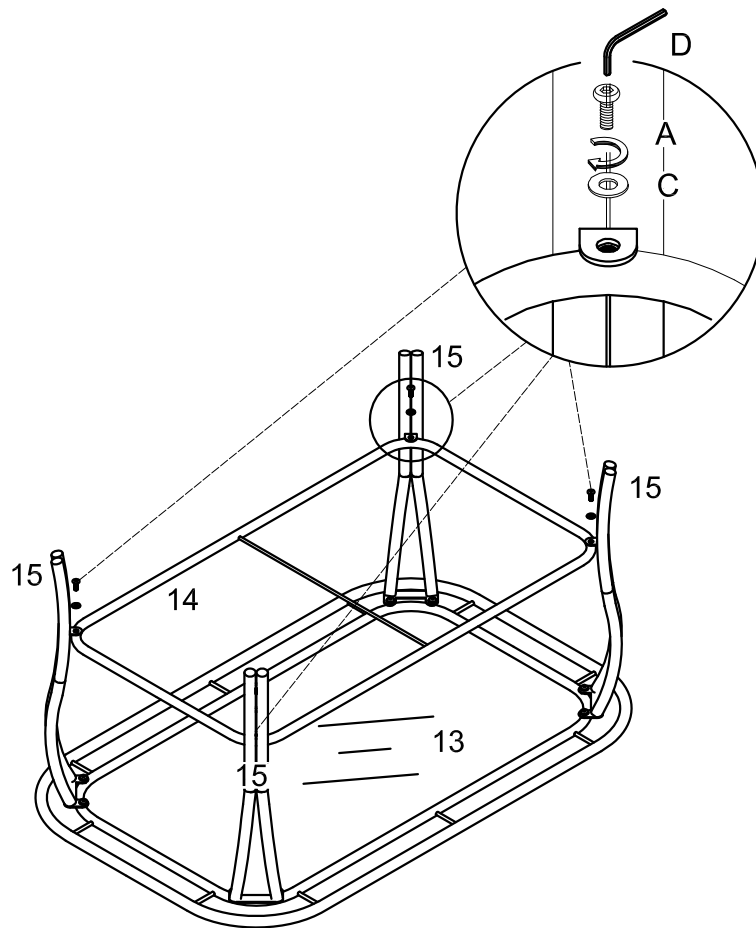

Use wrench (D) to secure shelf (14) to leg (15) with bolt (A) and washer (C).

Step 18

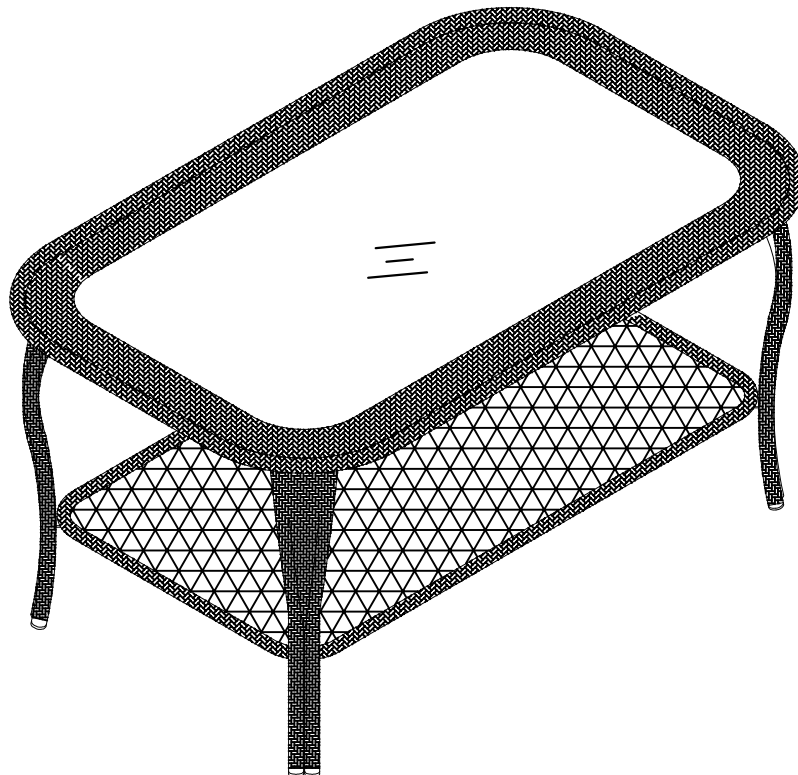

Table assembly finished.

Step 19



Final Assembly