

G6000-11 Swivel Chair

IMPORTANT NOTE

Carefully remove all the parts from the carton and put them individually on a soft cloth to prevent damage to the parts.

We have taken great care in the design of this product and request that you carefully and accurately follow our assembly instructions to ensure proper set-up.

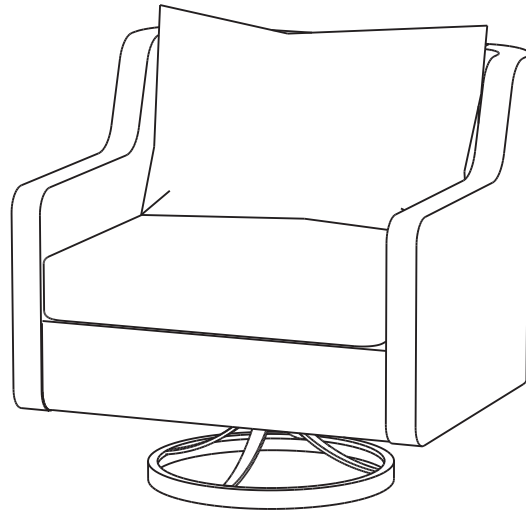

Part List

Assembly Instruction 1/5

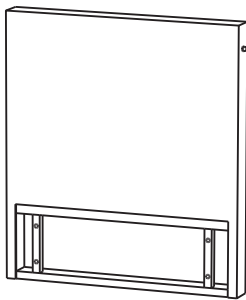

A.
Back
1 pc.

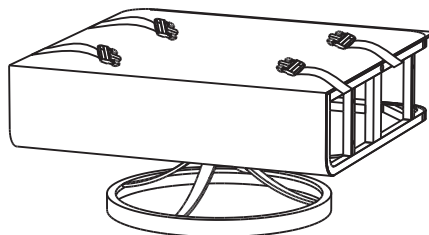

B.
Base Frame
1 pc.

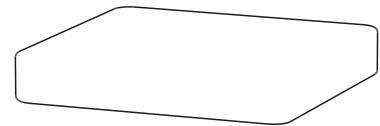

E.
Seat Cushion
1 pc.

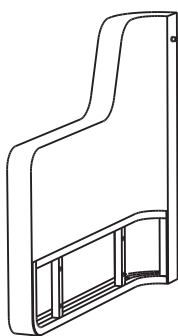

C.
Left Arm
1 pc.

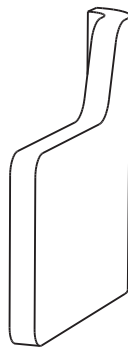

D.
Right Arm
1 pc.

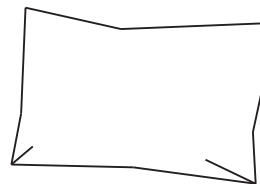

F.
Back Cushion
1 pc.

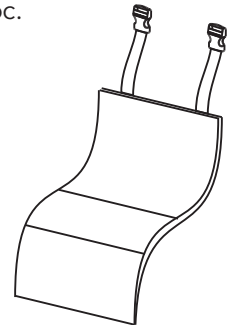

G.
Pouch
1 pc.

Hardware List

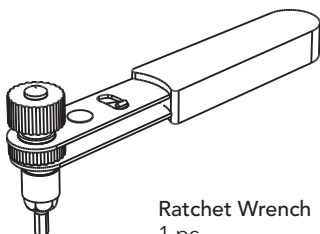

Ratchet Wrench
1 pc.

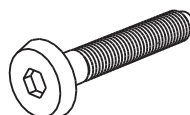

1
M6x50
Bolt
12 pcs.



2
M6 x Ø16
Flat Washer
12 pcs.

IMPORTANT

- Use a soft cloth between these parts and the floor.
- Do not use power tools above 8 volts to assemble.
- Do not tighten all the bolts until each part is properly assembled.
- Keep Ratchet Wrench as the bolts may need to be tightened in the future.

STEP 1

Attach Base Frame (B) to Back (A) with Bolts (1) and Flat Washers (2) tightening Bolts (1) by using Ratchet Wrench.

Note: Ratchet Wrench button is in tighten position. (See Figures 1 and 2)

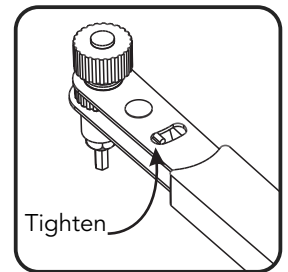
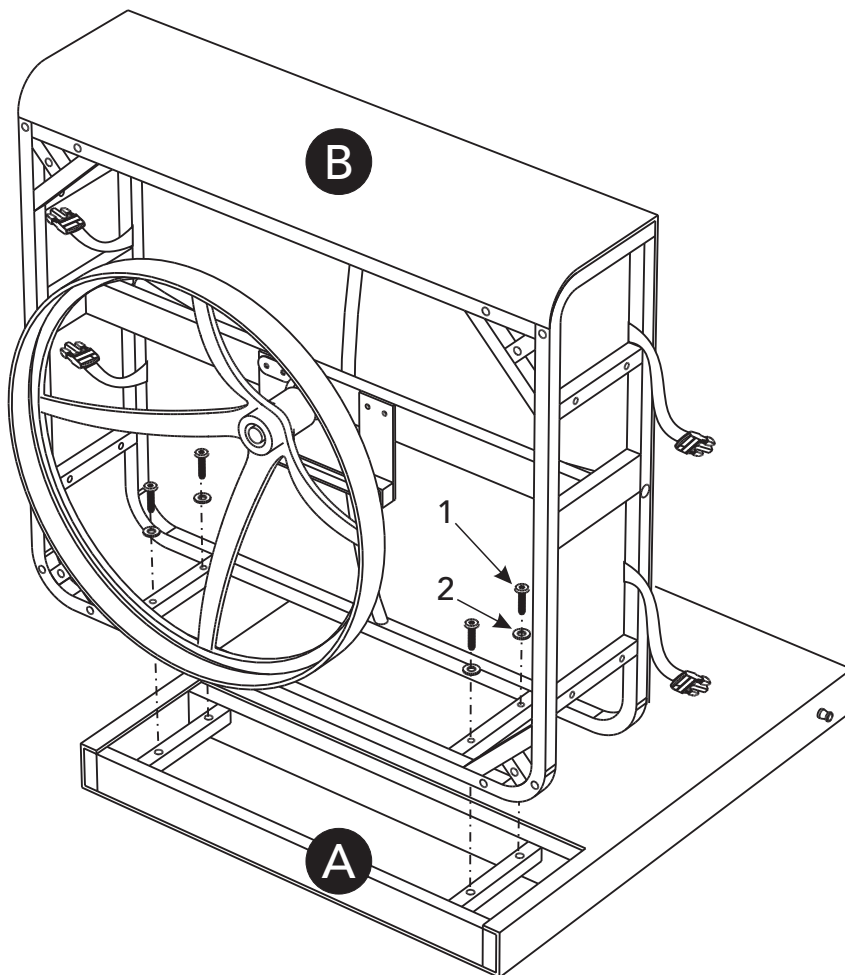

Figure 1

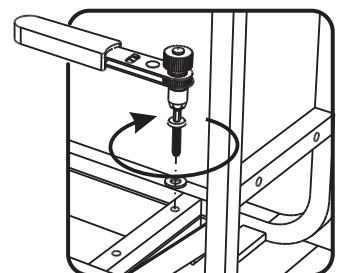

Figure 2

STEP 2

Attach Left Arm (C) to unit by inserting hook in Left Arm (C) into hole in Back (A). (See Figure 3)

Insert Bolts (1) and Flat Washers (2) into pre-drilled holes, then tighten.

Note: Please Pull the Tabs out before attach the Left Arm (C).

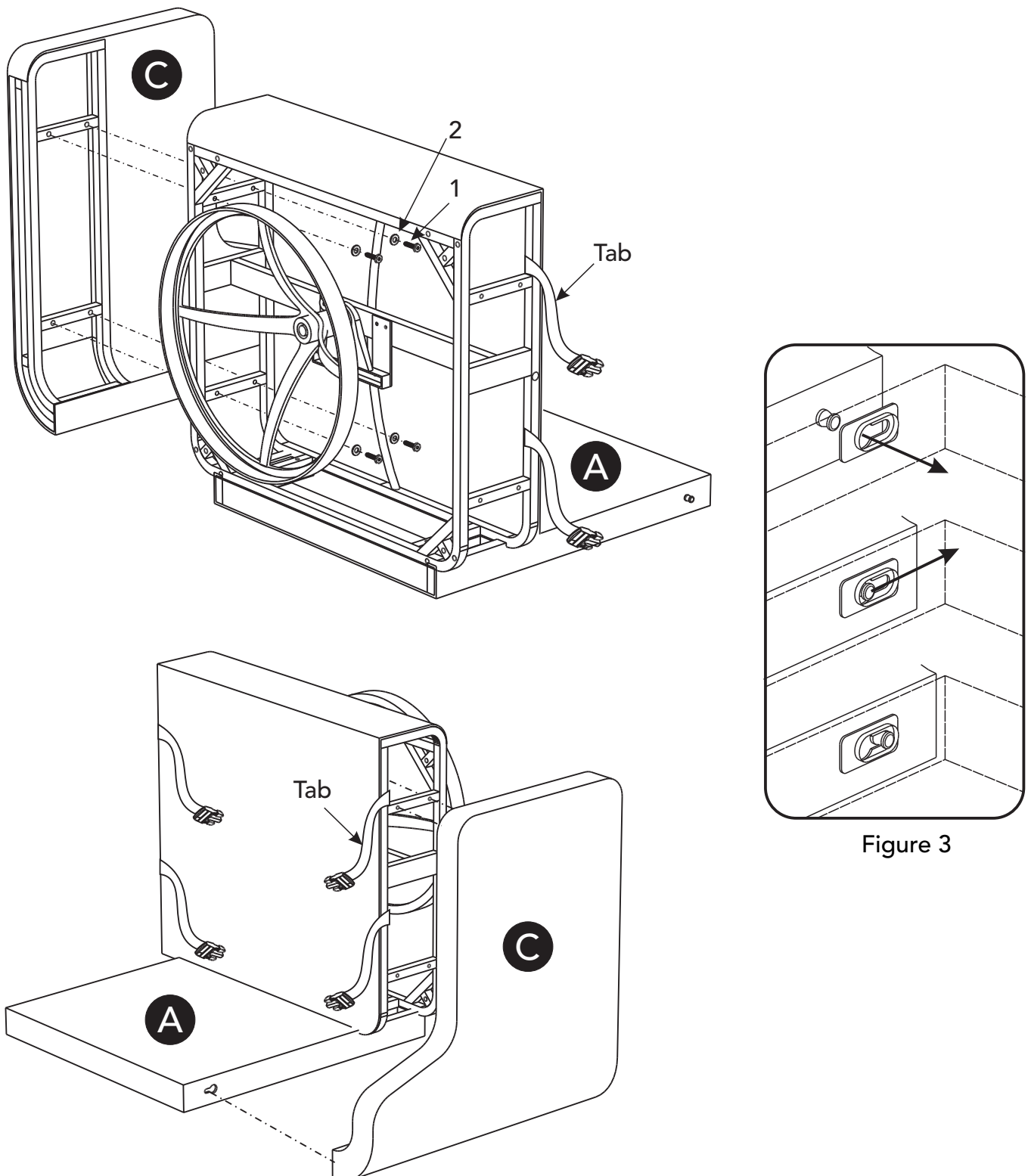

Figure 3

STEP 3

Attach Right Arm (D) to unit by inserting hook in Back (A) into hole in Right Arm (D).

Insert Bolts (1) and Flat Washers (2) into pre-drilled holes, then tighten.

Note: Please Pull the Tabs out before attach the Right Arm (D).

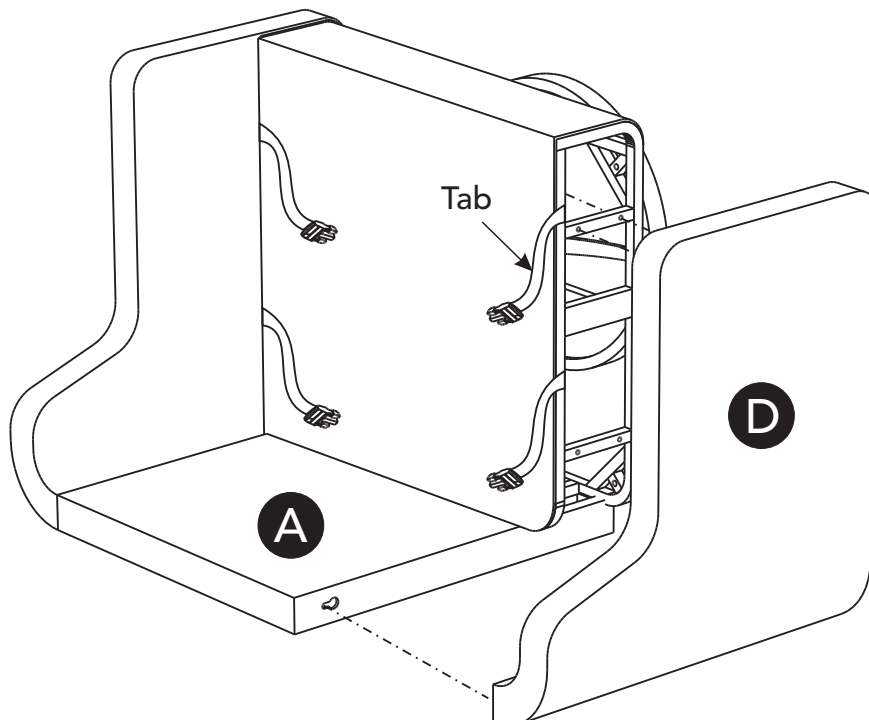
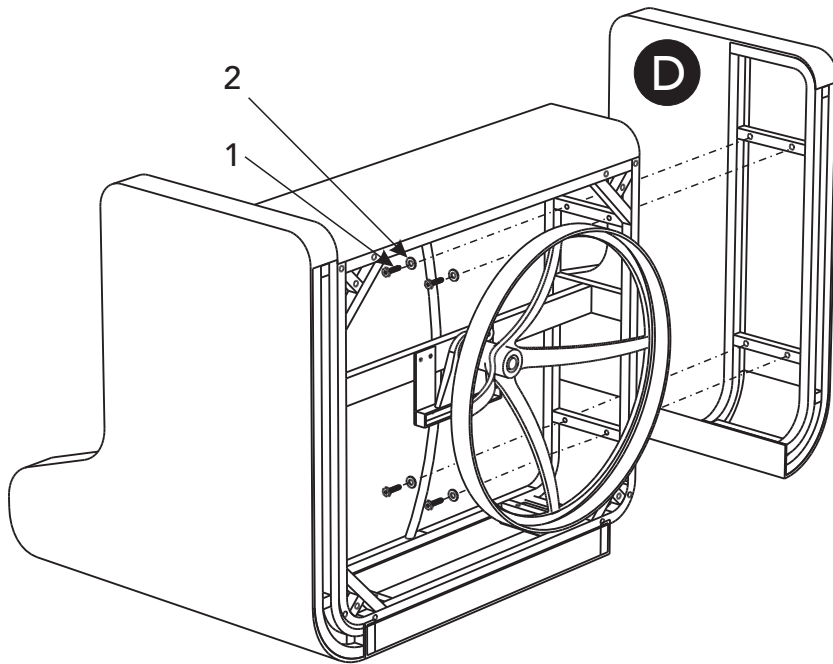

STEP 4

Turn unit to its upright position.

Place Seat Cushion (E) and Back Cushion (F) into position.

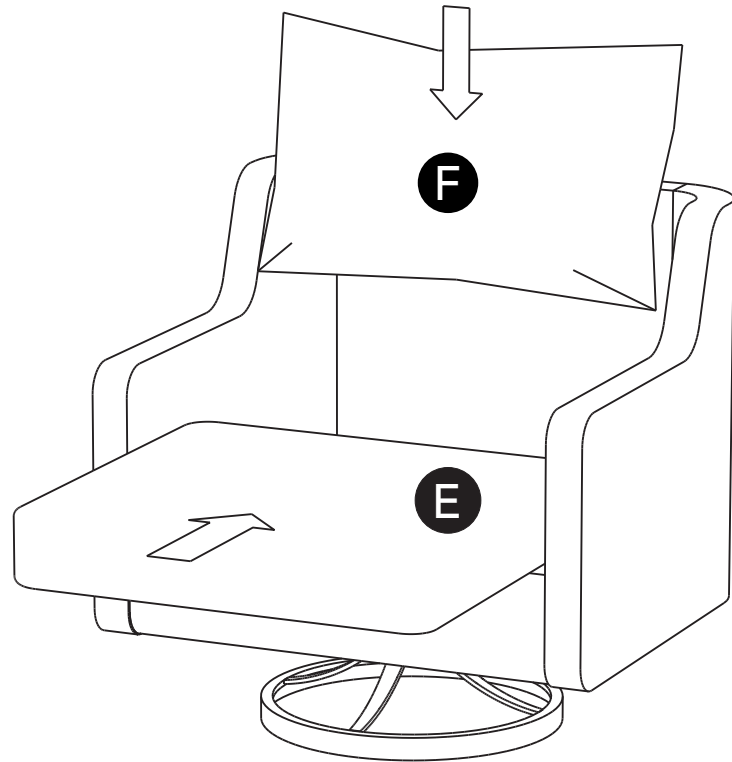

STEP 5

Place Pouch (G) over left or right arm by attaching Tabs on Pouch (G) to Tabs on Base Frame (B). (See Figure 4)

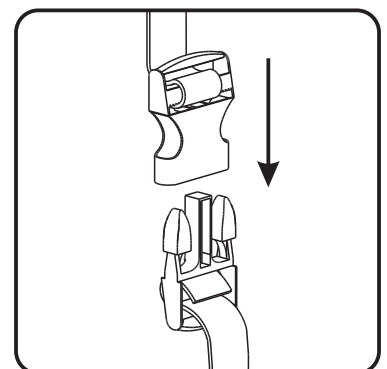
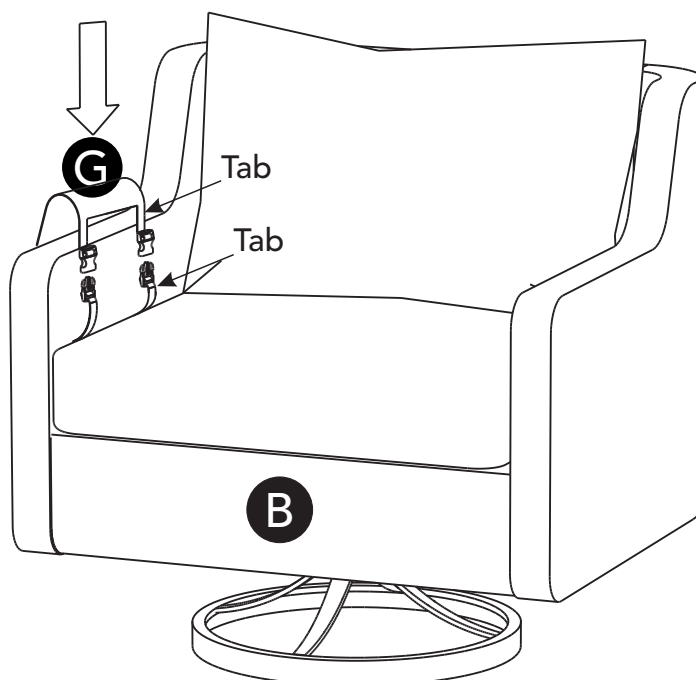

Figure 4

FLEXSTEEL®

OUTDOOR LIVING

CARE INSTRUCTIONS

Cleaning and maintenance:

- Regular cleaning: clean the furniture regularly with a damp cloth or sponge to remove dirt, dust and other deposits.
- Deeper cleaning: use mild soapy water or a fabric-friendly cleaner for the removable cushions. Avoid harsh chemicals that might harm the metal or synthetic wicker.
- Wipe dry if exposed to chlorine.
- Spot test to ensure the cleaning agents do not cause any damage to the product.
- Avoid sharp tools. Do not use hard brushes or sharp tools in order to prevent scratches or holes in the fabric.
- Cushion care: remove or cover the cushions during heavy rain or when not in use to prevent them from getting soaked.

Storage:

- To prolong the life of your outdoor furniture, we recommend using furniture covers when not in use.
- During winter and inclement weather, store furniture indoors if possible, otherwise cover the furniture when not in use.

Usage:

- Use furniture on a solid and level surface to minimize prolonged exposure to uneven or damp ground.
- Periodically check for any loose bolts and tighten as needed.

Flexsteel Industries, Inc.

For Parts or Customer Service, call toll-free: 1-888-415-3979

Monday-Friday 8:00-5:00pm Central Time

Email: customersolutions@flexsteel.com

www.flexsteel.com