

**WASH & CARE INSTRUCTIONS:**

**IMPORTANT:** Make sure to remove Musical Unit before washing plush animal. Surface wash, mild soap, air dry.

**RADIO AND TELEVISION INTERFERENCE:**

This equipment has been tested and found to comply with the limits for a Class B digital device, pursuant to Part 15 of the FCC rules. These limits are designed to provide reasonable protection against harmful interference in a residential installation. This equipment generates, uses and can radiate radio frequency energy and, if not installed and used in accordance with the instructions, may cause harmful interference to radio communications. However, there is no guarantee that interference will not occur in a particular installation. If this equipment does cause harmful interference to radio or television reception, which can be determined by turning the equipment off and on, the user is encouraged to try to correct the interference by one or more of the following measures:

- Reorient or relocate the receiving antenna.
- Increase the separation between the equipment and the receiver.
- Connect the equipment into an outlet on a circuit different from that to which the receiver is connected.
- Consult the dealer or an experienced radio/TV technician for help.

You may also find helpful the following booklet, prepared by the FCC: "How to Identify and Resolve Radio-TV Interference Problems." This booklet is available from the U.S. Government Printing Office, Washington D.C. 20402.

Changes and Modifications not expressly approved by Summer Infant, Inc. can void your authority to operate this equipment under Federal Communications Commissions rules.

visit us at  
[www.summerinfant.com](http://www.summerinfant.com)

Summer Infant stands behind all of its products. If you are not completely satisfied or have any questions, please contact our Consumer Relations Team at **1-800-268-6237** or [www.summerinfant.com/contact](mailto:customerserviceuk@summerinfant.com)

(For Europe call **+44 (0)144 250 5000** or [customerserviceuk@summerinfant.com](mailto:customerserviceuk@summerinfant.com))

<b>Summer Infant, Inc.</b> 1275 Park East Drive Woonsocket, RI 02895 USA 1-800-268-6237	<b>Summer Infant Europe, Ltd.</b> 1st Floor, North Wing Focus 31, Cleveland Road Hemel Hempstead HP2 7BW UK +44 (0) 144 250 5000	©2015 Summer Infant, Inc. Colors and styles may vary. <b>MADE IN CHINA.</b> Please retain information for future reference. 3/15
--	--	--

**WASH & CARE INSTRUCTIONS:**

**IMPORTANT:** Make sure to remove Musical Unit before washing plush animal. Surface wash, mild soap, air dry.

**RADIO AND TELEVISION INTERFERENCE:**

This equipment has been tested and found to comply with the limits for a Class B digital device, pursuant to Part 15 of the FCC rules. These limits are designed to provide reasonable protection against harmful interference in a residential installation. This equipment generates, uses and can radiate radio frequency energy and, if not installed and used in accordance with the instructions, may cause harmful interference to radio communications. However, there is no guarantee that interference will not occur in a particular installation. If this equipment does cause harmful interference to radio or television reception, which can be determined by turning the equipment off and on, the user is encouraged to try to correct the interference by one or more of the following measures:

- Reorient or relocate the receiving antenna.
- Increase the separation between the equipment and the receiver.
- Connect the equipment into an outlet on a circuit different from that to which the receiver is connected.
- Consult the dealer or an experienced radio/TV technician for help.

You may also find helpful the following booklet, prepared by the FCC: "How to Identify and Resolve Radio-TV Interference Problems." This booklet is available from the U.S. Government Printing Office, Washington D.C. 20402.

Changes and Modifications not expressly approved by Summer Infant, Inc. can void your authority to operate this equipment under Federal Communications Commissions rules.

visit us at  
[www.summerinfant.com](http://www.summerinfant.com)

Summer Infant stands behind all of its products. If you are not completely satisfied or have any questions, please contact our Consumer Relations Team at **1-800-268-6237** or [www.summerinfant.com/contact](mailto:customerserviceuk@summerinfant.com)

(For Europe call **+44 (0)144 250 5000** or [customerserviceuk@summerinfant.com](mailto:customerserviceuk@summerinfant.com))

<b>Summer Infant, Inc.</b> 1275 Park East Drive Woonsocket, RI 02895 USA 1-800-268-6237	<b>Summer Infant Europe, Ltd.</b> 1st Floor, North Wing Focus 31, Cleveland Road Hemel Hempstead HP2 7BW UK +44 (0) 144 250 5000	©2015 Summer Infant, Inc. Colors and styles may vary. <b>MADE IN CHINA.</b> Please retain information for future reference. 3/15
--	--	--



**IMPORTANT! KEEP FOR FUTURE REFERENCE**

Tools required: Phillips head screwdriver (not included). Requires 3 "AAA" batteries (included).

For technical support, contact us at **1-800-268-6237** or [www.summerinfant.com/contact](http://www.summerinfant.com/contact)

In Europe, call **+44 (0) 144 250 5000**, or e-mail us at [customerserviceuk@summerinfant.com](mailto:customerserviceuk@summerinfant.com).

For use with children from birth and up.

**Keep small parts away from children.**



**INSTRUCTION MANUAL**  
**MOMMIE'S MELODIES®**

**! WARNING:**

- Never place product in the crib. Always attach to crib rails/posts.
- Check security of Hook and Loop Strap to crib rail frequently.
- Never leave child unattended.
- Never let child play with Musical Unit.
- Possible entanglement injury. Keep out of baby's reach.
- Remove product from crib rail when baby begins to push up on hands and knees.

**! BATTERY WARNINGS:**

- Do not mix old and new batteries.
- Do not mix alkaline, standard, or rechargeable batteries.
- Remove batteries when product is stored for long periods of time or when batteries are exhausted.
- Dispose of exhausted batteries properly.
- Non-rechargeable batteries are not to be recharged.
- Rechargeable batteries are to be removed from the toy before being charged.
- Rechargeable batteries are only to be charged under adult supervision.
- Batteries are to be inserted with the correct polarity.
- The supply terminals are not to be short-circuited.



**IMPORTANT! KEEP FOR FUTURE REFERENCE**

Tools required: Phillips head screwdriver (not included). Requires 3 "AAA" batteries (included).

For technical support, contact us at **1-800-268-6237** or [www.summerinfant.com/contact](http://www.summerinfant.com/contact)

In Europe, call **+44 (0) 144 250 5000**, or e-mail us at [customerserviceuk@summerinfant.com](mailto:customerserviceuk@summerinfant.com).

For use with children from birth and up.

**Keep small parts away from children.**



**INSTRUCTION MANUAL**  
**MOMMIE'S MELODIES®**

**! WARNING:**

- Never place product in the crib. Always attach to crib rails/posts.
- Check security of Hook and Loop Strap to crib rail frequently.
- Never leave child unattended.
- Never let child play with Musical Unit.
- Possible entanglement injury. Keep out of baby's reach.
- Remove product from crib rail when baby begins to push up on hands and knees.

**! BATTERY WARNINGS:**

- Do not mix old and new batteries.
- Do not mix alkaline, standard, or rechargeable batteries.
- Remove batteries when product is stored for long periods of time or when batteries are exhausted.
- Dispose of exhausted batteries properly.
- Non-rechargeable batteries are not to be recharged.
- Rechargeable batteries are to be removed from the toy before being charged.
- Rechargeable batteries are only to be charged under adult supervision.
- Batteries are to be inserted with the correct polarity.
- The supply terminals are not to be short-circuited.

**COMPONENTS:**

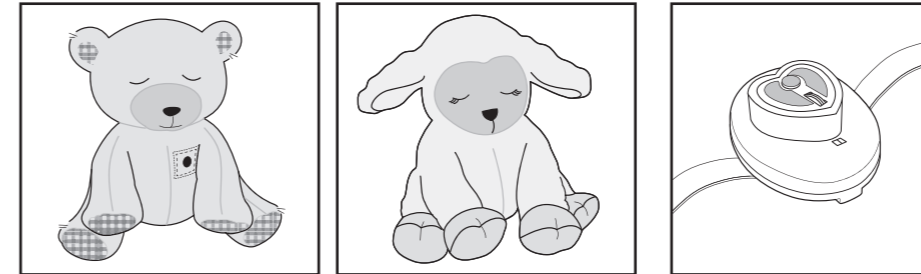

Plush animal

Musical Unit with Hook and Loop strap

**TO USE:**

**Note:** Batteries are included for the "Try Me" at store level. The melodies will automatically shut off after 20 seconds while in "try me" mode. **You must switch to the normal play mode for 20 minute auto/off operation.**

Place the plush animal face down so that the back pocket is exposed. With the musical unit's buttons facing you, place each hook and loop strap into the pocket and through the corresponding slits. Insert musical unit into the pocket and secure the hook and loop tabs on the pocket to close the opening.

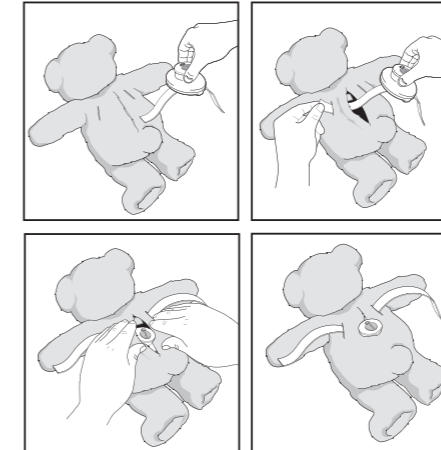

- Turn musical unit on by turning the volume wheel to desired volume level.
- Select whether or not you want cry activation on/off by pressing the button in/out. In cry activation mode audio will not play until a song is chosen or a sound activates the unit. The audio will play for 20 minutes and will re-activate when another sound occurs.
- Select mode you want baby to hear (lullabies or calming sounds) by pressing the corresponding button and cycling through the audio tracks. Each track will play for 20 minutes before fading to off.
- Turn the musical unit off by lowering the volume all the way down on the volume wheel.

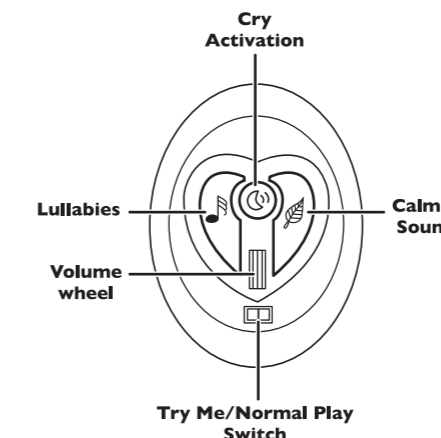

**COMPONENTS:**

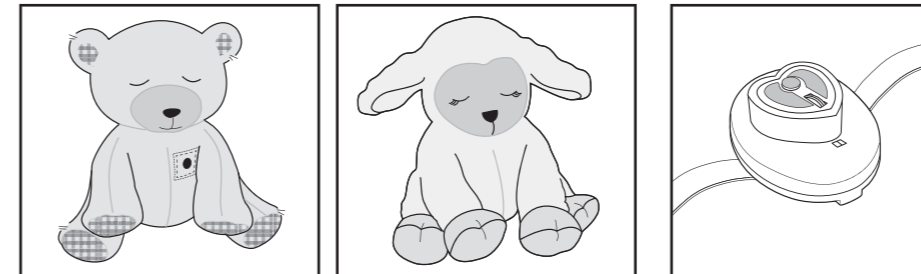

Plush animal

Musical Unit with Hook and Loop strap

**TO USE:**

**Note:** Batteries are included for the "Try Me" at store level. The melodies will automatically shut off after 20 seconds while in "try me" mode. **You must switch to the normal play mode for 20 minute auto/off operation.**

Place the plush animal face down so that the back pocket is exposed. With the musical unit's buttons facing you, place each hook and loop strap into the pocket and through the corresponding slits. Insert musical unit into the pocket and secure the hook and loop tabs on the pocket to close the opening.

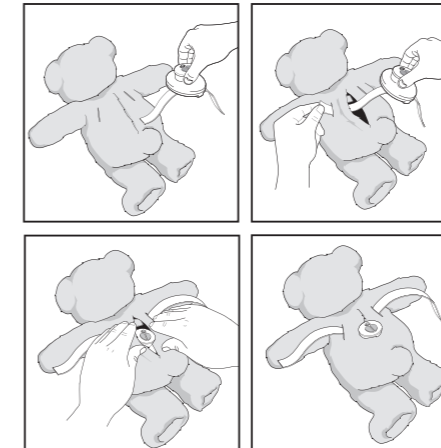

- Turn musical unit on by turning the volume wheel to desired volume level.
- Select whether or not you want cry activation on/off by pressing the button in/out. In cry activation mode audio will not play until a song is chosen or a sound activates the unit. The audio will play for 20 minutes and will re-activate when another sound occurs.
- Select mode you want baby to hear (lullabies or calming sounds) by pressing the corresponding button and cycling through the audio tracks. Each track will play for 20 minutes before fading to off.
- Turn the musical unit off by lowering the volume all the way down on the volume wheel.

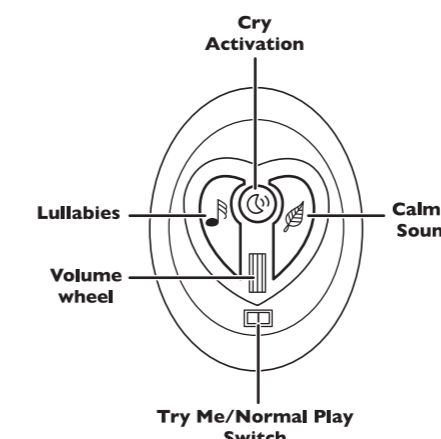

**TO USE:**

**Crib Mode**  
(from newborn until child can sit up unassisted)

Attach plush animal to crib by wrapping the Hook and Loop Strap on the back securely around crib posts or over the top rail. Musical unit should align between the 2 crib posts and face the outside of crib.

**Note:** For safety reasons, it is recommended that the plush animal be secured to opposite end of crib from baby, out of baby's reach.

**Nursery Mode**  
(from when child can push up unassisted to toddler age)

Place plush animal somewhere other than the crib, away from reach of child (example: nightstand, changing station, etc.)

**Toddler Mode** (2 years and up)

Remove Musical Unit and Hook and Loop Strap from plush animal. Close the opening on back of the plush animal shut and use as a cuddly companion for toddler.



**TO CHANGE BATTERIES:**

Remove Musical Unit from plush animal. Unscrew Battery Door. Remove old batteries and dispose of them safely.

Insert 3 new "AAA" batteries, making sure that the "+" and "-" are facing the correct way. The battery compartment is marked for clarity. Screw Battery Door back onto Musical Unit. Insert Musical Unit back into plush animal.

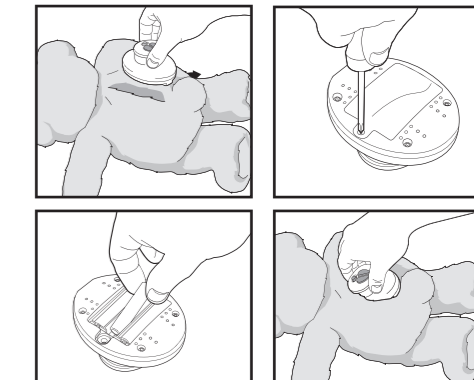

**TO USE:**

**Crib Mode**  
(from newborn until child can sit up unassisted)

Attach plush animal to crib by wrapping the Hook and Loop Strap on the back securely around crib posts or over the top rail. Musical unit should align between the 2 crib posts and face the outside of crib.

**Note:** For safety reasons, it is recommended that the plush animal be secured to opposite end of crib from baby, out of baby's reach.

**Nursery Mode**  
(from when child can push up unassisted to toddler age)

Place plush animal somewhere other than the crib, away from reach of child (example: nightstand, changing station, etc.)

**Toddler Mode** (2 years and up)

Remove Musical Unit and Hook and Loop Strap from plush animal. Close the opening on back of the plush animal shut and use as a cuddly companion for toddler.



**TO CHANGE BATTERIES:**

Remove Musical Unit from plush animal. Unscrew Battery Door. Remove old batteries and dispose of them safely.

Insert 3 new "AAA" batteries, making sure that the "+" and "-" are facing the correct way. The battery compartment is marked for clarity. Screw Battery Door back onto Musical Unit. Insert Musical Unit back into plush animal.

