

User's Manual

634CA

IN-DASH AM/FM  
CD RECEIVER

WITH FRONT PANEL AUX INPUT



634CA  
IN-DASH AM/FM CD RECEIVER  
WITH FRONT PANEL AUX INPUT

01.2010

tech support: [www.bosssaudio.com/support](http://www.bosssaudio.com/support)

**BOSS**<sup>®</sup>  
AUDIO SYSTEMS

BOSS Audio Systems • 3451 Lunar Court • Oxnard, CA 93030

[www.bosssaudio.com](http://www.bosssaudio.com)

800.999.1236

**BOSS**<sup>®</sup>  
AUDIO SYSTEMS



10R - 021004



# INSTRUCTION MANUAL

## In-Dash AM/FM Receiver with Front Panel AUX Input

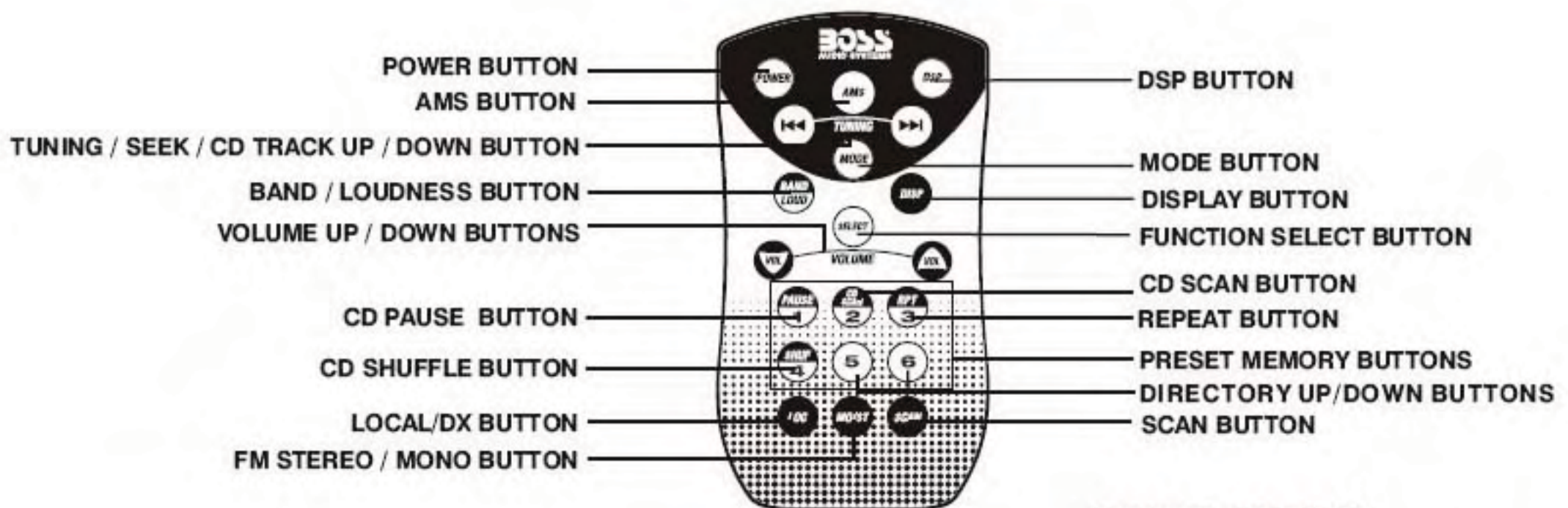
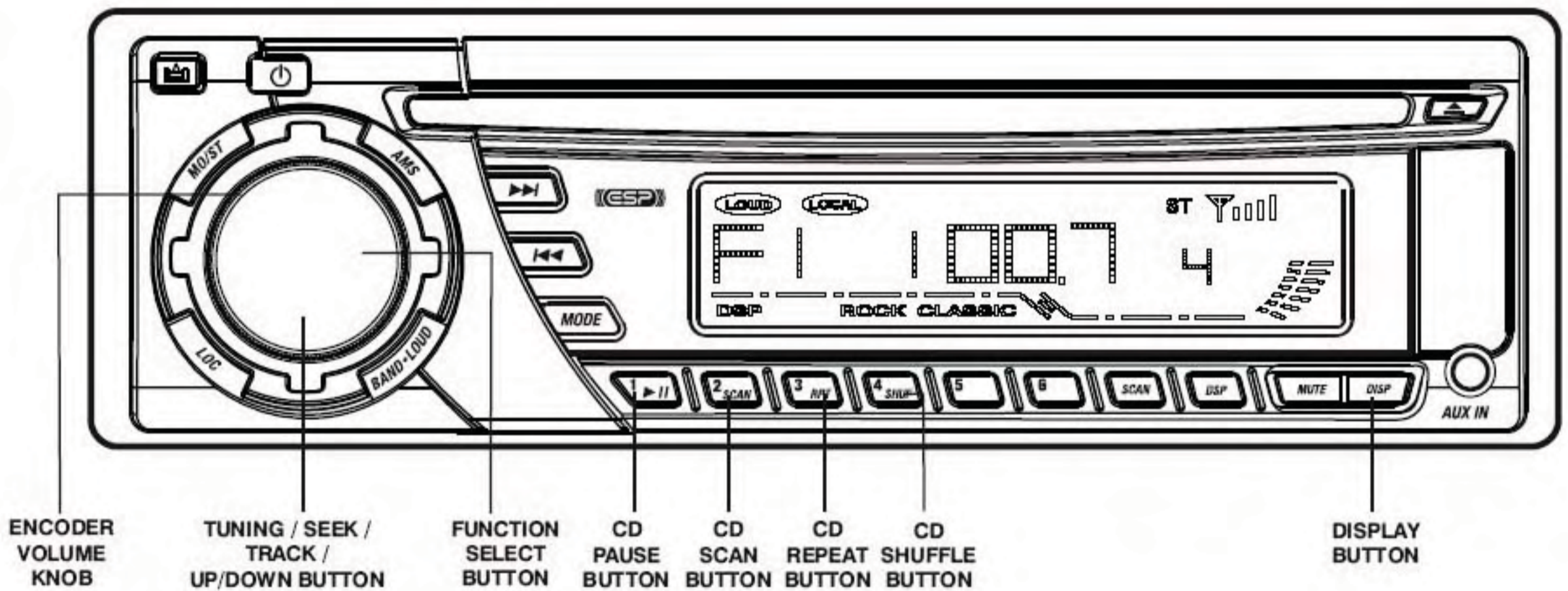
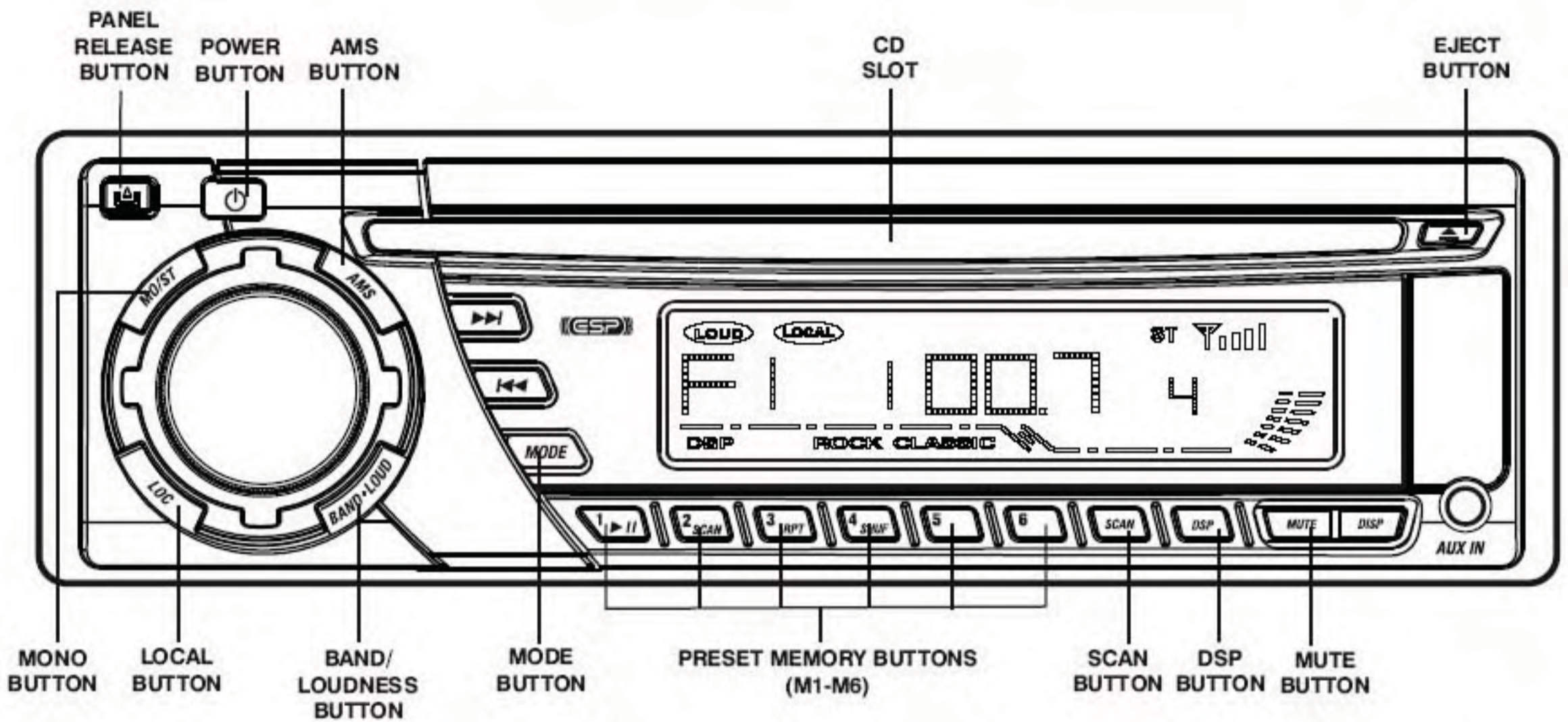

REMOTE CONTROL



# HANDLING COMPACT DISCS

## MOISTURE CONDENSATION

On a rainy day or in a very damp area, moisture may condense on the lenses inside the unit. Should this occur, the unit will not operate properly. In such a case, remove the disc and wait for about an hour until the moisture has evaporated.

## NOTES ON CDS

1. A dirty or defective disc may cause sound dropouts while playing. To enjoy optimum sound, handle the disc as follows.  
Handle the disc by its edge. To keep the disc clean, do not touch the surface (P.1).

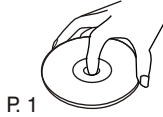

2. Do not stick paper or tape on the disc (P.2).



3. Do not expose the discs to direct sunlight or heat sources such as hot air-ducts, or leave them in a car parked in direct sunlight where there can be a considerable rise in temperature inside the car (P.3).



4. Before playing, clean the discs with an optional cleaning cloth. Wipe each disc from the centre out (P.4).



5. Do not use solvents such as benzene, thinner, commercially available cleaners, or antistatic spray intended for analog discs.

## NOTES ON DISCS

If you use the discs explained below, the sticky residue can cause the CD to stop spinning and may cause malfunction or ruin your discs.

Do not use second-hand or rental CDs that have a sticky residue on the surface (for example, from peeled-off stickers or from ink, or glue leaking from under the stickers).

**There are paste residue.**

**Ink is sticky (P.5).**



Do not use rental CDs with old labels that are beginning to peel off.

**Stickers that are beginning to peel away, leaving a sticky residue (P.6).**

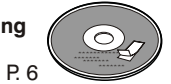

Do not use your CDs with labels or stickers attached.

**Labels are attached (P.7).**

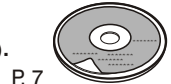

**Do Not Use Special Shape CDs**

Be sure to use round shape CDs only for this unit and do not use any special shape CDs. Use of special shape CDs may cause the unit to malfunction. (P.8).



Be sure to use CDs with disc mark



Only for this unit.

CD-Rs and CD-RWs which have not undergone finalization processing cannot be played. (For more information on finalization processing, refer to the manual for your CD-R/CD-RW writing software or CD-R/CD-RW recorder.) Additionally, depending on the recording status, it may prove impossible to play certain CDs record on CD-R or CD-RW.

# INSTALLATION

- Before finally installing the unit, connect the wiring temporarily and make sure it is all connected up properly and the unit and system work properly.
- Use only the parts included with the unit to ensure proper installation. The use of unauthorized parts can cause malfunctions.
- Consult with your nearest dealer if installation requires the drilling of holes or other modifications of the vehicle.
- Install the unit where it does not get in the driver's way and cannot injure the passenger if there is a sudden stop, like an emergency stop.
- If installation angle exceeds 30° from horizontal, the unit might not give its optimum performance.

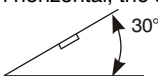

- Avoid installing the unit where it would be subject to high temperature, such as from direct sunlight, or from hot air, from heater, or where it would be subject to dust dirt or excessive vibration.
- Be sure to remove the front panel before installing the unit.



## DIN FRONT/REAR-MOUNT

This unit can be properly installed either from "Front" (conventional DIN Front-mount) or "Rear" (DIN Rear-mount installation, utilizing threaded screw holes at the sides of the unit chassis). For details, refer to the following illustrated installation methods A and B.

### DIN FRONT-MOUNT (Method A)

#### Installation the unit

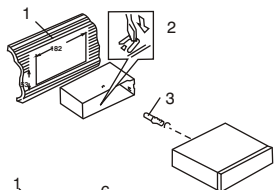

1. Dashboard
2. Holder

After inserting the half sleeve into the dashboard, select the appropriate tab according to the thickness of the dashboard material and bend them inwards to secure the holder in place.

3. Screw

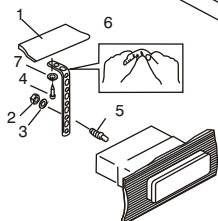

1. Dashboard
2. Nut (5mm)
3. Spring washer
4. Screw (5x15mm)
5. Screw
6. Support Strap

Be sure to use the support strap to secure the back of the unit in place. The strap can be bent by hand to the desired angle.

7. Plain washer

#### Removing the unit

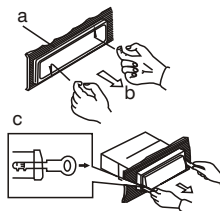

- a. Frame
- b. Insert fingers into the groove in the front of frame and pull out to remove the frame. (When re-attaching the frame, point the side with a groove down wards and attach it.)
- c. Insert the levers supplied with the unit into the grooves at both sides of the unit as shown in figure until they click. Pulling the levers makes it possible to remove the unit from the dashboard.

#### Trim Plate Installation:

Push the trim plate against the chassis until it is fitted.

**You must do this before you install the front panel, otherwise it can't be attached.**

## **DIN REAR-MOUNT (METHOD B)**

Installation using the screw holes on the sides of the unit.  
Fastening the unit to the factory radio mounting bracket.

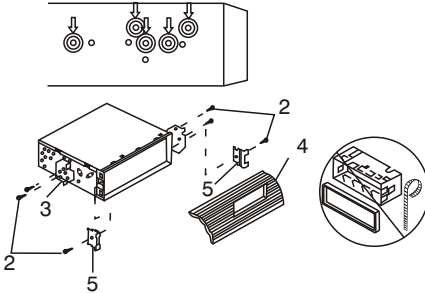

1. Select a position where the screw holes of the bracket and the screw holes of the main unit become aligned (are fitted) and tighten the screws at 2 places on each side.
2. Screw (must not use more than 6mm length)
3. Factory radio mounting bracket.
4. Dashboard or Console
5. Hook (Remove this part)

Note: the mounting box, outer trim ring, and half-sleeve are not used for method B installation.

## **DETACHABLE CONTROL PANEL (D.C.P.)**

**Removing The Detachable Control Panel (D.C.P.).**



1. Turn the power off
2. Press the D.C.P. release button
3. Remove the D.C.P.

**Attaching the DCP**

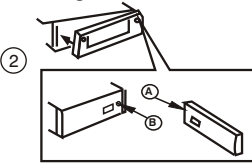

1. Attach the panel at the right side first, with point B on the main unit touching point A on the D.C.P. (As shown on the diagram).
2. Then press the left side of D.C.P. onto the main unit until a "click" sound is heard.

## **CAUTION**

- DO NOT insert the D.C.P. from the left side. Doing so may damage it.
- The D.C.P. can easily be damaged by shocks. After removing it, place it in a protective case and be careful not to drop it or subject it to strong shocks.
- When the release button is pressed and the D.C.P. is unlocked, the car's vibrations may cause it to fall. To prevent damage to the D.C.P., always store it in a protective case after detaching it.
- The rear connector that connects the main unit and the D.C.P. is an extremely important part. Be careful not to damage it by pressing on it with fingernails, pens, screwdrivers, etc.

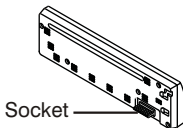

### **Note:**

If the D.C.P. is dirty, wipe off the dirt with soft, dry cloth only. And use a cotton swab soaked in isopropyl alcohol to clean the socket on the back of the D.C.P.

### **IMPORTANT**

These 2 screws are used to prevent damage to the CD mechanism during transportation. Please make sure to remove the 2 screws before installing the unit into the vehicle. DO NOT insert a CD into the unit before removing the 2 screws.

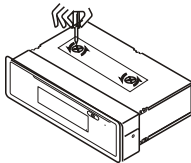

# ELECTRICAL CONNECTION

- Make sure your car battery is a 12 volt (6 filler caps) negative ground system (if not, a converter will be necessary).
- Before starting wiring connections, disconnect the power supply by removing the fuse from the fuse box.
- Connect the power wire to one of the extra terminals of the fuse box.
- Connect the black ground wire to a metal part of the car. It is important to make good contact.
- Make other wiring connections as shown.
- If your car does not have ISO connector, you can procure it from any car accessory shop.

**Notes: INCORRECT WIRING OR OPERATION WILL AVOID THE WARRANTY OF THIS UNIT.**



## Fuse Replacement:

To replace the fuse, pull out the blown fuse from the socket. Insert a new one with same rating.

# BASIC OPERATIONS

## PANEL RELEASE BUTTON

Press this button to remove the control panel.

## POWER BUTTON

Press this button to turn on or off the power.

## DISPLAY BUTTON

Press this button briefly, the LCD will display the clock for about 2 seconds, then return to previous display mode.

### Clock Adjustment

Under clock display mode, press DISP button until the LCD flashes, press Tuning Up Button to adjust hour and Tuning Down Button to adjust minute.

## MODE BUTTON

Press this button to select different mode, sequence as follow:

### MODE PRIORITY

- Tuner mode (Radio)
- CDP (only if a CD disc is inserted)
- AUX mode (only if this unit is equipped with this feature)

## FRONT AUX INPUT

Connect the external signal to the front 3.5mm earphone jack on front panel, then press Mode button to select Aux mode. Press Mode Button again to cancel Aux Mode and return to previous mode.

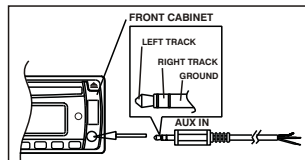

## RESET BUTTON

The RESET button is located on the main unit (as shown on the diagram). To press it vertically with a ballpoint pen or metal object will activate it. The reset button is to be activated for the following reasons:

- Initial installation of the unit when all wiring is completed.
- All the function buttons do not operate.
- Error symbol on the display.

**Note:** If press RESET button, the unit still cannot function normally, please use a cotton swab soaked in isopropyl alcohol to clean the socket on the back of the control panel.

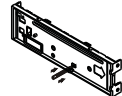

# AUDIO OPERATIONS

## ENCODER VOLUME KNOB

Turn this knob to adjust desired volume level.

## FUNCTION SELECT BUTTON

Press this button to select desired audio function.

### ORDER OF FUNCTION:

VOLUME(VOL) -> BASS(BAS) -> TREBLE(TRE) -> BALANCE(BAL) -> FADER(FAD)

While the selected function is displayed, turn Volume Knob to adjust the level within 5 seconds, otherwise the unit will return to volume adjustment mode.

## MUTE BUTTON

Press this button to mute the sound. Press it again to resume listening.

## DSP BUTTON (DIGITAL SOUND PROCESSOR)

Press this button to toggle the following EQ setting:

FLAT->CLASSICS->POP M->ROCK M->DSP OFF

At DSP OFF mode, EQ will be controlled by Bass/Treble setting.

## BAND/LOUDNESS BUTTON

Press the Band/Loudness Button long to switch the loudness on or off. When Loudness is on, display will show 'Loud On' for a few seconds.

## SCAN BUTTON

Press this button, the radio will tune up to search stations, the available stations will blinking and stay on the display for a few seconds.

## LOCAL / DX BUTTON

This control can be used to change between Local and Distant (-DX) tuning mode. Local mode improves reception in some areas where the signal is too strong.

## FM MONO / STEREO BUTTON (MONO)

Use this control to select stereo or monaural reception for FM radio stations. You can sometimes improve reception of distant stations by selecting mono mode.

# RADIO OPERATIONS

## BAND/LOUDNESS BUTTON

This is a dual function button. Press this button short to change between BAND FM1, FM2, FM3 AM(MW) bands. Press it long to turn on or off Loudness function.

## DUAL FREQUENCY SWITCH

Unit is defaulted in U.S.A frequency, if EURO frequency is required, a sharp pen is needed to switch the button on the left side of the chassis to EURO frequency.

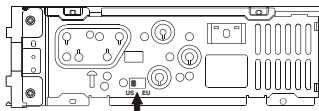

## TUNING / SEEK UP AND TUNING / SEEK DOWN BUTTONS

1. Press these buttons briefly will operate AUTO SEARCH tuning mode, the radio will tune up or down to the next station and remain on the frequency.
2. Press these buttons more than 2 seconds, operate as MANUAL SEARCH buttons, under this mode the tuning frequency will advance up or down rapidly when the button is pressed. If the buttons are not pressed within 3 seconds, they will return to auto search mode.

## RADIO SIGNAL STRENGTH METER

This is used to indicate the signal strength of current radio station broadcast. When you choose RADIO mode, it will show on the display.



Best  
reception



Worst  
reception

## **AUTO MEMORY STORE/PRESET SCAN BUTTON (AMS)**

- 1.PRESET SCAN: Press AMS button briefly enter Preset Scan mode, it will scan all the preset stations in the memories, you can hear that will stay on each station for about 5 seconds.
- 2.AUTO MEMORY STORE: Press AMS button long to enter Auto Store mode, this feature will automatically scan the current band and enter up to 6 strongest stations into the 6 preset memories. To stop Auto Store & Scan, press the AMS button again.

## **STATION PRESET BUTTONS (M1-M6)**

- 1.Press these buttons briefly to recall the stored stations in the selected band.
- 2.Presetting stations manually, Press the BAND button to select the band for the station to be preset. Use Tuning Up/Down to tune in the stations to be preset. Press the Preset button at which you want to store the station for at least 2 second. The preset number will appear on the display accompanied by a beep, this indicate that the station has been stored into memory.

# **CD OPERATIONS**

## **CD SLOT**

Insert the disc into CD slot. The CD will begin to play.

## **CD PAUSE BUTTON**

Press this button to pause CD play, press again to release pause.

## **CD SCAN BUTTON**

Press this button, the first 10 seconds of each track will be played sequentially until this button is pressed again, then normal play will resume at the current track.

## **CD REPEAT BUTTON**

Press this button, the current track will be played repeatedly until this button is pressed again.

## **CD SHUFFLE BUTTON**

Press this button to play all tracks on CD in random. Press again to deactivate it.

## **EJECT BUTTON**

Press this button to eject the CD from the unit. The receiver will switches to radio mode automatically.

## **TRACK UP AND TRACK DOWN BUTTON**

Press the Track Up Button to skip to the next track or previous track. Press the Track Down button during play will return to the beginning of the current track, press it one more time to skip to previous skip. Press and hold Track Up/Down Button to fast forward or fast reverse. CD player starts when you release the button.



# SPECIFICATIONS

## CD PLAYER

System	Compact disc audio system
Usable disc	Compact disc, CD-R, CD-RW (AUDIO format)
Sampling frequency	44.1KHz
No of quantization bits	1bit
Frequency	5-20,000Hz
Number of channels	2 stereo
S/N Ration	70dB

## RADIO SECTION

### FM

Frequency Range	87.5 - 107.9 Mhz 87.5 - 108 Mhz
Intermediate Frequency	10.7 MHz
Usable Sensitivity	Better than 15dB at S/N 30 dB
Stereo Separation	25 dB at 1KHz
S/N Ratio	50 dB

### AM (MW)

Frequency Range	530 - 1710 Khz 522 - 1620 Khz
Intermediate Frequency	450KHz
Usable Sensitivity	Better than 45dB
S/N Ratio	40 dB

## GENERAL

Power Supply	DC 11 -14V
Polarity	Negative Ground
Speaker impedance	4 ohms
Power Output	50W x 4

## REMARK :

**Specifications subject to change without notice.**

# TROUBLE SHOOTING

Before going through the check list, check wiring connection. If any of the problems persist after check list has been made, consult your nearest service dealer.

Symptom	Cause	Solution
No power	The car ignition is not on.	If the power supply is properly connected to the car accessory terminal, switch the ignition key to "ACC"
	The fuse is blown.	Replace the fuse.
Disc cannot be loaded or ejected	Presence of CD disc inside the player.	Remove the disc in the player, then put a new one.
	Inserting the disc in reverse direction.	Insert the compact disc with the label facing upward.
	Compact disc is extremely dirty or defective disc.	Clean the disc or try to play a new one.
	Temperature inside the car is too high.	Cool off or until the ambient temperature returns to normal.
	Condensation.	Leave the player to off for an hour or so, then try again.
No sound	Volume is in minimum.	Adjust volume to a desired level.
	Wiring is not properly connected.	Check wiring connection.
The operation keys do not work	The built-in microcomputer is not operating properly due to noise.	Press the RESET button. Front panel is not properly fixed into its place
Sound skips.	The installation angle is more than 30 degrees.	Adjust the installation angle to less 30 degrees.
	The disc is extremely dirt or defective disc.	Clean the compact disc. Then try to play a new one.
The radio does not work. The radio station automatic selection does not work.	The antenna cable is not connected.	Insert the antenna cable firmly.
	The signals are too weak.	Select a station manually.
ERROR 1	Mechanism Error	Press the reset button if the error code does not disappear, consult your nearest service dealer.
ERROR 2	Servo Error	Press the reset button if the error code does not disappear, consult your nearest service dealer.