

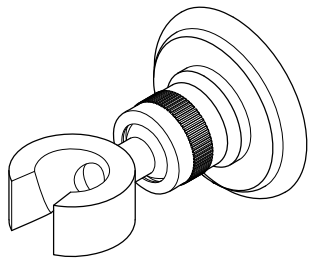

## Wall Bracket Installation Instructions

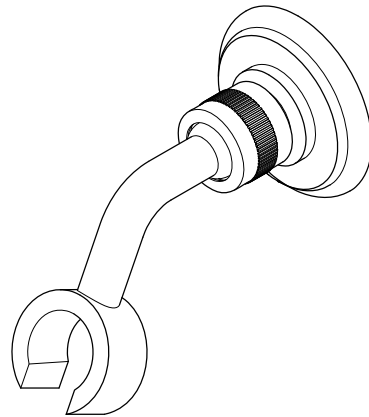

### Parts:

Mounting  
Screw &  
Anchor

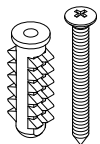

1Pc

[www.kingstonbrass.com](http://www.kingstonbrass.com)

TOLL-FREE CUSTOMER SERVICE: 1-877-2-KBRASS  
TECHNICAL SUPPORT E-mail: [service@kingstonbrass.com](mailto:service@kingstonbrass.com)  
12775 Reservoir Street, Chino, CA 91710

# CAUTION

Failure to follow all installation directions may  
cause product to detach from the wall and  
cause serious injury

### Tools Required

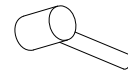

Hammer

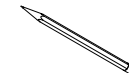

Marking Pencil

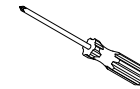

Phillips Screwdriver

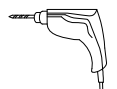

Power Drill

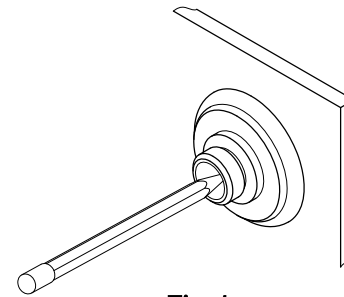

Fig. 1

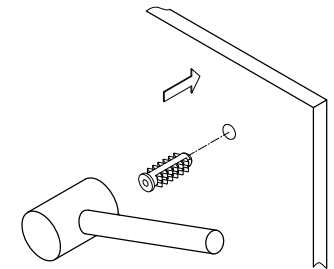

Fig. 2

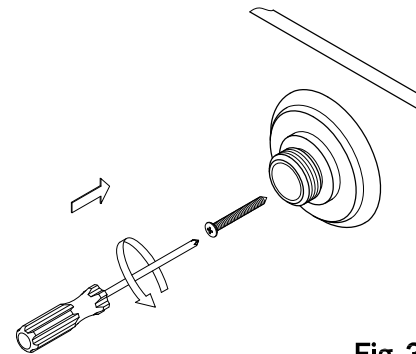

Fig. 3

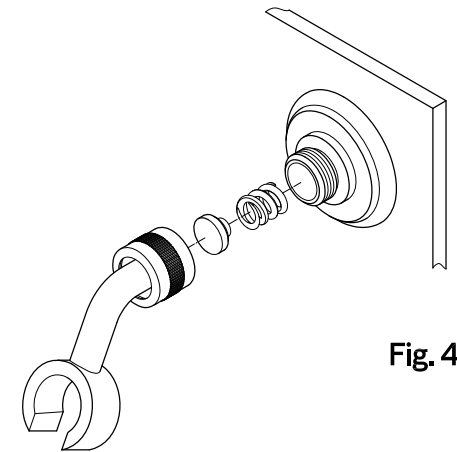

Fig. 4

### Installation Steps:

- Step 1. Locate position on the wall and mark outline of cover plate on the wall (Fig. 1).
- Step 2. Locate wall bracket in the center of outline. Mark location of the mounting screw (Fig.1) and drill holes at the marked location.
- Step 3. Insert anchors into the holes until flush with wall (Fig. 2).
- Step 4. Screw the wall bracket base into the wall with mounting screws, place the round cover over base and slide bracket in (Fig. 3).
- Step 5. Place the spring, metal washer and bracket set in the base and hand tighten in clockwise till fully secure (Fig. 4).

### Cleaning

Clean with a damp cloth only.  
Avoid using metal or abrasive polishes.

©2025 LVC Kingston LLC. All Rights Reserved.  
2025-05-AD