

ORDER BY PART NUMBER

# ILLUSTRATED PARTS

## U.3132LS U.3133X Deco™ Exposed Wall Mount Tub Filler

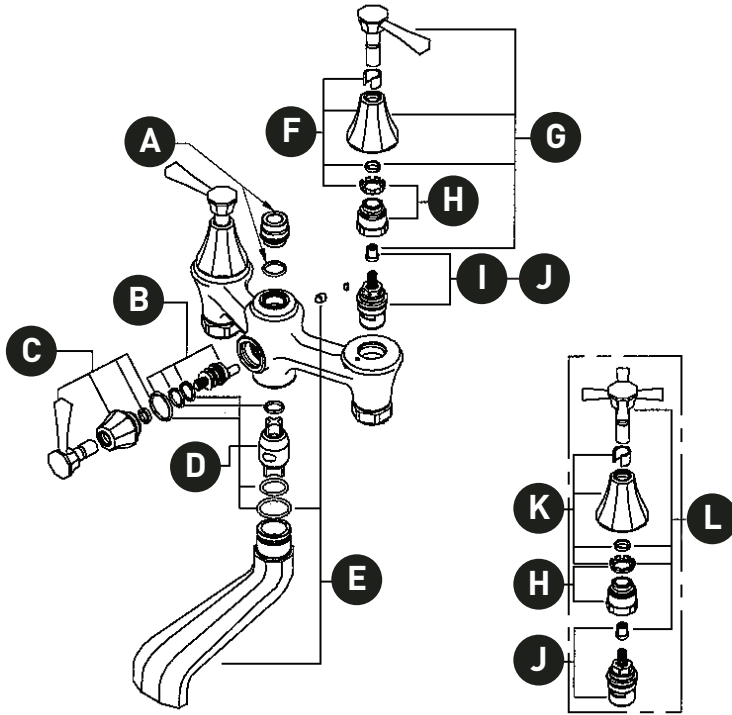

ID	Kit Number	Finish
A	9.11311	N/A
B	9.21523	N/A
C*	9.12324	See below
D	9.26500	N/A
E*	9.20104	See below
F*	9.12311	See below
G*	9.011157 (H)	See below
	9.011158 (C)	See below
H	9.11143	N/A
I	9.13500 (L)	N/A
J	9.13501 (R)	N/A
K*	9.12311	See below
L*	9.011170 (H)	See below
	9.011171 (C)	See below

**\*Finish Determined by Suffix**

Finish	Description
APC	Polished Chrome
EG	English Gold
PN	Polished Nickel
STN	Satin Nickel
ULB	Unlacquered Brass

For warranty or additional information, contact:

U.S.A.  
houseofrohl.com/support  
1-800-777-9762

QUEBEC / MARITIMES / WESTERN CANADA  
QUÉBEC / MARITIMES / OUEST CANADIEN  
QUEBEC / MARITIMOS / CANADA OCCIDENTAL  
houseofrohl.ca/support  
1-866-473-8442

ONTARIO  
houseofrohl.ca/support  
1-800-287-5354

VEUILLEZ EFFECTUER VOTRE COMMANDE  
PAR NO DE RÉFÉRENCE

# ILLUSTRATIONS DES PIÈCES

## U.3132LS U.3133X

Robinet de bain mural exposé Deco<sup>MC</sup>

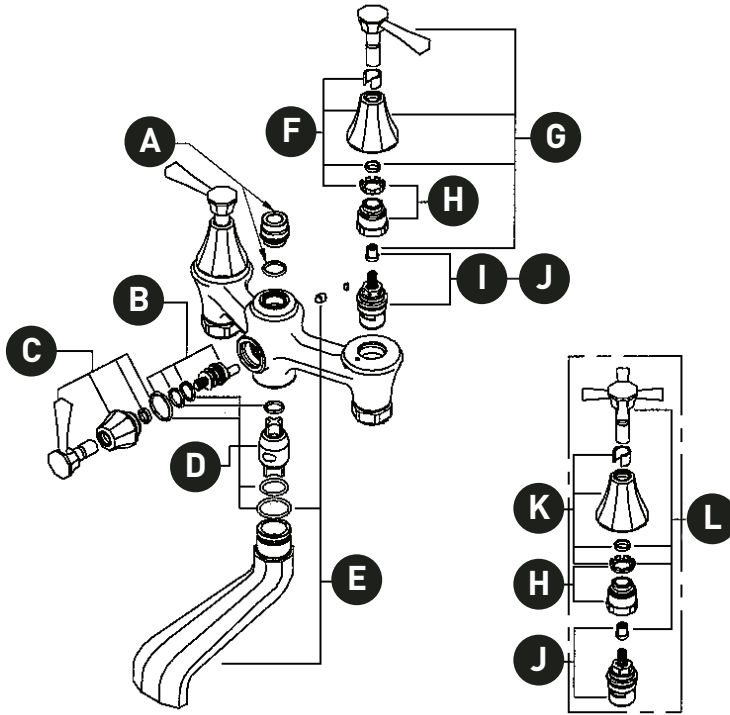

ID	Référence du kit	Finition
A	9.11311	N/A
B	9.21523	N/A
C*	9.12324	Voir ci-dessous
D	9.26500	N/A
E*	9.20104	Voir ci-dessous
F*	9.12311	Voir ci-dessous
G*	9.011157 (H)	Voir ci-dessous
	9.011158 (C)	Voir ci-dessous
H	9.11143	N/A
I	9.13500 (L)	N/A
J	9.13501 (R)	N/A
K*	9.12311	Voir ci-dessous
L*	9.011170 (H)	Voir ci-dessous
	9.011171 (C)	Voir ci-dessous

**\*Finition déterminée par le Suffixe**

Finition	Description
APC	Laiton poli
EG	Or anglais
PN	Nickel poli
STN	Nickel satiné
ULB	Laiton non laqué

For warranty or additional information, contact:

U.S.A.  
houseofrohl.com/support  
1-800-777-9762

QUEBEC / MARITIMES / WESTERN CANADA  
QUÉBEC / MARITIMES / OUEST CANADIEN  
QUEBEC / MARITIMOS / CANADA OCCIDENTAL  
houseofrohl.ca/support  
1-866-473-8442

ONTARIO  
houseofrohl.ca/support  
1-800-287-5354

PEDIR POR NÚMERO DE REFERENCIA

# PIEZAS ILUSTRADAS

## U.3132LS U.3133X

Grifo de baño de montaje en pared expuesto Deco™

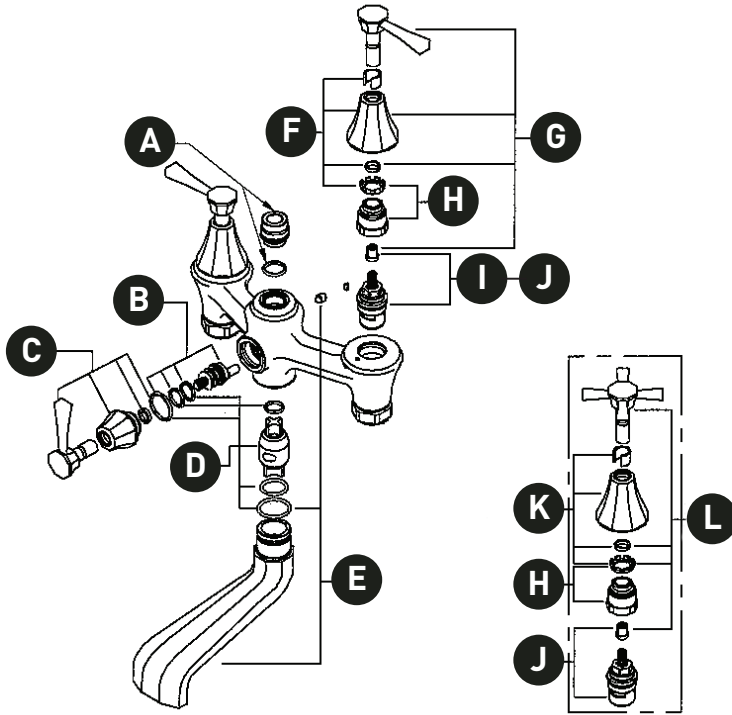

ID	Referencia del kit	Acabado
A	9.11311	N/A
B	9.21523	N/A
C*	9.12324	Ver más abajo
D	9.26500	N/A
E*	9.20104	Ver más abajo
F*	9.12311	Ver más abajo
G*	9.011157 (H)	Ver más abajo
	9.011158 (C)	Ver más abajo
H	9.11143	N/A
I	9.13500 (L)	N/A
J	9.13501 (R)	N/A
K*	9.12311	Ver más abajo
L*	9.011170 (H)	Ver más abajo
	9.011171 (C)	Ver más abajo

**\*Acabado determinado por el sufijo**

Acabado	Descripción
APC	Cromo pulido
EG	Oro inglés
PN	Níquel pulido
STN	Níquel satinado
ULB	Latón sin lacar

For warranty or additional information, contact:

U.S.A.  
houseofrohl.com/support  
1-800-777-9762

QUEBEC / MARITIMES / WESTERN CANADA  
QUÉBEC / MARITIMES / OUEST CANADIEN  
QUEBEC / MARITIMOS / CANADA OCCIDENTAL  
houseofrohl.ca/support  
1-866-473-8442

ONTARIO  
houseofrohl.ca/support  
1-800-287-5354