



CS3 bed is featured with Assist Bar, Drake Bed Ends and Invacare® Solace® Mattress

CARROLL CS SERIES™
CS3™ BED



Yes, you can.®

The **Carroll CS Series™ CS3™ Bed** was developed with safety in mind for those who require a bed that is stable throughout the travel range and mobile in the lowest position only.

Invacare® beds, mattresses and rails, excluding therapeutic support surfaces and bariatric beds, when used as a system and sold new and unused after August 1, 2007, meet the recommended FDA Guidelines for bed rail entrapment. Visit www.invacare.com/bedsafety for additional safety and entrapment information.

Features

Mobility at Low Height – The Maxi-Lock system secures the bed to the floor in all elevated positions, providing reassurance that the bed is locked and secured for maximum resident safety.

Exclusive Slat Deck Design – Provides a comfortable sleep surface, allows for improved infection control and helps reduce wear and tear on the mattress.

Ergonomic Hand Pendant – Water-resistant¹, sealed hand pendant designed to fit comfortably in the resident's hand.

Dual Pendant Connections – Pendant connects to either side of the bed, providing customized convenience for the resident.

Tool-less Assembly – The CS3 bed features tool-less assembly, minimizing set-up time.

Customizable Options –

- 39" or 42" Wide Deck
- 4" Bed Extender (84" Length)
- Attendant Control Panel
- Portable Battery Backup
- Hi-Lo Lockout

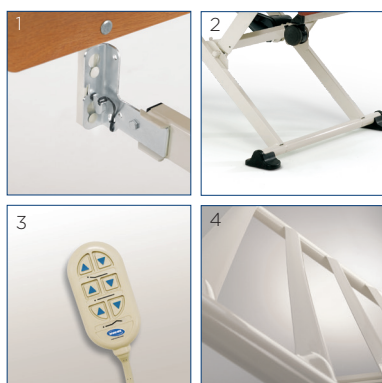

1. Tool-less Assembly 3. Ergonomic Hand Pendant
2. Maxi-Lock System 4. Slat Deck Design



Invacare Corporation
www.invacare.com

USA

One Invacare Way
Elyria, Ohio
44035-4190
(800) 333-6900

Canada

570 Matheson Blvd. E.,
Unit 8
Mississauga, Ontario
L4Z 4G4 Canada
(800) 668-5324

©2020

Invacare Corporation.
All rights reserved.
Trademarks are identified by the symbols ™ and ®. All trademarks are owned by or licensed to Invacare Corporation unless otherwise noted. Specifications are subject to change without notification.
Form No. 20-030
200202

Model #	Height Range	Sleep Surface	Weight Capacity*	Regulation Compliance	Limited Warranty
IHCS3	8.5" - 27" H	76" - 80" L 36", 39", 42" W	450 lb.	†Classified to: UL 60601-1 IEC 60601-2-38 CAN/CSA C22.2 No. 601.1	10 Years Frame 5 Years Mechanical 3 Years Electronics

NOTE: Whenever bed rails are used as part of any hospital or homecare bed system, the potential for bed rail entrapment exists. To reduce this risk, a patient must always be assessed regarding their risk of entrapment before any product is used. Routine patient monitoring is also required once a product is in use. To learn more about the risk of bed rail entrapment please visit the US FDA's website at <http://www.fda.gov> and search for "Bed Rail Entrapment."

* Maximum safe working load.

1. Pendant is water-resistant to IPX6 per IEC 60529.

†Testing conducted to select portions of UL/IEC Standards.

