

Read all instructions and review illustrations before assembly.

Stack on Unit Assembly Instructions

Figure 1

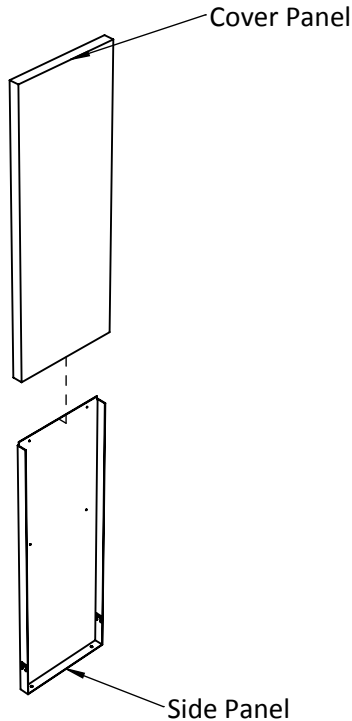

Tools required for assembly:

Phillips Screwdriver
Tape Measure

This assembly includes:

(2) Side Panels
(2) Cover Panels
(2) Shelves
(1) Back Panel
(4) Mounting Screws
(12) #8 x 1/2" Screws



WARNING

Stack-on unit is heavy. Two or more people are required for assembly. Attempting to assemble this stack-on unit alone may cause injury. Take care when handling metal parts. Sharp edges may cause injury.

IMPORTANT

Assembly hardware is located in a padded pack. Be sure to locate hardware pack before discarding any packaging materials.

1. Separate the Side Panel from the Cover Panel by sliding them apart through the bottom of the Cover Panel as shown in **Figure 1**
2. Repeat step 1 for the second set of Cover and Side Panels.
3. Lay Side Panel, flat surface up, onto a carpeted surface. Use a phillips screwdriver to install four #8 x 1/2" Screws into holes in flat surface of Side Panel and leave approximately an 1/8" gap between screw head and wall of Side Panel. See **Figure 2**.
4. Flip Side Panel, flat surface down, bend tab outwards using a screwdriver. See **Figure 3**.
5. Repeat steps 3 and 4 for the second Side Panel.

Figure 2

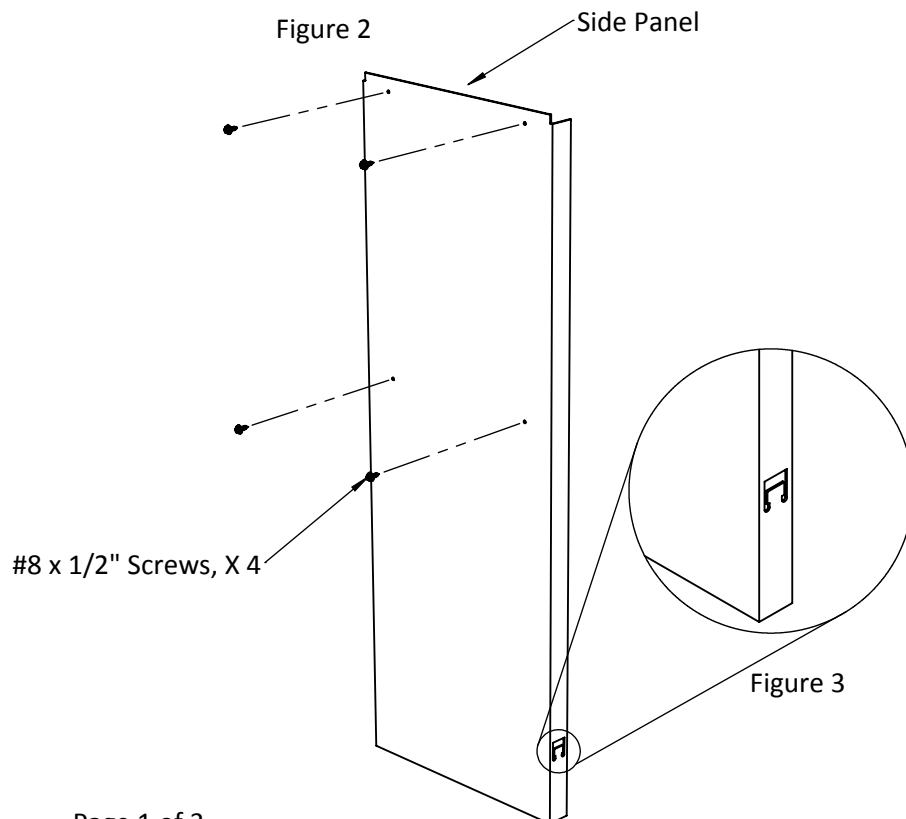

Figure 4

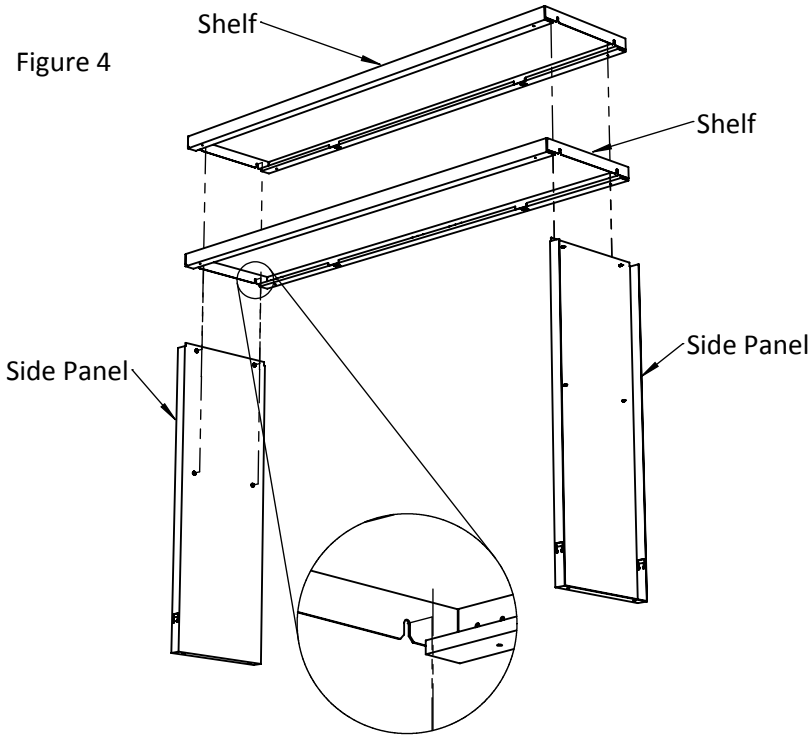

Figure 5

6. Using an assistant, align the four Notches, as shown in **Figure 5**, on the underside of the middle shelf with the four #8 x 1/2" Screws located on the flat surface of the Side Panels, and push shelf downward. See **Figure 4**.
7. Using a phillips screwdriver, securely tighten the four #8 x 1/2" Screws, attaching the shelf to the Side Panels.
8. Repeat steps 6 and 7 to attach the second Shelf to the Side Panels.
9. Using an assistant, align the four Screw Slots, as shown in **Figure 7**, on the Back Panel with the screw holes located on the bottom edge of the two Shelves. See **Figure 6**.
10. Install four #8 x 1/2" Screws using a phillips screwdriver, and tighten to securely attach the Back Panel.

Note: The Shelves are designed for either a flipper door or non-flipper door application. If installing flipper door(s), install shelves with door mounting holes facing out. If flipper door(s) are not being installed, install shelves with door mounting holes facing towards rear of stack on unit.

Figure 6

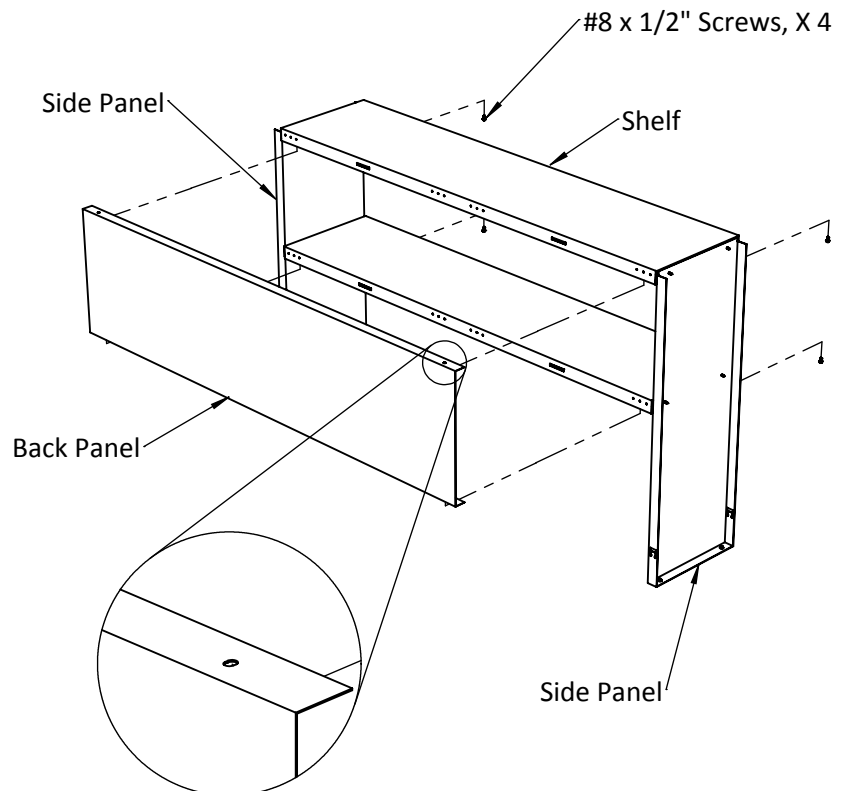
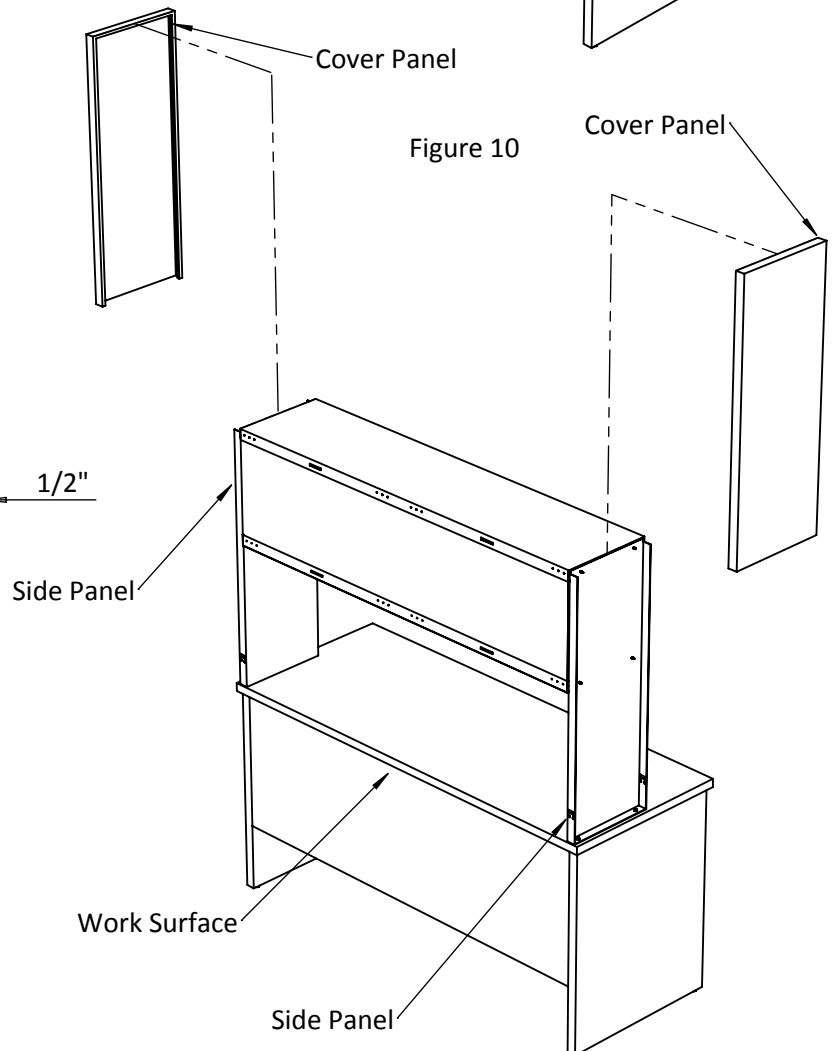
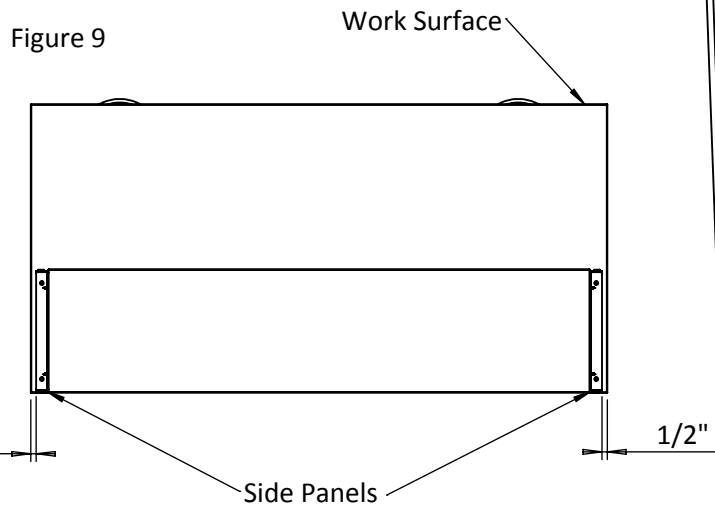
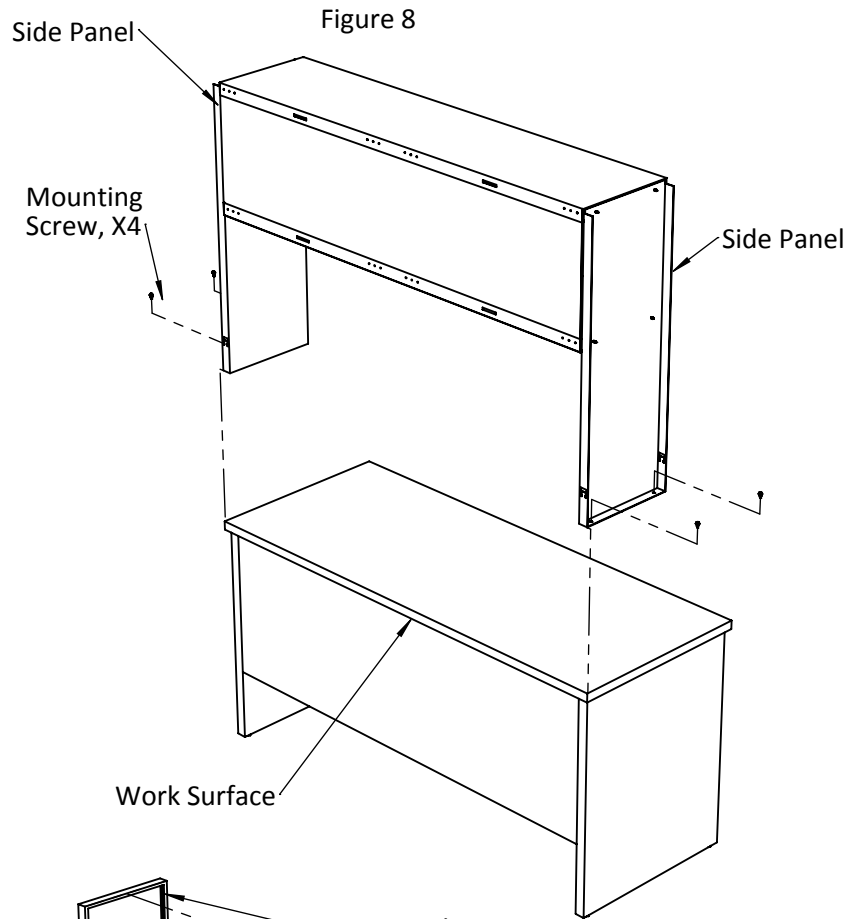

Figure 7

11. Using an assistant, lift Stack On Unit onto the Work Surface and locate stack-on at rear of Work Surface. See **Figure 8**.
12. As shown in **Figure 9**, use a tape measure to position each Side Panel approximately 1/2" inwards from each side of the Work Surface.
13. Using a phillips screwdriver, install four Mounting Screws through each Side Panel and into the Work Surface. Fully tighten screws.
14. With the top of the Cover Panel approximately 6" above the top of the Side Panel, position rear edge of Cover Panel over rear edge of Side Panel. Pivot front edge of Cover Panel toward front edge of Side Panel. Carefully press front edge of Cover Panel over-top the front edge of Side Panel and slide downwards until Cover Panel is resting on-top of the Work Surface. See **Figure 10**.
15. Repeat step 13 to install the second Cover Panel onto the second Side Panel.



! WARNING

To prevent stack on unit from tipping over, it is extremely important that screws securing Side Panels to the Work Surface be tight. Failure to follow this warning or improper installation of stack on unit can result in severe personal injury or property damage.