

# INSTRUCTION MANUAL

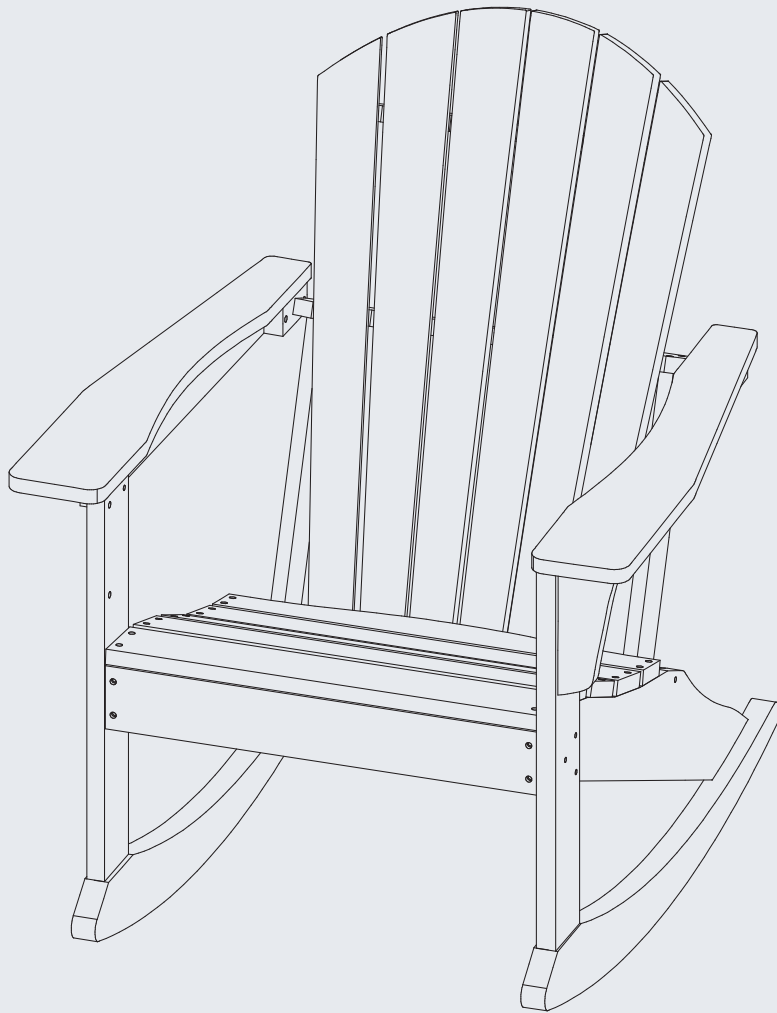

Outdoor Rocking Poly Adirondack Chair

V1.0

## ! NOTICE

### Do not overtighten screws. (Insert all screws before tightening screws.)

- Please do not exceed the weight limitations of this item.
- Do not stand on or use any part of this item as a step ladder.
- Firmly secure all bolts, screws, and nuts before use.
- Reconfirm that all bolts, screws, and nuts are secure every 90 days.
- Do not use or store this item in the proximity of open flame or flammable/combustible chemicals.
- Be aware that some parts are heavy and have sharp edges.

## TOOLS REQUIRED

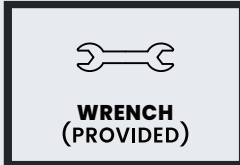

**CHAIR**  
**330 LBS**  
**CAPACITY**



**1 PERSON**  
**ASSEMBLY**



**UP TO 30 MIN.**  
**ASSEMBLY**

## HARDWARE

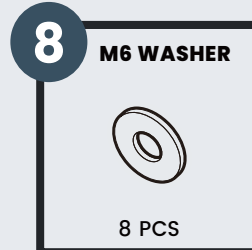
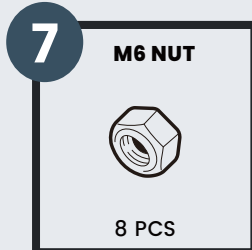
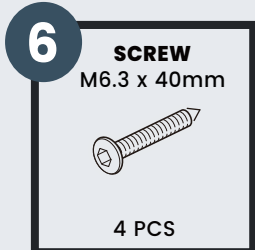
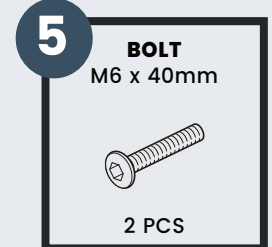
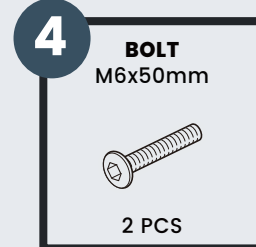
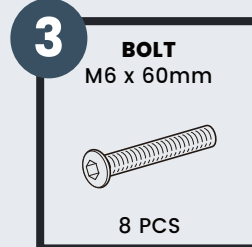
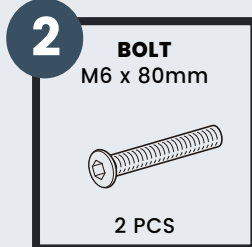
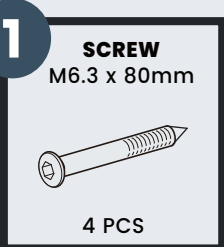

## PARTS

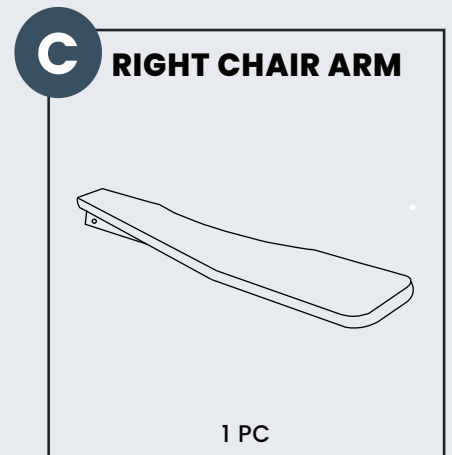
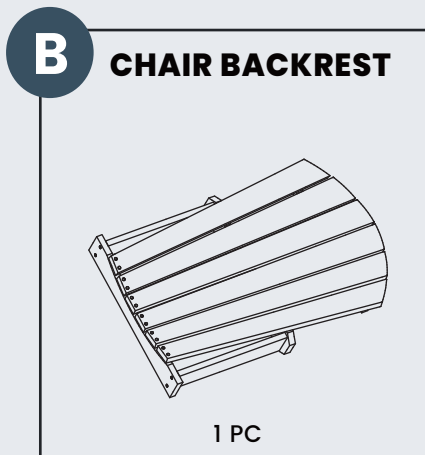
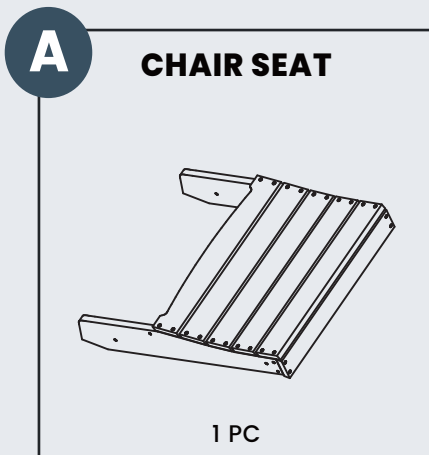

## PARTS

**D****LEFT CHAIR ARM**

1 PC

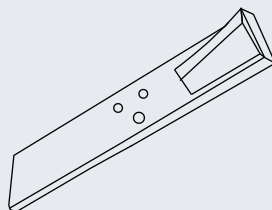
**E****RIGHT CHAIR LEG**

1 PC

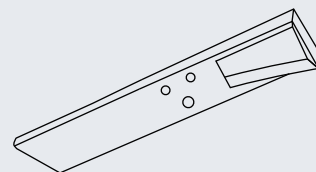
**F****LEFT CHAIR LEG**

1 PC

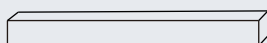
**G****BACK RAIL**

1 PC

**H****RIGHT ROCKING FEET**

1 PC

**I****LEFT ROCKING FEET**

1 PC

## PRODUCT ASSEMBLY - OVERALL VIEW

Look at following overall view of this chair and learn the exact position of each part to be assembled.

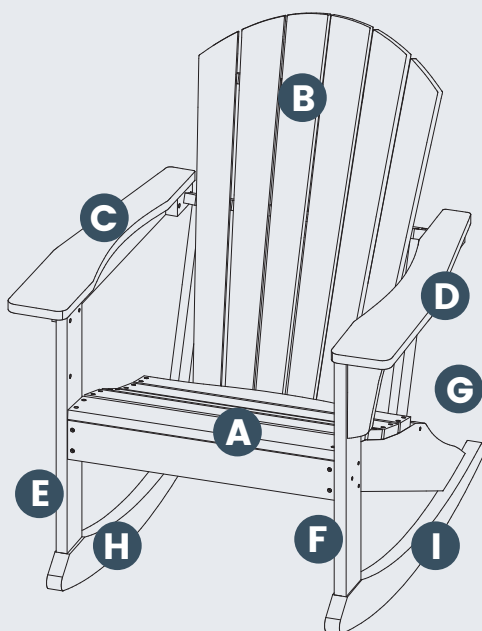

## PRODUCT ASSEMBLY

1

Attach **Part E Right Chair Leg** to **Part A Chair Seat** with 3 pcs of **Hardware #3 Bolt**, **Hardware #8 M6 Washer** and **Hardware #7 M6 Nut**.

Do same to attach **Part F Left Chair Leg** to **Part A Chair Seat**.

Do not tighten screws too much at this stage.

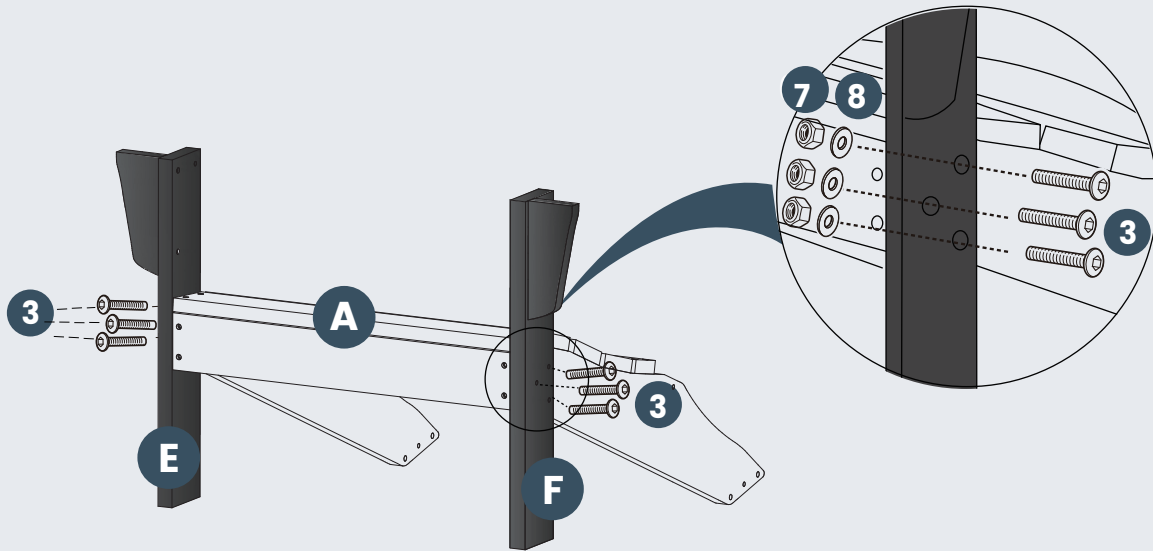

2

Attach **Part C Right Chair Arm** to **Part E Right Chair Leg** with 1 pc of **Hardware #3 Bolt**, **Hardware #8 M6 Washer** and **Hardware #7 M6 Nut**.

Do the same to attach **Part D Left Chair Arm** to **Part F Left Chair Leg**.

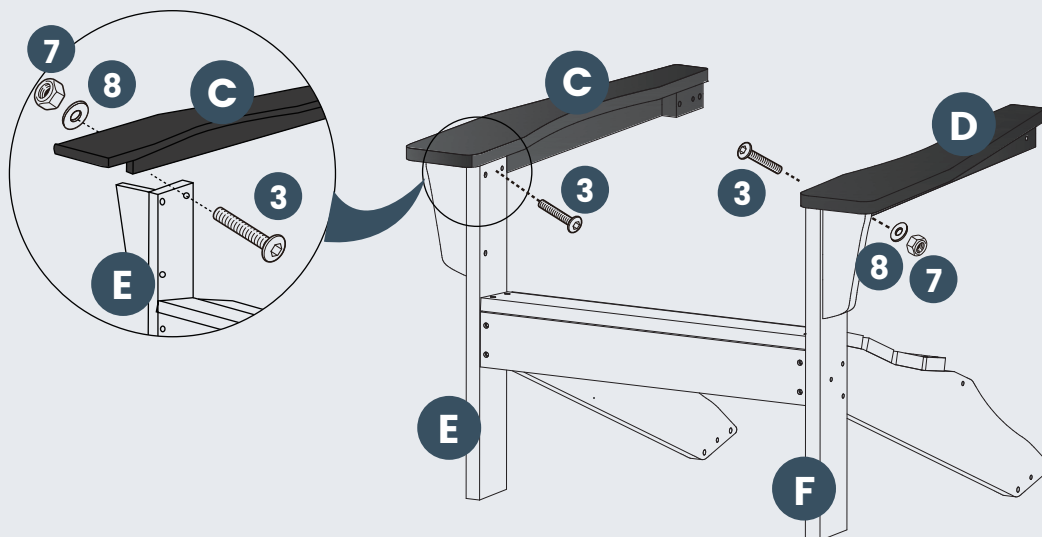

## PRODUCT ASSEMBLY

3

Put **Part B Chair Backrest** into **Part A Chair Seat** and attach them with 2 pcs of **Hardware #4 Bolt** then attach **Part B Chair Backrest** to **Part C Right Chair Arm** with 1 pc of **Hardware #2 Bolt**.

Do the same to attach **Part B Backrest** to **Part D Left Chair Arm**.

Attach **Part G Back Rail** to **Part A Chair Seat** with 2 pcs of **Hardware #5 Bolt**.

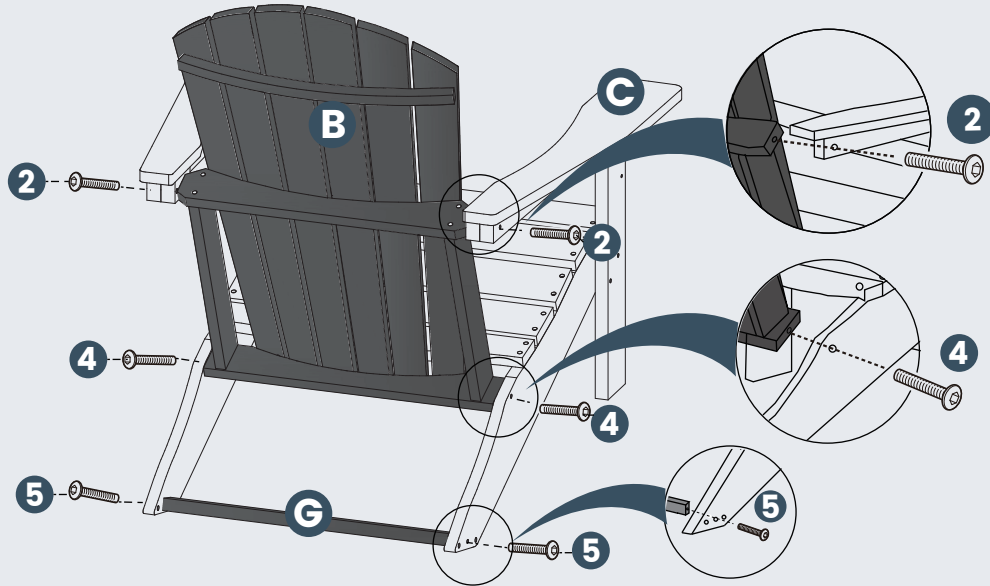

4

Attach **Part H Right Rocking Feet** to **Part E Right Chair Leg** with 2 pcs of **Hardware #1 Screw** and attach **Part H Right Rocking Feet** to **Part A Chair Seat Rear Leg** with 2 pcs of **Hardware #6 Screw**.

Do the same to attach **Part I Left Rocking Feet** to **Part F Left Chair Leg** and **Part A Chair Seat Rear Leg**.

Check and tighten all the bolts and screws again to finish the assembly.

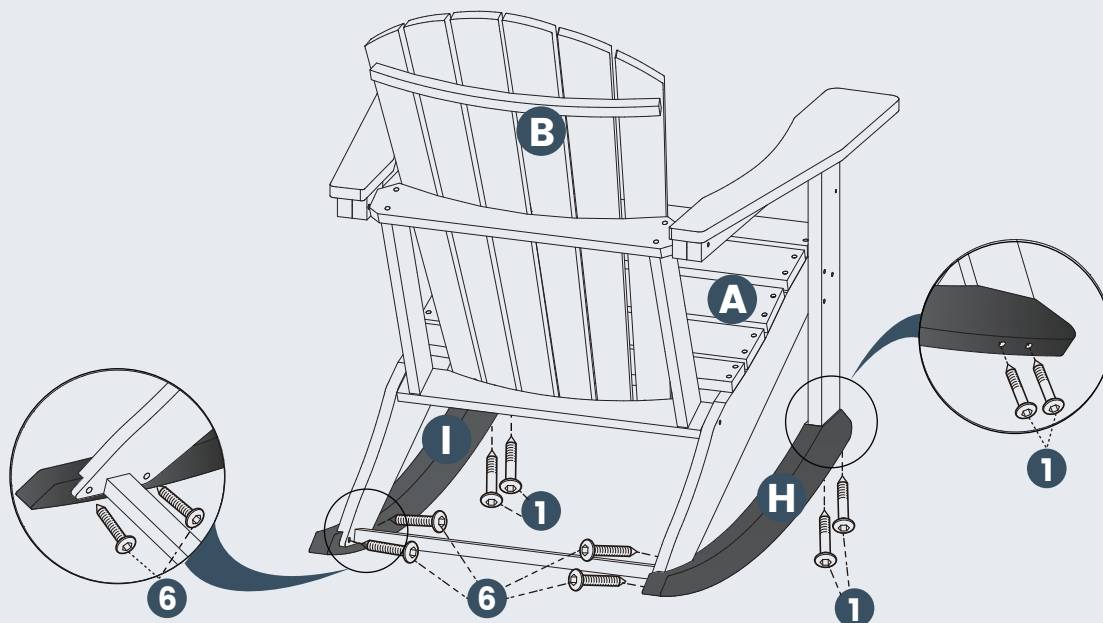

---

## CLEANING TIPS

**REGULAR CLEAN:** Use a mixture of warm water and mild soap. Gently scrub the surface with a soft bristle brush to remove any dirt or stains.

**QUICK CLEAN:** You can simply wipe down the furniture with a damp cloth.

Regular cleaning not only preserves the aesthetic appeal of your furniture, but also helps extend its lifespan.