

# SHIMANO

## SLX

## SLX150HG

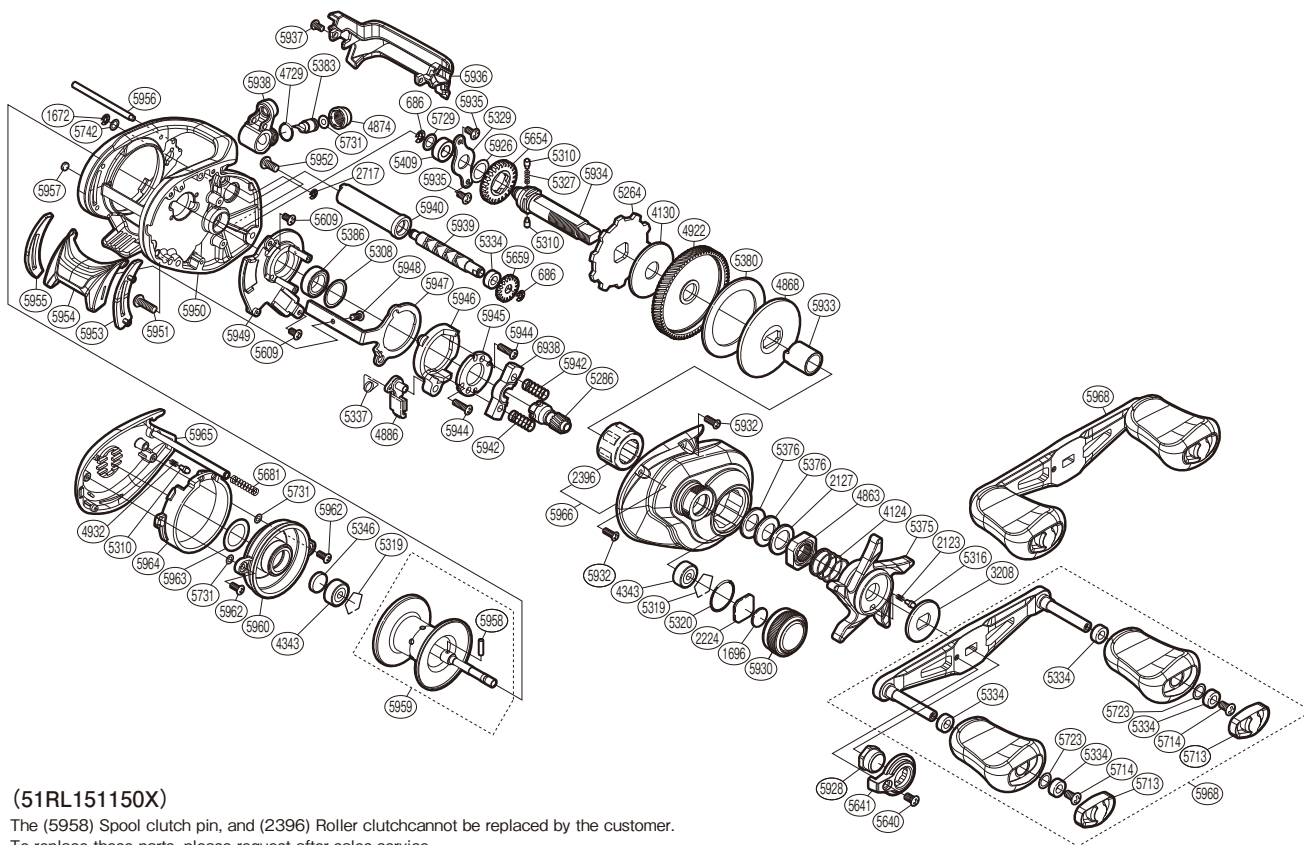

### (51RL151150X)

The (5958) Spool clutch pin, and (2396) Roller clutch cannot be replaced by the customer.  
To replace these parts, please request after-sales service.

#	Part No.	Description	#	Part No.	Description	#	Part No.	Description
686	105NK	E Lock	5346	10EX5	Spacer B	5940	100UF	Level Wind Guard
1672	105NC	E Lock	5375	10ROG	Star Drag	5942	100U9	Yoke Spring
1696	10896	Cast Control Spacer (B)	5376	109F5	Drag Spring Washer	5944	10LV0	Screw
2123	10BT2	Click Spring	5380	10R3D	Drag Washer	5945	100U5	Clutch Cam Retainer
2127	10J1N	Star Drag Spacer	5383	10BHQ	Line Guide Pawl	5946	100UK	Clutch Cam
2224	1085F	Spool Tension Spacer (A)	5386	10EX6	Ball Bearing	5947	100UG	Clutch Plate
2396	10F5C	Roller Clutch Bearing	5409	10DQF	Drive Shaft Bushing	5948	10LF4	Screw
2717	105NB	E Lock	5609	10LCT	Screw	5949	10DUK	Clutch Guard Assembly
3208	10J22	Star Drag Click Plate	5640	101VV	Screw	5950	100MJ	Frame
4124	10A70	Star Drag Spring	5641	10SSK	Handle Nut Plate	5951	100UU	Screw
4130	10CHX	Drag Washer	5654	101K8	Idle Gear	5952	100UV	Screw
4343	105C3	Ball Bearing	5659	10SRL	Idle Gear	5953	100MH	Clutch Bar Guide B
4729	108WQ	O Ring	5681	10KNH	Spring	5954	100ML	Clutch Button
4863	10A3T	Star Drag Nut	5713	10SS2	Handle Knob Seal	5955	100MW	Clutch Bar Guide A
4868	10D3H	Key Washer	5714	10LFA	Screw	5956	100UT	Stabilizer Bar
4874	10FJB	Pawl Cap	5723	1003Z	Washer	5957	10DTF	Washer
4886	10MME	Clutch Pawl	5729	1003V	Washer	5958	10P67	Spool Pin
4922	10CMC	Drive Gear	5731	1003S	Washer	5959	10DUH	Spool Assembly
4932	10GQZ	Click Spring	5742	10S42	Washer	5960	13X9B	Dial Case
5264	10D73	Anti-reverse Ratchet	5926	1023S	Washer	5962	100UL	Screw
5286	10CSC	Pinion Gear	5928	10E67	Handle Nut	5963	10DUM	Washer
5308	10190	Washer	5930	10TZQ	Cast Control Cap	5964	100UQ	Left Side Plate Cam Lever
5310	10HJG	Idle Gear Pin	5932	10LCY	Screw	5965	10DUJ	Left Side Plate Assembly
5316	10MFC	Click Pin	5933	100UC	Roller Clutch Inner Bearing	5966	10TX7	Right Side Plate Assembly
5319	1054D	Bearing Retainer	5934	100UP	Drive Shaft	5968	10DUN	Handle Assembly
5320	10R22	O Ring	5935	10E23	Screw	6938	10S8M	Yoke
5327	10JDY	Idle Gear Spring	5936	10DUL	Level Wind Protector Unit			
5329	109T1	Drive Shaft Retainer	5937	100U4	Screw			
5334	10PXZ	Bushing	5938	10DUG	Line Guide Assembly			
5337	10R1H	Clutch Pawl Spring	5939	100U6	Worm Shaft			

Please note that the number of adjusting washers may not be the same as shown in the exploded views.  
(Adjustment will vary with each individual product.)