

## LIMITED LIFETIME WARRANTY

Your Dynarex Product is warrantied to be free of defects in materials and workmanship for the lifetime of the product for the original purchaser. This item was built to exacting standards and carefully inspected prior to shipment. This Limited Lifetime Warranty is an expression of our confidence in the materials and workmanship of our products and our assurance to the consumer of years of dependable service.

The Warranty shall not apply under the following conditions:

- Problems arising from normal wear
- Problems arising from failure to adhere to the product instructions
- Problems arising from misuse, negligence, accident or improper operation, maintenance or storage
- Problems arising from modifications or unauthorized repairs, parts or attachments
- Products where the serial number has been removed or defaced
- Problems with non-durable components, such as rubber accessories, casters, and grips, which are subject to normal wear and need periodic replacement

Dynarex shall not be liable for any consequential or incidental damages whatsoever. Dynarex shall repair or replace defective products at its option. The foregoing warranty is exclusive and in lieu of other express warranties, if any, including the implied warranties of merchantability and fitness of a particular purpose. The remedy for any violation of the implied warranty shall be limited to repair or replacement of the defective product pursuant to the terms contained herein.

If you have a question about your Dynarex device or this warranty, please contact an authorized Dynarex dealer.

**WARNING:**  
Cancer and Reproductive Harm  
[www.P65Warnings.ca.gov](http://www.P65Warnings.ca.gov)



**SYMBOL GLOSSARY**  
For an explanation of symbols  
used in Dynarex packaging, visit  
[dynarex.com/symbols.php](http://dynarex.com/symbols.php)

R200103

Reorder No. 10502



# Pedal Exerciser

*Folding • Digital • Hand/Feet*



6 16784 05021 8

**Manufactured for: Dynarex Corporation**  
10 Glenshaw Street • Orangeburg, NY 10962  
USA • [www.dynarex.com](http://www.dynarex.com)

Made in China

## ASSEMBLY INSTRUCTIONS

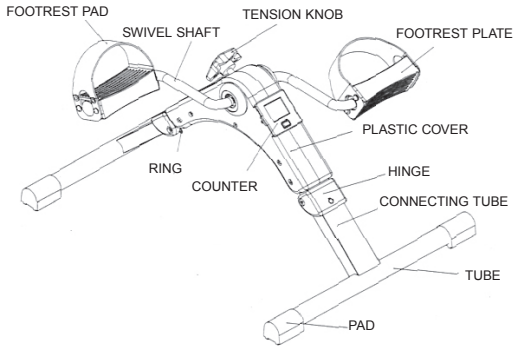

1. Remove contents from box.
2. Pull legs in opposite direction until locking button “snaps” into locking receiver (see figure A). To close, pull locking ring and bend leg down. Repeat on other leg (see figure B).
3. Tighten tension knob on top of Pedal Exerciser and turn clockwise to tighten. The tension knob will increase/decrease the amount of tension on the Pedal Exerciser. Tighten/loosen to a level that feels comfortable.

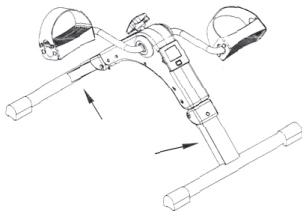

figure A

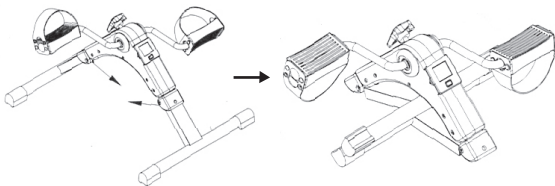

figure B

## AUTOMATIC OPERATION

1. **MODE** (red button): This control allows you to select a particular function. To start, press and hold the red button for 4 seconds. The LED will display the different functions. (If after turning on and there is no activity, the unit will automatically shut off).
2. To select a function, wait until the 4 second set up is complete. Push the red button and the arrow will move through the functions. When the desired function is selected, simply use the Pedal Exerciser and the unit will calculate the exercise.
3. **TIME**: Determines the amount of time the Pedal Exerciser has been operating.
4. **COUNT (CNT)**: Determines the amount of steps while operating the Pedal Exerciser.
5. **CALORIE (CAL)**: Determines the amount of calories burned while using the Pedal Exerciser.
6. **REPS PER MINUTE (R.P.M.)**: Automatically calculates the repetitions per minute.
7. **SCAN**: Will automatically review the results of all functions.

## BATTERY REPLACEMENT

If the display does not come on or reads incorrectly, the battery requires replacement.

To replace the battery, use a small screwdriver and remove the display panel. Turn the display panel over and remove the watch-style battery. Insert a new battery and replace the display panel.

**WARNING:** Device may become hot with extended use.