

AERE DINING TABLE ASSEMBLY INSTRUCTIONS



PARTS PACKING CONFIGURATIONS

BOX #1

A. GLASS TOP 1 PC

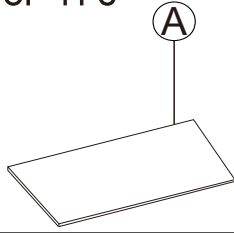

BOX #2

B. WOODEN LEG 1 PC

C. LOWER LEG 1 PC

D. UPPER LEG 1 PC

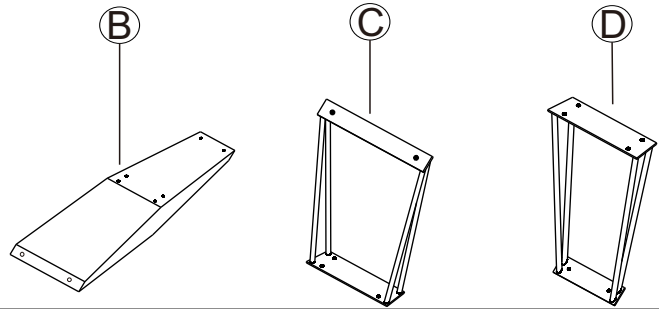

HARDWARE KIT PACKED IN BOX #2

NO.	DESCRIPTION	IMAGE	Q' TY
1	WASHER(ø17x1.5mm)		12 PCS
2	ALLEN BOLT(M8x20mm)		2 PCS
3	ALLEN BOLT(M8x35mm)		8 PCS
4	ALLEN BOLT(M8x10mm)		2 PCS
5	ALLEN KEY(S5)		1 PC
6	SPRING WASHER(ø13x2.0mm)		4 PCS

FULLY ASSEMBLED

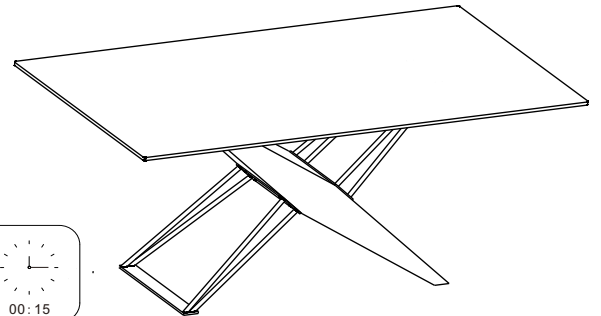

STEP 1:

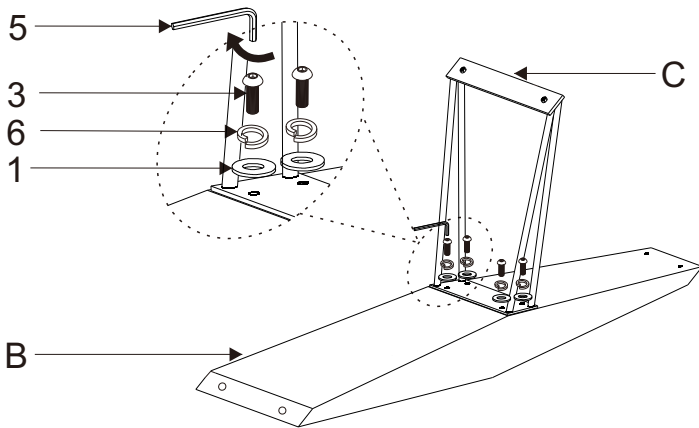

TIGHTEN ALL THE BOLTS COMPLETELY

STEP 2:

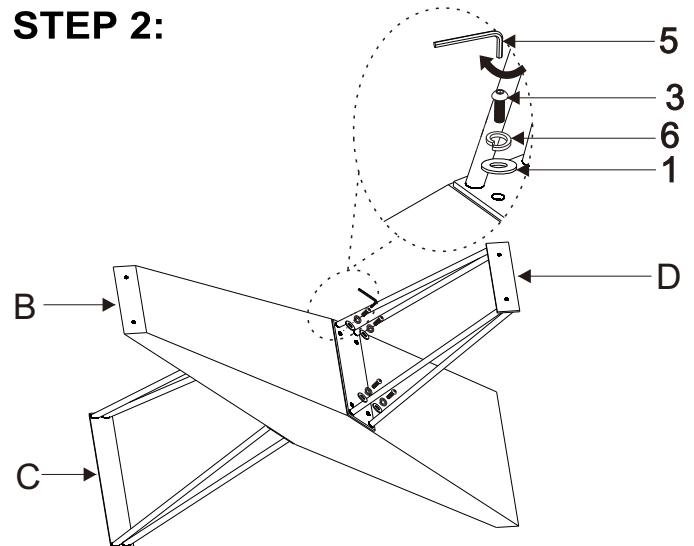

DO NOT TIGHTEN BOLTS COMPLETELY

STEP 3:

① ATTACH THE WOODEN LEG TO THE TOP, BUT DO NOT TIGHTEN THE BOLTS.

② ATTACH THE METAL LEG "D" TO THE TOP.

THEN TIGHTEN ALL THE BOLTS COMPLETELY.

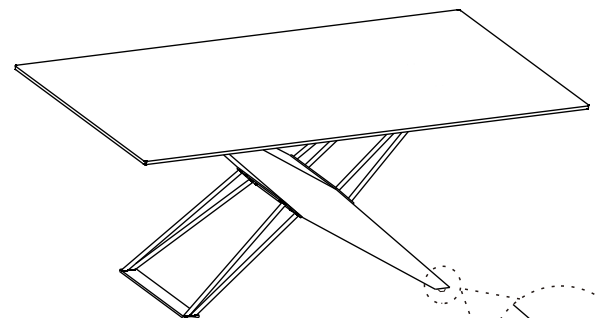
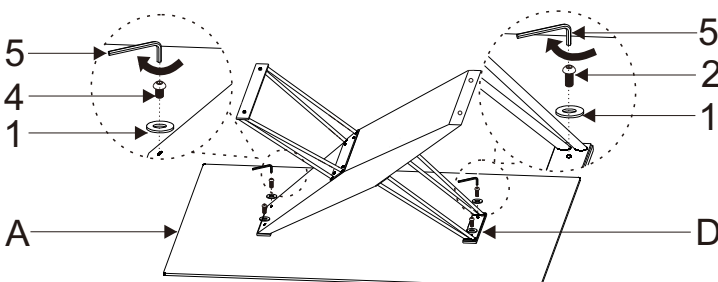

FULLY ASSEMBLED

LEVELER