

SIDES	BOTTOM
Material:Steel-Welding tube, white powder coating	

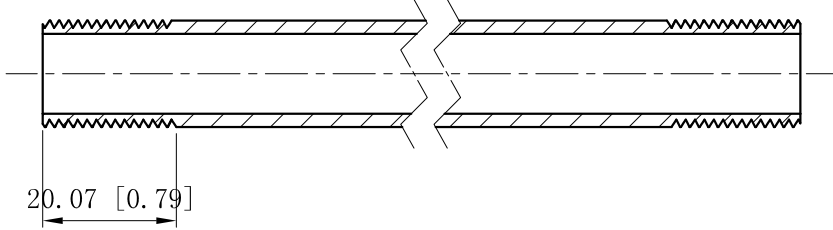

CUTAWAY VIEW A-A

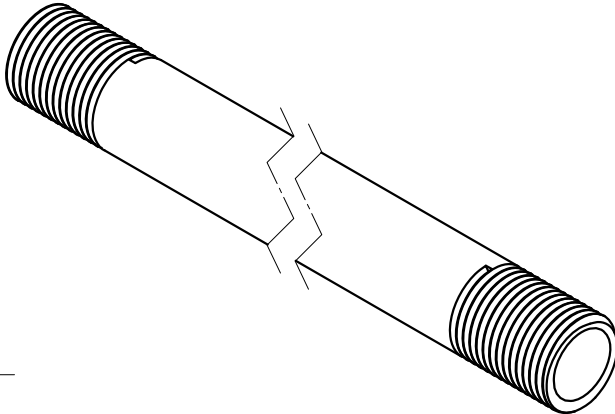
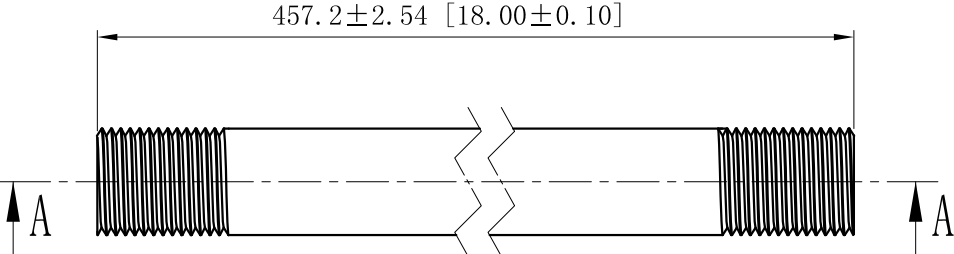
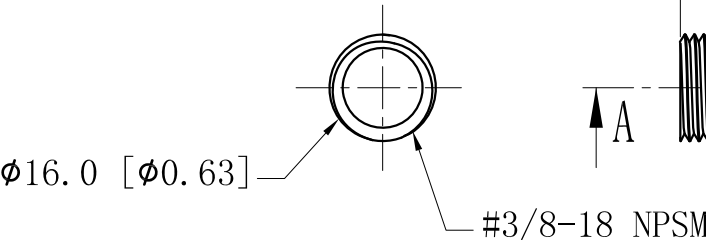

This data sheet is for reference only .GARVIN INDUSTRIES reserves the right to make changes to the design without prior notice.

DESCRIPTION
TRADE REFERENCE TERMS

STANDARD PACKING
1 PCS

<b>GARVIN INDUSTRIES</b>		
TITLE LIGHT FIXTURE STEMS & NUTS		
SIZE A4	DWG NO. LFS-375-18WH	REV A
DATA SHEET		