

Installing Canopy

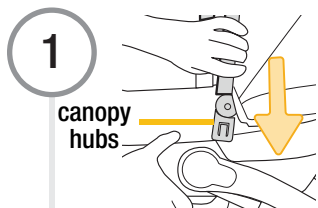

Attach Canopy Hubs to Outer Carrier
Align the canopy hubs with the slots on each side of the outer carrier. Then push them down into the slots.

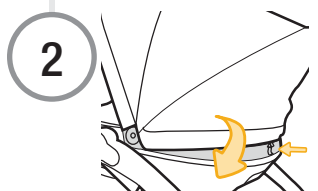

Pull Canopy Over Back of Outer Carrier Edge

Preparing Base for Install

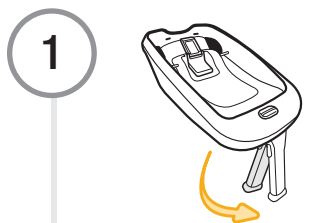

Unfold Load Leg
This is an optional feature. In a crash, load legs can reduce downward rotation, limit rebound, provide additional stability, and energy absorption. **⚠ Do not fully extend yet. Do not use the load leg to adjust the base angle.**

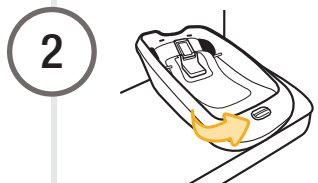

Check Base Angle
The angle indicator will turn **completely green** when correct. No red should be showing.



Adjusting the Base
If the angle indicator is not correct, adjust the base foot.

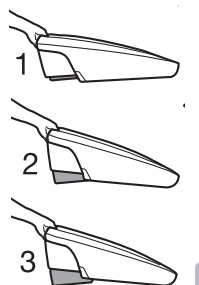

There are 3 positions.

- The adjustment handle is at the back of the base.
- Squeeze the adjustment handle to release the base foot.
- Then release the handle so the base foot locks into place.

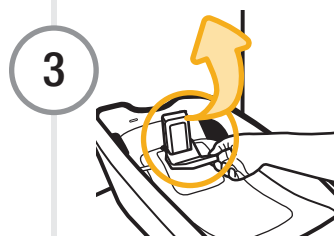

Lift Release Lever

For UAS Belt Base Install

- You **MUST OPEN THE LOCKOFF** in order for the UAS belts to loosen.

For Vehicle Belt Base Install

- The lap belt or the lap/shoulder belt both go **completely under** the belt path guides and the Lockoff.

There are 2 methods for install. Choose only one:



UAS Belts

OR

Vehicle Belts

When used correctly the UAS belts or the vehicle belts are equally safe.

⚠ Do not use both the UAS belts and vehicle belt at the same time.

UAS Belt Install with Base

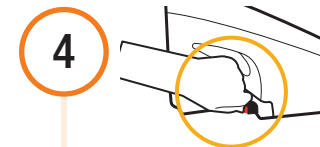

Release UAS Connectors from Storage Location

- Press in red button. Push connector into storage location.
- Then pull it and the belt out.

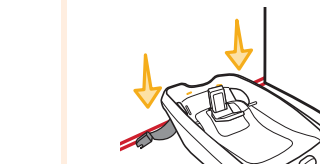

Attach Connectors to Vehicle Anchors



Push Release Lever Down

You **must Push the Release Lever Down** in order for the UAS belts to tighten.



Push Down on Base to Tighten UAS Belts

The belts will begin to automatically retract and tighten as you push down.



Check Tightness Indicators

The red will turn **completely green** when tightened correctly. No red should be showing.

You may need to **adjust the base foot** into another position for the tension indicators to turn completely green. See **Preparing Base for Install** Step 2 on Page 1.

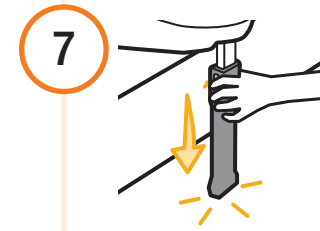

Extend Load Leg

- Squeeze the buttons on the load leg and pull it down until it meets the vehicle floor.
- It **must be** perpendicular to the vehicle floor.

⚠ Do not use the load leg if it does not reach the floor of your vehicle. **Do not use the load leg on top of vehicle storage compartments.** Review your vehicle owner's manual.

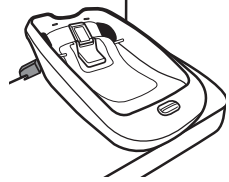

UAS Belt Base Install Finished!

To install the outer carrier to the base, see page 55 of the instruction manual.

Check the tightness of the install often to make sure it has not loosened.

Vehicle Belt Install with Base

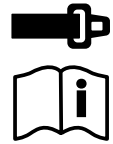

Check if Your Vehicle Belts Will Work With This Car Seat

Review pages 35-40 of the instruction manual and your vehicle owner's manual to find out what kind of vehicle belts you have.

4



Route Belt Through Belt Path Openings As Shown

The lap belt or the lap/shoulder belt both go **completely under** the belt path guides and the Lockoff as shown.

Buckle the vehicle belt.

5

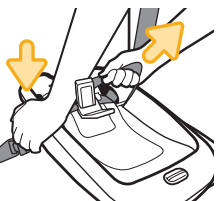

Push Down on Base While Tightening Belt

You **must** tighten the vehicle belt **BEFORE** closing the Lockoff.

Check Tightness Indicators

The red will turn **completely green** when tightened correctly. No red should be showing.



You may need to **adjust the base foot** into another position for the tension indicators to turn completely green.

See **Preparing Base for Install** Step 2 on Page 1.

6



Push Release Lever Down

The lap belt or the lap/shoulder belt both go **completely under** the belt path guides and the Lockoff as shown.

After the base has been installed, if your car has a switchable retractor, you may also use it to lock the belt.

If the Lockoff cannot be used properly, then do not install the base using vehicle belt installation. See page 3 of quick start guide for UAS install.

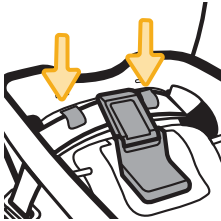

7

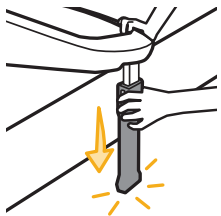

Extend Load Leg

- Squeeze the buttons on the load leg and pull it down until it meets the vehicle floor.
- It **must be** perpendicular to the vehicle floor.

⚠ Do not use the load leg if it does not reach the floor of your vehicle. **Do not** use the load leg on top of vehicle storage compartments. Review your vehicle owner's manual.

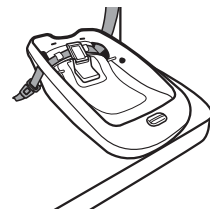

Vehicle Belt Base Install Finished!

To install the outer carrier to the base, see page 55 of the instruction manual.

Check the tightness of the install often to make sure it has not loosened.

Coral XP Quick Start Installation Guide

This quick start installation guide helps you use your Maxi-Cosi car seat right away. However, please read the complete instruction manual and all labeling on the car seat. They include important warnings and additional safety information.

