

INSTALLATION INSTRUCTIONS

Commercial Brass Shower Head

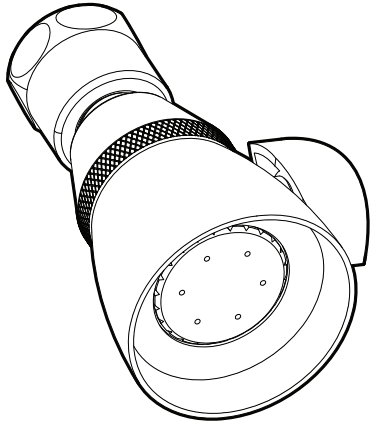

IMPORTANT

SAFETY TIPS:

Be sure to read and understand all instructions before beginning installation.

Inspect all connections after installation.

Cover the drain to avoid loss of parts.

Be sure to wear proper eye protection.

Do NOT over tighten any connections or damage may occur.

Shut OFF water supplies before beginning installation.

Observe all local plumbing and building codes.

This shower head has an optimal operating range of 20-80 psi

APPLY THREAD SEAL TAPE

- 1 Apply the included Thread Seal Tape to the outlet side of shower arm in a clockwise direction.

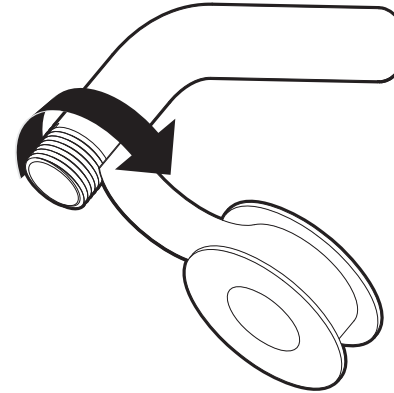

INSTALL SHOWER HEAD

- 2 Thread Shower Head onto shower arm by turning it in a clockwise direction. Tighten with Adjustable Wrench. Turn water supply on and check for leaks.

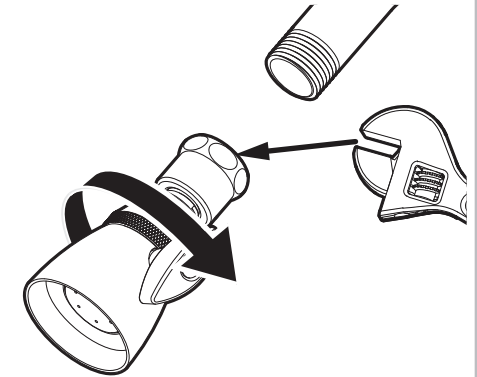

TOOLS & SUPPLIES NEEDED

Thread Seal Tape
(INCLUDED)

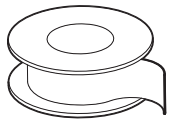

Adjustable
Wrench



MAINTENANCE

Periodic cleaning using a mild soap and warm water will help keep your shower's appearance in its original condition.

For best results, dry immediately with a soft, clean cloth. **DO NOT USE** harsh and/or abrasive cleaners.

To help restore the finish, occasionally apply a non-abrasive wax to your shower (follow manufacturers' instructions).

On CHROME PLATED SHOWERS, a two (2) part white vinegar, one (1) part water solution can be used to break down excessive mineral deposits on the sprays. Let the showerhead soak in the solution for about ½ hour then rinse thoroughly. Brush off any remaining mineral deposits if necessary.

DO NOT USE the vinegar/water treatment on any finish other than Chrome.

To reduce mineral build-up, turn the handle to FLOOD position to let the water drain out after every use.

ADJUST SPRAY PATTERN

- 3 Adjust spray pattern by rotating side handle to preferred spray position.

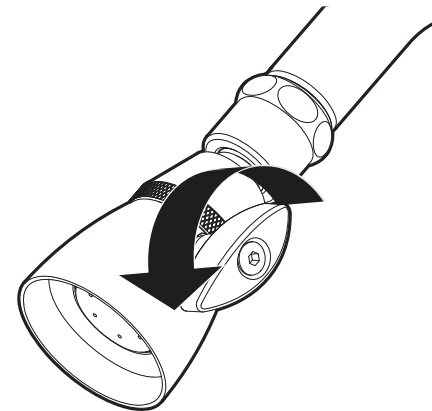

ROUGH IN DIAGRAM

ASME A112.18.1/CSA B125.1 Compliant

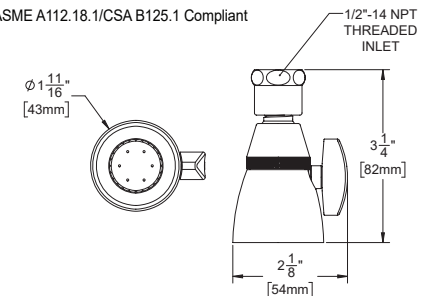

Model: S-2292
Max. Flow Rate: 2.5 gpm (9.5 L/min)
Min. Flow Rate: 2.0 gpm (7.6 L/min) @ 45 psi
For use with automatic compensating valves rated at 7.6 L/min (2.0 gpm) or less.

Model: S-2292-E175
Max. Flow Rate: 1.75 gpm (6.6 L/min)
Min. Flow Rate: 1.3 gpm (4.9 L/min) @ 45 psi
For use with automatic compensating valves rated at 4.9 L/min (1.3 gpm) or less.