

Brookings Bath Vanity Fully Assembled 49x22
Sherwin Williams® White Base and Ivory Swirl Top

**FULLY
ASSEMBLED
VANITY**

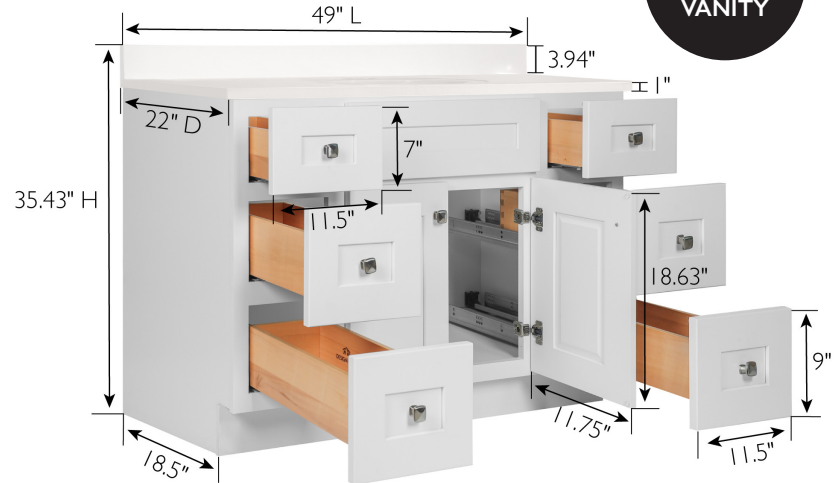

SPECIFICATIONS

MATERIAL CONSTRUCTION:	Wood/Cultured Marble	TOE KICK INSET WIDTH:	4.5"
ASSEMBLY REQUIRED:	No	BACK PANEL MATERIAL:	Plywood
ASSEMBLED DIMENSIONS:	35.43" H x 49" L x 22" D	BACK BRACE MATERIAL:	Solid Wood
ASSEMBLED WEIGHT:	163.42 .lbs	FAUCET TYPE:	Lav Centerset
TOOLS NEEDED FOR INSTALLATION:	Phillips Screwdriver; Rubber Mallet, Wood Glue	NUMBER OF MOUNTING HOLES:	3
CONSTRUCTION TYPE:	Face Frame	BOWL MATERIAL:	Ceramic
HINGE STYLE:	Soft Close	BACK SPLASH INCLUDED:	Yes
DOOR STYLE:	2 Shaker Doors	COLOR:	White
FACE FRAME MATERIAL:	Solid Wood	NUMBER OF BOWLS:	1
SIDES MATERIAL:	Plywood	BOWL DIMENSIONS:	16.85" W x 11.63" D
BOTTOM MATERIAL:	Plywood	BOWL SHAPE:	Oval
		SINK THICKNESS:	1"
		MOUNTING TYPE:	Floor Mount
		OVERFLOW HOLE:	Yes
		WARRANTY:	1-Year limited warranty
		TSCA TITLE IV COMPLIANT:	Yes
		LEGAL FOR SALE IN CALIFORNIA:	Yes
		PROP 65 HARMFUL MATERIAL:	Formaldehyde



TYPE:
JOB:
ORDER CODE:
APPROVALS: