

SIDES	BOTTOM

Material: Steel-Welding tube, zinc plated

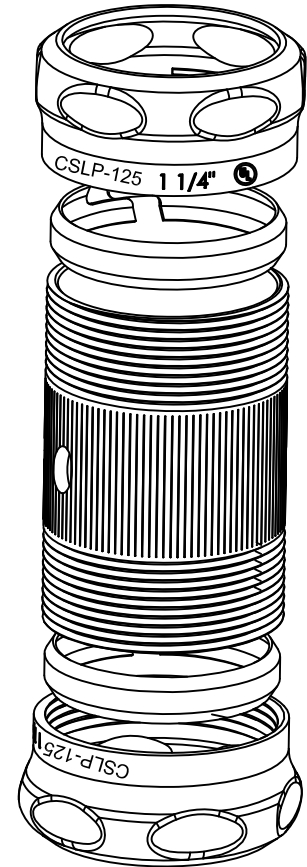
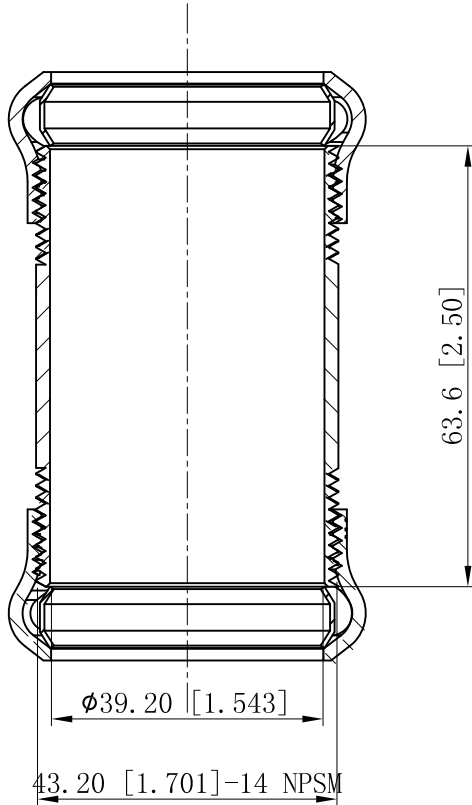
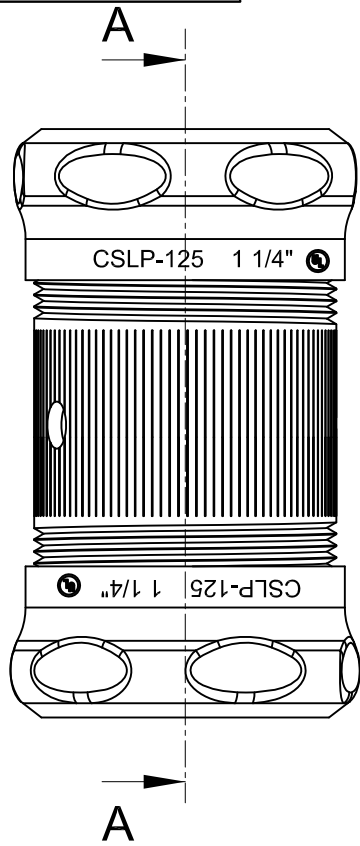

CUTAWAY VIEW A-A

This data sheet is for reference only .GARVIN INDUSTRIES reserves the right to make changes to the design without prior notice.

DESCRIPTION
TRADE REFERENCE TERMS

STANDARD PACKING	<h1>GARVIN INDUSTRIES</h1>		
25 PCS			
TITLE	STEEL EMT SET COMPRESSION CONNECTORS		
SIZE	DWG NO.	CSLP-125	REV B
		DATA SHEET	
www.garvinindustries.com			