

USER'S MANUAL

746UAB

BLUETOOTH®-ENABLED

MP3-COMPATIBLE CD AM/FM RECEIVER



BOSS[®]
AUDIO SYSTEMS

Thank you for choosing Boss Audio Systems! This unit will bring you years of enjoyment.

CONTENTS

Safety Precautions.....	2-3
Installation.....	4-6
Wiring Connections.....	7
Basic Operation.....	8
Radio Operation.....	9
CD/MP3/WMA/USB/SD Operation.....	10-11
Bluetooth Operation.....	12-13
Maintenance.....	14
IR Remote Control.....	15
Troubleshooting Guide.....	16

SAFETY PRECAUTIONS

⚠ **Important Warnings to Take Note of BEFORE Starting the Installation**

⚠ **Damage Caused By Incorrect Installation or Usage is NOT Covered By Warranty.**

PLEASE Take the Time to Read the Installation Notes Carefully.

⚠ **Please make all necessary connections and terminate any unused wires so they do not short. If you feel uncomfortable performing the install consult a professional installer.**

- **To avoid any possible damage to your vehicles electrical system, be sure to disconnect the battery cable before beginning installation.**
- The unit is intended for vehicles with a 12-volt battery and negative grounding.
- Before installing the unit in a recreational vehicle, truck, or bus, check that the battery voltage is 12 volts.
- **Remove the two transport screws from the top of the unit before installation.**
- Be sure to connect the negative (-) speaker leads to the negative (-) speaker terminal. Never connect the negative (-) speaker leads to chassis ground.
- This unit is only designed for use with 4 speakers. Do not combine outputs for use with 2 speakers. Do not ground negative speaker leads to the chassis ground.
- Speakers connected to this unit must be high-power units with a minimum rating of 80W and impedance of 4 to 8 ohms. Connecting speakers with output and/or impedance values other than those noted there will result in damage to the head unit and the speakers.
- **Check the condition off your speakers carefully - connecting the unit to old degraded speakers may result in a fault which will damage the audio IC and void the warranty.**

If this unit is installed in a vehicle that does not have an ACC (accessory) position on the ignition switch, the red lead of the unit should be connected to a terminal coupled with ignition switch ON/OFF operations. If this is not done, the vehicle battery may be drained when you are away from the vehicle for several hours.

SAFETY PRECAUTIONS

- Secure the wiring with zip ties or electrical tape. To protect the wiring, wrap adhesive tape around them where they lie against metal parts. To avoid short-circuiting, cover all disconnected lead with insulating tape. There is a possibility of short-circuiting if the leads are not insulated.
- Route and secure all wiring so it cannot touch any moving parts, such as the gear lever and handbrake. Do not route wiring in places that get hot, such as near the heater outlet. If the insulation of the wiring melts or gets torn, there is a danger of the wiring short circuiting to the vehicle's body.
- Don't pass the yellow lead through a hole into the engine compartment to connect to the battery. This will damage the lead's insulation and cause a very dangerous short.
- Do not shorten any leads, if you do, the protection circuit may fail to work when it should.
- Never feed power to other equipment by cutting the insulation of the power supply lead of the unit and tapping into the lead. The current capacity of the lead will be exceeded, causing overheating.
- Since a unique audio I/C circuit is employed, never wire so the speaker leads are directly grounded or the left and right - speaker leads are common.
- When this product's source is switched ON, a control signal is turned on through the change color to Blue/White lead. Connect to an external power amp's system remote control or the car's Auto-antenna relay control terminal (max. 300mA 12V DC).
- Do not block any vents or heater panels, Blocking them will cause heat to build up and may result in fire.
- When replacing the fuse(s) the replacement must be of the same amperage as shown on the fuse holder. Never replace a fuse with another of a different value. If the fuse blows again please contact your installation company. Double check that all wiring and connections are correct before re-connecting the battery and turning on the unit.
- After completing the installation and before operating the unit, reconnect the battery, then press the (RES) button with a pointed object, such as a ball-point pen to set to unit to it's initial status. After pushing the button, wait a few seconds for the red light to flash.

INSTALLATION

Tools for Installation

2 removal wrenches are supplied for taking out the old unit and replacing it with your new Boss Audio Systems car stereo. The following tools and supplies may also be needed for the installation:

Tools for Installation: Philips Screw-drivers /Machine Screws /Wire Stripper /Wire Cutter /Hammer /Pencil /Electrical Tape /Electric Drill

Supplies for Installation: Machine Screws /Crimp Connectors /14 Gauge Wire for Power Connections /14-16 Gauge Speaker Wires

The above are not supplied.

Before you install

Automotive audio equipment installations can be challenging even to the most experienced of installation technicians. We strongly recommend that this unit should be professionally installed by a authorized dealer (this is a requirement to validate the extended warranty).

IMPORTANT: Remove the two transport screws from the top fo the unit before installing.

Remove the Old Unit from the Dashboard

1. Remove the outer trim frame.
2. Insert the keys supplied with the old unit into both sides of the unit as shown in figure below until they click. Pull to remove the old unit from the dashboard.

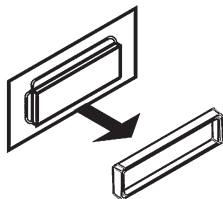

DIN Front Mount

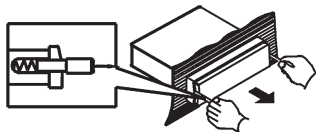

**DO NOT DISCONNECT WIRES
AT THIS TIME!**

Mark Polarity of the Speaker Wires

Marking the polarity of the speaker wires will make it easier to connect the existing speakers to your car radio. Consult wiring diagram of existing head unit before disconnecting any wires. If you are not positive of the polarity of the existing wires from the speakers to the head unit, install new wires.

1. While the old unit is playing, disconnect the wires from one speaker.
2. Take a length of masking tape and fold it around the wire so it forms a flag.
3. On the masking tape mark the polarity of the speaker wires (+&-), as well as left or right, and front or rear.
4. Double check that you marked the first speaker correctly by checking that the speaker wires are the same at the head unit.
5. Repeat this procedure for all of the speakers.
6. Mark the power, ground, and any other wires also.

INSTALLATION

WARNING!

Disconnect negative battery terminal from battery before starting installation.

NOTE: Mark the polarity of the existing speaker wires before disconnecting battery.

NOTE: Remove the two transport screws from the top of the unit before installing.

DIN Front Mount

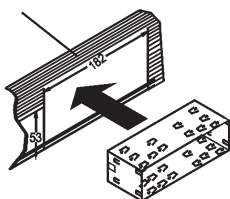

1. After removing the old radio and mounting sleeve, insert supplied mounting sleeve into opening.

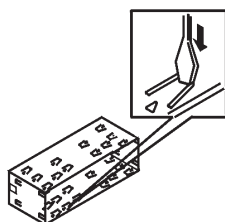

2. Bend the tabs on the mounting sleeve to keep the mounting sleeve firmly in place.

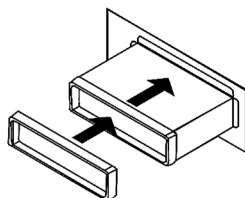

3. Attach wires from the unit to existing wires. See wiring connections diagram. Insert radio into dashboard. Then apply the trim frame to outside of radio.

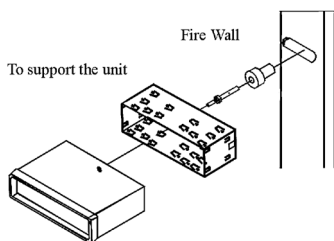

4. Support radio using rear mounting bolt and steel bar. (not included)

DIN Rear Mount

NOTE: Outer trim frame, hook, and mounting sleeve are not used for this installation

This is only intended as a general guide; contact the vehicle's manufacturer for specific instructions.

This method of installation uses the screw holes at the sides of the unit and the holes of the existing vehicle mounting bracket.

1. Remove the hooks on both sides.
2. Align the screw holes of the mounting bracket supplied with the car and the screw holes of the main unit. Tighten the 2 screws on each side of the unit. Then fasten the brackets to the car.
3. Attach wires of the unit to existing speaker wires. See wiring diagram.

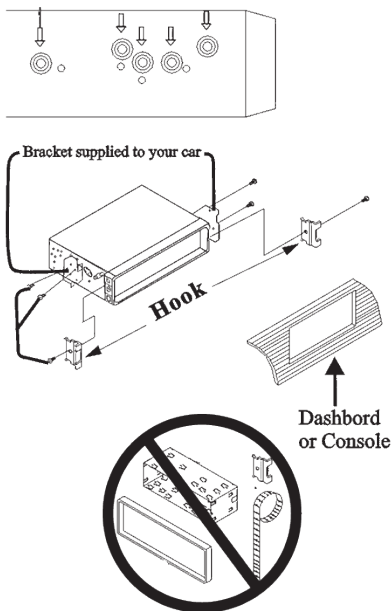

WIRING DIAGRAM

Make sure You have a good chassis ground. Good ground connection will eliminate most electrical noise problems. A good chassis ground requires a tight connection to the vehicle's metal chassis. The area around the ground connection should be clean, bare metal without rust, paint, plastic, dust, or dirt for a good ground connection.

Black Ground

Connect to vehicle body/chassis. Make sure you have a good chassis ground. This will eliminate most electrical noise form the motor and alternator. A good chassis ground requires a tight connection to ground. The area should be free from rust, paint or any form of dirt.

Yellow Memory Backup

Connect to electrical terminal always supplied with power regardless of ignition switch position.

Orange Remote

Connect to Auto-antenna or power amp control wire/remote connection. Maximum current 500mA 12VDC. (Low Current)

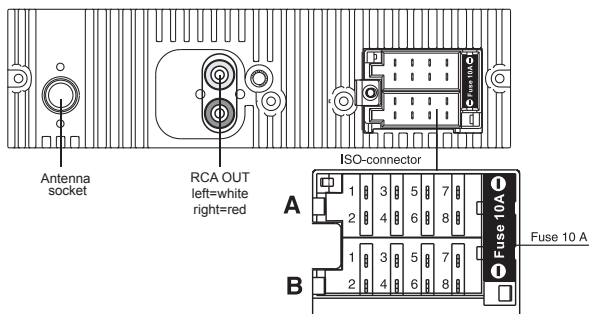

Connector A

1. Rear right speaker(+)/Purple
2. Rear right speaker(-)/Purple-Black
3. Front right speaker(+)/Grey
4. Front right speaker(-)/Grey-Black
5. Front left speaker(+)/White
6. Front left speaker(-)/White-Black
7. Rear left speaker(+)/Green
8. Rear left speaker(-)/Green-Black

Connector B

1. -
2. -
3. -
4. Battery 12V (+)/Yellow
5. Remote Trigger/Blue-White
6. -
7. ACC+/Red
8. Ground/Black

Speaker Wiring Notes:

Follow the above wiring diagram to install the head unit with new or existing speakers.

1. This unit is designed for use with four (4) speakers with impedance between 4 Ohms to 8 Ohms.
2. An Impedance load of less than 4 Ohms could damage the unit.
3. Never bridge or combine the speaker wire outputs. When not using four speakers, use electrical tape to tape the ends of the unused speaker outputs to prevent a short circuit.
4. Never ground the negative speaker terminals to chassis ground.

Basic Operation

1. Tuning the unit On / Off

Press any Button to turn the unit on, the display will show a message "BOSS AUDIO" to indicate it is ready for use. Press and hold the POWER button to turn the unit off. The display will show a message "GOODBYE".

2. Mode Selection

Press the SRC Button to select Radio Mode. Press the SRC Button to cycle the Play Mode among AUX, RADIO and CD PLAY.

Note: USB & SD mode will only show on the display when a USB flash memory or SD card is inserted into the USB port or SD port.

3. Loudness Control

Press the SEL button until "LOUD OFF" is shown on the display indicates that the loudness function is OFF. Turn the volume knob to select between ON or OFF.

4. Mute Control

Press the POWER/MUT button active or cancel Mute function.

5. Volume

Use the VOL +/- Button to adjust the volume level. The larger the number, the higher the volume level.

6. Bass/Treble

Press the SEL Button repeatedly until the display shows "BAS 00"/"TRE 00". Use the VOL +/- Button to adjust. When EQ is ON, bass/treble control is not available.

7. Balance/Fader

Press SEL Button repeatedly until the display shows "BAL L-R"/"FAD F-R", then use the VOL +/- Button to adjust the balance between the left & right speakers.

8. Clock

The time clock can be set anytime when the power is on. Press the CLK Button on the faceplate or remote control once, the time will show on the display.

Then press and hold the button until the hour blinks on the display. Rotate the VOL knob to set hours, then press the VOL knob for the minutes to blink and rotate the VOL knob to set.

Press the CLK button again or leave the unit idle for new setting to effect. Press the CLK button anytime to view the time clock display.

9. Preset Beep Sound Off

Press the SEL button repeatedly until "BEEP OFF" is displayed. Turn the VOL +/- Button to select "BEEP ON" or "BEEP OFF", then leave the unit idle for setting to take effect.

10. Preset Equalizer Function

Press the SEL Button repeatedly until "EQ" indication is displayed then rotate the Volume knob to choose between the EQ sound effects. The Sequence of equalizer setting will be as follows:

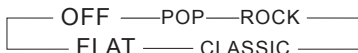

Radio Operation

1. Choose Radio Band

Press the SRC Button to access the radio function.

The unit comes with five bands- three FM Bands (FM1, FM2, and FM3) and two MW Bands (MW1, and MW2) selects. Each of the five bands can store up to six preset stations, for a total of 30 preset memory stations.

2. Radio Tune / Seek Function

In Radio Mode, press and hold the SEEK |<< or >>| Button for 2 seconds, and the display will show "MANUAL". Then Press the SEEK |<< or >>| Button once to manually adjust the radio frequency.

3. Tuning

Press the SEEK |<< or >>| Button once the radio will seek the next strong and clear frequency station. Repeat to seek more stations in your listening area with a strong signal.

4. Mono/Stereo Reception Control

In FM radio mode, Press the SEL Button until "STEREO" is shown on the display. Rotate the VOL +/- to select STEREO or MONO. Improvement of reception of distant stations can be done by selecting "MONO" operation which may cut down some reception noise.

5. Local / Distant Control

In FM radio mode, Press the SEL Button until "DX" is shown on the display. Rotate the VOL +/- to select "LOCAL" or "--DX--".

Local and distance reception setting can facilitate the radio reception, depending on the location in which the radio is being used.

6. Save Your Preset Stations

There are six numbered preset buttons which can store and recall stations for each band. While listening to a radio station you would like to save as a preset, press and hold one of the buttons numbered 1-6 until you hear a beep. The button you pressed is now the pre-set button for that station.

7. Automatic Store/Preset Scan

There are six numbered preset buttons which can store and recall stations for each band. While listening to a radio station you would like to save as a pre-set, press and hold one of the buttons numbered 1-6 until you hear a beep. The button you pressed is now the pre-set button for that station.

A. Automatic Scan & Store

While listening to the FM Radio, press and hold the F/PS Button. The receiver will automatically scan and save stations of the 3 FM Bands.

While listening to the MW Radio, press and hold the F/PS Button. The receiver will automatically scan and save stations of the 2 MW Bands.

B. Scan & Preview Saved Stations

Press the F/PS button once and the receiver will scan the radio stations in the current band.

CD/MP3/WMA/USB/SD Operation

1. Insert / Eject CD

Insert a disc into CD slot with label side up. The disc will be automatically loaded into the unit, even when it is off or at radio mode. The word "LOAD" will blink on the display and the CD will play automatically. Press the EJECT Button to eject the disc from the slot. If the disc is not removed from the slot within 5 seconds, it will automatically be loaded into the slot again. When the disc is ejected and removed, the unit will automatically switch to radio mode.

While you are playing a disc with MP3 or WMA, The first file in the root folder will be played. If there is any ID3 information that will be displayed as the file is playing.

To play MP3/WMA files from a USB flash memory or SD card, insert a USB flash memory or SD card into the USB port or SD port of the unit. The unit will start playing MP3/WMA files on the USB flash memory automatically.

If the MP3/WMA files are stored in folders on the USB drive, the unit will start by playing the first song in the first folder. After playing all the files sequentially in the first folder, the unit will play sequentially all of the files in the next folder. The unit will continue playing through all of the folders on the USB drive in this manner.

If the USB drive has loose files and folders containing files, it will play the loose files sequentially, then it will play the files in the folders sequentially.

2. Multi-Session CD Reading

This unit can read multi-session CDs. The multi-session reading will be activated automatically if the player detects a file that is written in multi-session format.

3. Selecting Tracks

Press the SEEK >>| Button to advance CD to the next track. Track numbers will be shown on the display. Press and hold SEEK >>| to fast forward.

Press the SEEK |<< Button to go to a previous track. Track numbers will be shown on the display. Press and hold the SEEK |<< Button to fast reverse. Disc will play normally when the No. 1(play/pause) Button is pressed.

4. Play / Pause CD

Press the No.1/PAU Button to pause the CD. Press this button again to resume playback.

5. Scanning Tracks

Press the No.2/INT Button to play the first 10 seconds of each track, "INT" will be displayed on the display. Press this button again to resume playback.

6. Repeat

Press the No.3/RPT Button to repeat the current track. Press it again to cancel.

7. Random

Press the No.4/RDM Button to play all the tracks in random order. "RDM" will appear on the display. Press this button again to stop random play.

8. Folder Down

Press the "5 𠄎" button once to go back one folder.

CD/MP3/WMA/USB/SD Operation(Con'd)

9. Folder UP

Press the "6  + " button once to advance one folder.

10. Search Modes

There are 3 search modes to help find your favorite MP3 & WMA tracks. The search modes only works with MP3/WMA CDs, and USB flash memory with MP3/WMA files.

A. Simple Track Search

Press the SEEK |<< or >>| Button to go to the next track or previous track.

B. Track Search

Press the F/PS Button, TRK-SCH will appear on the display. Use the VOL +/- Button to select the track number. press the SEL button so that the chosen track will start to play.

C. Folder Search

Press the F/PS Button twice and NAVIGATE will be shown on the display. Use the VOL +/- Button to select the folder name. Then press the SEL Button to play the chosen folder.

11. Electronic Skip Protection

Electronic Skip Protection is for driving on rough roads. The CD will play for 10 seconds on rough roads without skipping. If driving on a rough road for more than 10 seconds the CD may skip. For MP3 or WMA files will play for 60 seconds. If the road is rough for more than 60 seconds the CD with MP3 or WMA files may skip.

Bluetooth Operation

Pairing Your Mobile Phone

Before using Bluetooth functions, you must pair your mobile phone and the unit. Pairing is a special process used when two devices connect for the first time. The pairing process is used to generate a link key that is used for authentication purposes for future Bluetooth connections between devices. Your mobile phone can initiate a search for a new device and pair the unit.

1. Access the mobile phone's Bluetooth function and set the Bluetooth function to on
2. Use the mobile phone's add a new device feature. "BOSS AUDIO" appears in the list on your mobile phone.
3. Select "BOSS AUDIO". The unit has an auto pairing function. It will search for the Bluetooth mobile phone and pair automatically. A prompt to connect should appear on your mobile phone. Accept the request and initiate the process
NOTE: Some mobile phones require a "pass key" or pairing code to connect. If your phone requires a pass key or pairing code, you will need to enter this number. The default pairing code for the unit is "0000".

Auto-Reconnection

This unit has a built-in auto-reconnection function. In some conditions, the unit will auto reconnect with the mobile phone (note: the mobile phone must have been paired with the unit before.)

- When you turn off the unit and then turn it on again.
- Switch off the ACC wire and switch it on again.

Managing Incoming Calls

Answering an Incoming Call

Press the GREEN button to answer an incoming call.

Rejecting an Incoming Call

Press the RED button to reject the incoming call.

Bluetooth Operation

Audio Streaming (A2DP)

Note: *Your mobile phone must support this function. Please refer to your mobile phone's instruction manual.*

When in A2DP mode

Press the PREVIOUS button on the front panel of the unit to choose the previous track.

Press the NEXT button on the front panel of the unit to choose the next track.

Press the APS/PAUSE button on the panel control to pause play.

Other Operations

1. AUX Input

The AUX Input Jack is a 3.5mm stereo jack on the front panel of the unit. Press the Mode button to choose AUX. Connect any portable audio device such as a MP3 player to unit. Use the volume control to adjust volume.

2. Front Pre-amp Output

The RCA Output Jack is on the back of the unit. (Refer to Wiring Diagram) This output is for connecting amplifier, equalizer, or other audio component that requires a pre-amp out connection. (Red=Right, White=Left) Follow the manufacturer's instructions for the audio component that you are connecting.

Maintenance

Cleaning the Unit

Do not use any liquids to clean this unit.

Do not use petroleum distillates to clean this unit.

Use a clean, dry cloth to clean this unit.

Replacing the Fuse

Make sure the amperage matches the specified value when replacing the fuse(s). If the fuse is bad, check the power connection and replace the fuse with a new one. If the same problem occurs, this might indicate a malfunction within the unit.

Warning

When replacing a fuse, do not use a fuse with a higher amperage rating than the fuse originally supplied to your unit, otherwise damage will result to your unit.

IR Remote Control

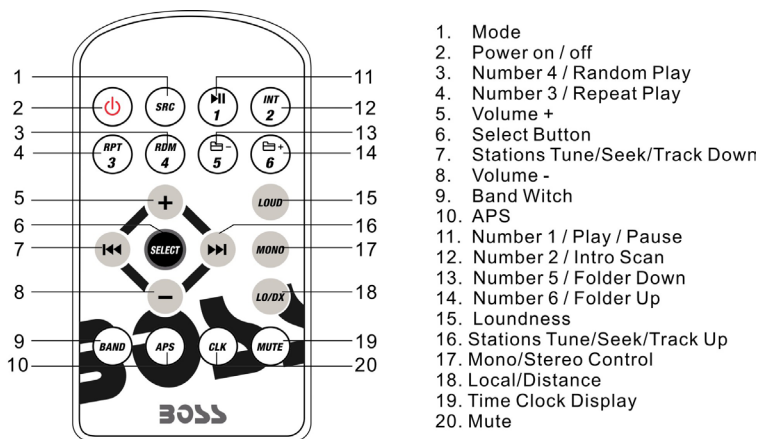

1. Mode
2. Power on / off
3. Number 4 / Random Play
4. Number 3 / Repeat Play
5. Volume +
6. Select Button
7. Stations Tune/Seek/Track Down
8. Volume -
9. Band Witch
10. APS
11. Number 1 / Play / Pause
12. Number 2 / Intro Scan
13. Number 5 / Folder Down
14. Number 6 / Folder Up
15. Loudness
16. Stations Tune/Seek/Track Up
17. Mono/Stereo Control
18. Local/Distance
19. Time Clock Display
20. Mute

This unit comes with a full remote control system. The CR-2025 Lithium battery is an included item with the remote control. **TO PLACE THE BATTERY:**

- (1) Remove the cover from the back of the remote control.
- (2) Insert a CR-2025 Lithium battery.
- (3) Insert the battery holder into the back of the remote control.

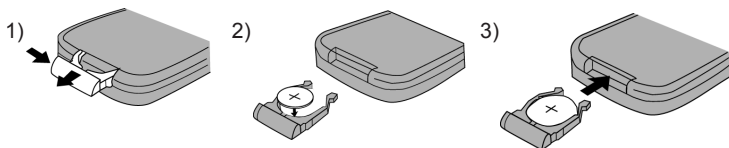

Operating the remote control

Aim at the face panel of the CD Receiver, the maximum distance at which signals can be received is about 6M. Make sure that the signal path is not obstructed. Do not drop or throw the remote control. Do not place the remote control in a location that is exposed to direct sunlight or next to a heating unit or other heat source.

Troubleshooting Guide

PROBLEM	CAUSE/SOLUTION
No Power	Check and make sure that the fuses did not blow.
Errors are displayed on the screen or no function is active	Unplug your car radio then plug it again
No radio reception	Check the connection of the antenna. Make sure the antenna is completely extended and that it is not broken
CDs cannot be loaded	A CD is already inside the appliance. Make sure that the fixing screws of the CD mechanism have been removed.
The stereo indicator is blinking	Set the frequency more accurately. The reception signal is too low.

Specifications

GENERAL

Operating Power.....	12 Volts DC, Negative Ground
Speaker output.....	4 speakers
Front Pre-amp Output.....	1V
Output Impedance.....	4 to 8 Ohms
Fuses.....	10 A
Dimensions.....	178mm(W) x 178mm(D) x 51mm (H)
Weight.....	2.0 Kg

CD PLAYER

Signal / Noise Ratio.....	>80dB
Frequency Response.....	20 Hz~20KHz
Channel Separation.....	>50dB
D / A Converter.....	16 Bit

FM TUNER

Tuning Range.....	(USA) - 87.5 - 107.9MHz, (Europe) - 87.5 - 108 MHz
FM Sensitivity.....	12dBu
Stereo Separation @ 1 KHz.....	35dB

AM TUNER

Tuning Range.....	(USA) -- 530-1710 KHz, (Europe) -- 522-1620 KHz
AM Sensitivity.....	30dBu

USER'S MANUAL

746UAB

BLUETOOTH®-ENABLED | MP3-COMPATIBLE CD AM/FM RECEIVER

BOSS®
AUDIO SYSTEMS

BOSS Audio Systems

3451 Lunar Court • Oxnard, CA 93030

www.bossaudio.com | 805.751.4853

tech support: www.bossaudio.com/technical-support



0115

iPod®/ iPhone® are registered trademarks of Apple, Inc., in the U.S. and other countries.
BOSS Audio Systems is not affiliated with Apple, Inc. or Google, Inc.