



Sink Specifications

| | |
|----------------------|--------|
| Color | SKU |
| Satin brushed finish | 443147 |

Design and Planning Tips

- Min cabinet size: 28 in

What is included:
Installation instructions
Cut-out template
Limited Lifetime Warranty

Drain hole compatible with 3.5" strainers or waste flanges

Depending on cabinet construction, a different cabinet size may be required.

Nested SKU: 203958

Codes & Standards

ASME A112.19.3-2017/CSA B45.4-17

Optional Accessories

| | |
|----------------------------|--------|
| Sink clips | 212594 |
| Sink Grid | 203999 |
| Colander | 224387 |
| Glass Cutting Board | 224390 |
| Ash Compound Cutting Board | 231609 |
| CapFlow Strainer Cover | 517666 |
| Elevated Grid | 231608 |

QUATRUS R15 28 Stainless steel Satin brushed finish

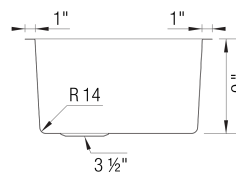
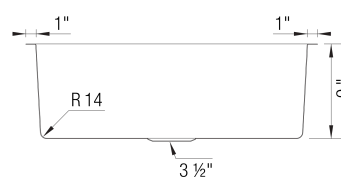
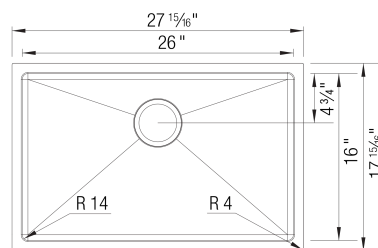

Warranty

BLANCO offers a limited lifetime warranty on all sinks and faucets, as well as a one-year warranty on all custom accessories.

Code/Standards Compliance

BLANCO sinks and faucets are third-party tested and certified to standards and listed by applicable certification bodies. For more information on individual product listings, contact our office or listing organization.



View our how-to videos to learn more about installing and caring for BLANCO products:
<https://www.blanco.com/us-en/service/how-to-videos/how-to-videos-for-sinks/>

Questions? Contact us today



BLANCO America, Inc.
110 Mount Holly By-Pass
Lumberton, NJ 08048

Phone & Fax
Phone: 888-668-6201
Fax: 609-668-6211

While BLANCO endeavors to provide accurate information, all dimensions are nominal, cannot be guaranteed, and are subject to change or cancellation. BLANCO assumes no responsibility for use of superseded or voided specifications.