

# INSTRUCTIONS FOR OCEAN SIGNAL MOB1

## How to Fit an Ocean Signal MOB1 to the Atlas 190 Hammar Life Jacket

These instructions will guide you through fitting your device into an Atlas lifejacket. Follow each step carefully to ensure it functions safely and correctly. Handle the lifejacket and all device components with care to avoid damage during installation.

### Before You Begin

Make sure you're familiar with how your Personal Locator Beacon (PLB) works—especially how to disable and re-enable it. You'll need to do this during the fitting process. If unsure, please refer to your Original Equipment Manufacturer's (OEM) manual.

You will need a sharp pair of scissors and a flat surface to work on.

### Step 1: Open the Lifejacket

Open your Atlas lifejacket via the burst point and peel the cover apart to expose the inflatable bladder. Spread the bladder out flat, being careful not to catch or snag the manual inflation cord.

*(For more details on unpacking, refer to your user manual.)*

### Step 2: Cut the Lower Slot

Using scissors, carefully cut the lower slot along the dotted line. Be sure not to cut or damage the inflatable bladder.

*(Fig. 1)*

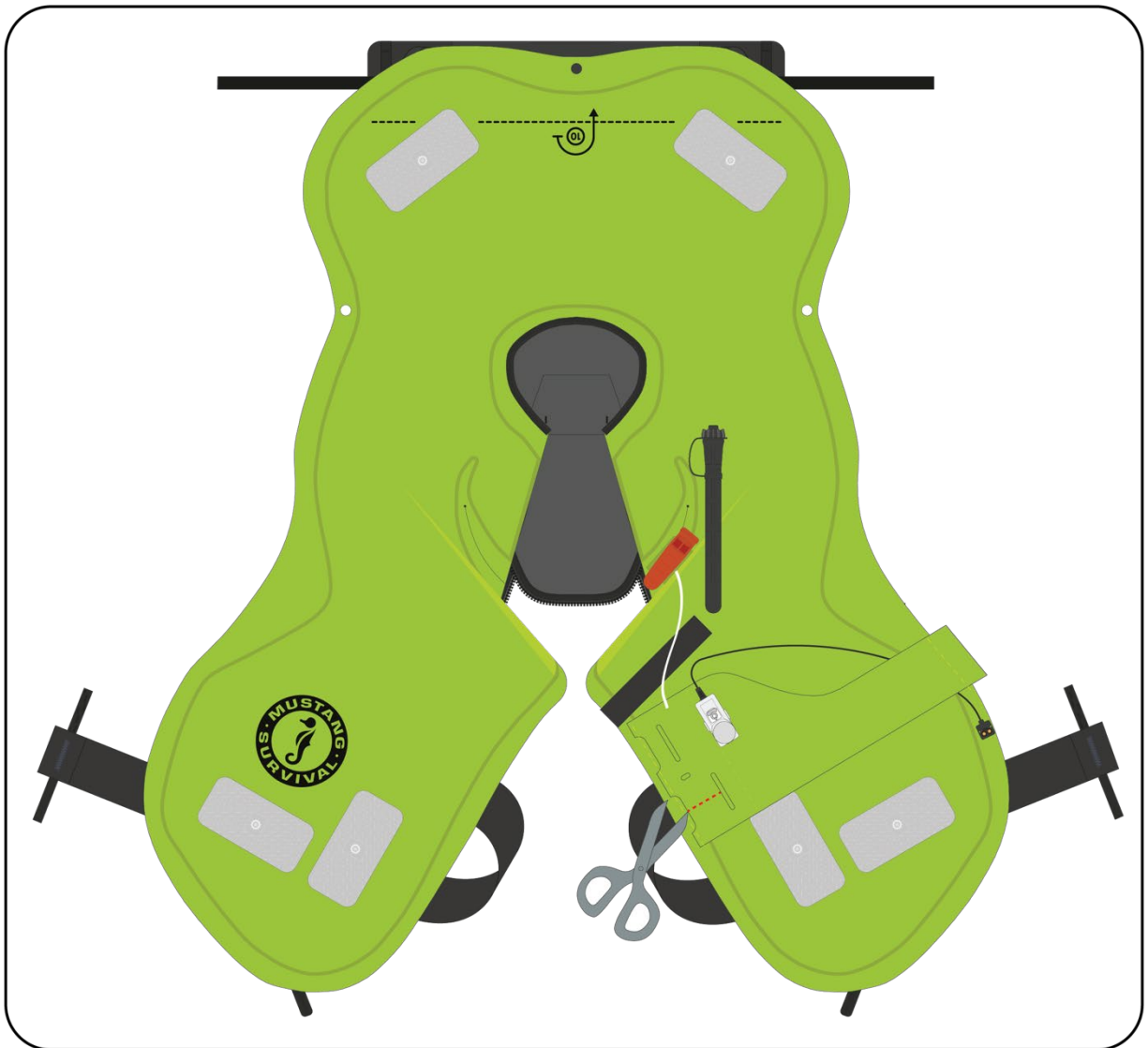

*Fig 1*

### Step 3: Attach the Device

Slide the fitting clip into the upper slot (*Fig. 2a*). Then, insert the end of the device through the lower slot (*Fig. 2b*) and mount it on the fitting clip.

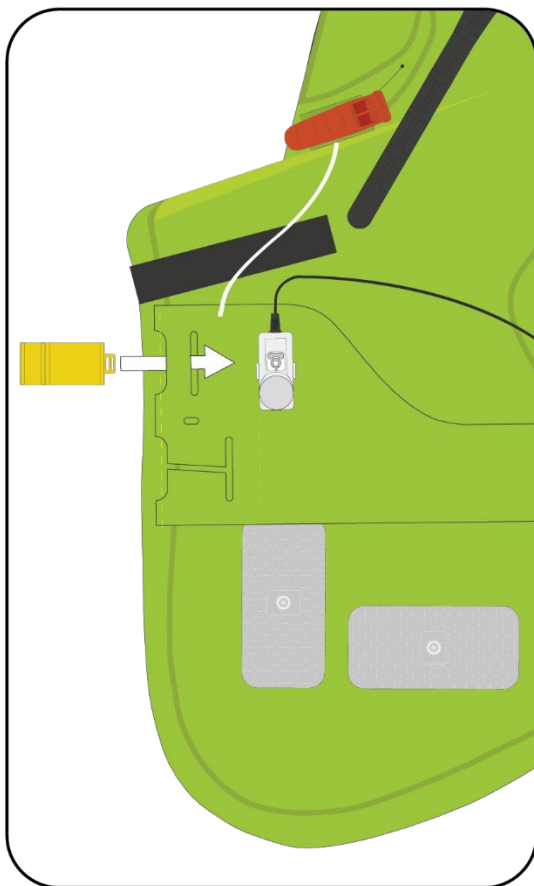

*Fig 2a.*

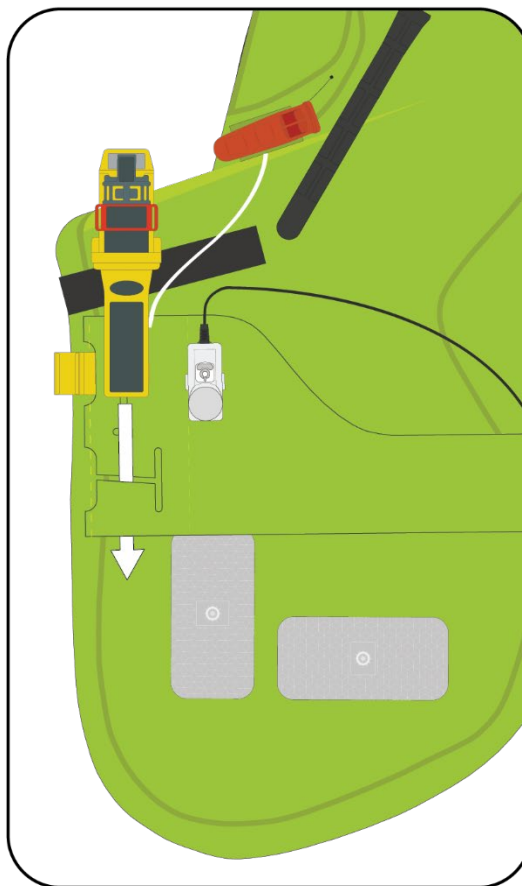
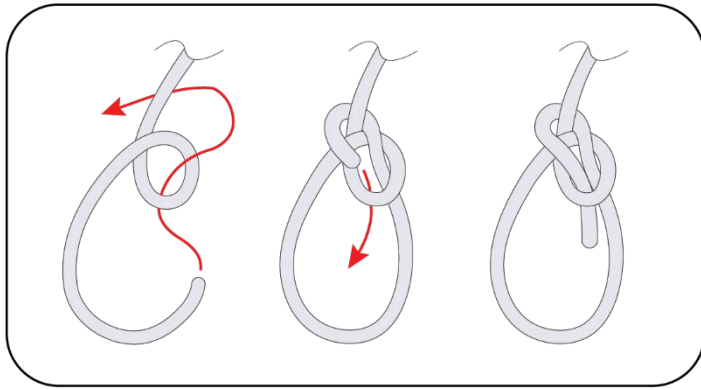

*Fig 2b.*

#### **Step 4: Attach the Security Lanyard**

Tie the security lanyard—located on the bladder next to the whistle—through the device’s top right tether slot using a bowline knot.

*(Fig. 3a and Fig. 3b)*



*Fig 3a*

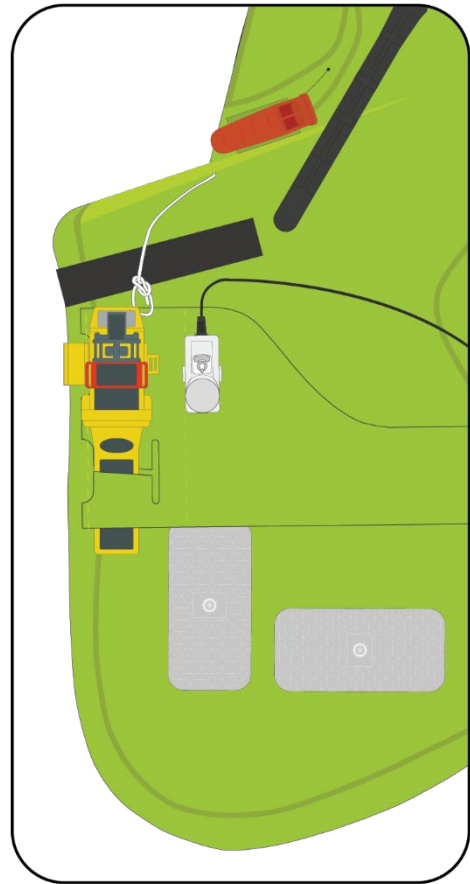
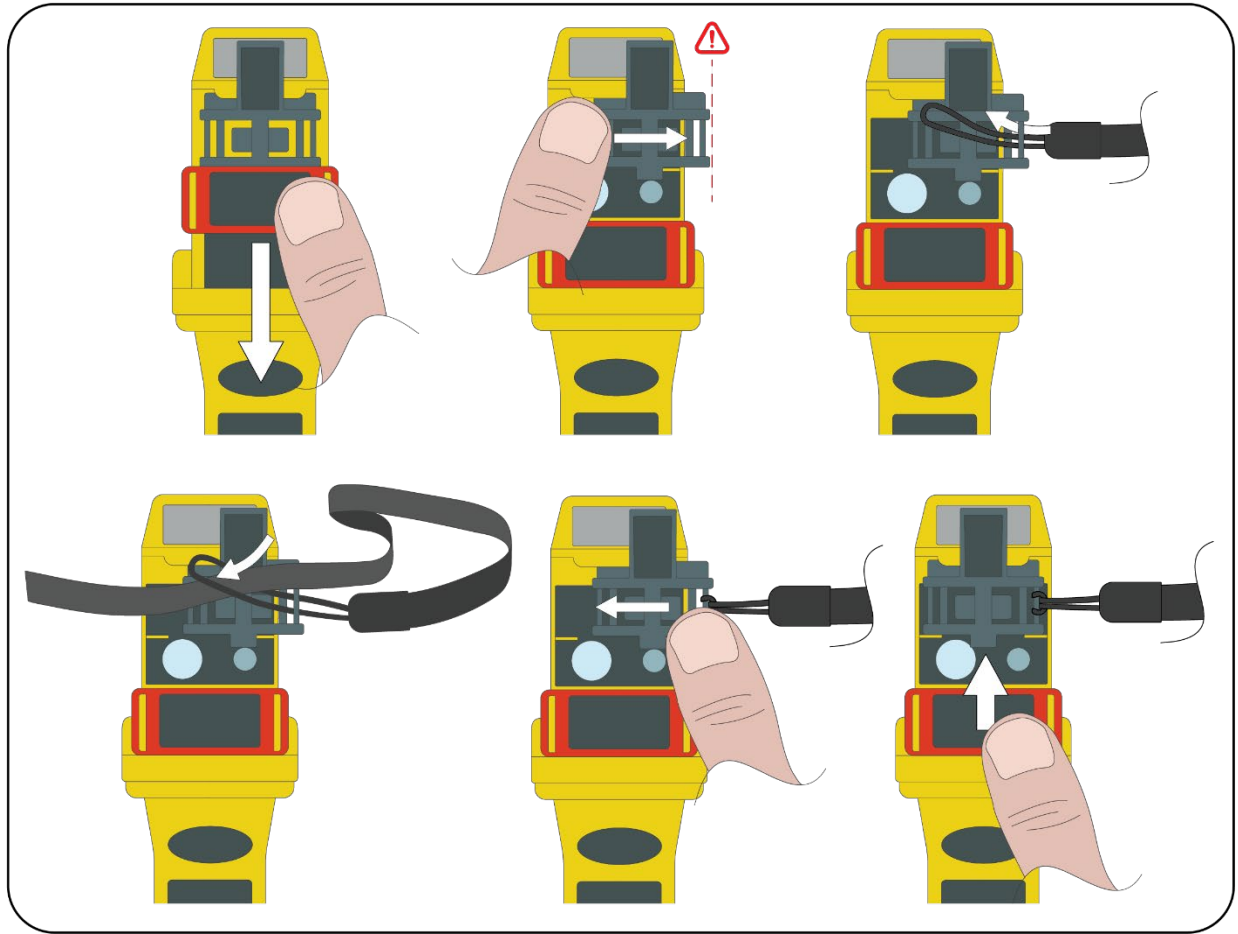

*Fig 3b*

### Step 5: Thread the Activation Cords

Follow the “Life Jacket Installation” instructions in the PLB’s OEM User Manual to correctly thread the activation cords through the device. When sliding the cords over the grey slide, take care not to expose the slot that holds the antenna.

(Fig. 4)

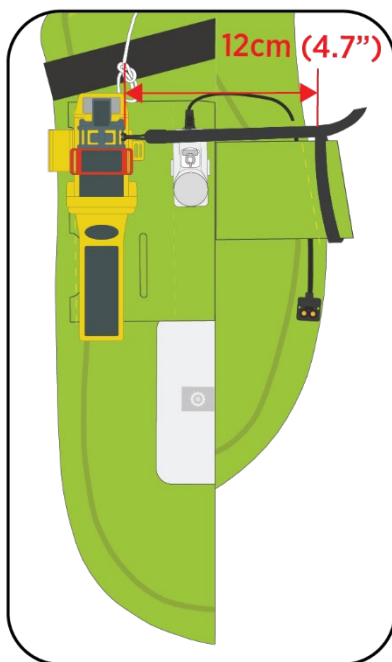

*Fig 4*

### Step 6: Secure the Tape

Thread the loose end of the tape through the far end of the bladder panel and tie a secure knot. Ensure there is exactly 12 cm (4.7") of space between the knot and the clip.

*(Fig. 5)*

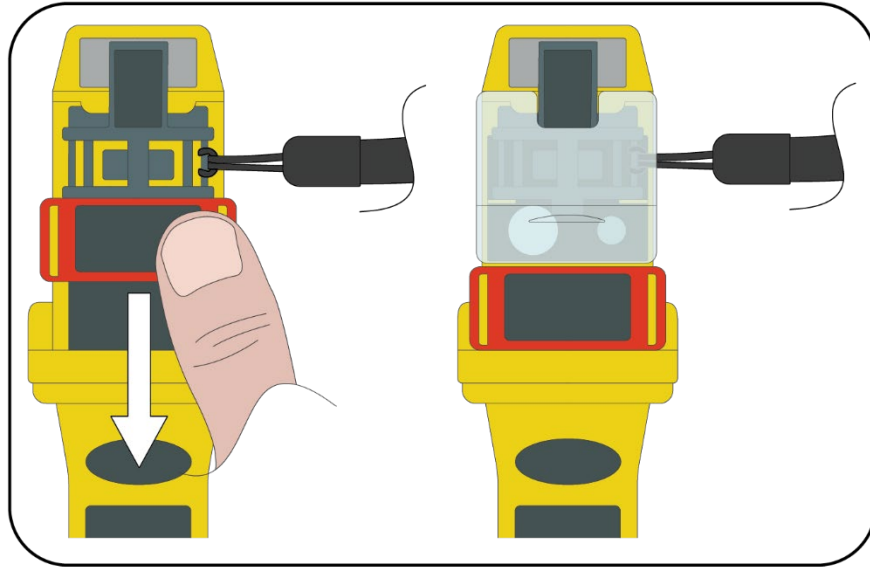

*Fig 5*

### Step 7: Arm the Device

Refer to the “Life Jacket Installation” section in the PLB’s OEM User Manual to correctly arm the device. Ensure the plastic guard is properly secured in place.

*(Fig. 6)*



*Fig 6*

#### Step 8: Repack the Lifejacket

Repack the lifejacket as outlined in the Atlas manual—except make sure the device is folded on top, facing outward, and positioned as the uppermost layer above the bladder.

*(Fig. 7)*



*Fig 7*

### Step 9: Mark the Label

As a final step, locate the label tucked into the centre back panel of the lifejacket and mark it to indicate "PLB fitted." (*Fig 8*)



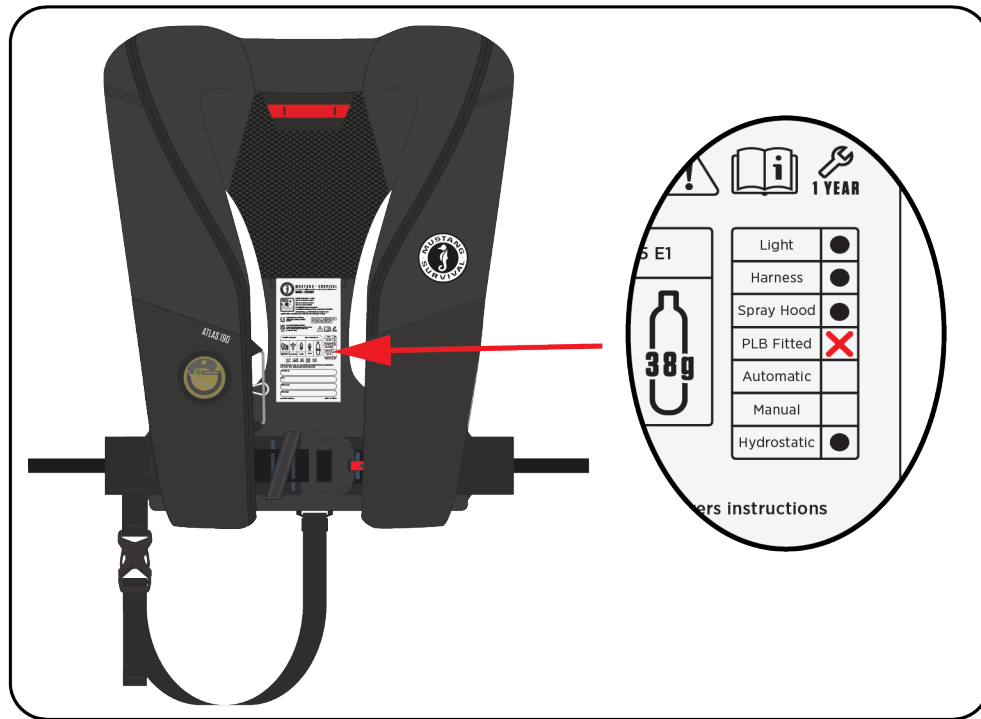

Fig 8