

# FLEXSTEEL®

## W1062-0311

### Rectangular Coffee Table With Casters

#### IMPORTANT NOTES

Carefully remove all the parts from the carton and put them individually on a soft cloth to prevent damage to the parts.

We have taken great care in the design of this product and request that you carefully and accurately follow our assembly instructions to ensure proper set-up. We recommend at least two adults assemble this product.

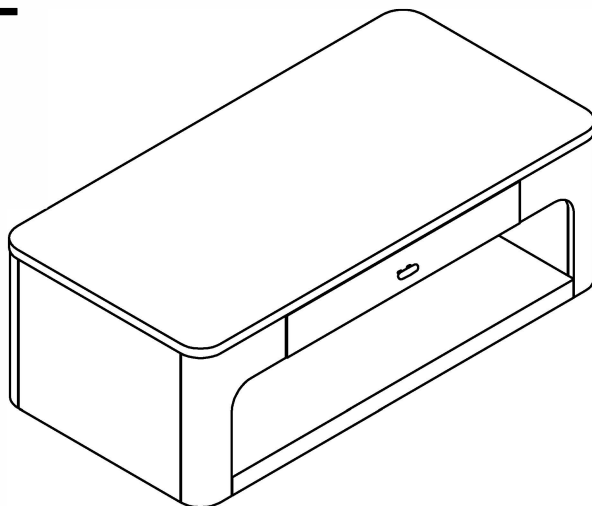

#### Part List

#### Assembly Instruction 1/1



Not included  
Phillips Screwdriver  
PH2 x 100mm

#### IMPORTANT NOTES

- Do not tighten up all the screws until each part is properly assembled.
- Use a soft cloth between these parts and the floor.
- We recommend this product be assembled by at least two adults.

#### STEP 1

Pull out the drawer. Remove the handle pull from the inside of the drawer by removing the screws from the front of the drawer with a Phillips Screwdriver (Not included). Attach the handle pull to the front of the drawer with the screws previously removed. Ensure the handle pull is leveled and tightened. (See Figure 1).

Figure 1

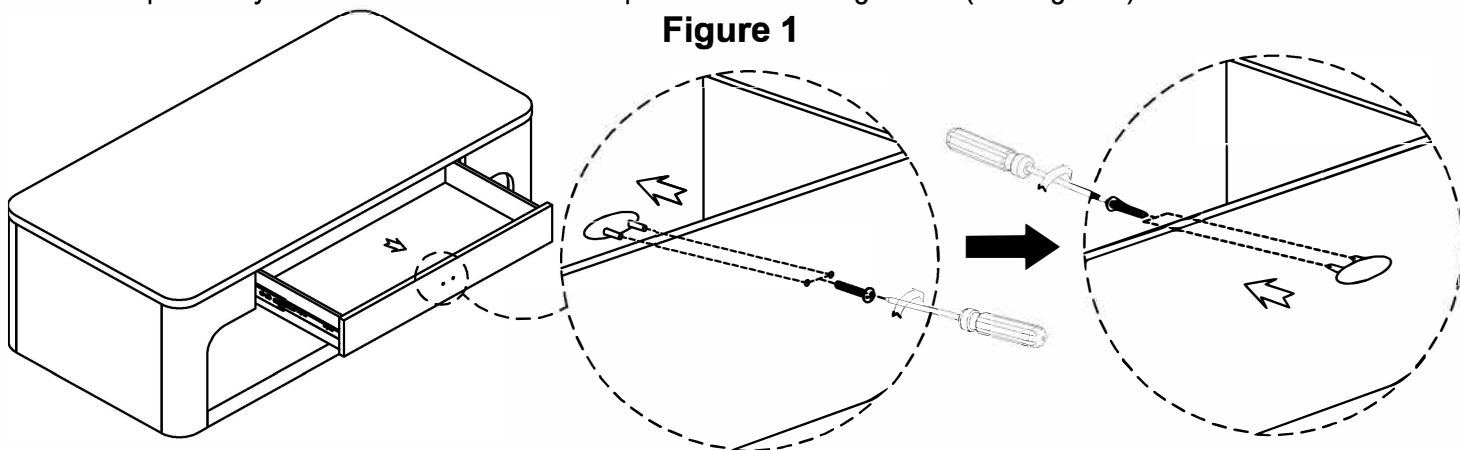

#### CARE INSTRUCTIONS

- To avoid scratches, do not place sharp or jagged objects directly on the top.
- Do not place hot items directly on the top.
- Use placemats or trivets under hot items and coasters under beverages to prevent marks and stains.
- Avoid the use of harsh chemicals or abrasive cleaning materials.
- Wipe the table clean with a soft, dry cloth after each use.
- Wipe up spills quickly with a soft, dry cloth.

Flexsteel Industries, Inc.

For Parts or Customer Service call

toll-free:

1-888-415-3979

Monday-Friday

8:00 a.m. - 5:00 p.m.

(Central Time)

Email:

customersolutions@flexsteel.com

www.flexsteel.com