



MAXI-COSI[®]
We carry the future

Mico Infant Car Seat Base

Fits Mico Nxt, Mico AP,
Mico 30, Mico Max 30
Infant Car Seats

**KEEP INSTRUCTIONS
FOR FUTURE USE.**
Read all instructions
before using
this base.



⚠ WARNINGS: Failure to follow the warnings on the labels and in the instruction manual can result in serious injury or death to your child.

4.11.18

4358-7395



Table of Contents

Getting Started

Rear-Facing Use	1
Parts of the Base	2

General Use

Removing and Installing Child Restraint to Base	3
Adjusting the Base	4

Safety Information

Installation in Vehicle	5
Vehicle Seating Position	5

Vehicle Information

Choosing Lower Anchor Belt or Vehicle Belts	7
Knowing Your Vehicle Belts	9

Rear-Facing Installation

 Lower Anchor Belt Installation	14
 Vehicle Belt Installation	20

General Information

Using a Locking Clip	25
Dorel Juvenile Group Information	28
Registration and Safety Notices	29
Warranty	30
Replacement Parts List	32

Rear-Facing Use

Your child's height, weight, and age determine how your child restraint should be placed in the vehicle.

Children up to 1 year of age must ride rear facing.

The American Academy of Pediatrics recommends that children should remain rear facing until they are at least 2 years old. Please talk to your doctor about the best option for your child.

This base and compatible child restraint must always be used rear facing.

⚠️ WARNING: Verify your child's weight and height (do not guess) before using your child restraint.



You **MUST** follow the weight and height ranges called out in the instruction manual that came with your compatible child restraint.

If your child does not meet the criteria in the child restraint manual, do not use this base.



Base Install



Lower Anchor Belt Install
Page 14



Vehicle Belt Install
Page 20

Parts of the Base

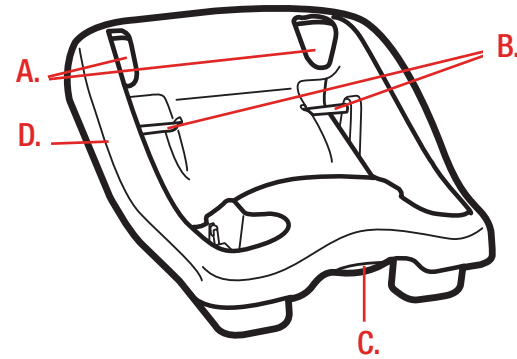

- A. Base Belt Path Openings
- B. Lock Bars
- C. Base Adjustment Handle
- D. Lower Anchor Belt Storage (under edge of base)

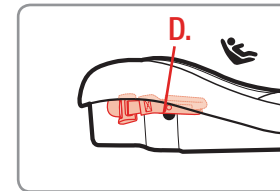

Removing and Installing Child Restraint to Base

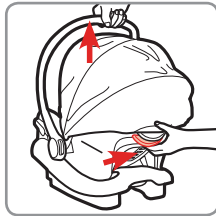

To Remove Child Restraint from Base

From the back of the child restraint, slide the base release handle up and lift the child restraint out of the base.

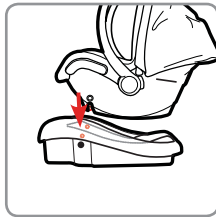

To Attach Child Restraint to Base

Align the slots on the side of child restraint with the lock bars in the base.

Push down firmly on the carry handle and front of the child restraint to lock it to the base. You will hear a “click” when it is locked.

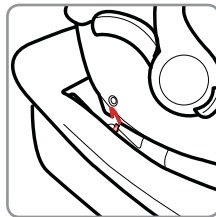

Pull up on front two corners of child restraint by infant's feet to make sure it is locked to the base.

Adjusting the Base

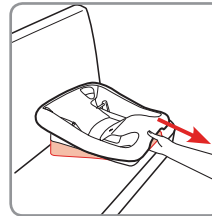

To Adjust the Base

The base has multiple positions.

From the back of the base, pull out on the base recline handle and lift or lower front of base.

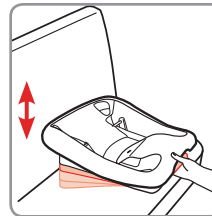

Installation in Vehicle

Check the vehicle belt or lower anchor belt before each use. Use only if the belt is tightened properly and locked securely in place.

This base should be securely belted in the vehicle even when not in use. In a crash or sudden stop, an unsecured base or child restraint could injure occupants.

Do not use a base or child restraint that has been in a crash. You must get a new base or child restraint.

On the top of the base there is a date of manufacture label. Do not use this base more than 8 years after the date of manufacture.

Vehicle Seating Position



Never place a child rear facing in a seating position with an active frontal air bag.

Check the vehicle owner's manual for more information about air bag/child restraint use.



Use the child restraint only on vehicle seats that face forward.

Do not use on seats that face the sides or rear of the vehicle.



For vehicles without a back seat, refer to your vehicle owner's manual. If you are not sure where to place the child

restraint in your vehicle, consult your vehicle owner's manual, contact Dorel Juvenile Group Consumer Care Department, or visit your local Child Passenger Inspection Station. Go to <http://www.safercar.gov/cpsApp/cps/index.htm> to find your closest station.

Children are safer when properly restrained in rear seating positions than in the front seating positions.



According to National Highway Traffic Safety

Administration information, children in rear seating positions are statistically safer, whether you have air bags, advanced air bags, or no air bags at all.

To avoid your child being seriously burned, take the following precautions:

1. Park in the shade or where sun does not directly hit the child restraint.
2. Cover the child restraint with a sheet or blanket when not in use.
3. Check for hot seat and buckles before placing child in child restraint.

To help protect your vehicle seat's upholstery from damage, use a single layer towel underneath and behind the base.

Choosing Lower Anchor Belt or Vehicle Belts

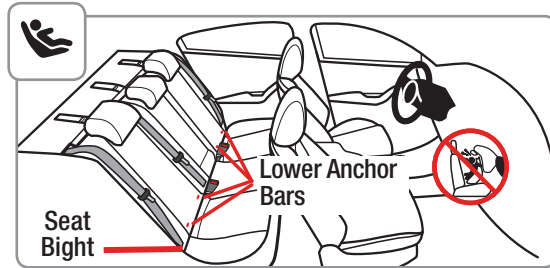

The LATCH System

The lower anchors of LATCH (Lower Anchors and Tethers for Children) is a universal system for installing child restraints without using vehicle seat belts.

The lower anchor system can ONLY be used in vehicles that have the lower anchor bars installed in designated LATCH seating positions. Most vehicles manufactured after September 2002 are equipped with lower anchor bars. Check your vehicle owner's manual to see which seating positions may be equipped with the LATCH system.

When installing with vehicle belts, the lower anchor belt MUST be properly stored. Storing Lower Anchor Belt: Attach connectors to attachments on base as shown. Gently pull free end of belt to remove slack.

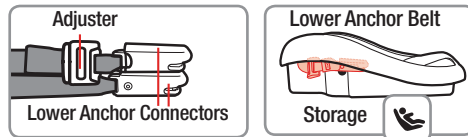

7

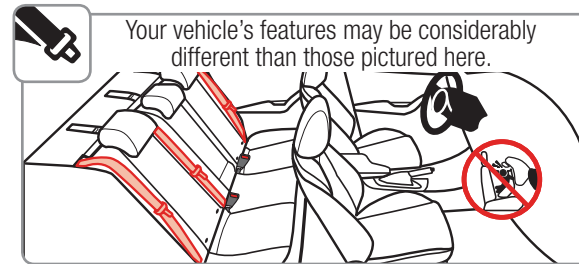

Vehicle Belts

If lower anchors are not an option, you must use the vehicle seat belt system to install the child restraint.

There are some vehicle belts that will not work with a child restraint or will require special attention. Check your vehicle owner's manual for specific instructions.

⚠ WARNINGS: When used correctly the lower anchor belt or vehicle belts are equally safe.

Do not use both the lower anchor belt and vehicle belt at the same time.

8

Knowing Your Vehicle Belts

Not all vehicle belts and seating positions will work with child restraints or bases. Please follow the following steps to understand how to lock a child restraint and base with a vehicle belt.

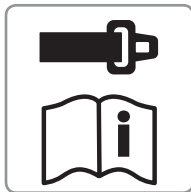

1. You MUST Review Your Vehicle Owner's Manual

Your vehicle owner's manual will let you know what vehicle belts and seating positions child restraints can be installed in.



2. Determine How the Base Will Be Locked Into Place

The vehicle belt **MUST NOT** loosen after tightening.

This means there needs to be a way to lock the vehicle belt.

The ways this can be done are:

- By using the seat belt's retractor; or
- By using the seat belt's latch plate.

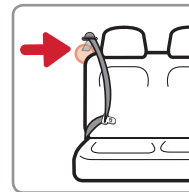

3. Check the Retractor

Retractors pull seat belts into stored positions and lock the belt to hold passengers in place.

A retractor is most likely how you will be locking a child restraint or base into place.

See below and the next page for some common types of vehicle belt retractors that will work with this base.

Types of Retractors

Switchable Retractor
(most vehicles have this type)



This retractor can be switched to a locking mode.

You **MUST** have the retractor in the locking mode to use the seat belt with this base.

Switching to locking mode: Slowly pull the shoulder belt all the way out, then let it go back in an inch or two. As it goes back in, you will most likely hear a ratcheting sound.

Gently pull the belt to see if it has locked. You will not be able to pull any more belt out if the lock has engaged.

Automatic Locking Retractor



This retractor always locks.

It will automatically lock after slowly pulling the seat belt out at least halfway and letting the belt go back into the retractor an inch or two.

Emergency Locking Retractor

See Step 4, "Check the Latch Plates".

If the retractor does not lock, it is most likely an Emergency Locking Retractor. These retractors only lock during a sudden stop or collision.

You will need to determine if your seat belt's latch plate can lock the belt. See Step 4, "Check the Latch Plates," below and on the next page.



4. Check the Latch Plates

Latch plates are the part of the seat belt that goes into the buckle.

Grasp the tongue of the latch plate (the part that goes inside the buckle) and pull straight out, in line with the lap belt.

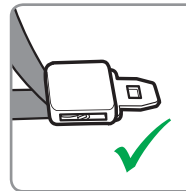

Locking Latch Plate

If the latch plate does not slide up and down the vehicle belt, it is a **locking latch plate**.

If the latch plate slides up and down the vehicle belt, it is a **sliding latch plate**.

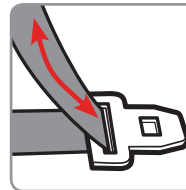

Emergency Locking Retractor with a Sliding Latch Plate

Sliding latch plates easily slip between the lap and shoulder portions of the belt.

If you have an Emergency Locking Retractor with a Sliding Latch Plate, you **MUST** use a locking clip to install the base. See pages 25-27.

Never Use With This Base

Emergency Locking Retractor Lap Only Belt	✗
Inflatable Seat Belts	✗

Rear-Facing Installation



Lower Anchor Belt



Lap Belt



Lap/Shoulder Belt



Depending on your Mico car seat model, the level-to-ground line can be in one of two places.

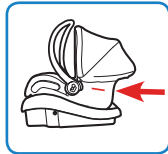

Level-to-Ground Line Location 1

OR



Level-to-Ground Line Location 2



⚠ WARNINGS: Never place a child rear facing in a seating position with an active frontal airbag. This can result in serious injury or death.

This child restraint **MUST** always face the rear of the vehicle.

Lower Anchor Belt Installation

⚠ WARNINGS: Do not use the lower anchor belt along with the vehicle lap or lap/shoulder belt.

Check the lower anchor belt before each use. Use only if the belt can be tightened properly and securely.

Do not fasten multiple lower anchor connectors on the same lower anchor bar in the vehicle.

Failure to follow these warnings can result in serious injury or death.

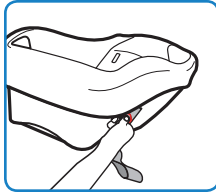

1. Remove Lower Anchor Belt from Storage Location

Unhook lower anchor connectors from base by pressing the red release button on each connector.

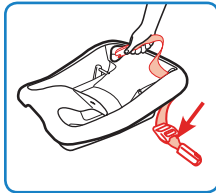

2. Route Lower Anchor Belt Through Base Belt Path

Adjuster **MUST** be on the right side of the base as shown.

Do not twist belt.

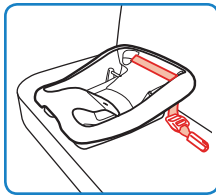

3. Place Base in Vehicle Rear Facing

Center the base between the vehicle anchors in the chosen seating position.

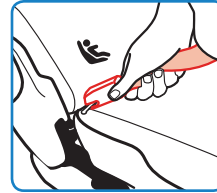

4. Attach Lower Anchor Connector to Vehicle's Lower Anchor

Review your vehicle owner's manual for lower anchor locations and lower anchor belt use.

Make sure arrows on connectors are facing up.

Fasten one lower anchor belt connector to the anchor located in the vehicle seat bight. Repeat for other side of base.

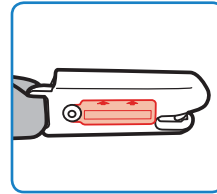

5. Tighten Belt

Firmly push down and towards the vehicle seat back while pulling free end of belt to tighten.

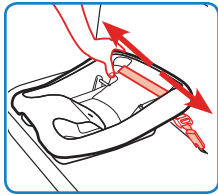

6. Check Belt Tightness

Hold the base at the belt path with your weakest hand.

Push and pull from side to side. It should not move more than 1 in. (2.5 cm).

If it moves more than 1 in. (2.5 cm), you can try:

- A. Pulling the belt tighter.
- B. Reinstalling the base.
- C. Changing to a different seating location.
- D. Switching to vehicle belt installation.

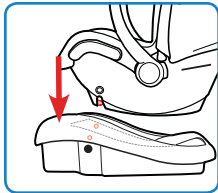

7. With Child Secured in Child Restraint, Attach Child Restraint to Base

Pull up on front two corners of child restraint by child's feet to make sure it is locked to the base.

⚠ WARNING: Failure to securely attach child restraint to base can result in serious injury or death.

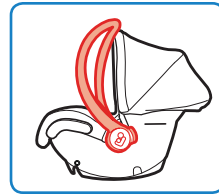

Carry handle **MUST** be upright AND locked when carrying and when installed in the vehicle.



OR

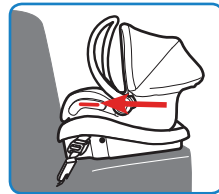

8. Check Level Line

Depending on your Mico car seat model, the level-to-ground line can be in one of two places.

Repeat steps 3-8 if level line is not parallel with the ground.

Adjust the base if needed. **See page 4 on how to use the base adjustment.**

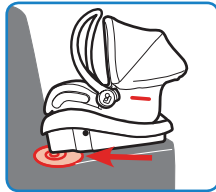

You may need to place a large rolled towel(s) or foam pool noodle(s) under front of child restraint to help make level line parallel with the ground.

Check often to be sure padding is still in place and the belt is tight.

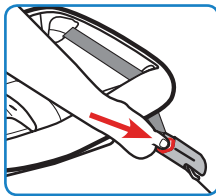

To Release Lower Anchor Belt

Remove lower anchor belt from vehicle anchors by pressing the red release button on each connector. Then pull it out of the vehicle seat.

Store lower anchor belt when not in use.

See page 7.

Vehicle Belt Installation

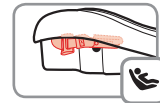

⚠ WARNINGS: Do not use the lower anchor belt along with the vehicle lap or lap/shoulder belt.

Secure the lower anchor connectors to storage attachments as shown when installing with vehicle belts.

Check the vehicle belt before each use. Use only if the belt can be tightened properly and locked securely in place.

Failure to follow these warnings can result in serious injury or death.

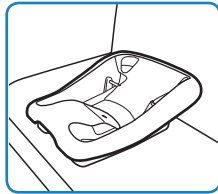

1. Place Base in Vehicle Rear Facing

Center the base in the chosen seating position.

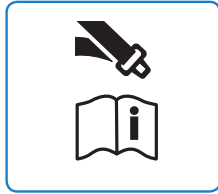

2. Check if Your Vehicle Belts Will Work With This Base

This is very important because **not all vehicle belts will work with child restraints or bases.**

Review pages 9-12 and your vehicle owner's manual to determine what kind of vehicle belt you have and how to lock a child restraint/base in place.

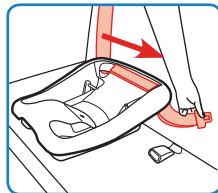

3. Route Vehicle Lap or Lap/Shoulder Belt Through Base Belt Path

Buckle vehicle belt.



4. Tighten Belt

Firmly push down and towards the vehicle seat back while pulling shoulder belt or free end of lap belt to tighten.

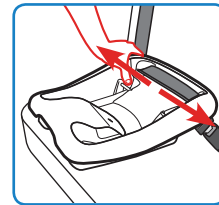

5. Check Belt Tightness

Hold the base at the belt path with your weakest hand.

Push and pull from side to side. It should not move more than 1 in. (2.5 cm).

If it moves more than 1 in. (2.5 cm), you can try:

- A. Pulling the belt tighter.
- B. Reinstalling the base.
- C. Changing to a different seating location.
- D. Switching to the lower anchor belt installation if lower anchors are available in your vehicle.

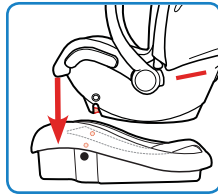

6. With Child Secured in Child Restraint, Attach Child Restraint to Base

Pull up on front two corners of child restraint by child's feet to make sure it is locked to the base.

⚠ WARNING: Failure to securely attach child restraint to base can result in serious injury or death.

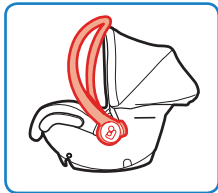

Carry handle **MUST** be upright **AND** locked when carrying and when installed in the vehicle.

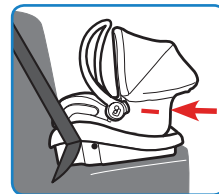

OR

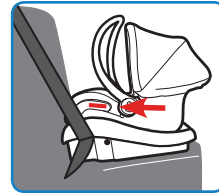

7. Check Level Line

Depending on your Mico car seat model, the level-to-ground line can be in one of two places.

Repeat steps 1-7 if level line is not parallel with the ground.

Adjust the base if needed. **See page 4 on how to use the base adjustment.**

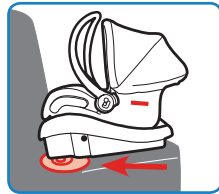

You may need to place a large rolled towel(s) or foam pool noodle(s) under front of child restraint to help make level line parallel with the ground.

Check often to be sure padding is still in place and the belt is tight.

Using a Locking Clip

You will rarely need to use a locking clip except in some older vehicles. Built in child restraint locking systems have been required in vehicles since 1996, and many vehicles had these features even earlier.

Review pages 9-12 and your vehicle owner's manual to determine if your vehicle belts require a locking clip. If you need a locking clip immediately, they are likely available at an auto dealership, an auto store, or where you purchased this base.

You can call us at 1-800-951-4113 or text us at 1-812-652-2525 for one.

A locking clip will not fix all types of seat belt problems. You **MUST** have a lap **and** shoulder belt to use a locking clip.

Follow pages 20-22 Warnings and Steps 1-4 before starting locking clip installation.

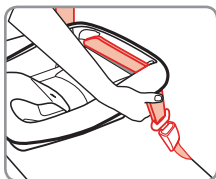

1. Determine Locking Clip Location

Grasp both vehicle belts together just behind the latch plate to mark the position for locking clip.

Unbuckle the belt.

NOTE: If the latch plate ends up just at the belt path opening so you cannot grasp the vehicle belt at the latch plate, grasp the vehicle belts on the opposite side of the base, as close to the latch plate as possible.

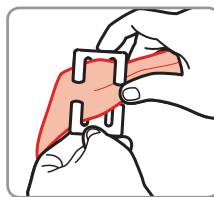

2. Attach Locking Clip

Thread both portions of the vehicle belt onto the locking clip, as close to the latch plate as possible.

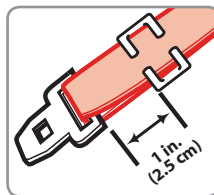

3. Position Locking Clip

Position locking clip about 1 in. (2.5 cm) from vehicle belt's latch plate.

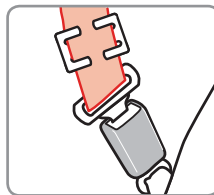

4. Rebuckle Vehicle Belt

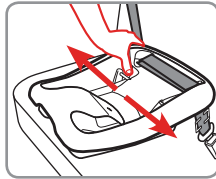

5. Check Belt Tightness

Hold base at the belt path with your weakest hand.

Push and pull from side to side. It should not move more than 1 in. (2.5 cm).

If it moves more than 1 in. (2.5 cm), you can try: A. Reinstalling the base. **B.** Changing to a different seating location.

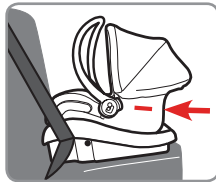

OR

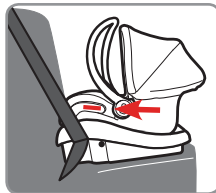

6. Recheck Level Line

Depending on your Mico car seat model, the level-to-ground line can be in one of two places.

The level line on shell **MUST** be parallel with the ground.

Remove the locking clip when the vehicle seat belt is not being used with a base or child restraint.

Dorel Juvenile Group Information

Thank you for choosing this base. The DJG family is committed to creating child restraints with the most comfort and convenience available today.

Remember, parents are a child's first teachers and examples. If you always buckle your seat belt, your child will think it is the natural thing to do. Make it a firm rule that the vehicle does not go until everyone is buckled up. Make no exceptions.

No one can predict if use of a child restraint will prevent injury or death in a particular crash. However, when combined with careful driving, proper use of a child restraint can lower a child's risk of injury or death in most crashes. Your child's safety is worth the time it will take to read and follow these instructions. If you still have questions or have any concerns with this base please contact our Consumer Care Department:

Call: 1-800-951-4113

Text: 1-812-652-2525

Website: www.maxi-cosi.com

Hours of Operation:

M-TH from 8:00 AM to 6:00 PM EST

FRI from 8:00 AM to 4:30 PM EST

Registration and Safety Notices

Please complete the postage-paid registration card that came with your child restraint, and send it to us. Child restraints could be recalled for safety reasons. You must register this restraint to be reached in a recall. Send your name, address, e-mail address if available, the restraint's model number and manufacturing date to:

Dorel Juvenile Group, Inc.
Consumer Care Department
PO Box 2609
Columbus, IN 47202-2609

or call 1-800-951-4113 or register online at
www.djgusa.com/registration/carseat/us.

For recall information, call the U.S. Government's Vehicle Safety Hotline at 1-888-327-4236 (TTY: 1-800-424-9153), or go to <http://www.NHTSA.gov>.

Consumer: Just fill in your name, address and email. Please print (use dark ink).
Your Name _____
_____ (initial)
Model Number **Line Code** **Manufacture Date**
Model Number Model Name Manufacture Date
AB123CDE MAXI-DR CAR SEAT 01/22/2015
L#11 B265035

Example of model number, manufacture date, and line code.

If you don't have the card or if your address changes, you will find the model number, manufacture date, and line code on the label located on top of base.

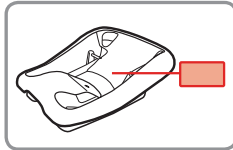

Warranty

Dorel Juvenile Group, Inc. (DJG) warrants this product to the original retail purchaser as follows: This product is warranted against defective materials or workmanship for one year from the date of original purchase. **An original receipt is required to validate your warranty.** DJG will, at its option, provide replacement parts or replace this product. DJG reserves the right to substitute if the part or model has been discontinued.

To make a claim under this warranty contact our Consumer Care Department by phone at 1-800-951-4113; or text us at 1-812-652-2525. Our hours of operation are from 8:00 a.m. to 6:00 p.m. EST Monday through Thursday and from 8:00 a.m. to 4:30 p.m. on Friday.

Proof of purchase is required and shipping charges are the responsibility of the consumer. Warranty Limitations: This warranty does not include damages which arise from misuse or abuse of this product.

Limitation of Damages: The warranty and remedies as set forth are exclusive and in lieu of all others, oral or written, expressed or implied. In no event will DJG or the dealer selling this product be liable to you for any damages, including incidental or consequential damages, arising out of the use or inability to use this product. **Limitation of warranties and other warranty terms and state law rights:** Any implied warranties, including implied warranties of the merchantability and fitness for a particular purpose, shall be limited to the duration and terms of the express written warranty. Some states do not allow limitations as to how long

an implied warranty lasts or the exclusion or limitation of incidental or consequential damages, so the above limitations may not apply to you.

This warranty gives you specific legal rights, and you may have other rights, which vary from state to state. Neither DJG nor the dealer selling this product authorized any person to create for it any other warranty, obligation, or liability in connection with this product.

Please note: Our product warranty only applies when purchased from an authorized Maxi-Cosi retailer. The origin of products not purchased through these authorized retailers is unknown and could be counterfeit.

We cannot support products from an unknown origin as we cannot verify the handling or condition of such merchandise. We maintain a strong network of authorized retailers to ensure you are purchasing safe and complete products.

Fulfillment by a third party does not guarantee you are purchasing from one of these authorized retailers. Pricing which is inconsistent with the majority of retailers is a strong indication that the retailer is not authorized, as we have a consistent price offering across all authorized retailers.

If you are unsure of the authorization status of a retailer you are considering purchasing from, or have purchased from, you can check www.maxi-cosi.com/us-en/shops.aspx; or call our Consumer Care Department at 1-800-951-4113; or text us at 1-812-652-2525.

Replacement Parts List

Prices are subject to change. Applicable tax and shipping & handling will also be added.

<u>Part</u>	<u>Cost</u>
Lower Anchor Belt.....	\$24.99
Instructions.....	\$0.00

**For availability and questions,
please call us at: 1-800-951-4113
or text us at: 1-812-652-2525.**

Hours of Operation:

M-TH from 8:00 AM to 6:00 PM EST
FRI from 8:00 AM to 4:30 PM EST

If you already know which parts you need,
you may complete your order with a credit card by
calling us at 1-800-951-4113.

**See list above for available parts. We accept
Visa or MasterCard.**