WASH & CARE INSTRUCTIONS:

To clean: Surface wipe only; air dry.

SwaddleMe®

Please read the following instructions and warnings carefully.
IMPORTANT! KEEP FOR FUTURE REFERENCE
Tools required: Phillips head screwdriver (not included).
Requires 3 "AA" batteries (included).

Adult assembly required.

For technical support, call **1-401-671-6551** in the U.S.A or **1-905-456-8484** in Canada, or e-mail at customerservice@summerinfant.com

For use with children from birth and up.
Keep small parts away from children.

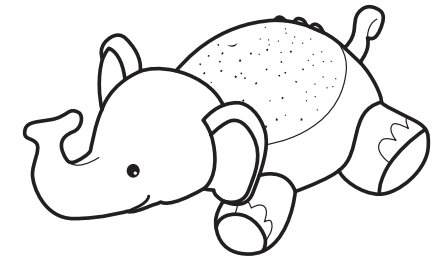
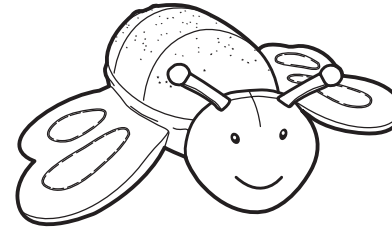

INSTRUCTION MANUAL

Slumber Buddies™

Thank you for purchasing Slumber Buddies™ from Summer Infant. The buddy system was designed to help create a tranquil and calming environment for your little one at night. Using a comforting combination of three colors and your choice of five lullabies/nature sounds, Slumber Buddies™ easily soothes your child to sleep. This cute little character will quickly become your child's best friend!

▲ WARNING

- NEVER place product in crib.
- Do not leave infant unattended with product.
- Complies with all applicable US government safety regulations and the safety requirements of ASTM F963.
- Exercise care when unpacking and assembling product.

▲ BATTERY WARNING

- Do not mix old and new batteries.
- Do not mix alkaline, standard, or rechargeable batteries.
- Remove batteries when product is stored for long periods of time or when batteries are exhausted.
- Dispose of exhausted batteries properly.
- Non-rechargeable batteries are not to be recharged.
- Rechargeable batteries are to be removed from the toy before being charged.
- Rechargeable batteries are only to be charged under adult supervision.
- Batteries are to be inserted with the correct polarity.
- The supply terminals are not to be short-circuited.

Summer Infant stands behind all of its products. If you are not completely satisfied or have any questions, please contact our Consumer Relations Team at **1-401-671-6551** in the U.S.A or **1-905-456-8484** in Canada or www.summerinfant.com/contact

Summer Infant, Inc.
1275 Park East Drive
Woonsocket, RI 02895 USA
1-401-671-6551
©2021 Summer Infant, Inc.

Summer Infant Canada
200 First Gulf Blvd., Unit C
Focus 31, Cleveland Road
Brampton, Ontario, Canada, L6W 4T5
1-905-456-8484

MADE IN CHINA.
Colors and styles may vary.
Please retain information for
future reference.
D0000000905_8.21

TO USE:

NOTE: Batteries are included for the “Try Me” mode. To activate the normal play mode, move switch to any of the three timer positions. When in “Try Me” mode, each function will automatically shut off after 10 seconds.

Power/Timer Control:

The main on/off/timer switch can be found next to the battery door on the bottom of the unit.

Open the pocket to locate the switch.

Turn switch to the “Off” position during long periods of inactivity.

ON/OFF/TIMER CONTROL:

1st position: “Try Me” mode

2nd position: Off

3rd position: On/15 min auto shut-off

4th position: On/30 min auto shut-off

5th position: On/45 min auto shut-off

☆ Nightlight/Selecting Display Color:

To choose a color for the nightlight star display, press the corresponding button to cycle through each of the four options – red, green, blue and light show (all colors). The display will automatically shut off after the set time has completed. Also, after cycling through each of the colors, press the button once more to turn the display off. The main on/off/timer switch can be found next to the battery door on the bottom of the unit. Open the pocket to locate the switch. Turn switch to the “Off” position during long periods of inactivity.

🎵 Lullabies/Nature Sounds:

To choose one of the three Lullabies or two Nature Sounds, press the corresponding button to begin cycling through the options. Once you make a decision, the sound will play the selected amount of time for before shutting off automatically. You can turn off the Lullabies/Nature Sounds feature manually by cycling through all five options and then pressing the button once more.

🔊 Volume:

Adjust the sound level with the volume button (Low / Medium / High) on each unit.

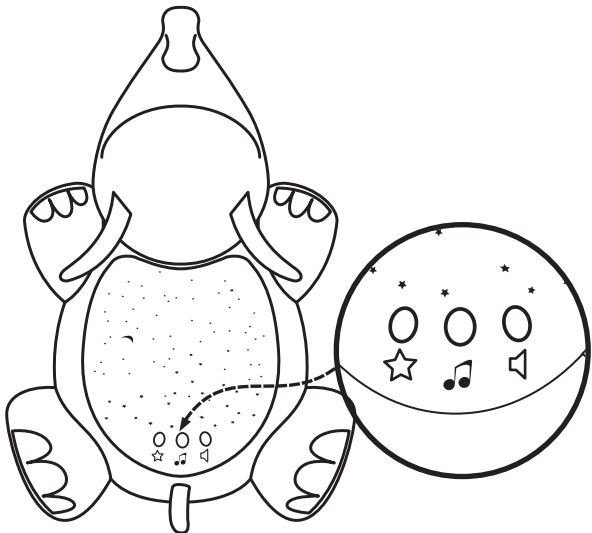

☆ **Nightlight Display**
(Red/ Green / Blue/ Light Show/ Off)

🎵 **Lullabies/Nature**
3 Lullabies/ 2 Nature Sounds/ Off

🔊 **Volume**
Low/ Medium/ High

TO CHANGE BATTERIES:

Step 1:

Open pocket on bottom of unit.

Step 2:

Use a Phillips head screwdriver to loosen battery door screw. Open battery door. Remove old batteries and dispose of them safely.

Step 3:

Insert 3 new “AA” batteries, making sure that the “+” and “-” are facing the correct way.

The battery compartment is marked for clarity.

Step 4:

Screw battery door back onto unit. Make sure the On/Off Switch is in one of the three “On/Timer” positions and secure pocket.

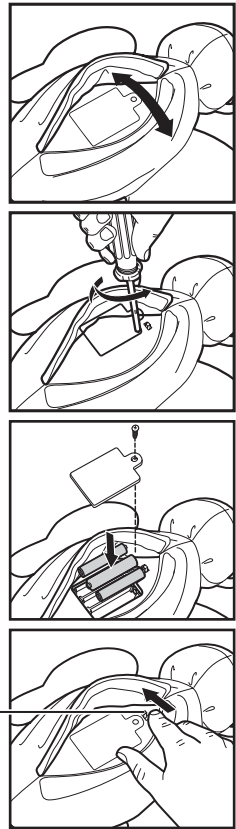

On/Off/Timer Switch

RADIO AND TELEVISION INTERFERENCE:

Changes and Modifications not expressly approved by Summer Infant (USA), Inc. can void your authority to operate this equipment under Federal Communications Commissions rules.

This device complies with part 15 of the FCC Rules.

Operation is subject to the following two conditions:

(1) This device may not cause harmful interference, and

(2) this device must accept any interference received, including interference that may cause undesired operation.

NOTE: This equipment has been tested and found to comply with the limits for a Class B digital device, pursuant to Part 15 of the FCC Rules. These limits are designed to provide reasonable protection against harmful interference in a residential installation.

This equipment generates, uses and can radiate radio frequency energy and, if not installed and used in accordance with the instructions, may cause harmful interference to radio communications.

However, there is no guarantee that interference will not occur in a particular installation. If this equipment does cause harmful interference to radio or television reception, which can be determined by turning the equipment off and on, the user is encouraged to try to correct the interference by one or more of the following measures:

- Reorient or relocate the receiving antenna.
- Increase the separation between the equipment and receiver.
- Connect the equipment into an outlet on a circuit different from that to which the receiver is needed.
- Consult the dealer or an experienced radio/TV technician for help.

This Class B digital apparatus meets all requirements of the Canadian Interference-Causing Equipment Regulations. CAN ICES3 (B) /NMB-3 (B).