

USER'S MANUAL

BV7949B

BLUETOOTH®-ENABLED

DVD/MP3/CD AM/FM RECEIVER

FEATURING 3.6" (91mm) WIDESCREEN TOUCHSCREEN DIGITAL TFT MONITOR



BOSS[®]
AUDIO SYSTEMS

Thank you for choosing Boss Audio Systems! This unit will bring you years of enjoyment.

CONTENTS

Safety Precautions.....	2-3
Installation.....	4-6
Wiring Connections.....	7
Controls Of The Unit.....	8
Basic Operation.....	9-10
Radio Operation.....	11-12
DVD/VCD/CD/MP3/WMA Operation.....	13-17
Bluetooth Operation.....	18-19
Setings & Sound.....	20
Other Operation.....	21
Maintenance.....	22
IR Remote Control.....	23
Troubleshooting Guide.....	24
Specifications.....	24

SAFETY PRECAUTIONS

- ⚠ **Important Warnings to Take Note of BEFORE Starting the Installation**
- ⚠ **Damage Caused By Incorrect Installation or Usage is NOT Covered By Warranty.**
PLEASE Take the Time to Read the Installation Notes Carefully.
- ⚠ **Please make all necessary connections and terminate any unused wires so they do not short. If you feel uncomfortable performing the install consult a professional installer.**

- **To avoid any possible damage to your vehicles electrical system, be sure to disconnect the battery cable before beginning installation.**
- The unit is intended for vehicles with a 12-volt battery and negative grounding.
- Before installing the unit in a recreational vehicle, truck, or bus, check that the battery voltage is 12 volts.
- **Remove the two transport screws from the top of the unit before installation.**
- Be sure to connect the negative (-) speaker leads to the negative (-) speaker terminal. Never connect the negative (-) speaker leads to chassis ground.
- This unit is only designed for use with 4 speakers. Do not combine outputs for use with 2 speakers. Do not ground negative speaker leads to the chassis ground.
- Speakers connected to this unit must be 4 to 8 ohms. Connecting speakers with output and/or impedance values other than those noted there will result in damage to the head unit and the speakers.
- **Check the condition of your speakers carefully - connecting the unit to old or degraded speakers may result in a fault which will damage the audio IC and invalidate the warranty.**

If this unit is installed in a vehicle that does not have an ACC (accessory) position on the ignition switch, the red lead of the unit should be connected to a terminal coupled with ignition switch ON/OFF operations. If this is not done, the vehicle battery may be drained when you are away from the vehicle for several hours.

SAFETY PRECAUTIONS

- Secure the wiring with zip ties or electrical tape. . To protect the wiring, wrap adhesive tape around them where they lie against metal parts. To avoid short-circuiting, cover all disconnected lead with insulating tape. There is a possibility of short-circuiting if the leads are not insulated.
 - Route and secure all wiring so it cannot touch any moving parts, such as the gear lever and handbrake. Do not route wiring in places that get hot, such as near the heater outlet. If the insulation of the wiring melts or gets torn, there is a danger of the wiring short circuiting to the vehicle's body.
 - Don't pass the yellow lead through a hole into the engine compartment to connect to the battery. This will damage the lead's insulation and cause a very dangerous short.
 - Do not shorten any leads, if you do, the protection circuit may fail to work when it should.
 - Never feed power to other equipment by cutting the insulation of the power supply lead of the unit and tapping into the lead. The current capacity of the lead will be exceeded, causing overheating.
 - Since a unique audio I/C circuit is employed, never wire so the speaker leads are directly grounded or the left and right - speaker leads are common.
 - When this product's source is switched ON, a control signal is turned on through the Blue/White lead. Connect to an external power amp's system remote control or the car's Auto-antenna relay control terminal (max. 500mA 12V DC).
 - Do not block any vents or heater panels, Blocking them will cause heat to build up and may result in fire.
 - When replacing the fuse(s) the replacement must be of the same amperage as shown on the fuse holder. Never replace a fuse with another of a different value. If the fuse blows again please contact your installation company.
 - Double check that all wiring and connections are correct before re-connecting the battery and turning on the unit.
- After completing the installation and before operating the unit, reconnect the battery, then press the (RES) button with a pointed object, such as a ball-point pen to set to unit to it's initial status. After pushing the button, wait a few seconds for the red light to flash.

INSTALLATION

Tools for Installation

2 removal wrenches are supplied for taking out the old unit and place with this brand name car radio. The following tools and supplies may also be needed for the installation:

Tools for Installation: Philips Screw-drivers /Machine Screws /Wire Stripper /Wire Cutter /Hammer /Pencil /Electrical Tape /Electric Drill

Supplies for Installation: Machine Screws /Crimp Connectors /14 Gauge Wire for Power Connections /14-16 Gauge Speaker Wires

The above are not supplied.

Before you install

We strongly recommend that this unit should be professionally installed by a VAT registered installer (this is a requirement to validate the warranty).

IMPORTANT: Remove the two transport screws from the top fo the unit before installing.

Remove the Old Unit from the Dashboard

1. Remove the outer trim frame.

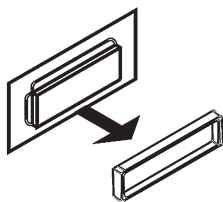

DIN Front Mount

2. Insert the keys supplied with the old unit into both sides of the unit as shown in figure below until they click. Pull to remove the old unit from the dashboard.

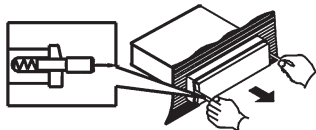

**DO NOT DISCONNECT WIRES
AT THIS TIME!**

Mark Polarity of the Speaker Wires

Marking the polarity of the speaker wirers will make it easier to connect the existing speakers to your car radio. Consult wiring diagram of existing head unit before disconnecting any wires. If you are not positive of the polarity of the existing wires from the speakers to the head unit, install new wires.

1. While the old unit is playing, disconnect the wires from one speaker.
2. Take a length of masking tape and fold it around the wire so it forms a flag.
3. On the masking tape mark the polarity of the speaker wires (+&-), as well as left or right, and front or rear.
4. Double check that you marked the first speaker correctly by checking that the speaker wires are the same at the head unit.
5. Repeat this procedure for all of the speakers.
6. Mark the power, ground, and any other wires also.

INSTALLATION

WARNING!

Disconnect negative battery terminal from battery before starting installation.

NOTE: Mark the polarity of the existing speaker wires before disconnecting battery.

NOTE: Remove the two transport screws from the top of the unit before installing.

DIN Front Mount

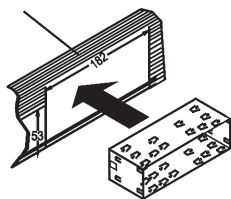

1. After removing the old radio and mounting sleeve, insert supplied mounting sleeve into opening.

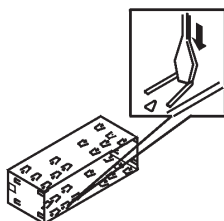

2. Bend the tabs on the mounting sleeve to keep the mounting sleeve firmly in place.

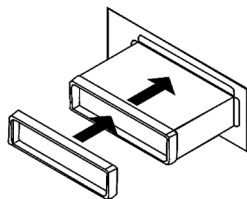

3. Attach wires from the unit to existing wires. See wiring connections diagram. Insert radio into dashboard. Then apply the trim frame to outside of radio.

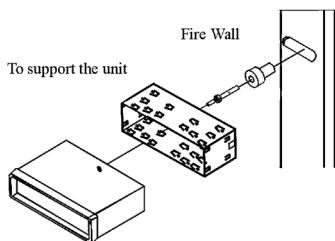

4. Support radio using rear mounting bolt and steel bar. (not included)

INSTALLATION

DIN Rear Mount

NOTE: Outer trim frame, hook, and mounting sleeve are not used for this installation

This is only intended as a general guide; contact the vehicle's manufacturer for specific instructions.

This method of installation uses the screw holes at the sides of the unit and the holes of the existing vehicle mounting bracket.

1. Remove the hooks on both sides.
2. Align the screw holes of the mounting bracket supplied with the car and the screw holes of the main unit. Tighten the 2 screws on each side of the unit. Then fasten the brackets to the car.
3. Attach wires of the unit to existing speaker wires. See wiring diagram.

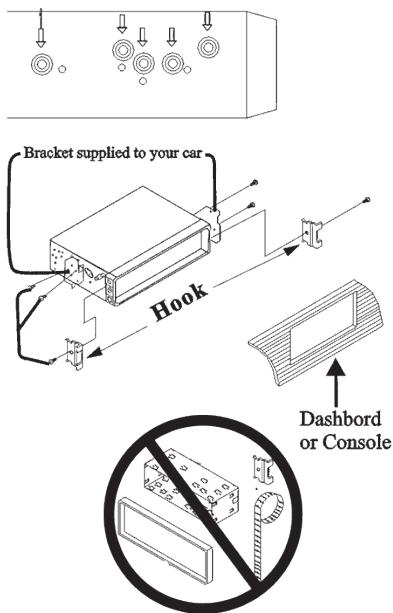

WIRING CONNECTIONS

General Wiring Notes:

Black Ground

Connect to vehicle body/chassis. Make sure you have a good chassis ground. This will eliminate most electrical noise from the motor and alternator. A good chassis ground requires a tight connection to ground. The area should be free from rust, paint or any form of dirt.

Light Green (Hand Brake - Ground)

Connect this wire to the hand brake wire of your car so that the display will be on only when the car is fully stopped.

Purple-White (Rear Gear - VCC)

Connect this wire to the rear gear wire of your car so that the backup camera function can be activated when you car is in reverse gear.

Yellow "Constant"

Connect to electrical terminal always supplied with power regardless of ignition switch position.

Blue/White Remote Output (+)

Connect to Auto-antenna or power amp control wire/remote connection. Maximum current 500mA.

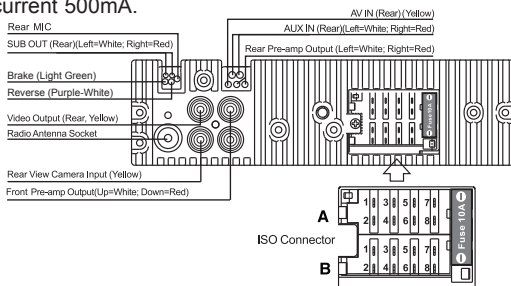

Connector A

1. Rear right speaker(+)/Purple
2. Rear right speaker(-)/Purple-Black
3. Front right speaker(+)/Grey
4. Front right speaker(-)/Grey-Black
5. Front left speaker(+)/White
6. Front left speaker(-)/White-Black
7. Rear left speaker(+)/Green
8. Rear left speaker(-)/Green-Black

Connector B

1. -
2. -
3. -
4. Battery 12V (+)/Yellow
5. Remote Trigger/Blue-White
6. -
7. ACC+/Red
8. Ground/Black

Speaker Wiring Notes:

Follow the above wiring diagram to install the head unit with new or existing speakers.

1. This unit is designed for use with four (4) speakers with impedance between 4 Ohms to 8 Ohms.
2. An Impedance load of less than 4 Ohms could damage the unit.
3. Never bridge or combine the speaker wire outputs. When not using four speakers, use electrical tape to tape the ends of the unused speaker outputs to prevent a short circuit.
4. Never ground the negative speaker terminals to chassis ground.

Controls Of The Unit

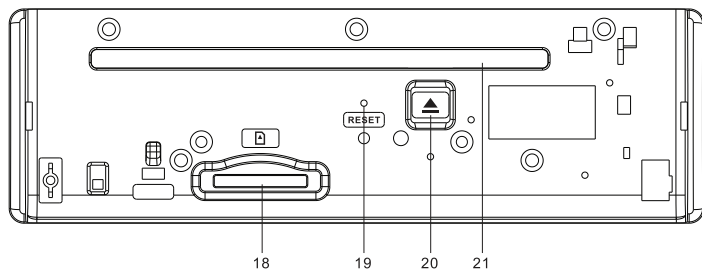
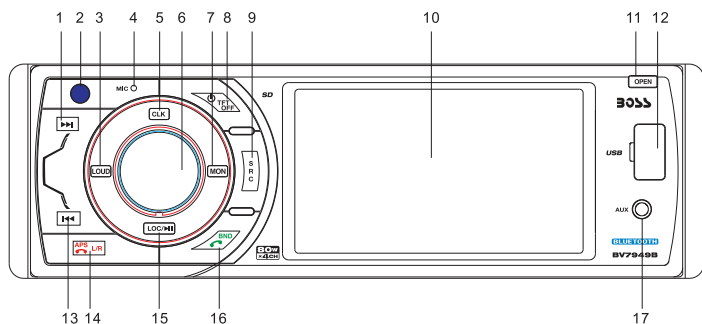

- | | |
|---------------------------------|--------------------------------------|
| 1. Next Track/Change Frequency | 12. USB Slot. |
| 2. Remote Control Receiver | 13. Previous Track/Change Frequency |
| 3. Loud On/Off Button | 14. APS(Auto Preset Scan)/L/R/Reject |
| 4. Mic Receiver | 15. LOC/Play/Pause Function |
| 5. Clock Display Button | 16. Radio Band Select/Answer |
| 6. Sound Select/Volume +/- | 17. Aux Input Jack |
| 7. Mon/Stereo Button | 18. SD Card Slot |
| 8. Power On/Off/TFT On/Off | 19. Reset Button |
| 9. Mode Select | 20. Eject Disc Button |
| 10. TFT Screen (3.6") | 21. CD/DVD Window |
| 11. OPEN (Panel Release Button) | |

Basic Operation



1. Tuning the unit On / Off

Press the Power button once to turn the unit on. The opening screen of the unit will be showing on the TFT monitor. Press and hold the POWER button for 2 seconds to turn the unit off.

2. Turning the TFT On / Off

During any play mode, press the Power Button once to turn the TFT screen off for screen saving and avoid distraction while driving. The sound will continue to play. Press the Power Button again to turn the TFT screen back on.

3. Mode Selection

Press the MOD Button on the front panel to cycle the Play Mode between RADIO, AUX, Blue Tooth and AV IN. Play mode can be chosen by touching on the Main User Interface also.

4. Volume Control

Press the VOL +/- Button on the front panel to adjust the volume level.

5. Eject Button

Press the Eject Button on the plastic bottom case to eject DVD or CD disc.

6. Main User Interface

As shown on the diagram on the top. Each play mode can be accessed directly by touching the screen.

7. Preset Equalizer Function

Press the VOL knob repeatedly to choose the EQ sound effects. The Sequence of equalizer setting will be as follows:

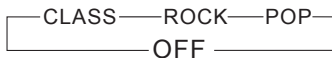

Basic Operation(Con'd)

8. Mute Control

Press the MUTE Button on the remote control to activate the mute function. Press the button again to resume.

9. Bass

Press the VOL knob until the display shows "BAS". Use the VOL DN/UP knob to adjust. When EQ is ON, bass control is not available.

10. Treble

Press VOL knob until the display shows "TRE". Use the VOL DN/UP knob to adjust. When EQ is ON, treble control is not available.

11. Balance

Press VOL knob until the display shows "BAL", then use the VOL DN/UP knob to adjust the balance between the left & right speakers.

12. Fader

Press VOL knob until the display shows "FAD", then use the VOL DN/UP knob to adjust the balance between the front & rear speakers.

13. Clock

Press the CLK button on the panel to show the time on the display.

14. Loudness Control

Press the LOUD button on the front panel until the display shows "LOUD OFF" indicates that the loudness function is OFF. Press the LOUD button again to turn the LOUD ON.

15. Sub Switch

Press the VOL knob repeatedly until display shows "SUB OFF", then use the VOL DN/UP knob to cycle between SUB ON and OFF, leave the unit idle for setting to take effect.

16. Preset Beep Sound Off

Press the SEL button repeatedly until display shows "BEEP OFF", then use the VOL DN/UP knob to cycle between BEEP ON and OFF, leave the unit idle for setting to take effect.

Radio Operation



1. Choose Radio Band

Press the MOD Button to access the radio function. Press the BND button to select your desired radio band during RADIO mode.

The unit comes with five bands- three FM Bands (FM1, FM2, and FM3) and two AM Bands (MW1, and MW2). Each of the five bands can store up to six preset stations, for a total of 30 preset memory stations.

2. Auto/Manual Tuning

Manual tuning: Press and hold the >>| or |<< button for a second until display shows "MANUSEEK" on the left top of the screen to adjust the radio frequency step by step.

Automatic tuning: In default tuning mode (AUTOSEEK), Press >>| or <<| (left or right arrow on the screen) once to adjust the radio frequency automatically. Press the >>| or <<| (left or right arrow on display) to stop searching.

3. Mono/Stereo Reception Control

Under radio mode, touch MO/ST button on the screen to select ST:ON or ST:OFF. When ST:OFF is selected, the word "MONO" will be displayed on the screen.

4. Local/Distance Control

Press the LOC/RDM button on the remote control or press LOC/>|| button to select LOCAL or DX on the front panel.

Local and distance reception setting can facilitate the radio reception, depending on the location in which the radio is being used.

Radio Operation(Con'd)

5. Save Your Preset Stations

There are six numbered preset(P1-P6) buttons when you enter radio mode which can store and recall stations for each band. While listening to a radio station you would like to save as a pre-set, touch one of the buttons numbered P1-P6 until you hear a beep. The button you pressed is now the pre-set button for that station.

6. Automatic Store/Preset Scan

A. Automatic Scan & Store

Press and hold the APS Button for 3 seconds. The receiver will automatically scan and save the 6 strongest available stations as the 6 preset memories of the current band. To stop auto store, press this button again.

B. Scan Saved Stations

Press the APS button on the front panel or touch APS button under radio mode to scan all preset stations in the memory of the current band and stay on each memory stations for about 5 seconds. To stop preset scan, press this function again. To listen to saved station touch P1-6 button on the screen.

DVD/VCD/CD/MP3/WMA Operation

1.Insert / Eject CD

Press “Open” button, the front panel of the unit will slip down and then insert a disc into CD slot with label side up. The disc will be automatically loaded into the unit, even when it is off or at radio mode. Then close the front panel. The word “LOAD” will be shown on the display and the CD will play automatically. Press “Open” button, the front panel of the unit will slip down , then press EJECT Button to eject the disc from the slot. If the disc is not removed from the slot within 5 seconds, it will automatically be loaded into the slot again. When the disc is ejected and removed, the unit will automatically switch to radio mode.

A. While you are playing DVD, after the disc is loaded, the media of the DVD will be played automatically. The menu will be prompted so that you can choose the setting. You can also press the PBC button on the remote control during playback to return to the opening screen to get the menu. The disc will go back to the opening screen if PBC button is pressed.

B. While you are playing CD, the monitor will show the details as PIC 01:

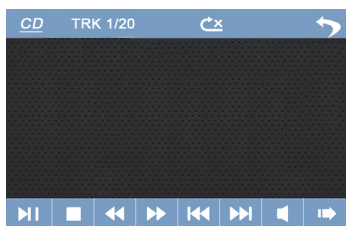

PIC 01



PIC 02

However, when you under MP3 mode, you could use the navigation “↑” “→” “←” “↓” button from remote control (or touch directly the song what you want on the screen) to select the song you would like to listen, then press the ENTER button to confirm your selection.

C. While you are playing MP3/WMA in DVD/CD/USB/SD, the monitor will show the details as PIC 02 :

D. While you are playing DVD/CD/USB/SD which contains MP3, WMA, JPG or DIVX formats, after insert the disc into the CD Slot, the unit will directly play the audio files. To select the format among music, picture, video, and then you can use the navigation “↑” “→” “←” “↓” button From the remote control(or touch directly on the screen) to select the file that you would like to view/listen to and press the ENTER button to confirm your selection.

Picture of playlist menu (see PIC 02)

DVD/VCD/CD/MP3/WMA Operation(Con'd)

2. OSD (ON-Screen Display)

While playing DVD/VCD, press OSD button On the remote control or touch the screen directly to activate the OSD.

A. For VCD, the monitor will show the details as PIC 03 :

B. For DVD, activate OSD for the first time, the monitor will show the details as PIC 04 :

activate OSD for the second time, the monitor will show :

Press again to turn the OSD off, leave it for 5 seconds, the unit will turn off the OSD automatically.

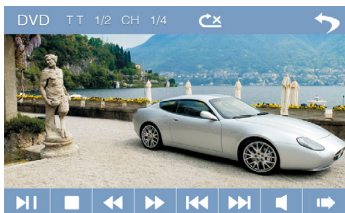
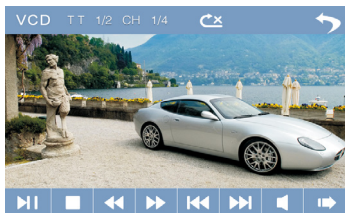

3. Title / PBC Playing

Press the TITLE button on the remote control so that the first title track of the DVD will be played. After playing, the current running track will be resumed. For VCD2.0, press the PBC button on the remote control while the disc is playing. You can switch between PBC on and PBC off mode.

4. Selecting Tracks

Press SEEK >>| or SEEK |<< On the Remote Control, Track numbers will be shown on the display. Press and hold the SEEK |<< Button to fast reverse. Disc will play normally when the SEEK >>| or SEEK |<< Button is released.

5. Play/Pause

Press the LOC/>|| button on the unit or >|| button from the remote control to call the setup menu.

6. Audio Selection

Under DVD/VCD mode, press APS button on the unit or AUDIO button on the remote control, in order to choose the audio language. The audio languages available differ from Disc to Disc. You can also use the setup menu to confirm. Refer to the packing of the Disc for details.

7. Subtitle Language

Press the SUB-T button on remote control to select the subtitle language you want. The sub-title languages available differ from Disc to Disc. You can also use the setup menu to confirm. Refer to the packing of the Disc for details.

DVD/VCD/CD/MP3/WMA Operation(Con'd)

The audio languages available differ from Disc to Disc. You can also use the setup menu to confirm. Refer to the packing of the Disc for details.

VCD: Press AUDIO during playbackIt is possible to switch the sound between mono and stereo sound. The sequence is as follows:
Mono Left --> Mono Right --> MIX MONO --> STEREO

8. Track Time Search

Press the GOTO button on the remote control to search the desired track time to play the Disc. The OSD will be prompted. Make use of the navigation keys and digit keys on the remote control to choose your desired chapter, track or time. Press the ENTER button to confirm your selection.

9. Zoom +/-

Press the ZOOM button on the remote control to perform the zoom function. The zoom range is from 1/4 up to 4 (total 7 stages), according to the zooming intensity.

10. Slow Motion

Press the SLOW button on the remote control to perform slow motion of the video play. SF 1/2 up to 1/7 will be shown, according to the slowness. Cycle back to normal playback of press the Play/Pause button to resume.

11. Multi-Angle View

Press the ANGLE button on the remote control to perform multi-angle playback. The number of angles change in sequential order.

Note: The number of angles is different according to the disc. The function only work for discs having scenes recorded at different angles. When no different angle is recorded, the OSD will show "INVALID KEY"

12. Video System

Press the BND/NP/SUB button on the headunit or remote control to choose between NTSC, PAL, AUTO, according to the encoding format of the disc. The default mode is AUTO. Use this function if there is something wrong about the display function (eg. no color is display).

13. Programmer Mode

Press the PROG button on the remote control to set the program play. Use the Navigation and Digit keys to set the Chapter and Track no. as your desired sequence. Press Enter to begin the program play. Press the PROG button and confirm a blank program again to cancel this operation.

14. Electronic Shock Protection

This unit is programmed with Electronic Shock Protection (ESP) so that the video/music will be protected against rough roads. Electronic Shock Protection time depends on the media that is being played. ESP for playing DVD is 5 seconds, for playing VCD is 10 seconds, for playing CD is 12 seconds, for MP3 is 180 seconds. This is built-in function so that there is no need to switch on or switch off.

DVD/VCD/CD/MP3/WMA Operation(Con'd)

15. Returning to Main User Interface

Press the arrow on the right hand side of onscreen menu p.1 to return to the main user interface.

Onscreen Menu



SETUP MENU

The functions of the setup menu will be briefly described as follows:

1. Functions of the setup menu are as follows:

From Left to Right:

A. System setup /B. Language setup /C. Audio setup /D. Video setup

A. SYSTEM SETUP

a. TV SYSTEM -- This player can play discs recorded in either PAL or NTSC format. Select NTSC format when you are connected to NTSC TV. Select PAL format when you are connected to PAL TV. If you select AUTO, the unit will auto select the format according to you TV System.

b. SCREEN SAVER -- Choose the screen saver on or off.

c. TV TYPE -- This is to select the appropriate TV aspect (4:3 or 16:9) according to the connected TV set.

i) 4:3 PS -- Played back in the PAN & SCAN style. (If connected to wide-screen TV, the left and right edges are cut off.)

ii) 4:3 LB -- Played back in LETTERBOX style. (If connected to wide-screen TV, black bands appear at top and bottom of the screen)

iii) 16:9 -- Select when a wide-screen TV set is connected.

d. PASSWORD -- Press the STOP button for two times during playback, so that the disc play is completely stop. Press the right, left, down, up buttons orderly, then the setup menu for password will be prompted for you to set up the new password.

e. RATING -- Select Suitable guidance rating by the cursor button and confirm by pressing ENTER button.

Rating 1: [Kid Safe] -- Select it if the programs are safe to all kids view.

Rating 2: [G] -- Select it to indicate that it allows admission to person of all ages.

DVD/VCD/CD/MP3/WMA Operation(Con'd)

Rating 3: [PG] -- Select it to indicate that it needs parents to guide their children.

Rating 4: [PG_13] -- Select it to indicate that children under 13 are forbidden to view.

Rating 5: [PG_R] -- Select it if "PG_R" was printed on the DVD disc.

Rating 6: [R] -- Select it to indicate that children under 17 must be guided to view by their parents.

Rating 7: [NC-17] -- Select it to indicate that children under 17 are forbidden to view.

Rating 8: [ADULT] -- Select it to indicate that only adults are permitted to view.

B. LANGUAGE SETUP

Select the preferred OSD Language, Audio Language, Subtitle Language and Menu Language by using the navigation buttons. The default language is in English. Please refer to the setup tree to select language of the following categories:

a. OSD Language /b. Audio Language /c. Subtitle Language /d. Menu Language

C. AUDIO SETUP

a. AUDIO OUT

This is to activate the audio output from ANALOG/OPTICAL mode to SPDIF/RAW mode or SPDIF/PCM mode.

i) SPDIF/OFF

Analog or Optical output port all has not output signal.

ii) SPDIF/RAW

When the player is connected with the power amplifier by the analog or optical port, please select this item; when the playing disc which is recorded by Dolby Digital, DTS or MPEG recording system, the analog or optical output signal of the unit will be the same as the digital signal (RAW format) of the playing disc. At the same time, the power amplifier you connected must have the decode function of Dolby Digital, DTS or MPEG.

iii) SPDIF/PCM

When the player is connected with the 2 channel, digital stereo amplifier, please select this item; when the playing disc which is recorded by Dolby Digital or MPEG recording system, the analog or optical output will be modulated to 2 channel output by PCM.

b. KEY

This is to select key up and down according to your needs.

D. VIDEO SETUP

This is to let the user set Brightness, Contrast, Hue, Saturation and Sharpness using the navigation keys. Press ENTER button to confirm the setting of the video. The sequence of the video setup is as follows:

a. BRIGHTNESS

b. CONTRAST

c. HUE

d. SATURATION

e. SHARPNESS

Bluetooth Operation

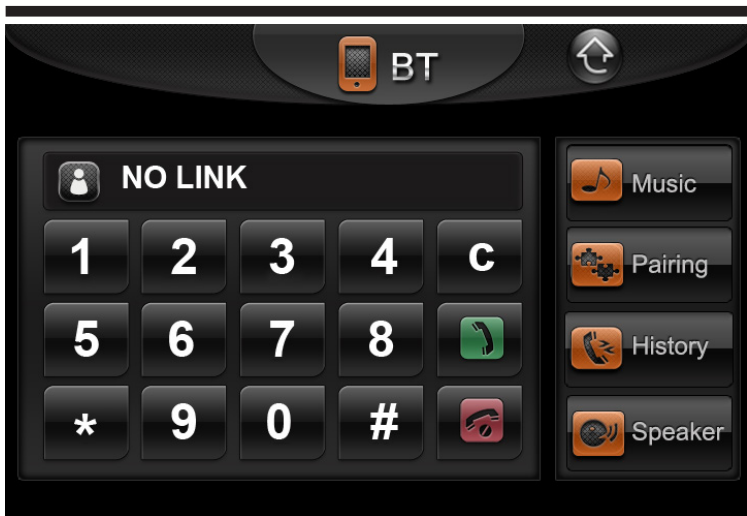

PAIRING

Open the bluetooth switch on the phone, search bluetooth device by the phone and "BOSS AUDIO" will appear in your phone. Input "0000" as password to establish connection.

DIAL PAD

Touch the dial pad to dial the number you would like to call. Touch the CALL (green) button to send the number.

SPEAKER PHONE

Touch the SPEAKER button to select the sound to be received by the car audio speakers or the cellphone.

REJECT CALL

Press the REJECT (red) button to end the call or to reject an incoming call.

RETURN TO USER MANUAL

Touch the arrow key on the top right corner to return to the main user interface.

Bluetooth Operation(Con'd)

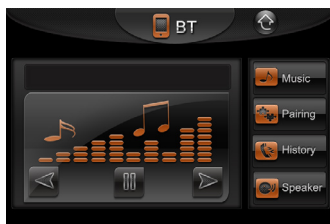
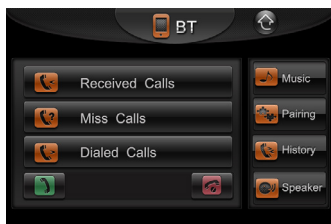

CALL RECORD

Press the HISTORY button to enter the phone book page to view received, missed and dialed calls. More details in the next page.

1. Received Calls

Touch the RECEIVED CALLS button, the received call will be displayed.

2. Missed Calls

Touch the MISSED CALLS button, the missed call will be displayed.

3. Dialed Calls

Touch the DIALED CALLS button, the dialed call will be displayed.

A2DP

Press the MUSIC button to enter the A2DP page to control playing music of your cellphone.

Playing Music on your cellphone

Touch || to play or pause the music. Touch |<< and >>| to select down or up one song in your song list.

Settings & Sounds

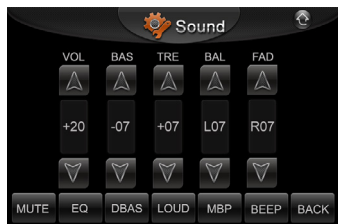

The Settings and Sound menu can be selected in Radio, Aux and Main User Interface.

1. CLOCK

Set the time clock by touching the arrow up or down for hour and min session accordingly. The clock will be displayed on the right.

2. Clock Mode

Set the time mode "12" or "24" by touching the arrow up or down.

3. Clock AM/PM

When the clock mode is set 12, AM/PM button is able to set, indicating different time of a day; When the clock mode is set 24, the AM/FM button is inactive to set.

4. DISPLAY SETTINGS

Brightness, Contrast, Color and Hue can be set by touching the up or down arrow.

5. Radio Region

You can set USA or Europe in Radio Region by touching the arrows.

6. Subwoofer

Subwoofer function can be set on or off by touching the arrows.

7. SOUND

Various sound settings including Volume, Bass, Treble, Balance, Fader, Equalizer, D-Bass, Loud, Super Bass (MBP), Beep on/off can be set in the SOUND menu.

8. VOLUME

Press the VOL+ and VOL- button to adjust the volume level. It can also be selected by the SELECT button. Turn the SELECT button to the right to increase the volume, and to the left to decrease the volume.

Other Operations

1. Front Pre-amp Output x 4

The RCA Output Jack is on the back of the unit. (Refer to Wiring Diagram) This output is for connecting amplifier, equalizer, or other audio component that requires a pre-amp out connection. (Red=Right, White=Left) Follow the manufacturer's instructions for the audio component that you are connecting.

2. Video Output(Rear) x 1

The Video Output Jack is on the back of the unit. (Refer to Wiring Diagram) This output (in yellow) is for connecting monitor(s). You must connect a monitor for car in order to play this unit in another monitor. Consult your dealer for any kinds of monitors that are suitable to use in car. Press the "BAND" button to choose between PAL and NTSC mode.

3. Backup Camera Input(Rear) x 1

The backup camera input is on the back of the unit. (refer to wiring diagram). This input (in yellow) is for connecting backup camera for parking. You must connect the VCC wire (in pink color) to the reverse gear switch in order to activate this video input mode when you switch the reverse gear of your car. Please refer to the wiring diagram for more details.

4. SUB Pre-amp Output x 2

The Subwoofer Output Jack is on the output wire harness. (Refer to Wiring Diagram) This output is for connecting up to 2 subwoofer amplifier to the Subwoofer Output Jack to drive a subwoofer. Follow the amplifier's installation instructions. Press and hold the BAND/NP/SUB button to activate or deactivate this function.

5. Aux Input(Front) x 1

The Aux Input Jack is a 3.5mm connector on the front panel of the unit. Press the Mode button to choose AUX. Connect any portable audio device such as a discman or a portable MP3 player to the unit. Use the volume control to adjust volume.

6. AV Input(Rear) x 1

The AV Input Jack is a set of composite input on the rear of the unit. Press the Mode button to choose AUX. Connect any portable audio/video device such as a DVD player or VCD player to unit. Use the volume control to adjust volume.

Maintenance

Cleaning the Unit

Do not use any liquids to clean this unit.

Do not use petroleum distillates to clean this unit.

Use a clean, dry cloth to clean this unit.

Replacing the Fuse

Make sure the amperage matches the specified value when replacing the fuse(s). If the fuse is bad, check the power connection and replace the fuse with a new one. If the same problem occurs, this might indicate a malfunction within the unit.

Warning

When replacing a fuse, do not use a fuse with a higher amperage rating than the fuse originally supplied to your unit, otherwise damage will result to your unit.

IR Remote Control

- Power on/off
- Band Select
- Mode Select Key
- Play / Pause Function
- Mute Sound Function
- Show All Track's Title (DVD only)
- Display SETUP Menu
- Subtitle Language Switching Key

- Cursor Button in Menu Mode
- Confirm The Track/Chapter Selected or Select Item In SETUP Menu.
- Stop Playback
- Watch The DVD Content From Different Angle
- Play DVD in Slow Advance
- Repeat Play Function
- Program The Tracks To Be Played / Stereo Selection
- Adjust Volume Level
- Zoom In and Zoom Out Function
- Random Play Function / Local Selection
- Track Up / Down or Fast Forward / Backward
- Sound Select Button
- PBC Play Mode
- Statistical Disc Information Display Button
- Change The Audio Output Method
- Number Select Key
- Track Time Search

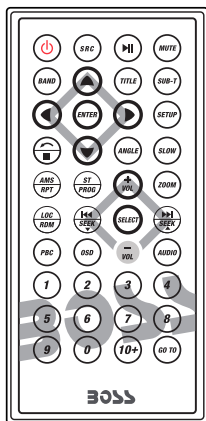

This unit comes with a full remote control system. The CR-2025 Lithium battery is an included item with the remote control. **TO PLACE THE BATTERY:**

- (1) Remove the cover from the back of the remote control.
- (2) Insert a CR-2025 Lithium battery.
- (3) Insert the battery holder into the back of the remote control.

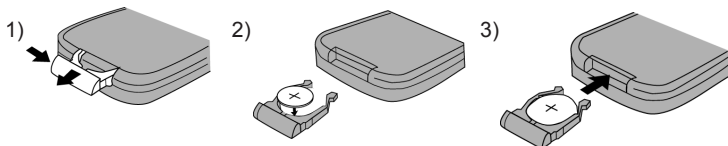

Operating the remote control

Aim at the face panel of the CD Receiver, the maximum distance at which signals can be received is about 6M. Make sure that the signal path is not obstructed. Do not drop or throw the remote control. Do not place the remote control in a location that is exposed to direct sunlight or next to a heating unit or other heat source.

Troubleshooting Guide

PROBLEM	CAUSE/SOLUTION
No Power	Check wiring connections. Check and make sure the fuse is not blown. Replace with the proper rating/size fuse.
Some errors occur in the LCD or nothing functions when buttons are pressed.	Press the RESET Button.
Unable to receive stations	Check and make sure the antenna is connected properly.
Poor radio reception	Check and make sure the antenna is the correct length. Make sure the antenna is not broken. If the antenna is broken, replace it. The antenna is poorly grounded. Check and make sure the antenna is grounded at mounting location.
CD's cannot be loaded	A CD is already loaded in the player. Eject CD.
Songs keep skipping	The CD is dirty or damaged.
File information shows in LCD but will not play.	Your file may be corrupt.

Specifications

GENERAL

Operating Power.....	12 Volts DC, Negative Ground
Wattage.....	80WX4CH
Speaker output.....	4 speakers
Front Pre-amp Output.....	1v
Output Impedance.....	4 to 8 Ohms
Fuses.....	10 A
Dimensions.....	7" (W) x 7" (D) x 2" (H)
Weight.....	4.4 lbs

CD PLAYER

Signal / Noise Ratio.....	>80dB
Frequency Response.....	20 Hz~20KHz
Channel Separation.....	>50dB
D / A Converter.....	16 Bit

FM TUNER

Tuning Range.....	(USA) 87.5 - 107.9MHz, (Europe) 87.5 - 108 MHz
FM Sensitivity.....	12dBu
Stereo Separation @ 1 KHz.....	35dB

AM TUNER

Tuning Range.....	(USA) 530-1710 KHz, (Europe) 522-1620 KHz
AM Sensitivity.....	30dBu

USER'S MANUAL

BV7949B

BLUETOOTH®-ENABLED | DVD/MP3/CD AM/FM RECEIVER



BOSS Audio Systems

3451 Lunar Court • Oxnard, CA 93030

www.bossaudio.com | 805.751.4853

tech support: www.bossaudio.com/technical-support



0215

iPod® / iPhone® are trademarks of Apple, Inc. registered in the U.S. and other countries.
BOSS Audio Systems is not affiliated with Apple, Inc.