

INSTRUCTION MANUAL



Patio Folding Highback Dining Chair

V2.0

! NOTICE



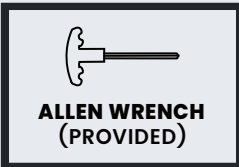

Do not overtighten screws. (Insert all screws before tightening screws.)

- Please do not exceed the weight limitations of this item.
- Do not stand on or use any part of this item as a step ladder.
- Firmly secure all bolts, screws, and nuts before use.
- Reconfirm that all bolts, screws, and nuts are secure every 90 days.
- Do not use or store this item in the proximity of open flame or flammable/combustible chemicals.
- Be aware that some parts are heavy and have sharp edges.
- When using an electric drill, please adjust its speed slowly to avoid screw slippage.

TOOLS REQUIRED

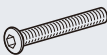
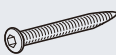
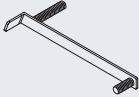
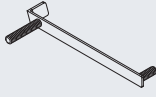
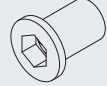

HARDWARE

1 BOLT M6 x 60mm  2 PCS	2 SCREW M6 x 50mm  2 PCS	3 RIGHT CONNECTOR  1 PC	4 LEFT CONNECTOR  1 PC	5 BARREL NUT M6 x 18mm  4 PCS
6 M6 NUT  2 PCS	7 M6 WASHER  10 PCS	8 M6 WASHER (BIG)  4 PCS		

PARTS

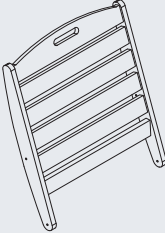
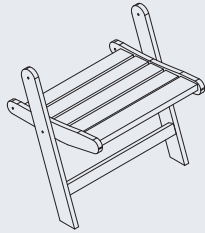
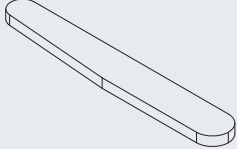
A CHAIR BACKREST  1 PC	B CHAIR SEAT  1 PC	C CHAIR RIGHT ARM  1 PC
--	--	---

PARTS

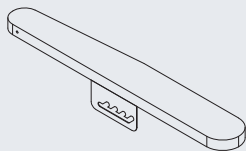
D**CHAIR LEFT ARM**

1 PC

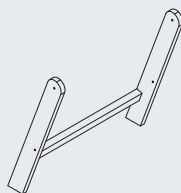
E**CHAIR REAR LEG**

1 PC

PRODUCT ASSEMBLY – OVERALL VIEW

Look at the overall view of this chair and learn the exact position of each part to be assembled.

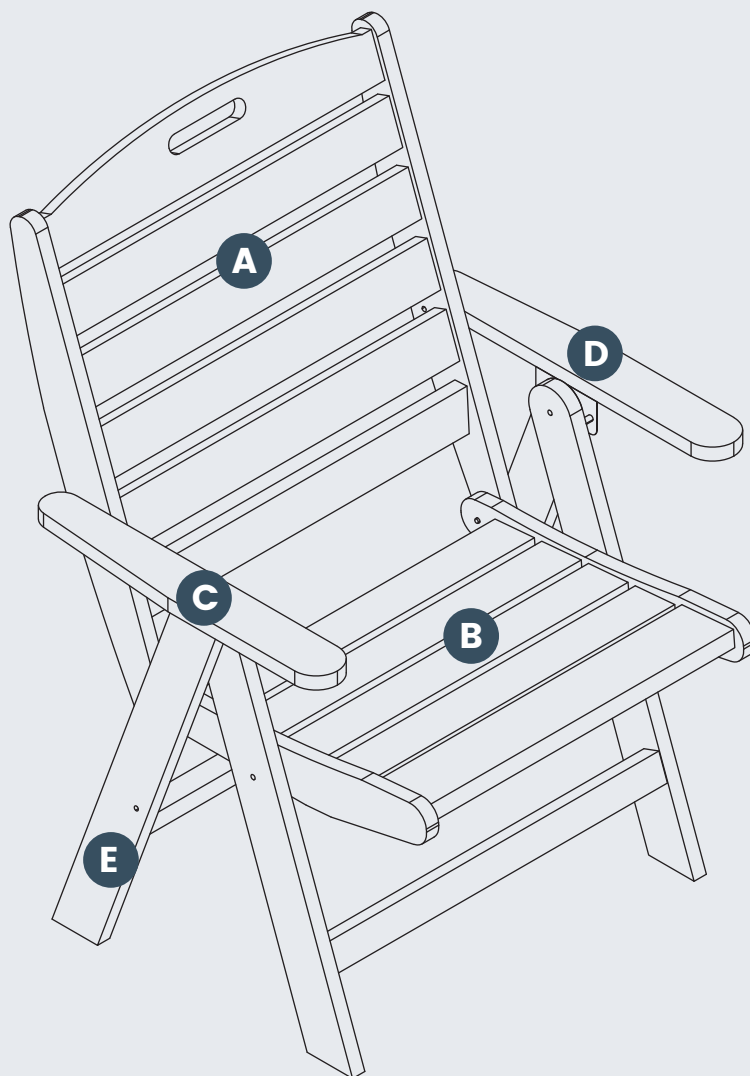

PRODUCT ASSEMBLY

1

Attach **Part A Chair Backrest** to **Part B Chair Seat** with 1 pc of **Hardware #3 Right Connector**, 1 pc of **Hardware #4 Left Connector**, 2 pcs of **Hardware #5 Barrel Nut** and 4 pcs of **Hardware #7 Washer**.

Please make sure the protective cover is properly fitted on Hardware #3 and #4 Connector.

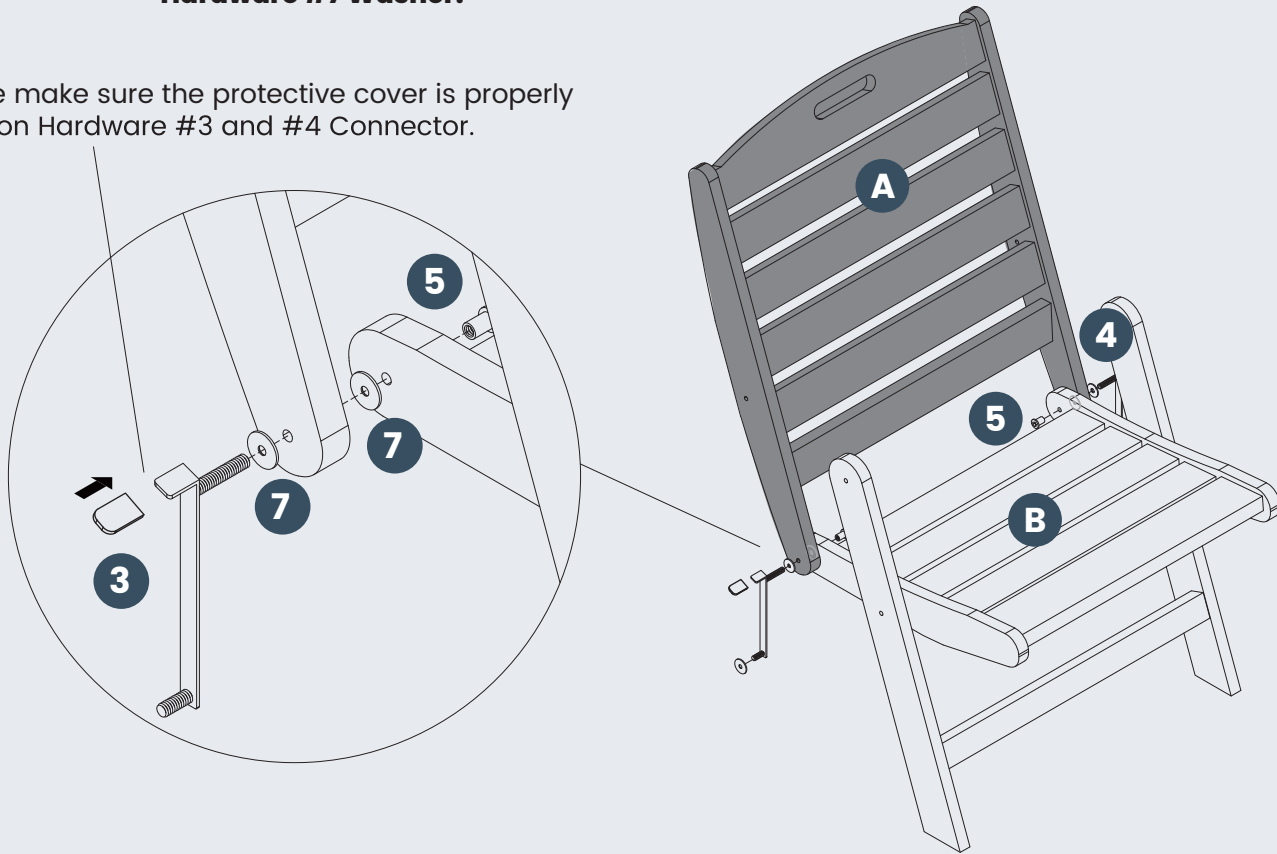

2

Attach **Part E Chair Rear Leg** to **Part A Chair Backrest** with the other end of **Hardware #3 Right Connector** and **Hardware #4 Left Connector**, 2 pcs of **Hardware #7 Washer** and 2 pcs of **Hardware #5 Barrel Nut**.

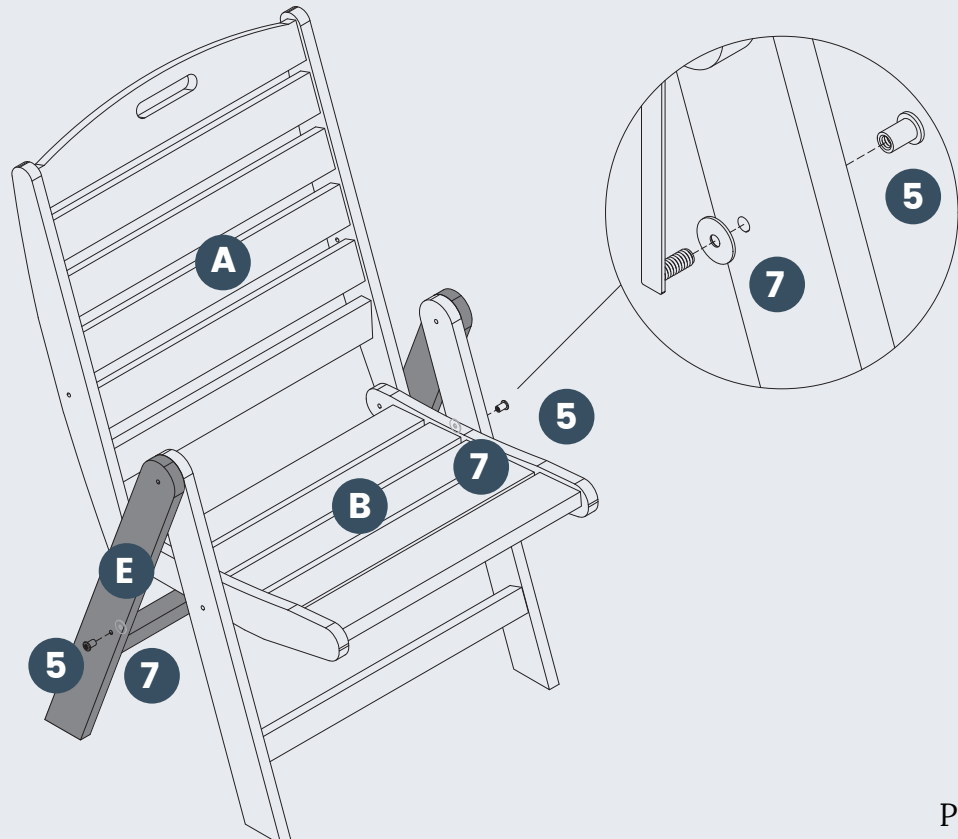

PRODUCT ASSEMBLY

3

Attach **Part C Chair Right Arm** and **Part D Chair Left Arm** to **Part A Chair Backrest** with 2 pcs of **Hardware #2 Screw** and 2 pcs of **Hardware #7 Washer**.

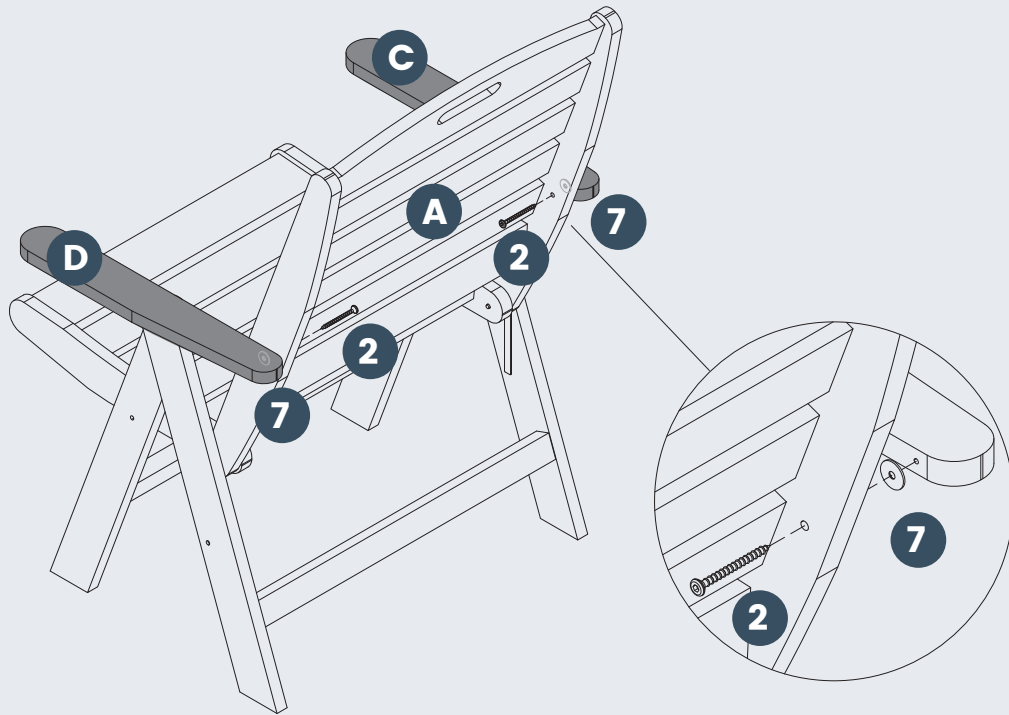

4

Attach **Part C Chair Right Arm** to **Part E Chair Rear Leg** and **Part B Chair Seat** with 1 pc of **Hardware #1 Bolt**, 2 pcs of **Hardware #8 Washer**, 1 pc of **Hardware #7 Washer** and 1 pc of **Hardware #6 Nut**.

Do the same to the **Part D Chair Left Arm**.

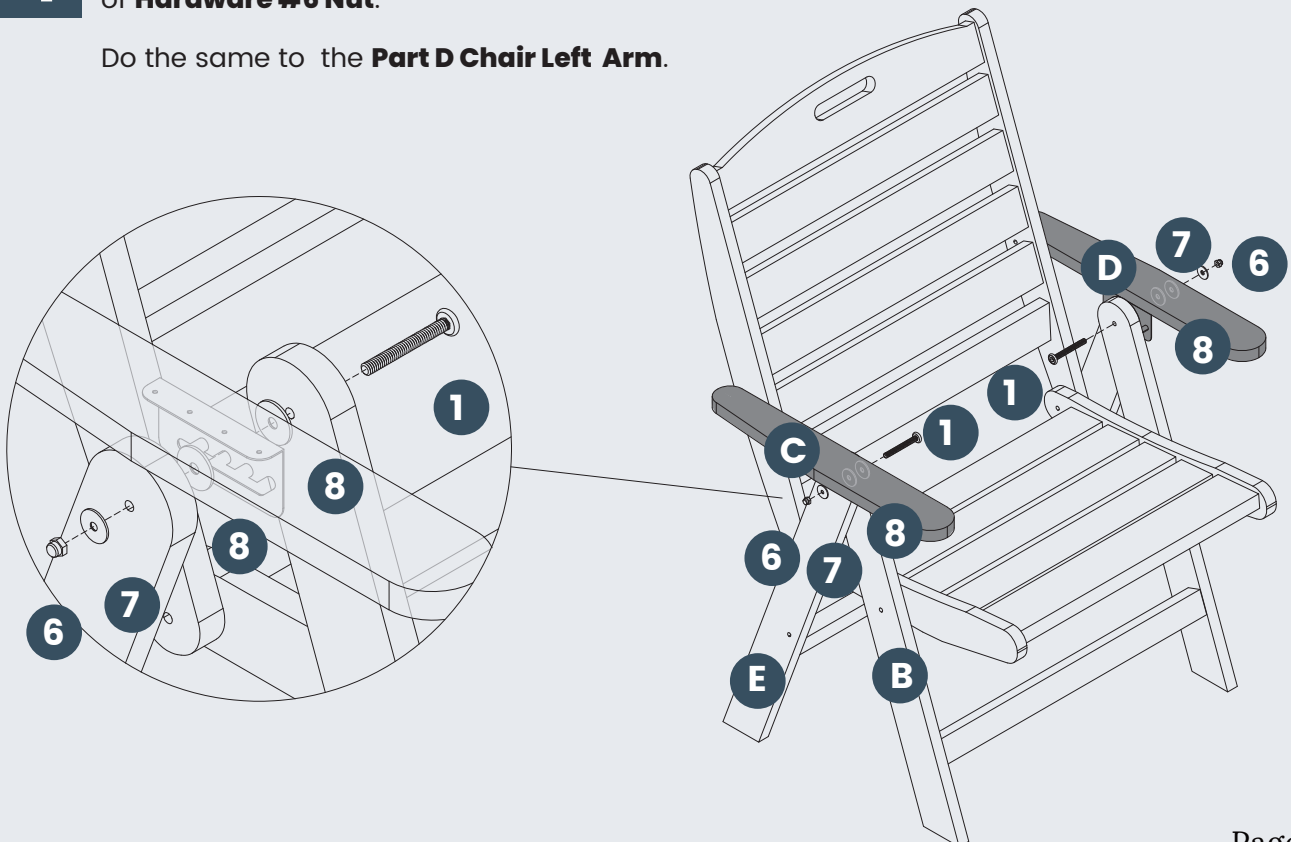

5

Adjust the backrest to the position you like and fasten the nut on the arm.

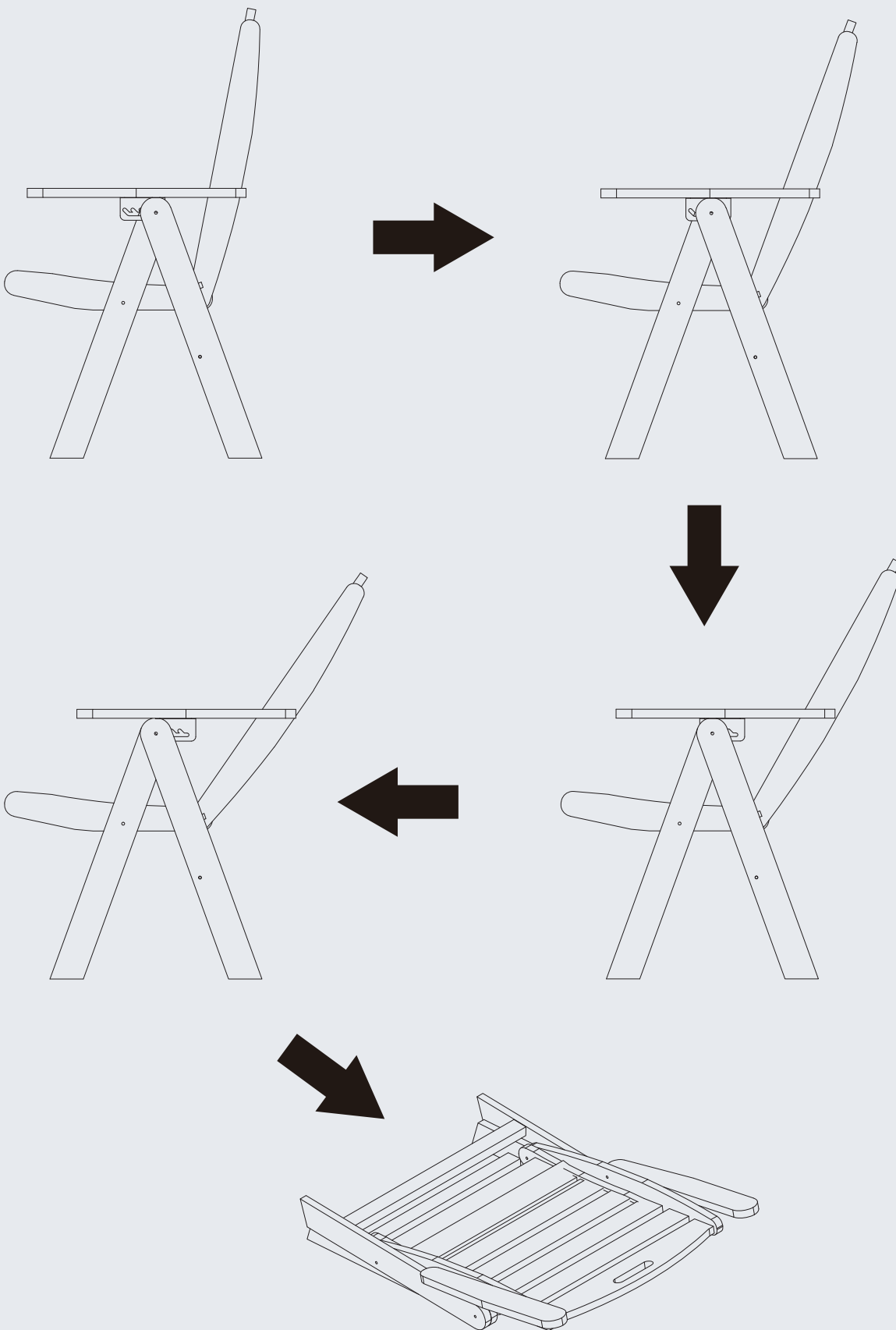

CLEANING TIPS

REGULAR CLEAN: Use a mixture of warm water and mild soap. Gently scrub the surface with a soft bristle brush to remove any dirt or stains.

QUICK CLEAN: You can simply wipe down the furniture with a damp cloth.

Regular cleaning not only preserves the aesthetic appeal of your furniture, but also helps extend its lifespan.