

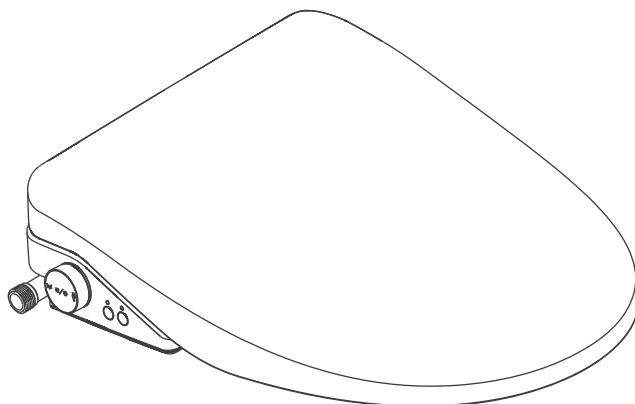

ITEM: TL-AZEB106VWH/UWH
TL-AZEB107VWH/UWH
ANZZI ELECTRIC BIDET SEAT
INSTALL & OPERATION MANUAL
V1.0



DON'T WAIT! REGISTER NOW!

Register your product within 90 days to ensure your product is recognized as an official purchase and is eligible for warranty coverage.

Mail in the completed registry card (Pg.3) or register online at www.swcorp.com/register.



PRODUCT REGISTRATION*

IMPORTANT: Warranty will not be recognized unless product is registered.

We offer two options to register your product.

1. **Register online at <https://register.anzzihome.com/register/>** or Scan the QR code below. Registering online is fast, secure, and ensures we receive your information.



2. **Complete, cut out, and mail the registration card below.** Returning this registration card will ensure your product's warranty and allow us to process any warranty claims.

Mail the card to: 5701 NW 35 Avenue, Miami, FL 33142



Product Registration Card

Name..... Address

City.....State..... Zip.....

Phone..... Email.....

Date of Purchase Order or Purchase # SKU or Model #

Installer's Name Phone

I have read the Owner's Manual carefully and understand and agree that any installation, operation or maintenance of the product must be done strictly in accordance with instructions and guidelines contained in the owner's manual and installation guide.

Signature..... Date.....

Need help? For technical support call 305-614-4070 or visit us at www.ANZZI.com

PRODUCT SIZE CHART

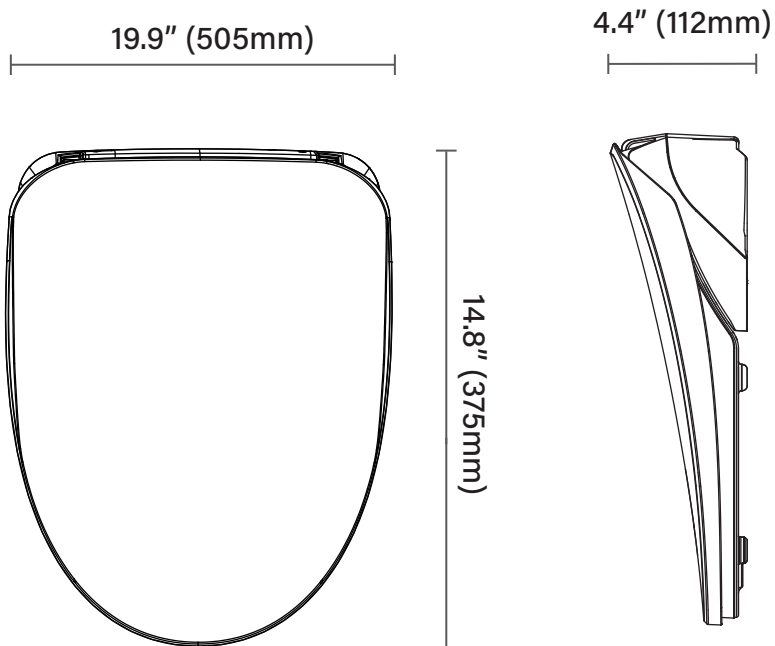

Thank you for choosing **ENVO Electric Bidet Seat**. Please read and understand this entire manual before attempting to install, assemble or operate this product.

SAVE THESE INSTRUCTIONS

TABLE OF CONTENTS

SAFETY PRECAUTIONS	PG.7
COMPONENTS	PG.9
ELECTRIC BIDET SEAT INSTALLATION.....	PG.10
GUIDELINES FOR FIRST USE	PG.14
OPERATION INSTRUCTIONS FOR SIDE KNOB	PG.15
REMOTE CONTROL INSTRUCTIONS	PG.16
CLEANING & MAINTENANCE.....	PG.18
FUNCTION LIST	PG.20
PRODUCT PARAMETERS	PG.20
TROUBLE SHOOTING	PG.21

SAFETY PRECAUTIONS

Please carefully read the safety precautions before installation. This is important and must be observed.

DANGER

Only connect to a Ground-Fault Circuit-Interrupter(GFCI) protected grounded socket.

Do not remove the ground pin or use a ground adapter.

Otherwise, electric shock will be caused by fault or short circuit.

WARNING

●Any modification to your ENVO Electric Bidet Seat will invalidate the warranty. If cables, plugs or other components need to be repaired or replaced, they need to be installed by qualified electricians.

●Any replacement shall be provided by ANZZI. The use of a third-party replacement will invalidate the warranty.

●Cut off the power supply before maintenance.

●Ensure that the bathroom is well ventilated to avoid moisture accumulation. Installing the electric bidet seat in a humid place may cause electrical failure of the product.

●In any case, the socket shall be installed at a position greater than 19-11/16"(500mm) from the bathtub.

●Do not touch the power socket with wet hands, **Otherwise it may cause electric shock.**

●Do not pour water, hot water or detergent onto the top of the Electric bidet seat, power supply or plug.

●Make sure the Electric bidet seat is away from flames or combustibles.

●Do not put your fingers or anything at the outlet of the heater, **Otherwise it may cause burns or electric shock.**

●Do not excessively pull or bend the cable. If there is any damage to the cable or plug, cut off the power supply. Use the cable provided by ANZZI for replacement.

●Do not bend or squeeze the water inlet hose, **Otherwise it may lead to water leakage or reduce the water inlet pressure.**

●When power failure occurs during cleaning and the nozzle is not reset, do not push it back by hand. The nozzle will reset itself after the power supply is restored.

●If your ENVO Electric Bidet Seat has the following problems, please stop using it. Turn off power supply and supply stop.

- Pipe, hose or product leaks.
- Product breakage.
- The product has abnormal sound or peculiar smell.
- Smoke from the product.

●Do not use while bathing .
Do not place or store product where it can fall or be pulled into a tub or sink.
Do not place in or drop into water or other liquid.

Do not reach for a product that has fallen into water. Unplug immediately.

Product contains strong magnets — people fitted with pacemakers or other auxiliary equipment should not use.

SAFETY PRECAUTIONS

ATTENTION

- If you are not sure whether the product has been correctly grounded, please find a qualified electrician or sales and service personnel to check and confirm and make sure the power supply provides the matching voltage and power required by the product.

- Review all local plumbing and building codes related to products.

- The water supply pipe must be at least 1/2" copper pipe to provide the optimum flow for the normal operation of the product.

- Carefully check the new Electric bidet seat for damage.

- Use the water inlet hose supplied with the product.

- Do not stand on the Electric Bidet Seat or place any heavy objects on your Electric Bidet Seat. Otherwise, it may be damaged and cause personal injury or water leaks.

- Don't expose the seat to the sun. Otherwise the product may turn yellow or fade.

- Do not install Electric Bidet Seat on moving vehicles such as RVs or boats.

- Don't lean against the Bidet Seat lid.

- When children, the elderly or disabled people use this Bidet Seat, they need to pay close attention. Adjust the appropriate seat temperature for the people mentioned above, as well as for people having skin allergies.

- Do not use this Electric Bidet Seat when you are sleepy.

- Beware of low-grade burns. When sitting for a long time on the Bidet Seat, switch the Bidet Seat temperature adjustment to "OFF". When any of the following persons use a heated seat or warm air drying, someone should switch the Bidet Seat temperature adjustment to "OFF" and switch the drying air temperature to "Low".

- Young children, the elderly and other users who are unable set the temperature appropriately themselves.

- The ill, physically disabled and others who do not have freedom of movement.

- Those using any medicines that cause drowsiness (sleeping medicine or cold medicine), those who have been drinking heavily, anyone severely fatigued and anyone else liable to fall asleep.

- The Electric Bidet Seat requires fresh water only.

- Clean this product with a clean soft cloth. Do not use any abrasive detergent to clean this product.

- Always unplug the plug from the outlet before removing the main unit.

- Any replacement of parts must only be performed by qualified service personnel.

- When the ambient temperature is freezing or if you are not using the Electric Bidet Seat over an extended period of time, drain the water out of it and turn the supply stop off and pull the electrical plug from the outlet.

NOTE: ENVO does not assume any responsibility for the losses caused by the improper installation and actions listed above or other improper operations.

COMPONENTS

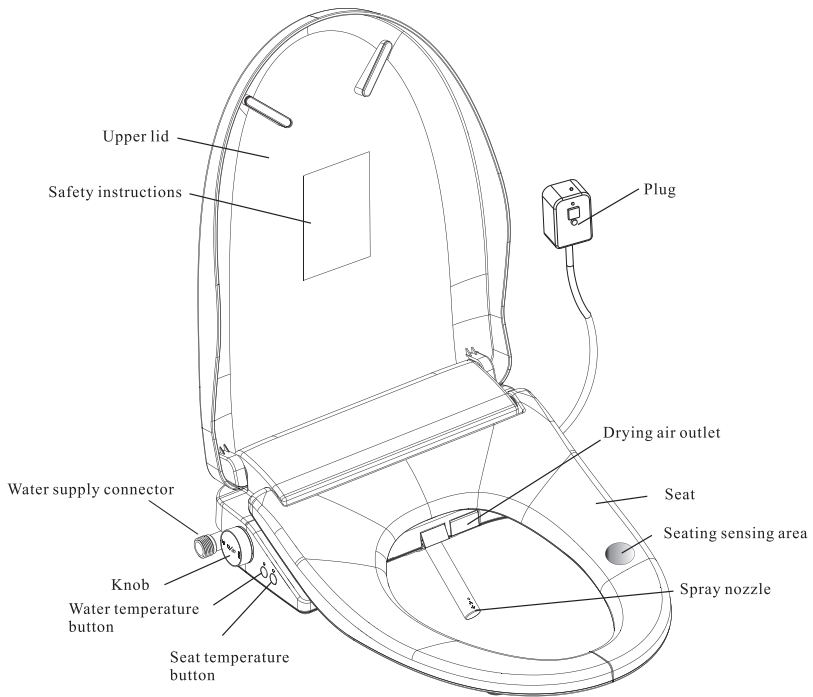

NO.	Name	Quantity	Sketch
1	Bidet seat	1pcs	
2	Accessories		
	Fixing plate	1pcs	
	Adjusting Block	2pcs	
	Expansion bolt	2pcs	
3	Waterway accessories		
	Tee joint	1pcs	
	Inlet hose with water supply connectors	1pcs	

NO.	Name	Quantity	Sketch
4	User's manual	1pcs	
5	Installation template	1pcs	
6	Remote Control base	1pcs	
	Fixing plate	1pcs	
	Expander body	2pcs	
	Screw	2pcs	

ELECTRIC BIDET SEAT INSTALLATION

Size requirements of adapter cover

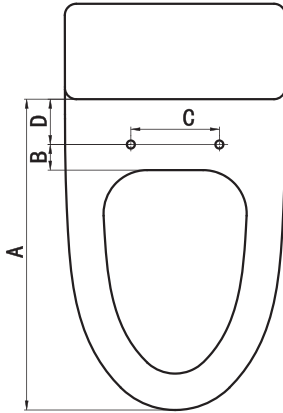

- A.Distance from water tank to the front of toilet: 20-21" (505-535mm).
- B.Distance from mounting holes to the back edge of toilet bowl: <2.75" (70mm).
- C.Spacing between two mounting holes: 4.64-7.16" (118-182mm).
- D.Distance from mounting hole to water tank: >1.18" (30mm).

Preparation before installation

Before installing the Electric Bidet Seat:

1. Remove the existing toilet seat and turn off the water supply system of the toilet.
2. Press the flush button to release the pressure from the water supply pipe.
3. Place a container under the inlet valve to catch the excess water.
4. Close the water inlet angle valve and disconnect the connection between the water inlet valve of the toilet and the water supply pipe.

CAUTION: When determining the outlet position of the circuit, it is necessary to follow the local standards.

Install circuit outlet:

1. Before installation, please install a power socket within one yard on the right side of the toilet.
2. It is recommended to use a waterproof socket instead of extension cord connection products.



All ceramic toilet body outline drawings in this manual are for demonstration only.

Install the fixing plate

Fixing plate groove

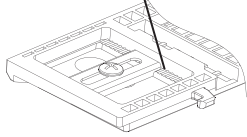

1. Install the expansion bolt into the mounting holes of the ceramic toilet body.
2. Place the fixing plate above the mounting holes of the ceramic toilet body.
3. Thread the bolt into the long hole of the adjusting block.
4. Place the adjusting blocks in the grooves on either side of the fixing plate. Use the installation template to position the fixing plate. Lock the adjusting blocks to the fixing plate with the bolts.

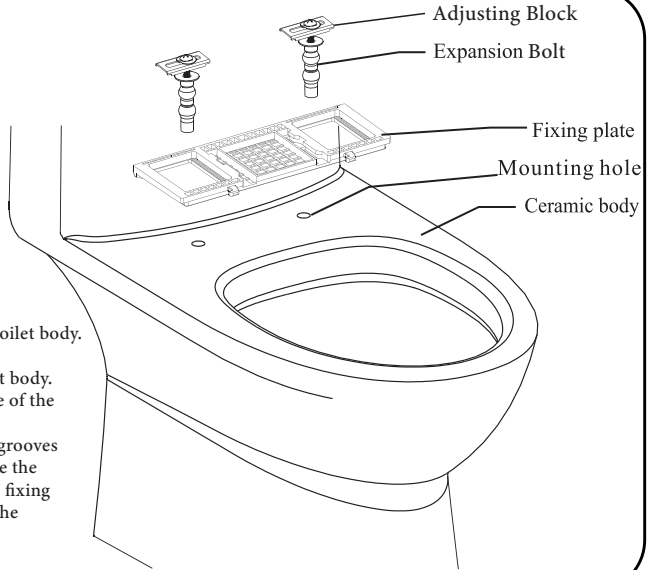

Install the Electric Bidet Seat

Align the bottom of the Electric Bidet Seat with the direction of the fixing plate, and push the seat in the direction of the arrow.

When you hear the "click" sound, it indicates that the seat is installed in place.

Fixing plate

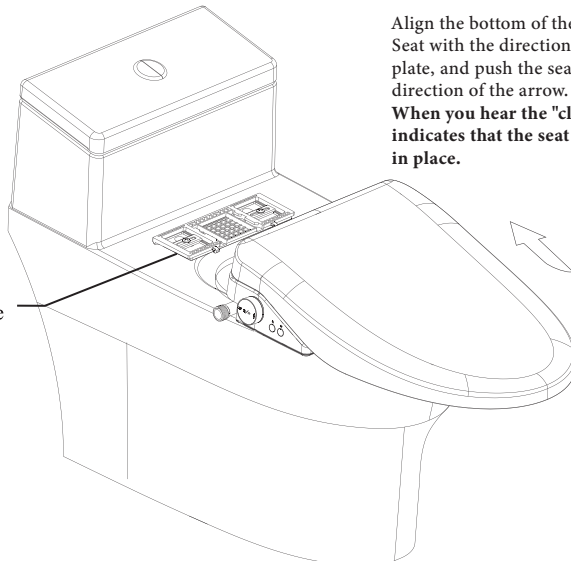

Installation tip:

Tighten the fixing plate to 70% at first, install the bidet seat, adjust the position, then press and hold the push rod to remove the bidet seat, finish tightening the bolts of the fixing plate and finally install the Bidet Seat.

Power and water supply

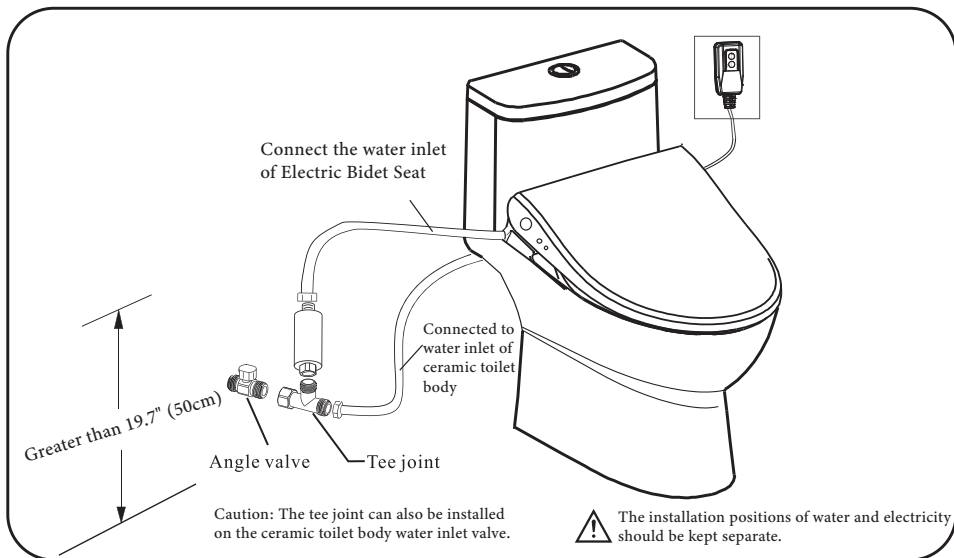

Connect the water supply

Connect the external water source to the water inlet with the equipped hose and filter screen.

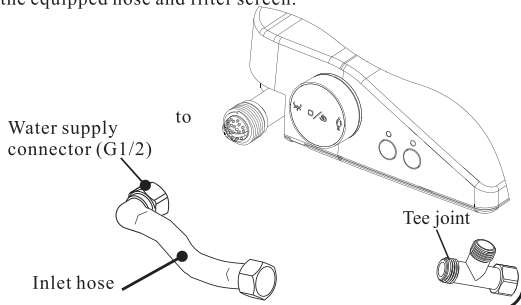

CAUTION

The plug must be connected to an effectively grounded socket. Otherwise, electric shock may result in the case of power failure or leakage.



Turn on electricity

1. Install 120V (more than 10A) socket at a position above 19.7" (50cm) from the ground.
2. The socket should be installed in a location where it will not be splashed with water.
3. Use a grounded socket.
4. Insert the power plug of the product into the socket.

WARNING!

Please connect the power supply according to the product power supply requirements, otherwise it may cause product fault.



Remote control installation

Installation method

1. Remove the EVA adhesive sticker on the back of the remote control base.
2. Install the remote control base to the verified position.
3. After the base is installed, put the remote control on the base.

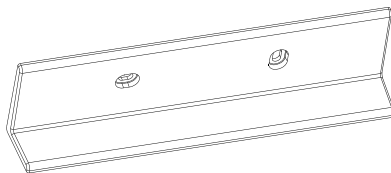
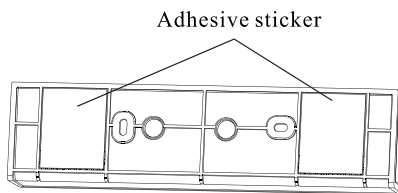

Alternative installation method

1. Use a pencil to mark location for two holes on wall, then, drill two expansion pipe holes with diameter of 6mm on the wall and insert the anchors.
2. Install the remote control base and fix it with screws.
3. After the base is installed, put the remote control on the base.

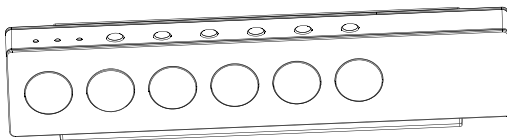
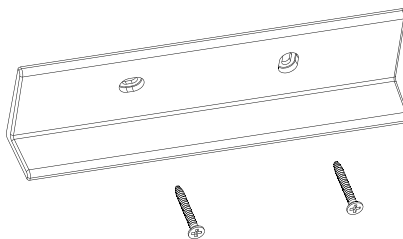
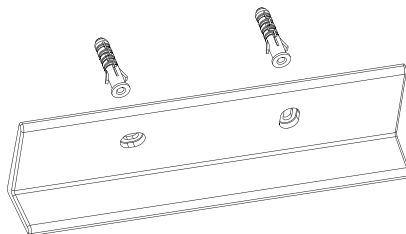

GUIDELINES FOR FIRST USE

Open valve

Open the inlet valve to restore water flow to the toilet.

1. Check power supply.

Confirm that the power plug is plugged in tightly and the indicator light on the plug is on, indicating that the system has been powered on. If the indicator light is not on, you can press the "reset" button on the plug to power on. After power on, you can hear the "tick" sound of the system buzzer.



2. Human-body seating sensor

In the area shown in the figure, there is a seat sensor embedded in the product. The system functions can be enabled only when the system senses that someone is seated.

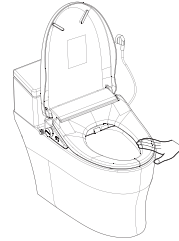

3. Check basic functions

When the human body seating sensing is on, Turn the knob to "♀" or "♂" to start the function.

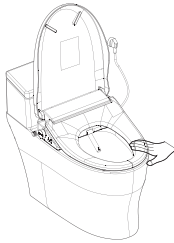

4. Check the drying function

When the human body seating sensing is on, press the "☰" button on remote control to start the function.

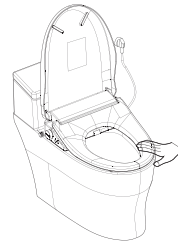

This device complies with Part 15 of the FCC rules. Operation is subject to the following two conditions:

- 1) this device may not cause harmful interference, and
- 2) this device must accept any interference received, including interference that may cause undesired operation.

Changes or modifications not expressly approved by the party responsible for compliance could void your authority to operate the equipment.

The device has been evaluated to meet general RF exposure requirement.

OPERATION INSTRUCTIONS FOR SIDE KNOB

Control Knob

When user is sitting on the seat:
Turn backward to start Rear Wash.
Turn forward to start Female Wash.
Press for two seconds to start Power Wash.

During washing:
Turn knob forward to increase washing pressure and turn backward to reduce pressure.
Press knob to stop and return to standby state.

In standby state:
Press knob to start or stop Air Drying.

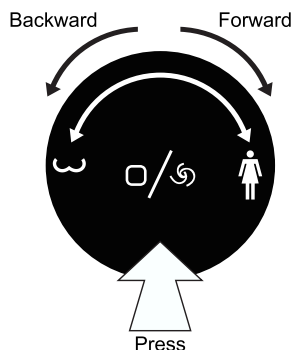

Water Temperature Button

Press the button to adjust the water temperature, the indicator will show the water temp in 4 levels. (dim, green, yellow, red)

During washing:
Press for three seconds to turn ON / OFF moving wash function.

Seat Temperature Button

Press the button to adjust the seat temperature, the indicator will show the seat temp in 4 levels. (dim, green, yellow, red)

Auto Temperature:

Press for three seconds to turn ON (1 Beep) / OFF (2 Beeps) Auto Temperature function. If this function is ON, the seat temperature will auto adjust according to indoor temperature, and cannot be adjusted manually.



Water
Temp



Seat
Temp

REMOTE CONTROL INSTRUCTIONS

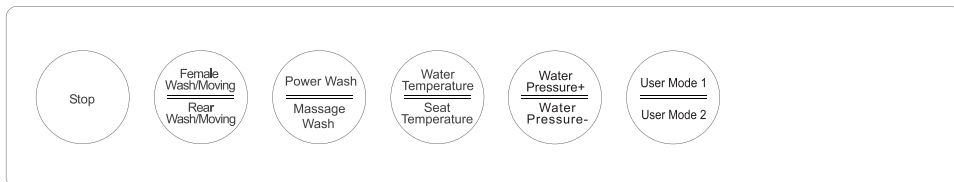

This remote is suitable for TL-AZEB107VWH/UWH

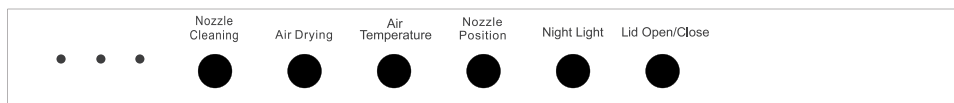

This remote is suitable for TL-AZEB106VWH/UWH

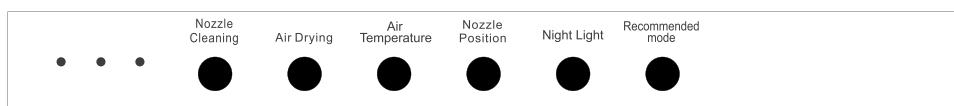

How to use

Stop	Press the stop button to deactivate “rear wash”, “female wash”, “air drying” and “pulse wash” functions.
Rear Wash	Press the Rear Wash button when user is sitting on the seat and bidet will start rear wash for 90 seconds, If the person leaves the seat while the function is running, the function will be stopped.
Female Wash	Press the Female Wash button when user is sitting on the seat and bidet will start female wash for 90 seconds, If the person leaves the seat while the function is running, the function will be stopped.
Power Wash	Press the Power Wash button when user is sitting on the seat and bidet will start power wash for 90 seconds, If the person leaves the seat while the function is running, the function will be stopped.
Water temperature	Press the water temperature button to adjust the water temperature in the "rear wash" and "female wash" modes.
Seat temperature	Press the Seat Temperature button to change the temperature of the seat.
Water Pressure	Press the Water Pressure +/- button to change the water pressure in "rear wash" and "female wash" modes.

How to use

Lid open/close	Press the lid open/close button to open the toilet lid, and then press the button again to close it. Press for 3 seconds to start or stop the auto lid open/close function. (Auto lid open/close feature only applicable to TL-AZEB107VWH/UWH models.)
Recommended mode	Press the recommended mode to use the preset setting.
User mode	Press the user button for 2 seconds to set in memory the current water temperature, air temperature, seat temperature, nozzle position and water pressure. Press the user button to use the memory setting.
ECO	Press the ECO button to start power-saving function (the buzzer rings once); press the button again to stop the power-saving function (the buzzer rings twice for a short time). The seat temp will be 82°F in the ECO mode.
Nozzle cleaning	Press the nozzle cleaning button, and the nozzle will come out. Then the cleaning jet will spray water to clean the nozzle for 10 seconds. Press stop button to stop it when it is running.
Massage Wash	When the "rear wash" or "female wash" function is started, press the massage button to start or stop the massage function. The water temperature changes alternately from 90-100°F.
Air Drying	Press the Air Drying button when user is sitting on the seat and bidet will start air drying for 3 minutes. If the person leaves the seat while the function is running, the function will be stopped.
Air Temperature	Press the Air Temperature button to change the air temperature in "air drying" modes.
Night Light	Turn on or turn off the night light of the control knob.
Nozzle Position	Press the Nozzle Position button to move the nozzle position in the "rear wash" and "female wash" modes.
Code Matching	Unplug the electrical cord, press and hold the "Female Wash" button for 3 seconds. At this time the three LED indicators on the remote will flash red, then plug the electrical cord again.

CLEANING & MAINTENANCE

Product Cleaning

1. Turn off power

Unplug the power plug before cleaning the product.

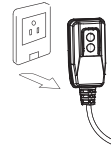

2. Nozzle Cleaning

Press the "Nozzle Cleaning" button on the remote control, and the nozzle will automatically come out. Use a soft cloth or soft bristled toothbrush to clean the nozzle. You can also remove the nozzle for cleaning (pull the spray nozzle out straight and do not shake it).

After cleaning, reinstall the spray nozzle and press the "stop" button, the nozzle will return automatically.

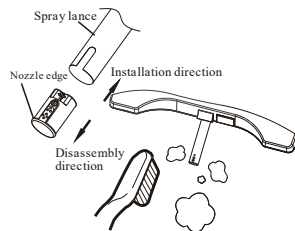

3. Clean the external parts of the product

Clean the product with a soft cloth and neutral detergent. Do not use hydrogen chloride cleaner, thinner, benzene, sandpaper, polishing machines, or other cleaning products.

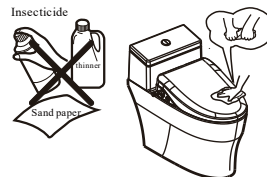

4. Clean the filter screen

When users feel that the water flow is less than normal during use, they can clean both ends of the filter screen with a brush. The product must be completely separated from the water supply hose during cleaning.

If the product is connected to an external filter, please replace it regularly according to the water quality.

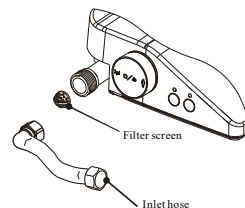

If not in use for an extended period of time

1. Pull the plug out.

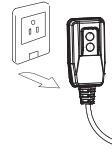

2. Close the valve to turn off the water supply to the system.
Remove the water inlet hose from the water inlet valve
and drain the water in the hose.

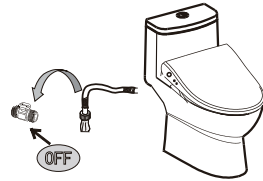

3. Press and hold the push rod in the direction of arrow 1,
and then horizontally remove the Bidet Seat in the opposite
direction of the water tank (arrow 2).

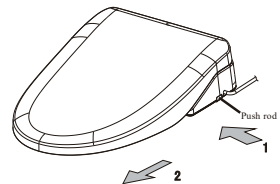

CAUTION

When using the product after a period of disuse, test to confirm proper operation before use. (refer to the Product Installation section).



FUNCTION LIST

Models		TL-AZEB106VWH	TL-AZEB107VWH
		TL-AZEB106UWH	TL-AZEB107UWH
Functions			
Basic Functions	Seat heating	○	○
	Water heating	○	○
	Rear/Female Wash	○	○
	Warm air drying	○	○
Additional Functions	Deodorization		○
	Auto lid open/close		○
	Lid slow close	○	○
	Remote control	○	○
	Moving wash	○	○
	Massage	○	○
	Anitbacterial seat	○	○
	Seasonal Temp auto-adjust	○	○

Note: “○” indicates feature is included.

PRODUCT PARAMETERS

SPECS	
Dimensions (L x W x H)	19.9" x 14.8" x 4.4" (505 x 375 x 112 mm)
Rated power	1220 Watts
Voltage	120V AC / 60Hz
Waterproof grade	IPX4
Range of inlet water pressure	0.15 Mpa - 0.75 Mpa

TROUBLESHOOTING

CAUTION:

1. Please unplug the electrical cord before maintenance.
2. The electric bidet's features will not work unless a person is sitting on the seat.
3. If the electrical cord is damaged, please contact ANZZI service.
4. In case of water leakage, close the valve to shut off water supply.

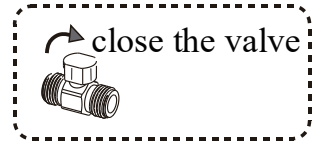

Please follow the following precautions before maintenance:

Symptom	Possible causes	Recommended actions
Power		
Function non-responding	<ul style="list-style-type: none"> ● Is there a power outage? Is there power at the power socket? ● Is the main power turned on? 	<ul style="list-style-type: none"> ● Please wait until power is restored. Please turn on the power socket. ● Please turn on the main power.
Rear wash/Female wash		
No water	<ul style="list-style-type: none"> ● Is water cut off? ● Is water valve closed? ● Did you not touch the sensing area? 	<ul style="list-style-type: none"> ● Please wait for water. ● Please open the water valve. ● Please sit on the sensing area.
Water pressure is decreasing	<ul style="list-style-type: none"> ● Is the warm water switched off or is the water temperature setting low? ● Is the filter or external filter clogged? 	<ul style="list-style-type: none"> ● Turn up the water pressure with control knob or remote control. ● Clean the filter; Change the external filter regularly.
Water temperature is low	<ul style="list-style-type: none"> ● Is the warm water switch off or is the water temperature setting low? 	<ul style="list-style-type: none"> ● Adjust the water temperature with control button or remote control.
Stops spraying water after 90 seconds of washing	<ul style="list-style-type: none"> ● Just a setting. Not a fault problem. 	<ul style="list-style-type: none"> ● Use the washing functions again.

Symptom	Possible causes	Recommended actions
Water stops during washing	<ul style="list-style-type: none"> • The person sitting doesn't touch the sensing area of the seat. 	Adjust sitting position to make sure the user is sitting on the sensing area.
Seating sensor		
The washing or deodorizing function active without being seated.	<ul style="list-style-type: none"> • Is the seat splashed with water or does it have a wet towel on it? 	<ul style="list-style-type: none"> • Please wipe the water off with dry towel; • Please remove the wet towel.
Seat heating		
Seat temperature is low	<ul style="list-style-type: none"> • Is the warm seat switch off or is the seat temperature setting is low? • Is it in ECO mode? 	<ul style="list-style-type: none"> • Adjust the seat temperature with control button or remote control; • Please wait for 5 mins after sitting . Or turn off ECO mode.
ECO function		
ECO function is not activated	<ul style="list-style-type: none"> • Is there a power outage or is the power cord unplugged? • Is the battery on the remote control depleted? 	<ul style="list-style-type: none"> • Press the ECO button on the remote control to active the function. • Replace battery.
Remote control		
Remote control not responding	<ul style="list-style-type: none"> • Is the battery on the remote control depleted? • Is the battery installed incorrectly? • Is the user not touching the sensing area of the seat ring? 	<ul style="list-style-type: none"> • Replace battery. • Install the battery correctly. • Adjust sitting position to make sure user is sitting on the sensing area.

Symptom	Possible causes	Recommended actions
---------	-----------------	---------------------

Deodorization

Deodorization is not activated	<ul style="list-style-type: none"> The person sitting isn't touching the sensing area of the seat ring. 	<ul style="list-style-type: none"> Adjust sitting position to make sure the user is sitting on the sensing area.
--------------------------------	------------------------------------------------------------------------------------------------------------------------	---------------------------------------------------------------------------------------------------------------------------------

Warm air drying

Air temperature is low	<ul style="list-style-type: none"> Is the air temperature setting low? 	<ul style="list-style-type: none"> Adjust the air temp. by remote control.
Function stops during drying	<ul style="list-style-type: none"> Normally it stops after 3 mins of drying. 	<ul style="list-style-type: none"> Use this function again. Adjust sitting position to make sure the user is sitting on the sensing area.
Air drying is not activated	<ul style="list-style-type: none"> The person sitting isn't touching the sensing area of the seat ring. 	<ul style="list-style-type: none"> Adjust sitting position to make sure the user is sitting on the sensing area.

Others

Dirt not cleaned	<ul style="list-style-type: none"> Is the water valve fully open? Is the water valve filter blocked? Water pressure too low when sharing water with bathroom. 	<ul style="list-style-type: none"> Open the water valve. Clean the filter.
Water is dirty	<ul style="list-style-type: none"> The external filter has been used over 6 months. 	<ul style="list-style-type: none"> Replace with a new filter.
Water pipe connection leaking	<ul style="list-style-type: none"> Is the nut of the connecting pipe tightened? 	<ul style="list-style-type: none"> Tighten the nut.

If there is other problem other than the above , please contact the seller.

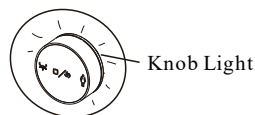

Troubleshooting

Alert	Knob light alert	Buzzer	Fault description
Seat temp. sensor alert	<ul style="list-style-type: none"> Flash red once 	1 beep	<ul style="list-style-type: none"> Sensor open or short circuit will trigger alarm and stop seat heating.
Air temp. sensor alert	<ul style="list-style-type: none"> Flashes red twice 	1 beep	<ul style="list-style-type: none"> Sensor open or short circuit will trigger alarm and stop air drying.
Water temperature sensor alarm	<ul style="list-style-type: none"> Flashes red three times 	1 beep	<ul style="list-style-type: none"> The outlet water temperature is too high.

ENVO 
by ANZZI