

# PVC Molded End Bells

- Suitable for use with Schedule 40 or Schedule 80 conduit
- Also compatible with EB or DB duct

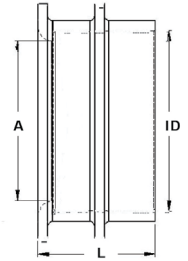

Trade Size	Part Number	Average Dimensions (in)			Package Quantity
		Length (L)	Socket ID	Flared End ID (A)	
½	MEB05	1.00	0.85	0.63	100
¾	MEB07	1.00	1.06	0.88	100
1	MEB10	1.20	1.33	0.95	50
1¼	MEB12	1.24	1.68	1.32	50
1½	MEB15	1.36	1.92	1.64	50
2	MEB20	1.55	2.39	2.12	40
2½	MEB25	1.89	2.89	2.58	30
3	MEB30	1.93	3.52	3.12	50
3½	MEB35	2.11	4.02	3.62	50
4	MEB40	2.18	4.52	4.10	50
5	MEB50	2.39	5.59	5.11	25
6	MEB60	2.57	6.69	6.12	15
8	MEB80	6.00	8.67	8.12	1