

# INSTRUCTION MANUAL

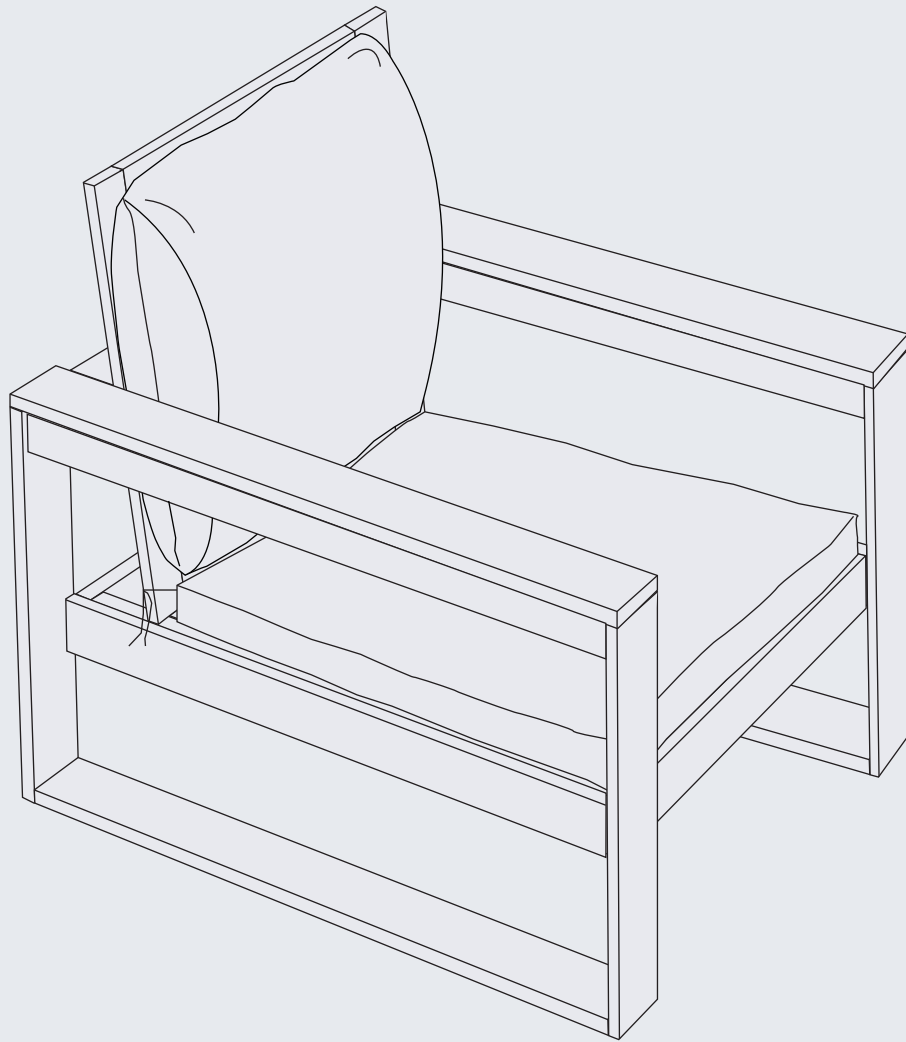

Patio Deep Seating Club Chair With Cushion

**V1.0**

## ! CARE & MAINTENANCE

### Please keep this instruction for your future reference.

- Be careful when assembly, avoid hurting the top surface.
- Clean the chair with lukewarm water, mild detergent & soft cloth.
- Firmly secure all bolts before use, do not use any part of this item as a step ladder.
- Reconfirm that all bolts, screws, and nuts are secure every 90 days.
- Do not use or store this item in the proximity of open flame or flammable/combustible chemicals.
- Be aware that some parts are heavy and have sharp edges.
- Do not overtighten screws. (Insert all screws before tighten screws.)
- Please do not exceed the weight limitations of this item.

## TOOLS REQUIRED



**CHAIR  
300 LBS  
CAPACITY**



**1 PERSON  
ASSEMBLY**



**UP TO 20 MIN.  
ASSEMBLY**

## HARDWARE

**1**

**M6.3 x 40mm  
SCREW**



16 PCS

**2**

**M6.3 x 55 mm  
SCREW**

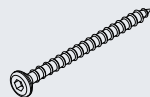

2 PCS

**3**

**ALLEN  
WRENCH**



1 PC

## PARTS

**A**

**CHAIR SEAT**

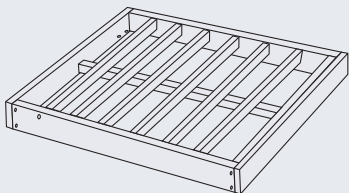

1 PC

**B**

**BACKREST**

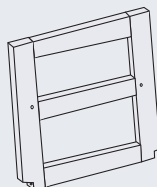

1 PC

**C**

**CHAIR RIGHT ARM**

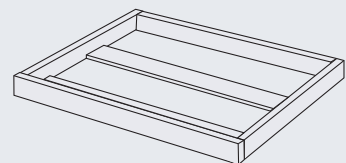

1 PC

**D**

**CHAIR LEFT ARM**

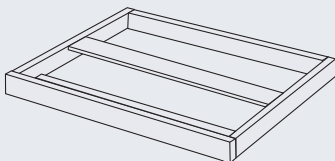

1 PC

**E**

**BACK SUPPORT**



1 PC

## CUSHION

**Z1**

**BACK CUSHION**

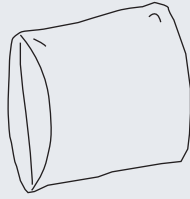

1 PC

**Z2**

**SEAT CUSHION**

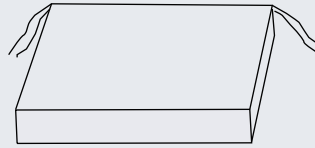

1 PC

## PRODUCT ASSEMBLY - OVERALL VIEW

Look at following overall view of this chair and learn the exact position of each parts to be assembled.

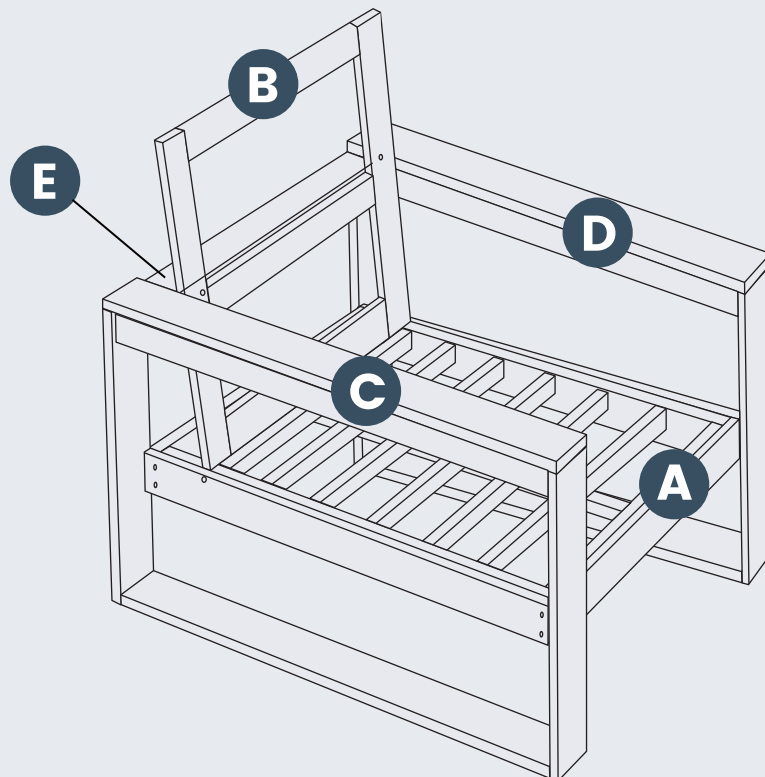

## PRODUCT ASSEMBLY

1

Attach **Part C Chair Right Arm** to **Part A Chair Seat** with 4 pcs of **Hardware #1 Screw**.

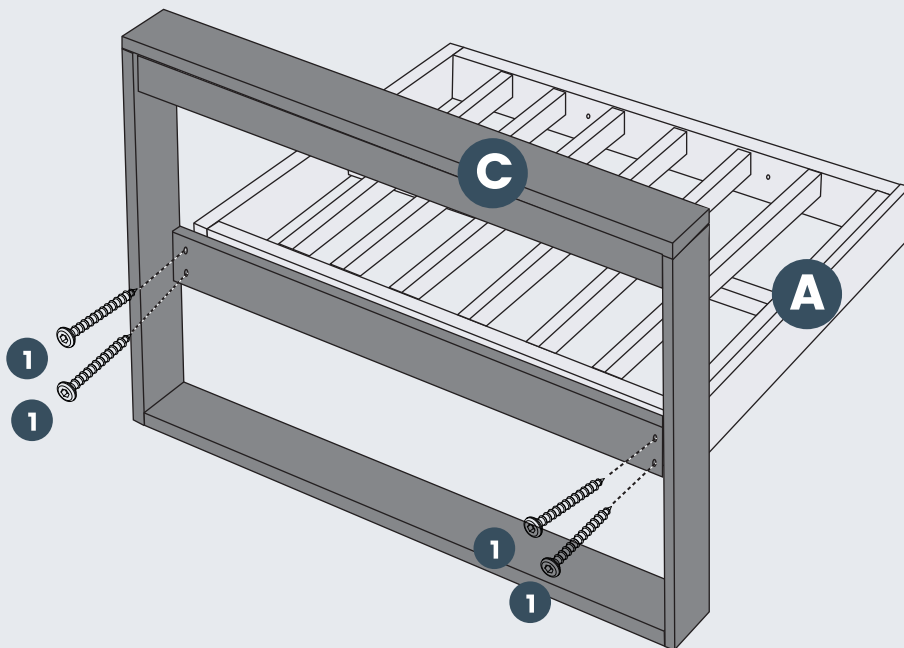

2

Attach **Part D Chair Left Arm** to **Part A Chair Seat** with 4 pcs of **Hardware #1 Screw**.

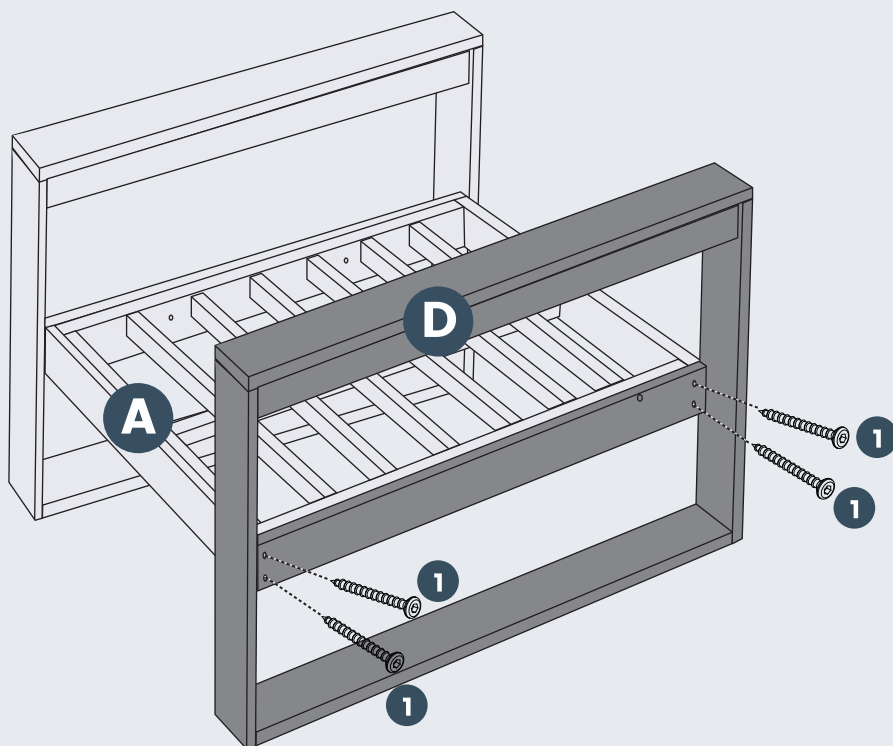

## PRODUCT ASSEMBLY

3

Attach **Part A Chair Seat** to **Part C Chair Right Arm** and **Part D Chair Left Arm** with 4 pcs of **Hardware #1 Screw**.

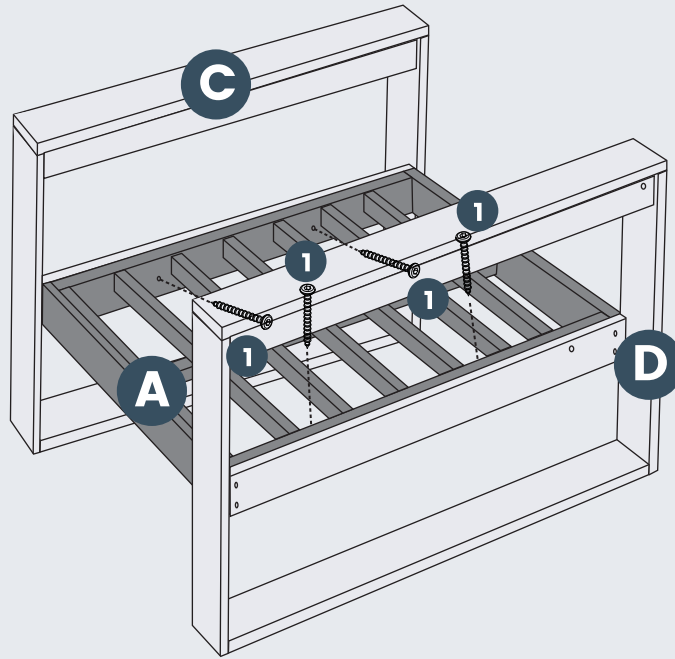

4

Place **Part E Back Support** between **Part C Chair Right Arm** and **Part D Chair Left Arm** as below and attach them with 2 pcs of **Hardware #1 Screw**.

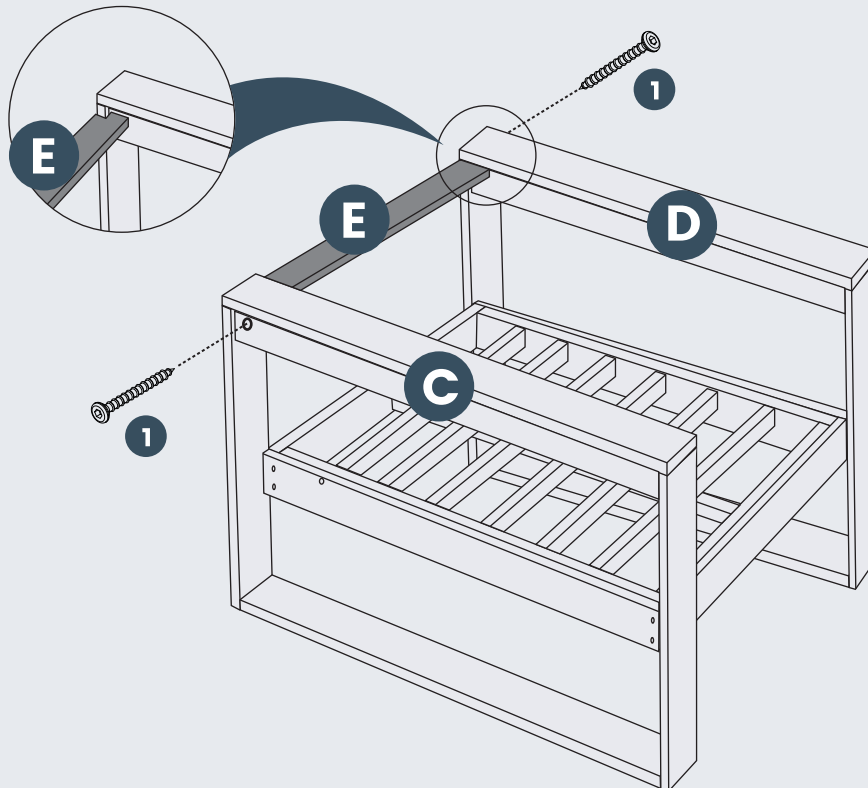

## PRODUCT ASSEMBLY

5

Place **Part B Backrest** onto **Part A Chair Seat** as below, attach **Part B Backrest** to **Part C Right Arm** and **Part D Chair Left Arm** with 2 pcs of **Hardware #2 Screw**.

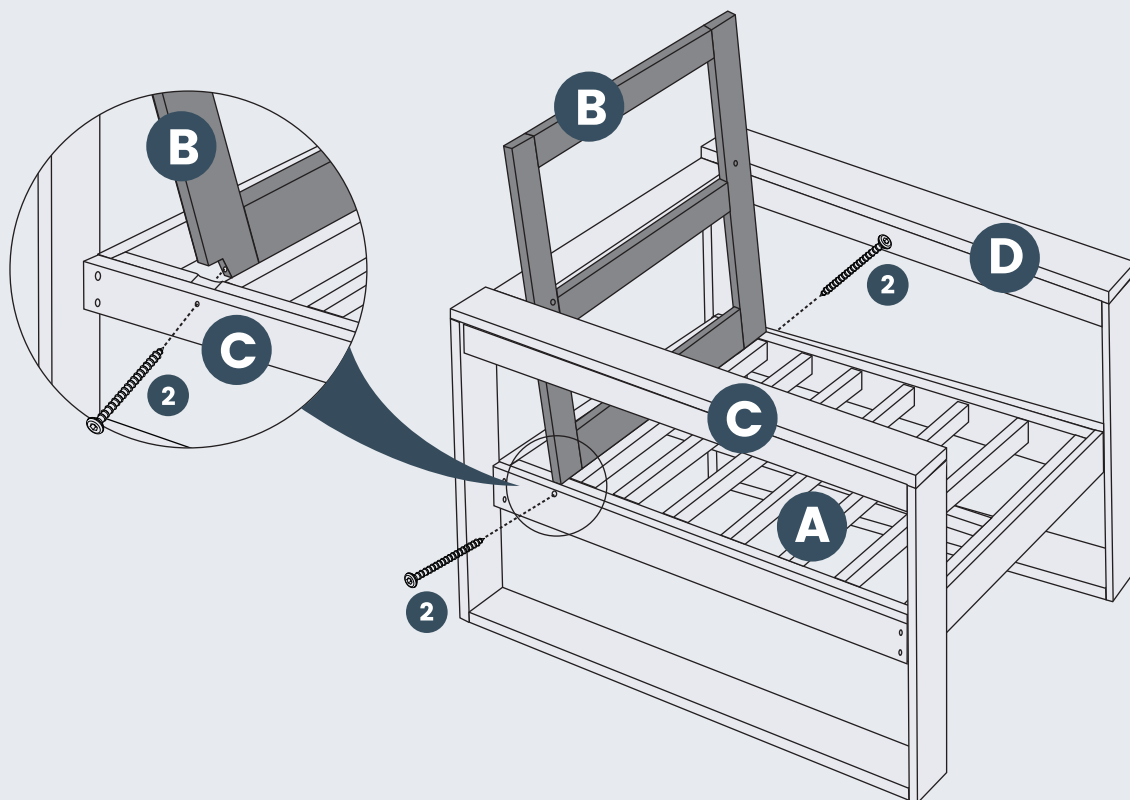

6

Attach **Part B Backrest** to **Part E Back Support** with 2 pcs of **Hardware #1 Screw**.

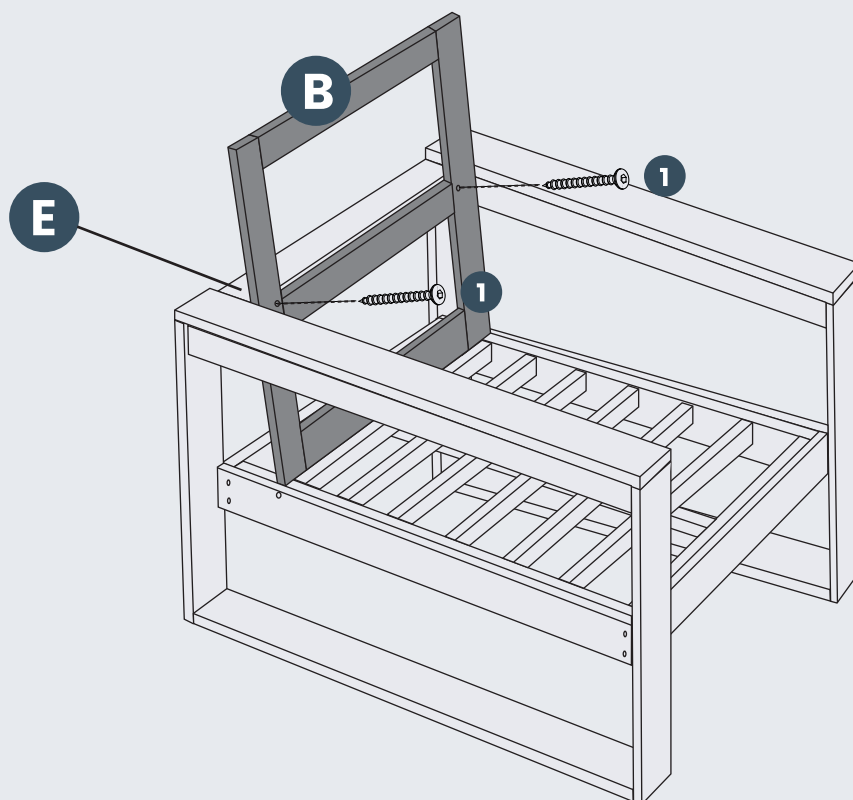

## PRODUCT ASSEMBLY

7

Check and tighten all the screws when the parts are loosely attached.

Place **Cushion Z1** and **Z2** onto the chair for comfortable use.

Tie the **Seat Cushion** to the **Chair Backrest** to make it steady.

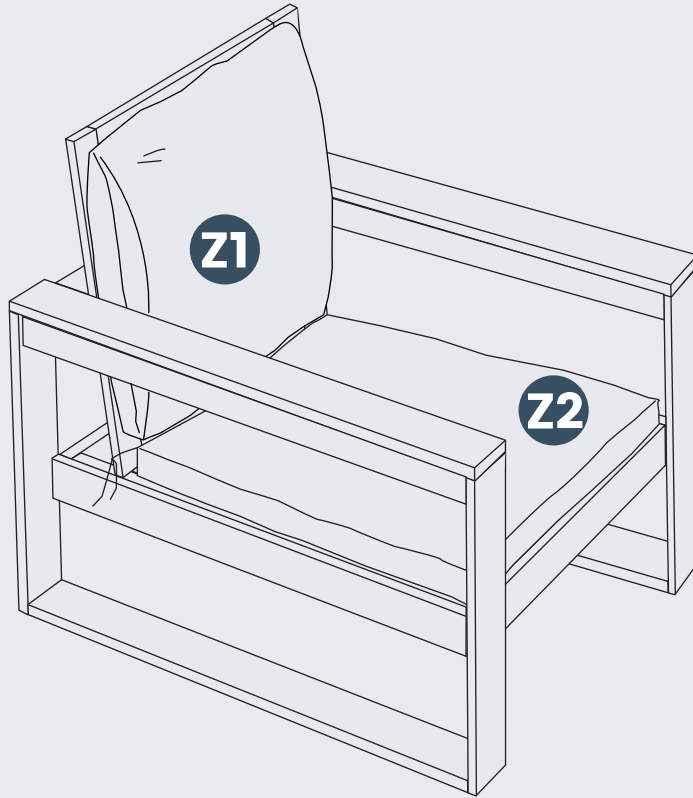

---

## CLEANING TIPS

**REGULAR CLEAN:** Use a mixture of warm water and mild soap. Gently scrub the surface with a soft bristle brush to remove any dirt or stains.

**QUICK CLEAN:** You can simply wipe down the furniture with a damp cloth.

Regular cleaning not only preserves the aesthetic appeal of your furniture, but also helps extend its lifespan.