

INSTRUCTIONS

1. Please count and make sure all pieces are present before assembly.
2. The pole pieces are delicate. To prevent damage, do not use excessive force.
3. Assemble crystal puzzle by putting the puzzle pieces together in the order shown below.
4. Missing a piece? Email info@ugames.com or call (415) 503-1600 with missing piece number.

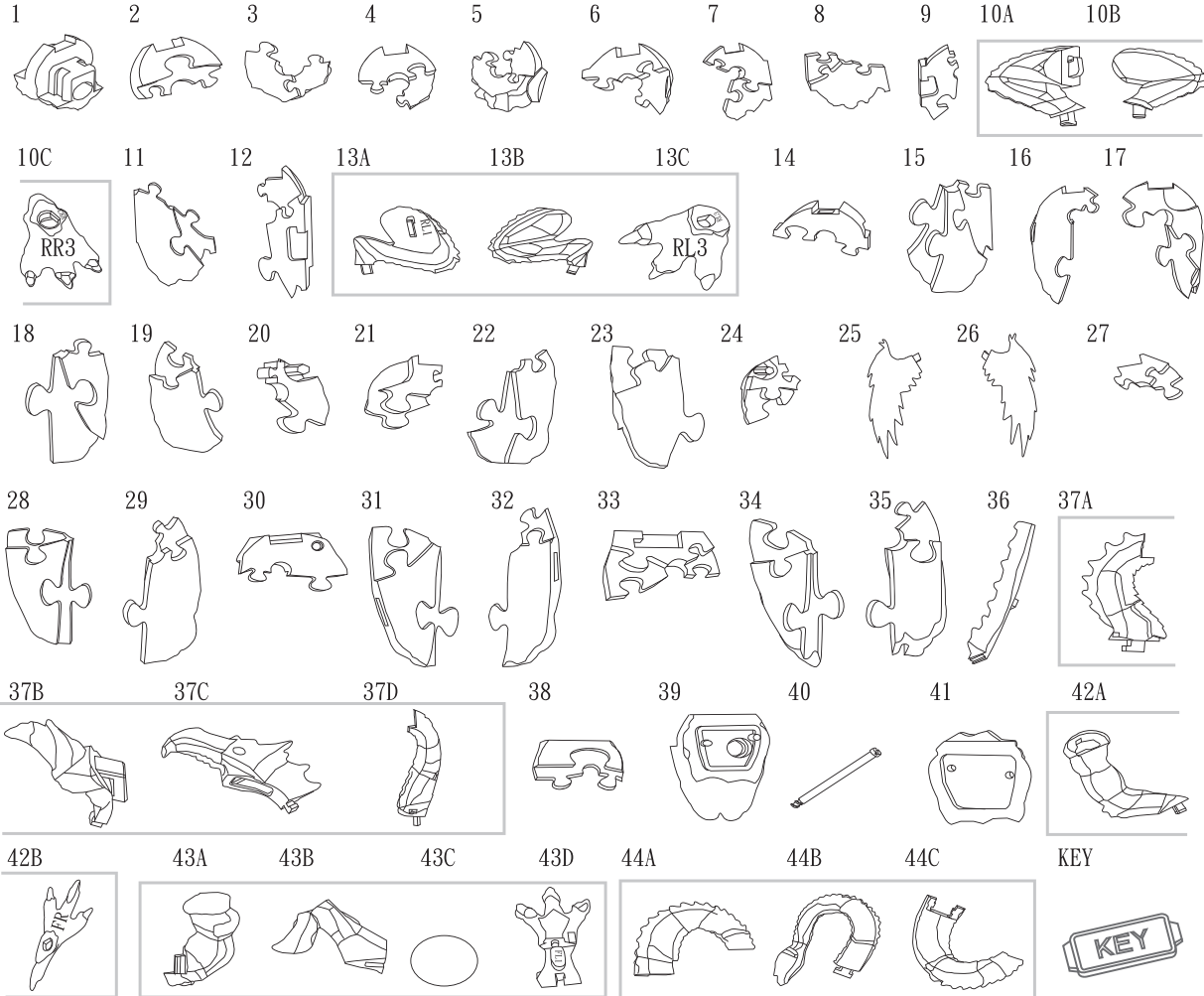

HINTS

1

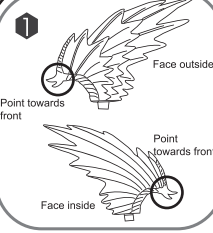

Make sure wings are pointed in the correct direction, as indicated above.

2

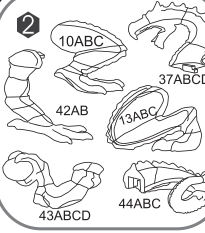

Combine the head, neck, tail and legs before mounting pieces onto the body.

3

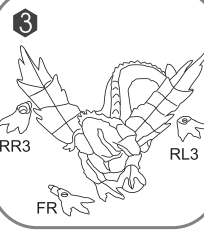

Note the markings on the three legs distinguishing front, rear, left and right.

4

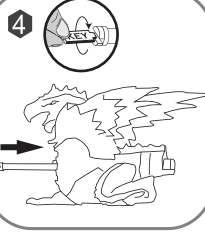

After assembling piece #39, insert center pole #40 through the front and screw it down with the screw enclosed.

