

SHIMANO

TRAX

TRX200A

The (5765) Bearing, (6074) Spool clutch pin, and (4225) Roller clutch cannot be replaced by the customer. To replace these parts, please request after-sales service.

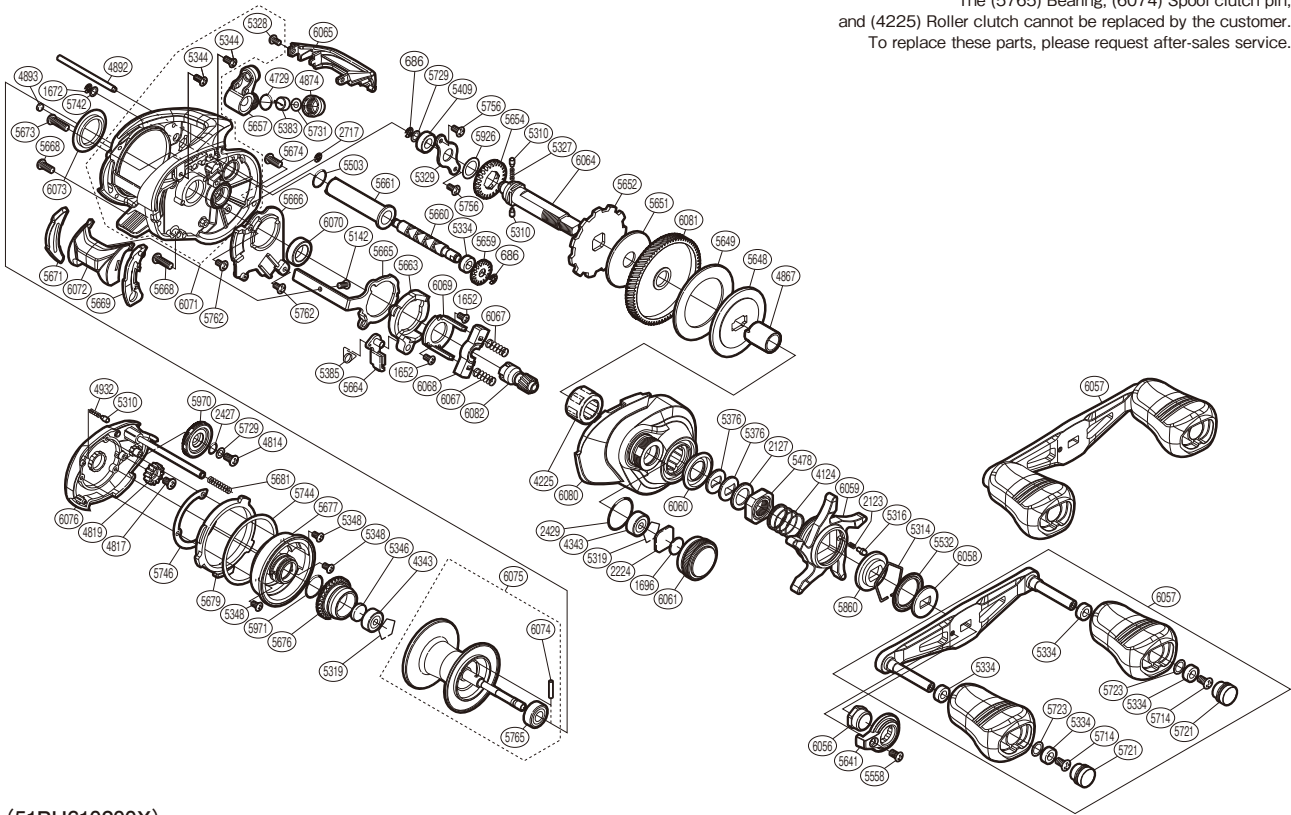

(51RH610200X)

#	Part No.	Description	#	Part No.	Description	#	Part No.	Description
686	10FJB	E Lock	5383	10MPD	Line Guide Pawl	5742	10LHY	Washer
1652	101M5	Screw	5385	10DRK	Clutch Pawl Spring	5744	10KNH	Washer
1672	10P68	E Lock	5409	10SAU	Drive Shaft Bushing	5746	108WS	Washer
1696	105C3	Cast Control Spacer B	5478	10DRE	Star Drag Nut	5756	1003V	Screw
2123	1024H	Click Spring	5503	10SAS	O Ring	5762	10SXB	Screw
2127	10T9X	Star Drag Spacer	5532	10MFC	Star Drag Seal	5765	101DR	Ball Bearing
2224	108WK	Spool Tension Spacer A	5558	1022Z	Screw	5860	10SRY	Star Drag Click Plate
2427	10CLF	O Ring	5641	10LFA	Handle Nut Plate	5926	1023S	Washer
2429	10CCN	O Ring	5648	10SSJ	Key Washer	5970	1011D	Brake Dial
2717	10SAP	E Lock	5649	10DRD	Drag Washer	5971	1004Z	O Ring
4124	109F5	Star Drag Spring	5651	1023U	Drag Washer	6056	10PXZ	Handle Nut
4225	10SSF	Roller Clutch Bearing	5652	101K8	Anti-Reverse Ratchet	6057	10KXW	Handle Assembly
4343	10F3C	Ball Bearing	5654	10DQF	Idle Gear	6058	10J26	Drive Shaft Shield
4729	10SRL	O Ring	5657	10ST0	Line Guide Assembly	6059	10J1N	Star Drag
4814	103L7	Screw	5659	101GT	Idle Gear	6060	1085F	Roller Clutch Water Proof
4817	10GQZ	Screw	5660	105NB	Worm Shaft	6061	1054D	Cast Control Cap
4819	1023U	Idle Gear	5661	10SAT	Level Wind Guard	6064	10S3Y	Drive Shaft
4867	10DRH	Roller Clutch Inner Tube	5663	10SSV	Clutch Cam	6065	1003S	Level Wind Protector
4874	108WQ	Pawl Cap	5664	10559	Clutch Pawl Assembly	6067	10DRF	Yoke Spring
4892	108PY	Stabilizer Bar	5665	10SST	Clutch Plate	6068	10SG1	Yoke
4893	105CA	Anti-Thrust Washer	5666	10SXA	Clutch Guard	6069	104CP	Clutch Cam Retainer
4932	10HJG	Click Spring	5668	10SRK	Screw	6070	10RE7	Pinion Gear Bushing
5142	10S57	Screw	5669	10SAR	Clutch Bar Guide B	6071	10SG5	Frame Assembly
5310	10HJG	Idle Gear Pin	5671	10S42	Clutch Bar Guide A	6072	10QSE	Clutch Button Assembly
5314	10BT2	Click Plate Retainer	5673	100ZK	Screw	6073	105NC	Frame Center Seal
5316	10A70	Click Pin	5674	100ZE	Screw	6074	10EX5	Spool Clutch Pin
5319	10SJA	Bearing Retainer	5676	10DSB	Brake Ring Gear Assembly	6075	100GW	Spool Assembly
5327	109T1	Idle Gear Spring	5677	10040	Brake Case Assembly	6076	1023S	Left Side Plate Assembly
5328	10BHQ	Screw	5679	103LE	Left Side Plate Cam Lever	6080	10SSR	Right Side Plate
5329	105NK	Drive Shaft Retainer	5681	10SAZ	Spring	6081	10JDY	Drive Gear
5334	10SAW	Bushing	5714	10E8U	Screw	6082	10LVE	Pinion Gear
5344	10SSP	Screw	5721	1003Z	Handle Knob Seal			
5346	10L1Q	Spacer B	5723	10QVP	Washer			
5348	10SG6	Screw	5729	10LCQ	Spacer			
5376	10896	Drag Spring Washer	5731	101E0	Spacer			

Please note that the number of adjusting washers may not be the same as shown in the exploded views. (Adjustment will vary with each individual product.)