

INSTRUCTION MANUAL



Adirondack Casual Patio Dining Chair

V2.0

! NOTICE

Do not overtighten screws. (Insert all screws before tighten screws.)

- Please do not exceed the weight limitations of this item.
- Do not stand on or use any part of this item as a step ladder.
- Firmly secure all bolts, screws and nuts before use.
- Reconfirm that all bolts, screws, and nuts are secure every 90 days.
- Do not use or store this item in the proximity of open flame or flammable/combustible chemicals.
- Be aware that some parts are heavy and have sharp edges.
- Please adjust the speed slowly when you use electric drill for assembling to avoid screw slippage.

TOOLS REQUIRED

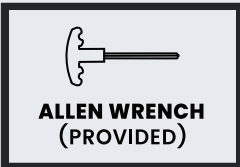

HARDWARE

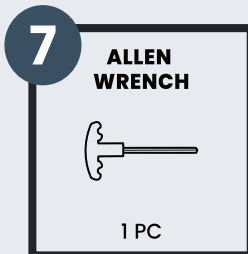
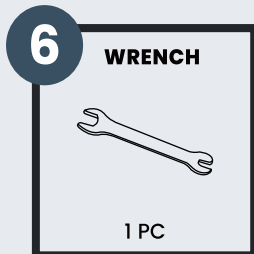
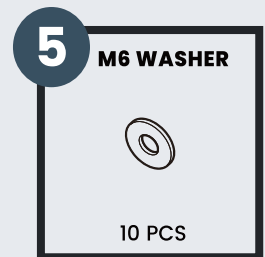
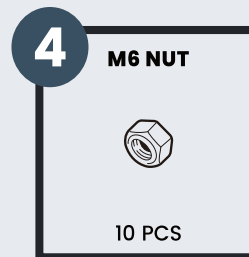
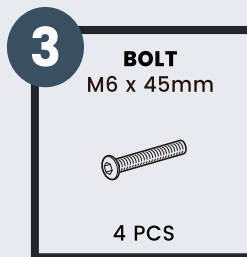
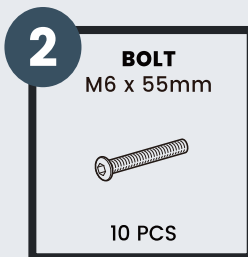
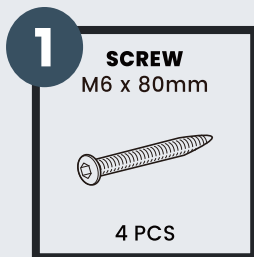

PARTS

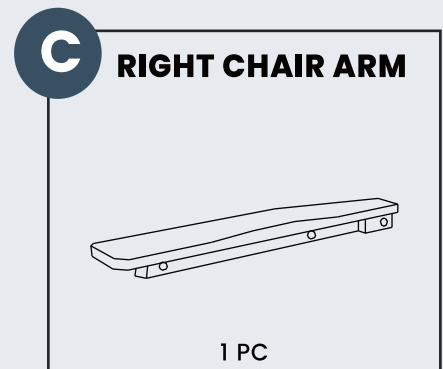
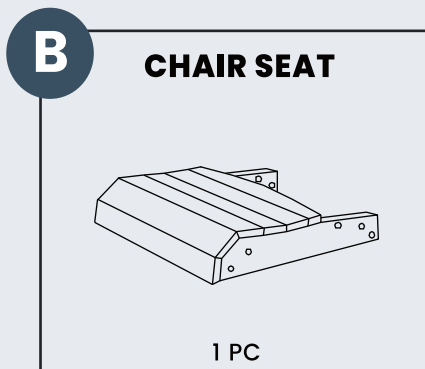
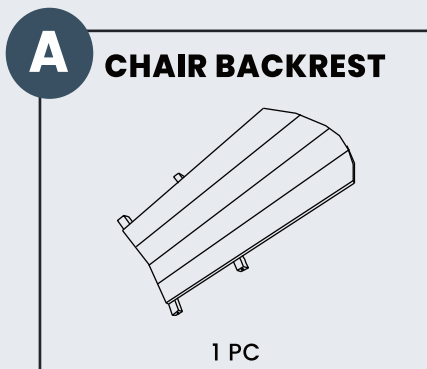

PARTS

D**LEFT CHAIR ARM**

1 PC

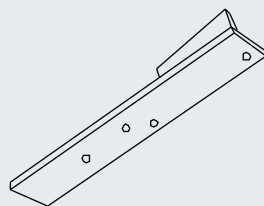
E**RIGHT CHAIR LEG**

1 PC

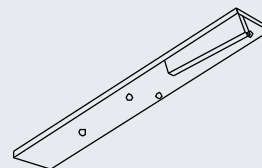
F**LEFT CHAIR LEG**

1 PC

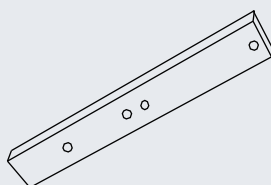
G**RIGHT REAR LEG**

1 PC

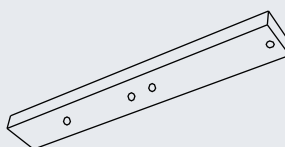
H**LEFT REAR LEG**

1 PC

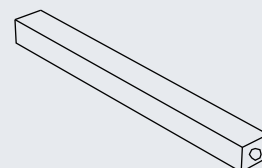
I**RAIL**

2 PCS

PRODUCT ASSEMBLY – OVERALL VIEW

1

Look at the overall view of this chair and learn the exact position of each part to be assembled.

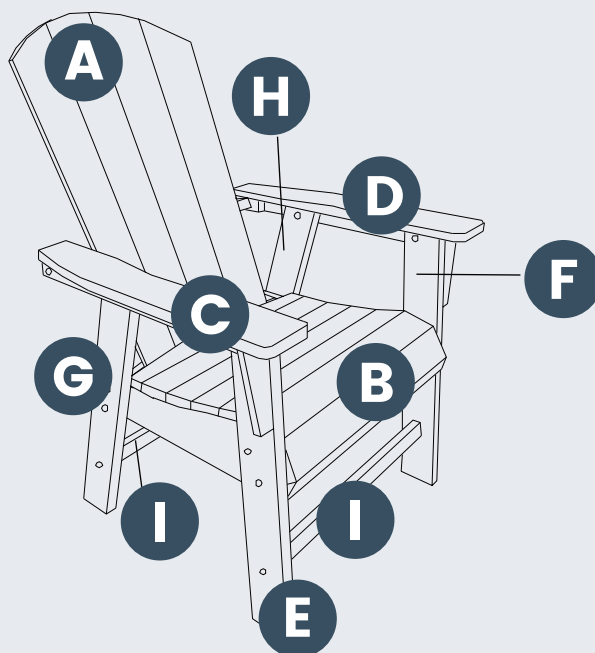

PRODUCT ASSEMBLY

1

Place **Part A Chair Backrest** and **Part B Chair Seat** as below, attach **Part H Left Rear Leg** to **Part B Chair Seat** and **Part A Chair Backrest** with 1 pc of **Hardware #1 Screw**.

Do not tighten screws too much at this stage.

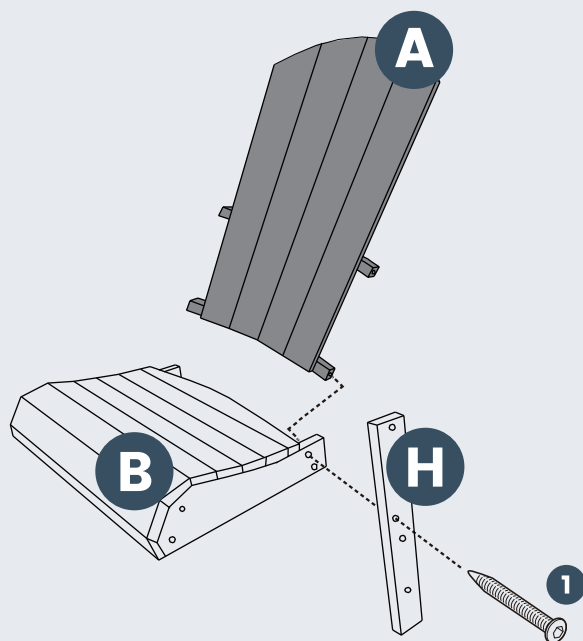

2

Attach **Part H Left Rear Leg** to **Part B Chair Seat** with 1 set of **Hardware #2 Bolt**, **Hardware #5 Washer** and **Hardware #4 Nut**.

Attach **Part I Back Rail** to **Part H Left Rear Leg** with 1 pc of **Hardware #3 Bolt**.

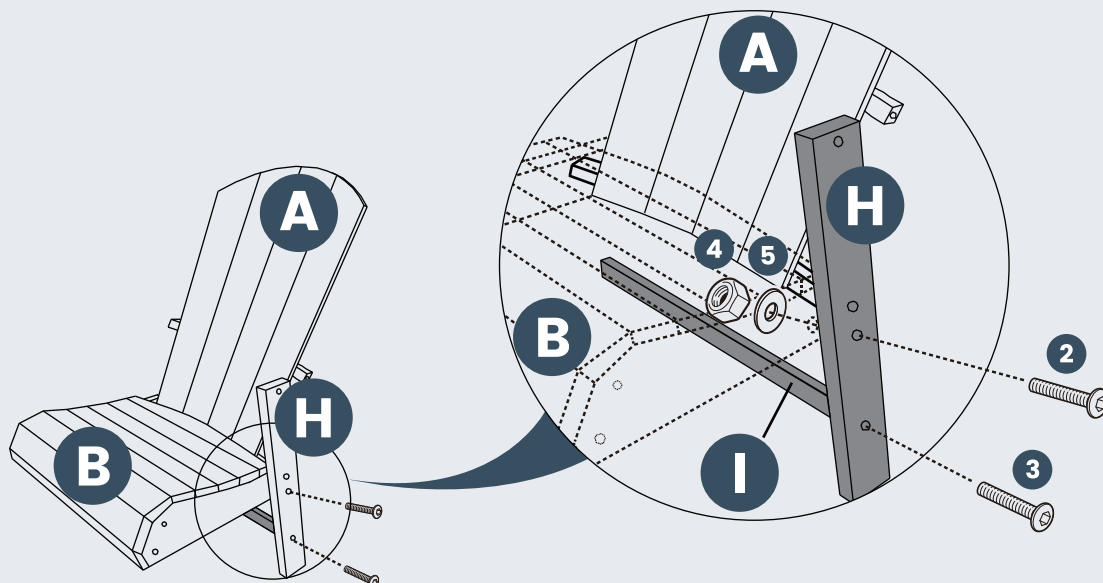

PRODUCT ASSEMBLY

3

Attach **Part F Left Chair Leg** to **Part B Chair Seat** with 2 sets of **Hardware #2 Bolt**, **Hardware #5 Washer** and **Hardware #4 Nut**.

Attach **Part I Front Rail** to **Part F Left Chair Leg** with 1 pc of **Hardware #3 Bolt**.

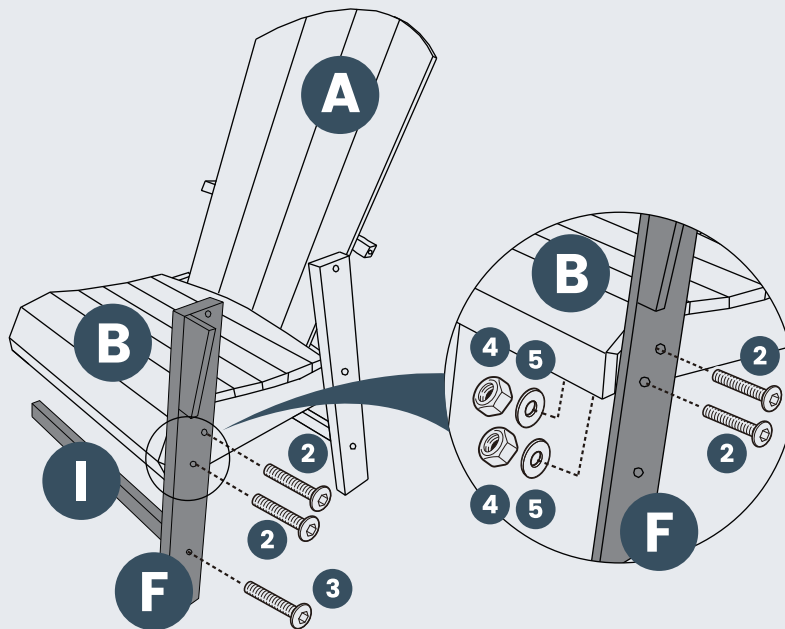

4

Do the same to attach **Part E Right Chair Leg** and **Part G Right Rear Leg** to **Part A Chair Backrest** and **Part B Chair Seat** with 3 sets of **Hardware #2 Bolt**, **Hardware #5 Washer** and **Hardware #4 Nut** as well as 1 pc of **Hardware #1 Screw**.

Attach **Part E Right Chair Leg** and **Part G Right Rear Leg** to **Part I Rails** with 2 pcs of **Hardware #3 Bolt**.

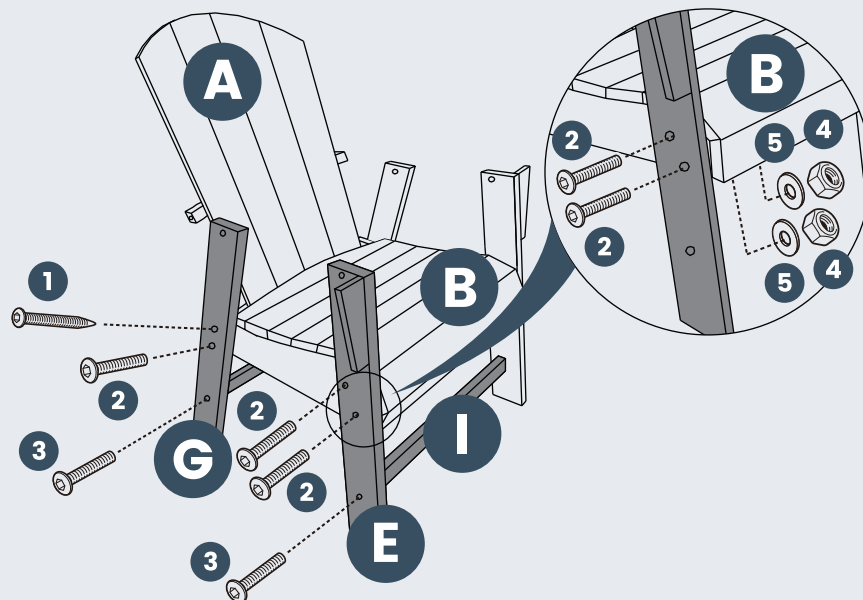

PRODUCT ASSEMBLY

5

Attach **Part D Left Chair Arm** to **Part A Chair Backrest** with 1 pc of **Hardware #1 Screw**.

Attach **Part D Left Chair Arm** to **Part F Left Chair Leg** and **Part H Left Rear Leg** with 2 sets of **Hardware #2 Bolt**, **Hardware #5 Washer** and **Hardware #4 Nut**.

Do the same to attach **Part C Right Chair Arm** to the chair to finish the assembly.

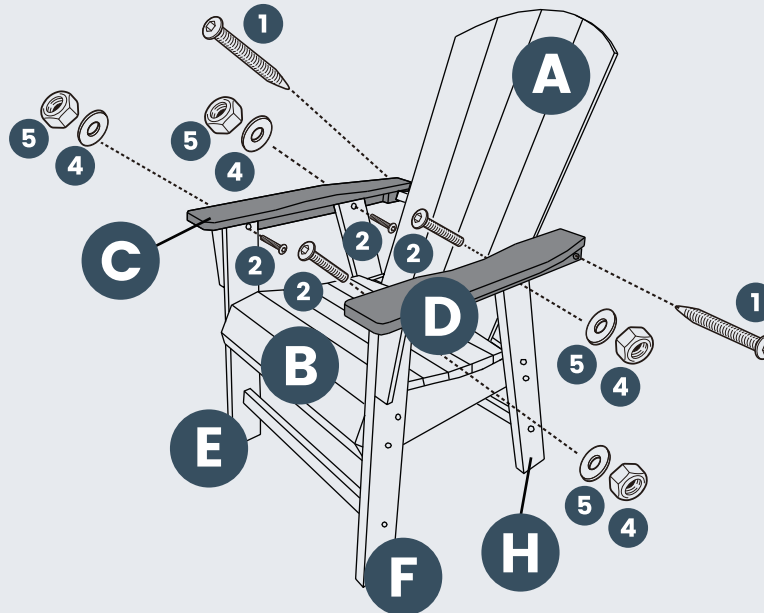

6

Tighten all the bolts and screws again to ensure this chair is steady enough to use.

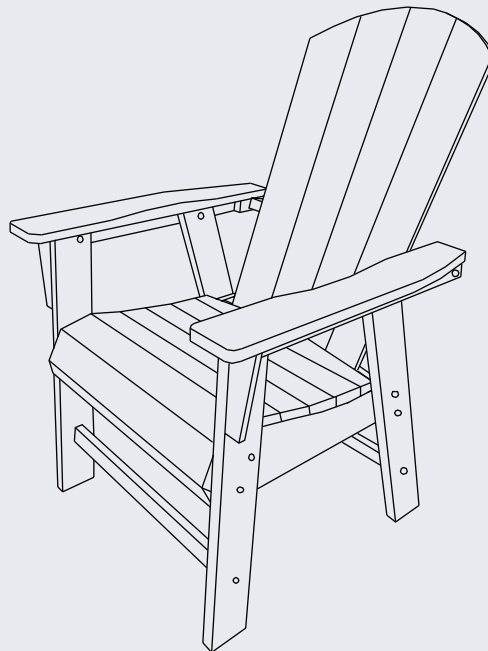

CLEANING TIPS

REGULAR CLEAN: Use a mixture of warm water and mild soap. Gently scrub the surface with a soft bristle brush to remove any dirt or stains.

QUICK CLEAN: You can simply wipe down the furniture with a damp cloth.

Regular cleaning not only preserves the aesthetic appeal of your furniture, but also helps extend its lifespan.