

10 Shake your snow globe and watch it snow on your winter scene. Be sure to hold the base and dome when shaking.

11 If you notice water near the stopper, be sure the stopper is tightened. Extra stoppers are included.
Display - Place your snow globes on the clear plastic trays provided. In case of accidental leakage, do not display your globes on wood or any surface that may be damaged by water. These globes also look great without the water!



As with any handcrafted item, your snow globes may change over time. This is a normal part of the crafting process.

If you need to remove water from the snow globe, do so over a sink with an adult's help.



Make Your Own HOLIDAY SNOW GLOBES

6+

Create 2 Winter Wonderlands!

Note: You will need to divide your supplies so you have enough materials to make both snow globes. For best results, plan out your designs before you begin. Refer to the box for ideas and inspiration.

Place the base on your work station with the shallow side facing up. This is the side you will decorate. **Do not decorate the side with the removable stopper or the domes will not fit properly.**

Mixing Clay to Create New Colors:

Red + Yellow = Orange

Red + Yellow + Blue = Brown

Blue + White = Light Blue

Note: You may need to wash your hands when switching colors of clay.

1 Cover the base of your snow globe with a thin layer of clay. Push the clay evenly to the edge of the base. This will help seal the globe so water won't leak out.



Be sure to save some clay for your second globe.

MYO Holiday Snow Globes
#6365000
© Faber-Castell USA, Inc.
Cleveland, Ohio 44131
www.fabercastell.com
Designed in USA • Made in China
Non-toxic Safe for children
Conforms to ASTM D-4236

Need Help?
Call Toll Free: 800-311-8684
E-mail: consumer@fabercastell.com
Chat or view FAQs & INFO online:

www.CreativityforKids.com



2 Flip the base over and remove the stopper. Using a clay tool, clear the clay out of the hole and replace the stopper. Do not place clay over the hole when decorating. This is where the water will be added later.

3 Decorate your scene by making clay trees, a snowman, presents, candy canes - anything you can imagine.

Use your tools to make hash marks on the bottom of the clay pieces to hold them together. You can use your tools to help smear and smudge them firmly into the base clay.



Ideas to try:

Presents

A rectangle of clay can become a present. Roll a thin rope of clay to create a ribbon.

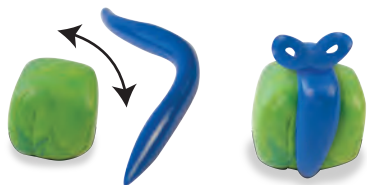

Penguin

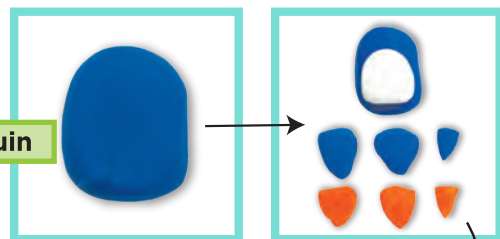

Turn a gumdrop shape into a penguin. Add a white belly, 3 orange triangles for the beak and feet, and 3 blue triangles for the tail and flippers. Add a face with your tools.

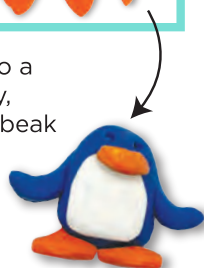

Tree

Form a green cone to create a tree. Add balls of colored clay to create ornaments and a base.



North Pole

Roll a rope of red and white clay together to make a pole. Pinch some clay into the shape of a sign. Use your tools to add an "N" and "P" for "North Pole". Attach your sign to the pole.

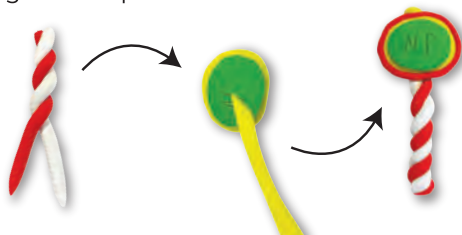

4 To add the Santa or Snowman figures, press some extra clay on the base and press the figure firmly into the clay. You can use a little glue to permanently secure your figures.

5 Once all is in place, turn the base over and give it a firm shake to make sure everything is secure. Once all is in place, turn the base over and give it a firm shake to make sure everything is secure.

6 Sprinkle a little glitter over your scene. Save enough for both globes. Try to keep the glitter away from the edges of the base for the most secure seal.

7 Press the top of the globe onto the base. It should fit very snugly. You may need to ask an adult or older friend to help with this step.



8 Wipe away any clay from where the globe meets the base and add a line of glue around the seam. Place snow globes on the clear plastic trays provided and let dry for 1-2 hours.



9 Remove the stopper from the bottom of the base and place the funnel in the hole. Use a small stream of cool water to fill the base. Once it is filled replace the stopper. *For a crystal clear snow globe, try using bottled or distilled water.*



It is best to work over a sink and ask an adult for help as needed. Have some paper towels handy to clean up any drips. Slightly lift funnel when adding after to prevent it from overflowing.