

FOLDING FOR STORAGE

1. Remove Tray.
2. Remove Seat.
3. Raise Safety Bar to top position.
4. Push button on front of Platform while squeezing lever underneath platform and lift up to fold.
5. Lower the Safety Bar.

TO CLEAN

5-point harness: Machine wash, warm water, gentle cycle. Do not use chlorine-based bleach. Hang to dry. Do not dry clean.

Seat Cushion: Hand wash cold. Line dry.

Tray: Dishwasher-safe; top rack only. Use normal settings. Do not use high temperature setting (sani-cycle). Or tray can be washed in warm water using mild liquid soap. Rinse thoroughly with clean water.

Frame and Seat: Wipe surface with a damp cloth or sponge using mild liquid soap. Wipe with clean water. Air dry.

WARRANTY INFORMATION

If you have a warranty question or any other customer care questions, please contact our Consumer Care team by calling 1-800-704-8697 or by e-mailing cs@tomy.com. You can also visit our warranty page at: <https://us.thefirstyears.com/warranty/>



help@thefirstyears.com / 1-800-704-8697 / www.thefirstyears.com

THE FIRST YEARS is the trademark of TOMY, registered in the U.S. and other countries.
© 2024 TOMY, TOMY INTERNATIONAL, 2015 SPRING RD., OAK BROOK, IL 60523 U.S.A.
All Rights Reserved. Styles and colors may vary. Made in China. Y7937 240528



HAPPY HEIGHTS™ HIGH CHAIR & TODDLER TOWER

Instruction Manual Y7937



Maximum Weight

High Chair: 40 lbs; 6 months to 3 years old

Toddler Tower: 50 lbs; 18 months to 4 years old

**Read all instructions carefully before use
and keep for future reference**

HIGH CHAIR WARNINGS

⚠️ WARNING:

FALL HAZARD: Children have suffered severe head injuries including skull fractures when falling from high chairs. Falls can happen suddenly if child is not restrained properly.

- Always use restraints, and adjust to fit snugly.
- Tray is not designed to hold child in chair
- Stay near and watch child during use
- Never place chair on a tabletop, countertop, or other elevated surface
- Never place near stairs, dangerous objects, or appliances such as stoves.
- The Child should be secured in the high chair at all times by the restraining system.
- The high chair should be used only by children capable of sitting upright unassisted and up to 3 years or a maximum weight of 40 lbs.
- Do not use the high chair unless all components are correctly fitted and adjusted.
- Do not use the high chair if any parts are broken, torn, or missing.
- Never use near stairs or in any location where hanging cords can be reached by child.
- Never adjust seat height when child is in high chair.
- Never allow child to use footrest to climb in or out of high chair.
- Be aware of the risk of tilting when your child can push its feet against a table or any other structure.

TODDLER TOWER WARNINGS

⚠️ WARNING:

FALL HAZARD: Children can suffer serious injury or death from falls or tipping over.

- Always stay near and watch child during use.
- For indoor use only. Always use on a flat, level surface.
- Never place near stairs, dangerous objects, or appliances such as stoves.
- The toddler tower is intended for use with only one child at a time. Maximum weight of 50 lb.
- Always ensure that the support bar is up and positioned around the child's torso when in use.
- Do not allow child to push away from counter. Do not allow child to over-extend reach.
- Do not use the toddler tower unless all components are correctly fitted and adjusted.
- Do not use the toddler tower if any parts are broken, torn, or missing.

IMPORTANT:

- Adult assembly required.
- This product contains small parts. Keep small parts out of children's reach during assembly.
- Assembly components may have sharp points and edges. Exercise care when unpacking and assembling product.
- After assembly is complete, properly discard all packaging materials.

COMPONENTS

1. Seat Top
2. Seat Bottom
3. Seat Pad with 5-point Harness
4. Tray
5. Step/Footrest
6. Front Leg
7. Back Leg
8. Main Frame
9. Platform
10. Upper Frame
11. Safety Bar

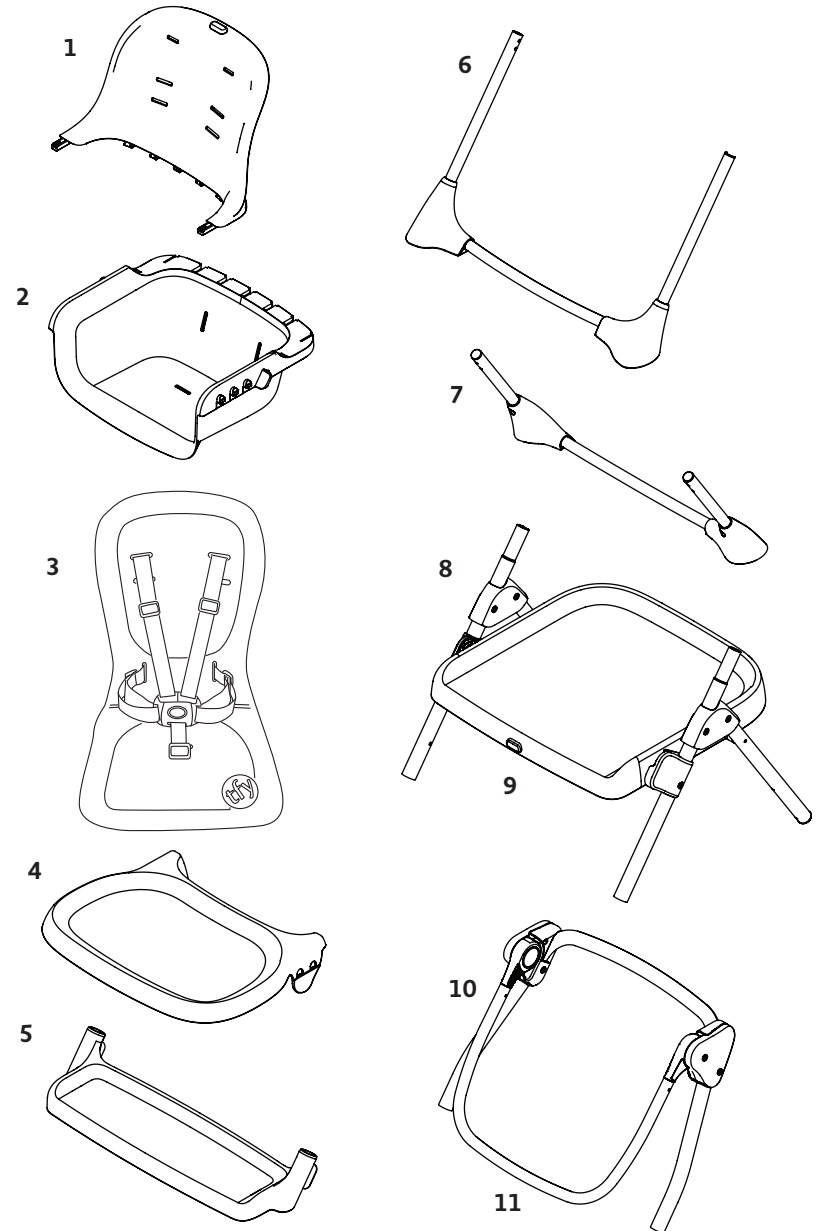

ASSEMBLE SEAT

NOTE: This is a one-time snap assembly. Do not attempt to separate the seat after the top and bottom are joined.

1. Slide the seat top into the seat bottom. It will click into place. [Fig. A1, A2]

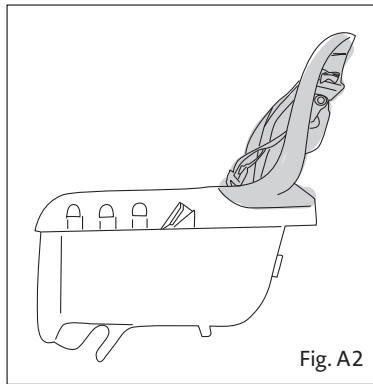
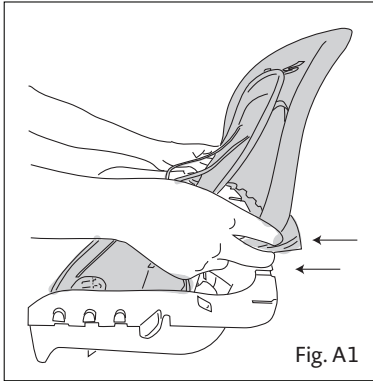

2. Shoulder straps of the harness have already been threaded through. For a smaller child, use the lower two slots. For a taller child, use the higher slots. [Fig. B]

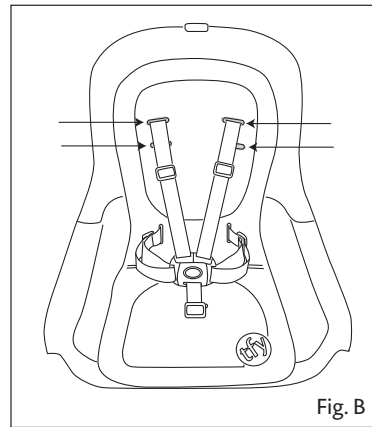

3. Insert Back Leg into Main Frame. [Fig. E] Ensure pins pop through the holes and lock into place.

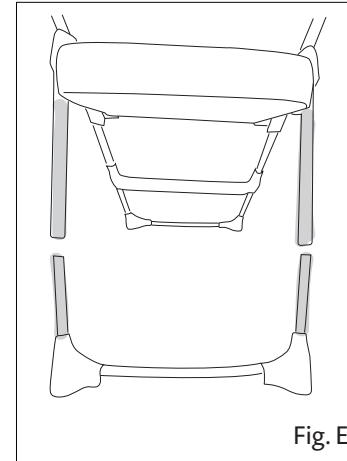

4. Attach Upper Frame to Main Frame. [Fig. F] Ensure pins pop through the holes and lock into place.

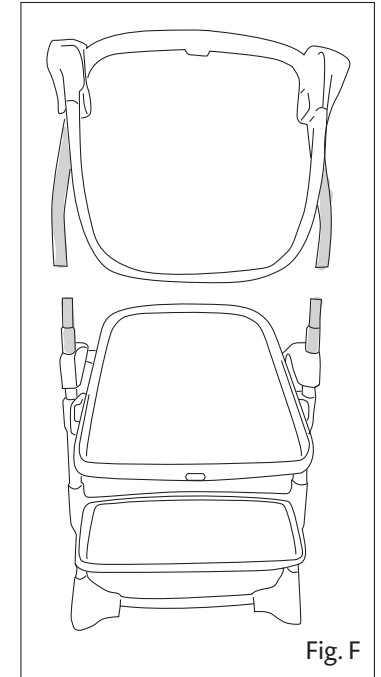

ASSEMBLE FRAME

1. Slide Step/Footrest up onto Main Frame until it clicks into place. [Fig. C]

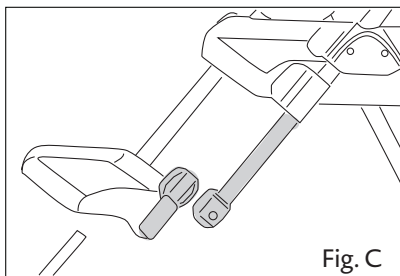

2. Insert Front Leg into Main Frame. [Fig. D] Ensure pins pop through the holes and lock into place. **NOTE:** Front legs are longer than back legs.

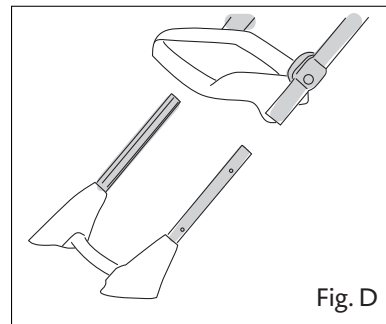

HIGH CHAIR MODE

Attach Seat to Upper Frame

1. Ensure Safety Bar is fully lowered. Push side buttons on Upper Frame to adjust Safety Bar. [Fig. G]

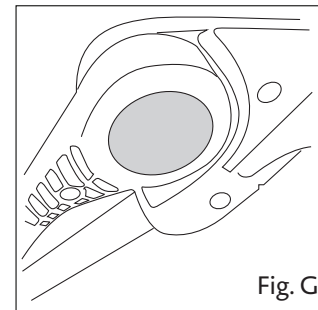

2. Place the bottom hooks of the Chair onto the Safety Bar. [Fig. H]

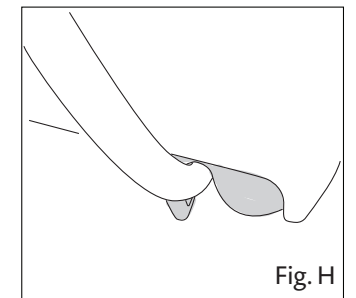

HIGH CHAIR MODE (CONT.)

3. Push down on the button at top back of the Seat while squeezing the lever to release the lock. [Fig. I]
4. Push down on the Seat to lock into place. Always ensure seat is firmly locked in place before use.

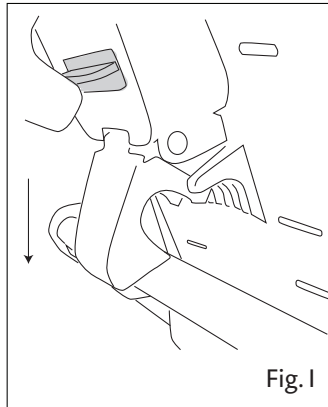

Attaching Tray to Seat

1. Hold Tray over Seat. Align slots on Tray above notches on side of Seat. Holding Tray level, gently flex the sides of the Tray over the notches on the seat and connect. You will hear a click. [Fig. J]
2. To change position, gently flex the sides out and slide over the notches into the other position.

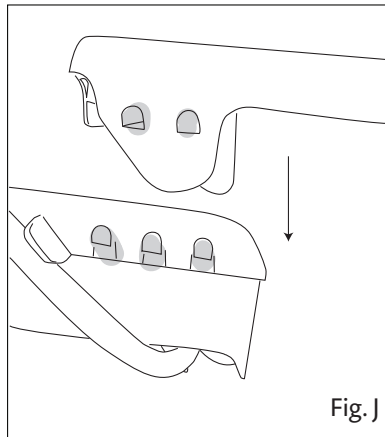

Removing Tray:

Gently flex the sides to disconnect the Tray from the notches and lift the tray off.

TODDLER TOWER MODE

1. Remove tray.
2. Remove Seat by pushing down on the button at top of the seat back while squeezing the lever to release the lock. [Fig. K]
3. Detach the bottom hooks from the safety bar.
4. Push the side buttons on the Upper Frame to lift the Safety Bar to the top position.

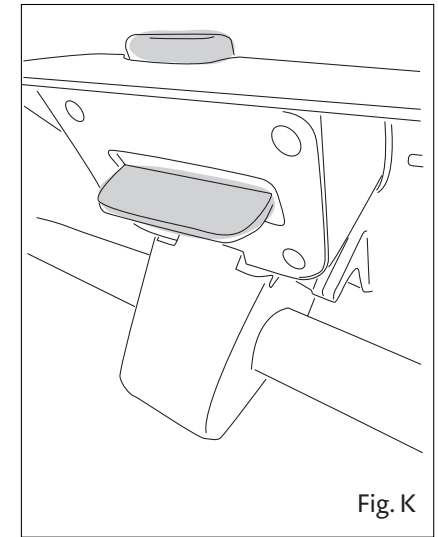

ADJUSTING HEIGHTS

Height can be adjusted for both High Chair and Toddler Tower Mode.

Adjust the leg pins to desired level. Ensure pins pop through the holes and lock into place. Always make sure the product is level before using. [Fig. L]

