

Two-Hole Schedule 40 Half Bath Waste Kit

Parts List

- | | |
|-----------------------|---------------------|
| A. Faceplate Screws | E. Stopper Assembly |
| B. Overflow Faceplate | F. Spud |
| C. Overflow Gasket | G. Drain Gasket |
| D. Overflow Elbow | H. Drain Elbow |

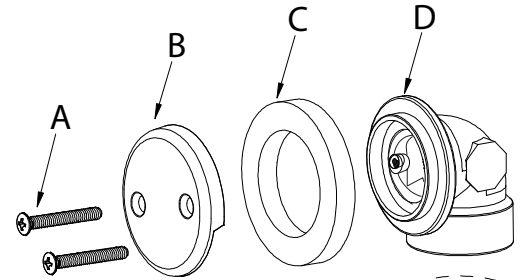

Additional Parts Needed

- Pliers
- PVC Cement
- Screwdriver

Installation Instructions

1. Check the fit of all pieces before assembly to ensure all dimensions are correct.
2. Cut the pipes to correct lengths, if needed.
3. Attach the overflow gasket (C) to the overflow elbow (D) and insert into the overflow opening from the back of the tub.
4. Secure the overflow faceplate (B) to the overflow elbow (D) using the faceplate screws (A).
5. Position the drain elbow (H) and drain gasket (G) under the bathtub.

Note: You can use pliers to go through the crossbars inside.

6. Place the stopper assembly (E) in the spud (F).
7. Using PVC cement, glue all PVC tubular items together.
8. Test for leaks.

