

# Remi Smart Toilet

## USER MANUAL

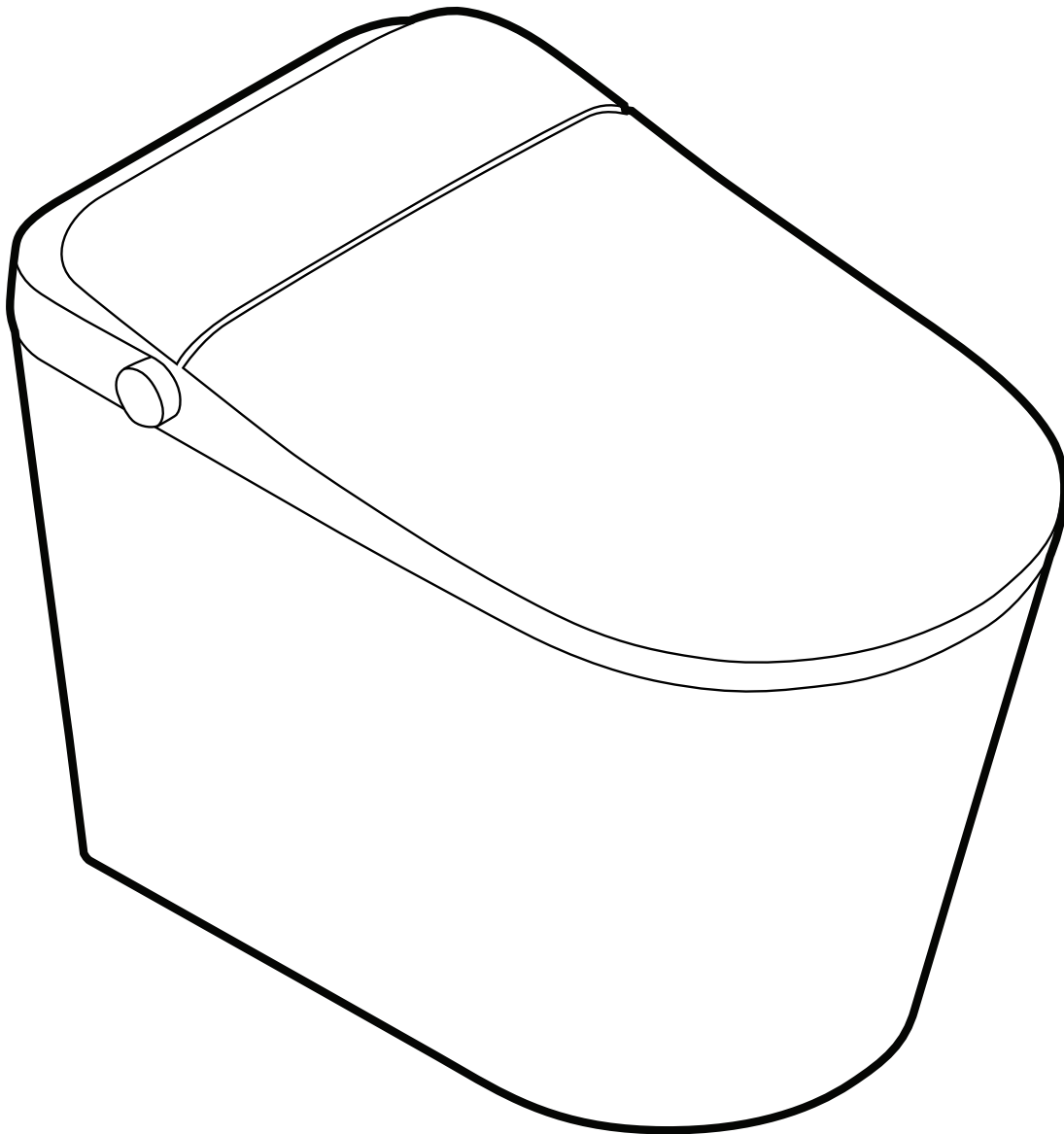



## PRIOR TO INSTALLATION:

- Inspect toilet to ensure no damages have occurred while in shipping.
- Observe all plumbing and building codes in accordance with your state and local requirements.
- All dimensions are nominal! Be sure to measure your toilet prior to installation.
- The step-by-step guidelines in the installation instructions are a general reference. Should there be any discrepancies, Swiss Madison cannot be held liable. It is recommended to install all Swiss Madison products by hiring a licensed professional.
- Read installation and maintenance instructions thoroughly before installing. Be sure to use proper tools and always wear proper personal safety accessories for your protection.
- Two people are recommended to handle and install this product as it is fragile.

## QUESTIONS OR CONCERNS?

Please contact us:

1-434-623-4766

info@swissmadison.com

## INCLUDED PARTS:

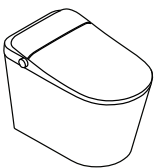

Smart Toilet



Wax Ring



Remote

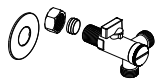

Angle Valve

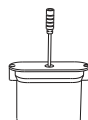

Battery Box



Water Line

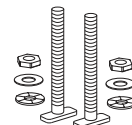

T-Bolts



Foaming Agent



Bolt Cover  
Caps



Aroma  
Therapy Disc

## SUGGESTED TOOLS & MATERIALS:



Safety  
Glasses

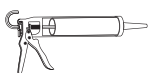

Glue Gun

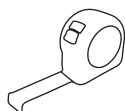

Tape  
Measure



Wrench

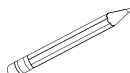

Marker



Screwdriver



Drill



Sealing Tape

**CAUTIONS AND WARNINGS:****DON'T  
DISASSEMBLE****Never disassemble, repair or alter.****Do not use tools in areas other than designated in this manual.**

Doing so may cause fire, electrical shock, overheating, short circuit or equipment failure.

**DON'T  
SPLASH WATER****Do not get any water or cleaning solution on the main unit or connection of power cord.**

Doing so may cause fire, electrical shock, heat or short circuit and may cause the product to crack resulting in injury or water damage.

**DON'T****Do not use the product if a malfunction occurs.**

In case of malfunction or other problems, be sure to cut off power by switching to OFF. Close the water valve to stop water supply.

Possible malfunctions:

- Water is leaking from a pipe or the main unit.
  - The product is cracked or broken.
  - The product makes a strange noise or emits a strange odor.
  - The product emits smoke.
  - The product is abnormally hot.
- 
- The toilet seat is out of place. Continued use of the product after a malfunction could result in fire, electrical shock overheating, short circuit, injury, or water damage.
  - Continued use of the smart toilet after a malfunction could result in fire, electrical shock overheating, short circuit, injury, or water damage. Please contact professionals for assistance.
  - Use tap water only. Using other types of water may cause irritation to the skin and malfunction of the product.

**DON'T****STOP****Do not use a loose or unstable power socket.**

Doing so may cause fire, electrical shock, heat or short circuit.

**Insert the power plug into an AC socket rated for 110V to 60Hz and 15A or above. Failure to do so could result in fire or electrical shock.**

If the power exceeds the socket's specification, it may cause overheating and potentially lead to fire.



STOP

**Do not perform any actions that may damage the power plug.**

Avoid striking, yanking, twisting, excessively bending, damaging, altering, or heating the power cords. Additionally, do not place any heavy objects on, bind, or pinch the power cords. Using a damaged power cord may result in a fire, electrical shock, heat or short.

**Do not install in wet locations or areas prone to condensation.**

This is an electrical product. Avoid installing in areas that it is most likely to get wet or humidity is high.



MUST

When using the product in a bathroom, install a fan or ventilation port and ensure good air flow through the bathroom. Failure to do so may cause fire or electrical shock.

**If the power cord is damaged, it must be replaced by the manufacturer, its service agent, or another qualified professional to avoid hazards.****Do not allow children to play with the toilet and remote.**

The appliance is not to be used by persons (including children) with reduced physical, sensory or mental capabilities, or lack of experience and knowledge, unless they have been given supervision or instruction. To prevent low-temperature burns, please do not sit on the toilet for a long time.



GROUND WIRE

**This appliance must be grounded.**

Connect this product only to a properly grounded power supply unit. Improper connection may cause electric shock.



MUST OBEY

**Do not raise the toilet seat or lid while objects are on top of the unit.**

Doing so may cause the main unit to come loose and fall, resulting in injury. Do not lean on cover when device is in use to prevent product from damage.



NO FIRE

**Keep cigarettes and other open flames away from the product.**

Failure to do so may cause fire.



STOP

**Do not apply strong force, mechanical shock, step on or stand on the toilet seat, toilet lid or main unit.**

Also do not place any heavy objects on the toilet seat, toilet lid or main unit. Doing so may cause the main unit to crack or come loose and fall, resulting in injury. Doing so may damage the product and cause injury or water damage.

**Never obstruct the warm air openings of the product with fingers or any other items.**

Ensure that the warm air openings remain unobstructed to prevent electric shock, personal injury, or damage to the product.

**Do not fold or crush the water supply hose or damage by cutting with a sharp object.**

Doing so may cause water leaks.

When maintaining the plastic parts (main unit etc.) or the water supply hose, use a neutral kitchen detergent diluted with water.

**Do not use any of the following: toilet cleaner, household cleaner, benzene, paint thinner, powdered cleanser, or nylon scrubbing brush.**

These items may damage or crack the plastic, potentially causing injury or malfunction. Additionally, these items could damage the water supply hose and result in a water leak.

**To prevent a sudden water leak, never remove the water filter drain valve while the shut-off valve is open.**

Doing so will cause water to spurt out unexpectedly.



MUST OBEY

**When installing the water filter drain valve, make sure that it is securely tightened in its proper position.**

Failure to securely tighten it may cause a water leak.

**MUST OBEY**

**If a water leak occurs, always close the shut-off valve immediately.**

**When the ambient temperature is expected to drop to 0°C or below, take measures to prevent damage to the pipes and hoses due to freezing.**

- Frozen water pipes can cause the main unit and connected pipes to crack, potentially resulting in a water leak.
- To avoid this, regulate the room temperature to ensure that the pipes and hoses do not freeze during cold months.
- Failure to properly secure and tighten connections may also cause a water leak.

**Avoid exposing the product to direct sunlight, as this may cause changes in color or malfunction.**

Do not urinate on the main unit, toilet seat, or wand, as this may result in malfunction or discoloration.

**Disconnect the power cord during thunderstorms.**

- When the product will not be used for a long period of time, close the shut-off valve and then turn off the power to the product.
- When the product is not used for a long time, remove the battery in the battery box to prevent the battery leakage from damaging the battery box.
- Use the water supply hose provided with the product. Do not use old or existing hoses.

**Keep the remote control away from water.**

During daily use of the remote control, keep it away from water to prevent water from getting inside the remote control. And please return it to the holder after each use. When the product has been used for a long period of time, replace the batteries in the remote control.

**PARTS:**

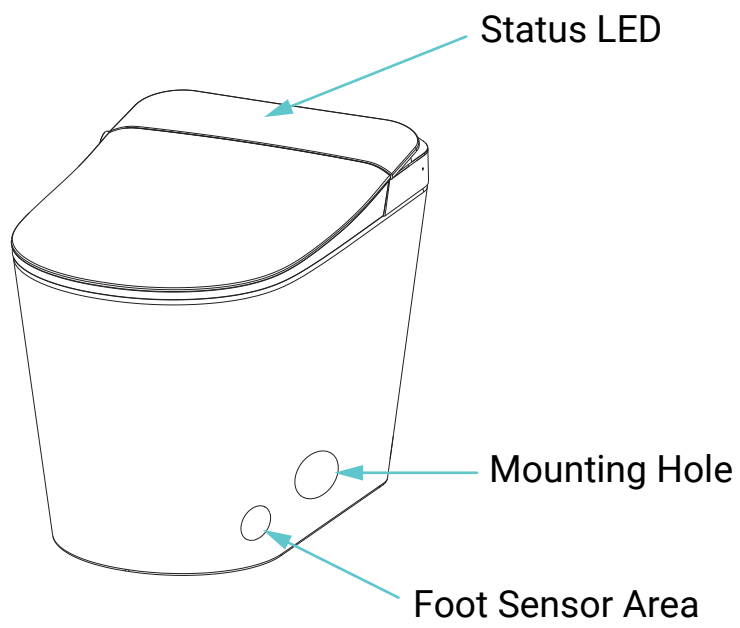
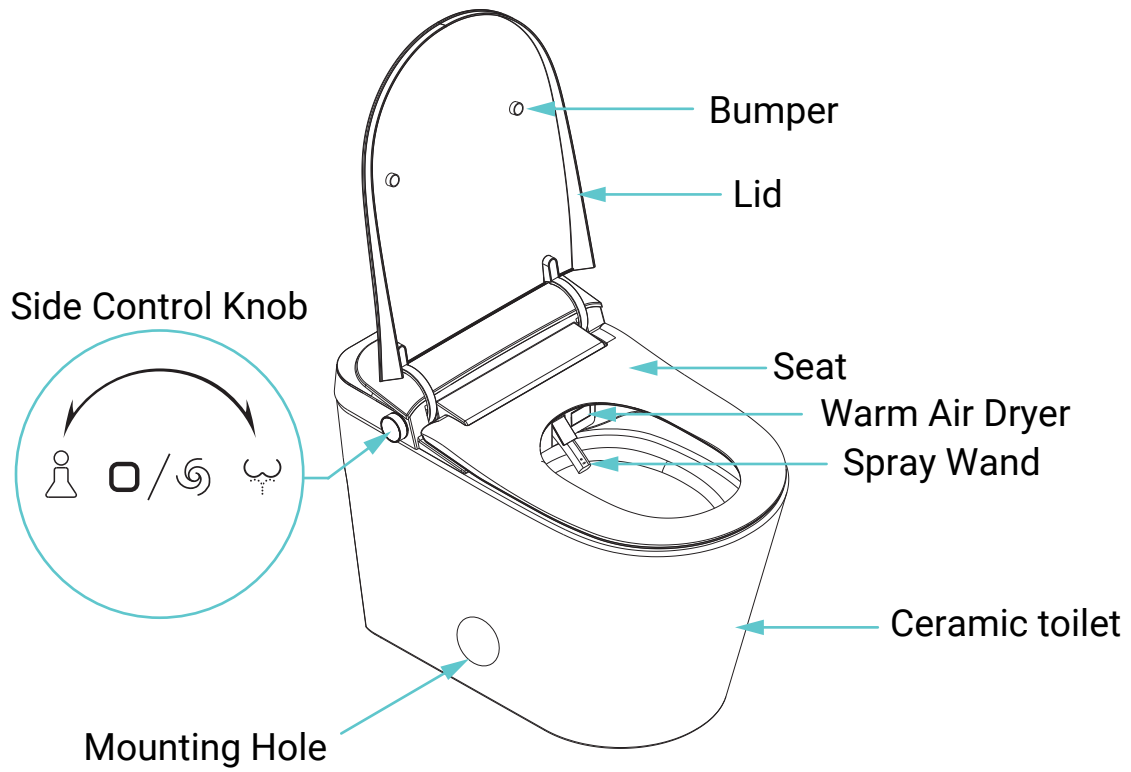

## INSTALLATION PREPARATIONS:

- Make sure that the floor tiles and the wall tiles have been paved, and that a pit tube and a water supply pipe are reserved.
- Reserve the installation position according to the dimensions given in the figure below (symbols \* refer to the recommended dimensions) to ensure normal use of the water supply pipe.
- Make sure the distance between center of the pit tube and the wall, i.e., the pit distance, matches with the product.
- Turn on the water supply switch to drain water to flush away the mud and other foreign matters in the reserved water pipes to avoid blockage of the water pipes..

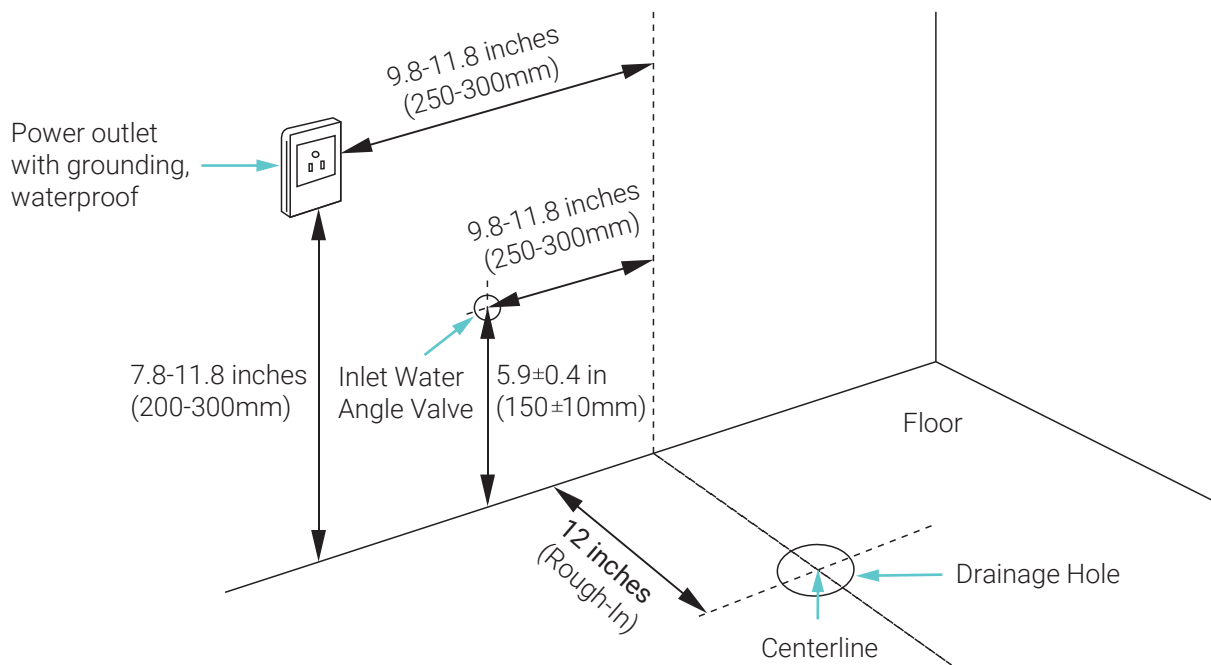

Be sure to set the power outlet as follows:

1. Confirming that the power socket used is handled by proper grounding.
2. The location of the power outlet should be in close proximity to facilitate the installation and disassembly of this product, while also maintaining a safe distance from the bathtub area.
3. It is recommended to use a waterproof type socket, do not use an extension cord to connect this product.
  - May cause fire or electric shock.



Warning

## INSTALLATION:

### 1 For newly installed toilet, a flange plate is needed (not included).

- Place the flange plate into the drainage hole, aligning the arrow on the flange plate with the dashed line on the vertical wall. The center of the flange must align with the center line.
- Use a marker to indicate the positions of the four installation holes on the flange plate.
- Use a power drill to create four 6mm installation holes on the flange plate. Insert four corresponding plastic anchors.
- Secure the flange plate in place using the provided four screws.
- A power outlet is required, and it is recommended to place the outlet 6-12 inches off the floor to the left or right rear of the toilet.

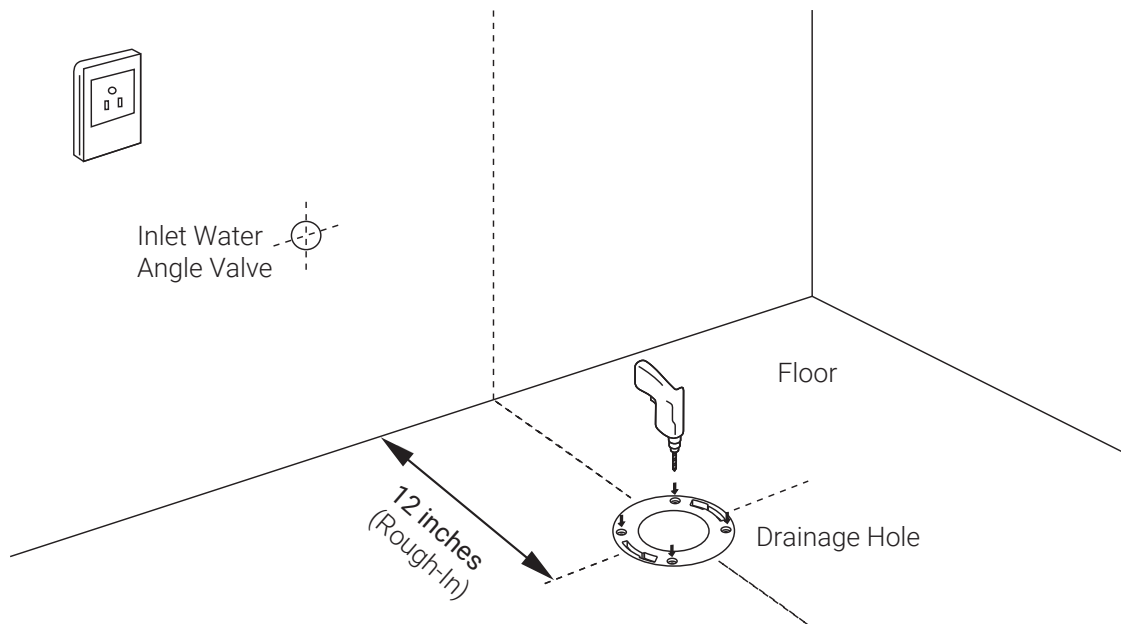

### 2 • Install the floor bolts

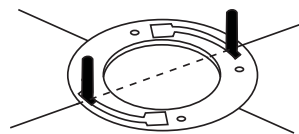
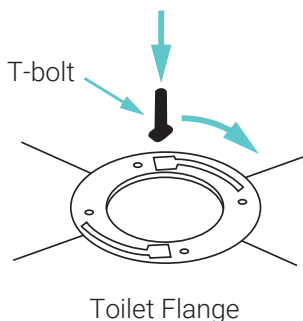

The two screws and the center of the flange must be in straight line

### 3 Install Angle Valve

#### Installation Method 1

- Remove the copper sleeve and nut from the NPT 1/2 valve.
- Insert the nut and copper sleeve into the copper tube in order, and then tighten the valve.

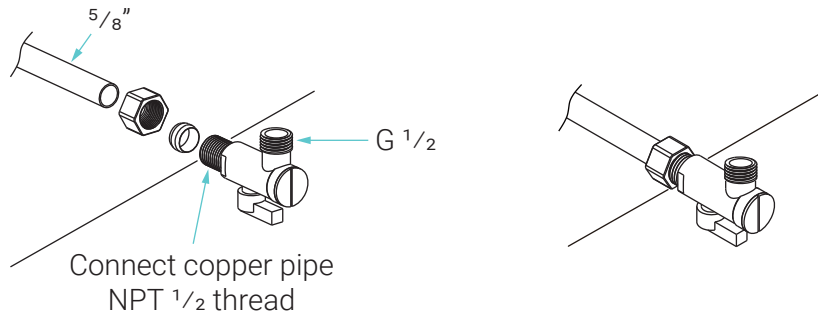

#### Installation Method 2

- Remove the copper sleeve and nut from the NPT 1/2 valve.
- Screw the valve into water outlet.

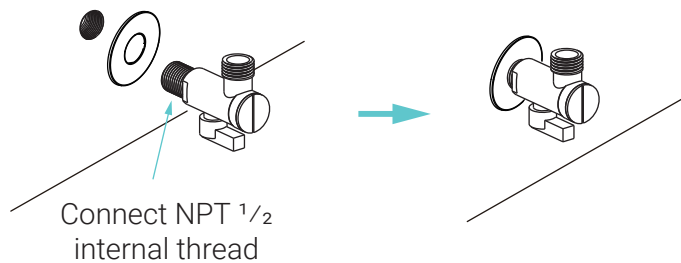

#### Installation Method 3

- Wrap sealing tape around the 3/8" compression male thread of the valve and screw the adapter onto the valve.
- Remove the copper sleeve and nut from the NPT 1/2 valve.
- Wrap sealing tape around the NPT 1/2 thread of the valve, and then tighten the valve joint NPT 1/2 location.

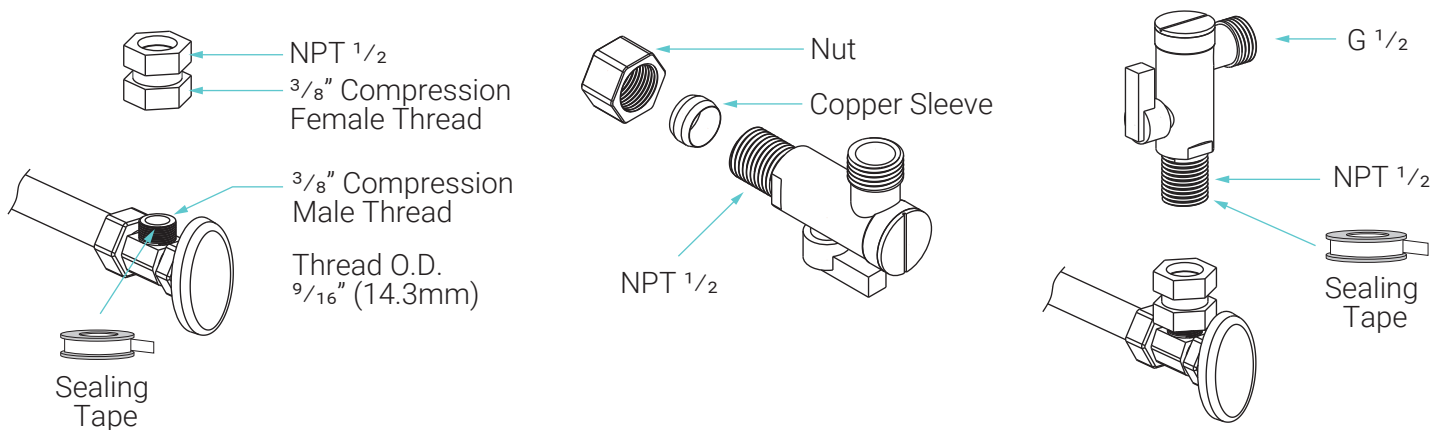

#### 4 Install the Battery

- Open the battery compartment and insert 10 AA batteries. Find the lead wire of the battery box, connect the waterproof plug, and then place the battery box inside the ceramic.

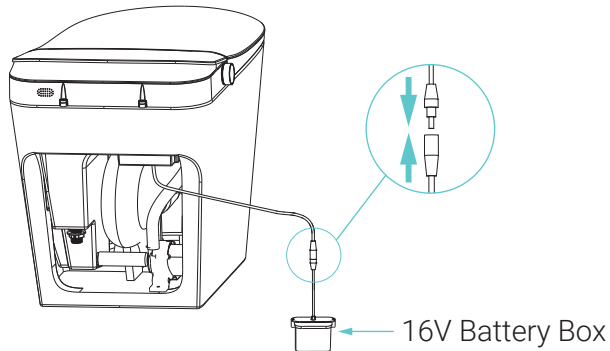

#### 5 Install the Wax Ring

- Put the wax ring on the flange.

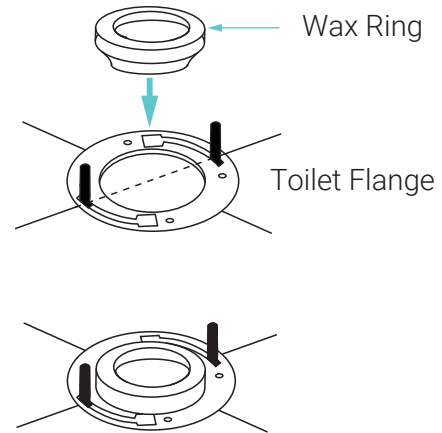

#### 6 Install the Toilet

- Carefully lower the toilet onto the flange and press firmly to secure it.
- Place the washer and nut onto the T-bolt screw, then tighten securely.

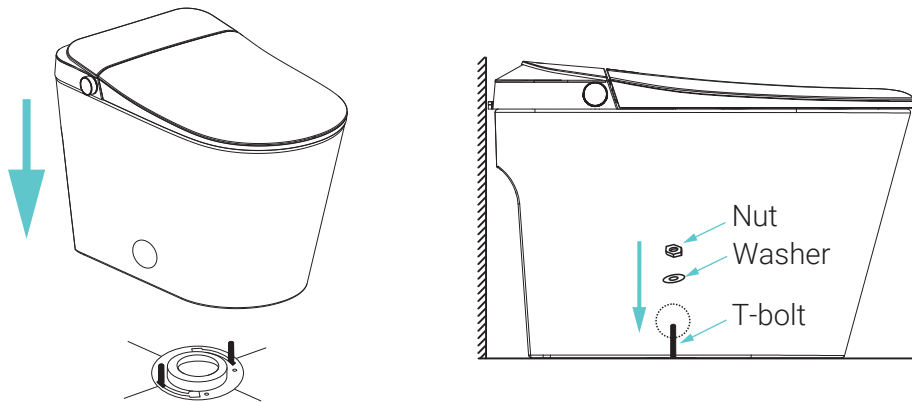

#### 7 Install the Bolt Cover Cap

- Cover both sides of the toilet with bolt cover cap.

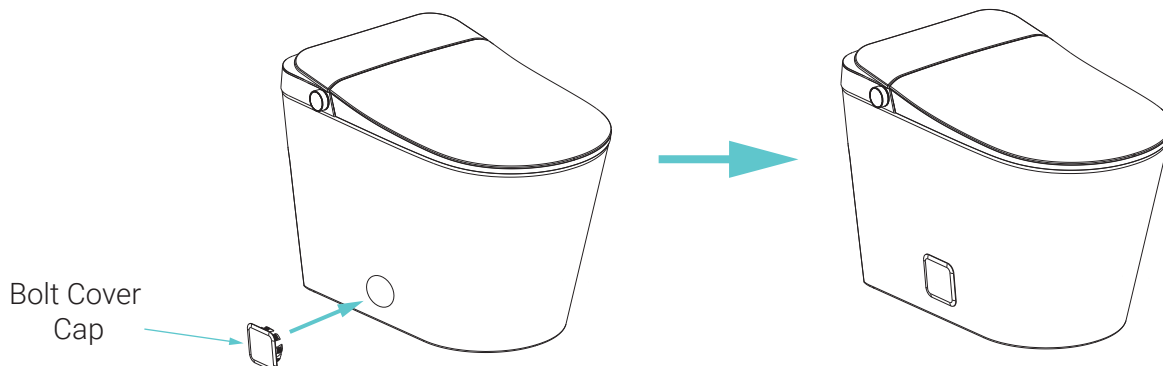

## 8

**Connect the Inlet Pipe**

- Connect the water inlet hose.
- Apply a circle of anti-mold sealing silicone at the junction between the toilet and the floor. After the silicone sealant has solidified, plug in the power and slowly open the angle valve. Adjust the water pressure to within 80 PSI and check all connection points for leaks.

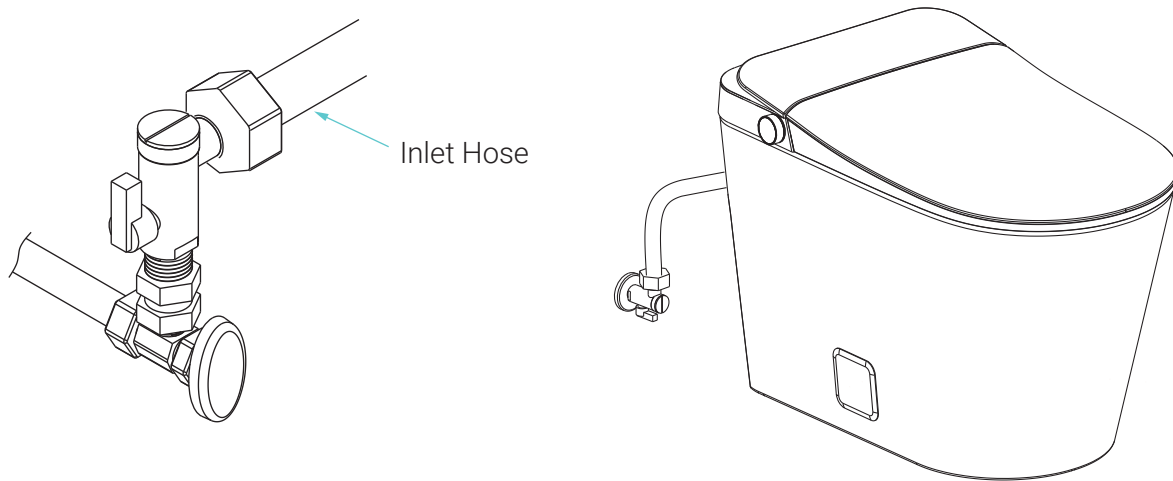

## 9

**Install Aromatherapy Disc and Foam Solution**

- Open the decorative cover, place the aromatherapy disc in the corresponding position. Put in foam liquid and screw on the bottle cap, and then install the decorative cover back.

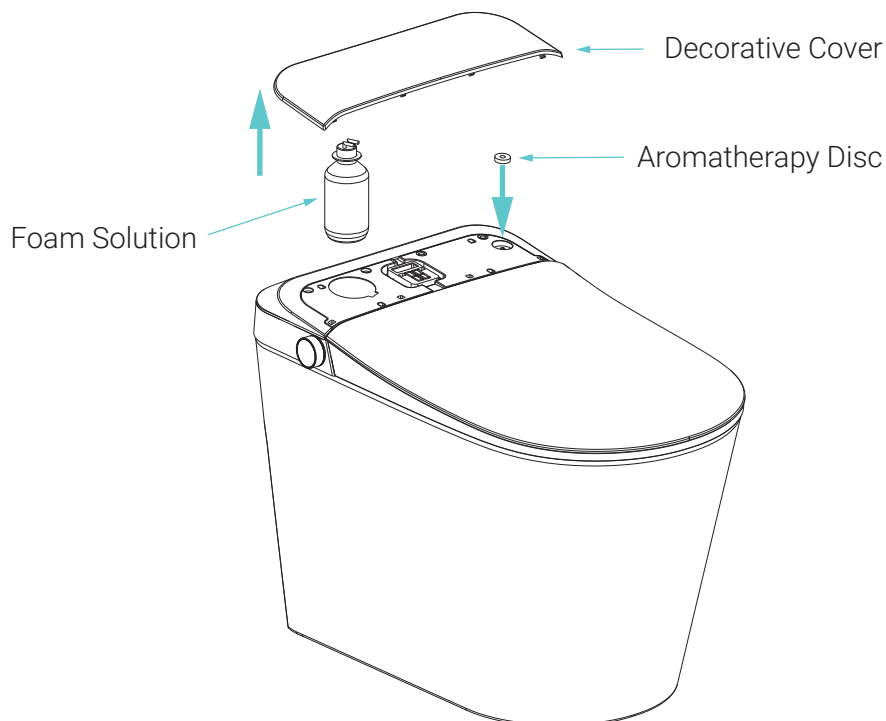

## PREPARATION

### 1 Turn on the angle valve

- Check the threaded connection for leaks to ensure complete sealing.
- Turn the angle valve counterclockwise to the full open position.

**Note:** The angle valve opens with a large torque for the first time.

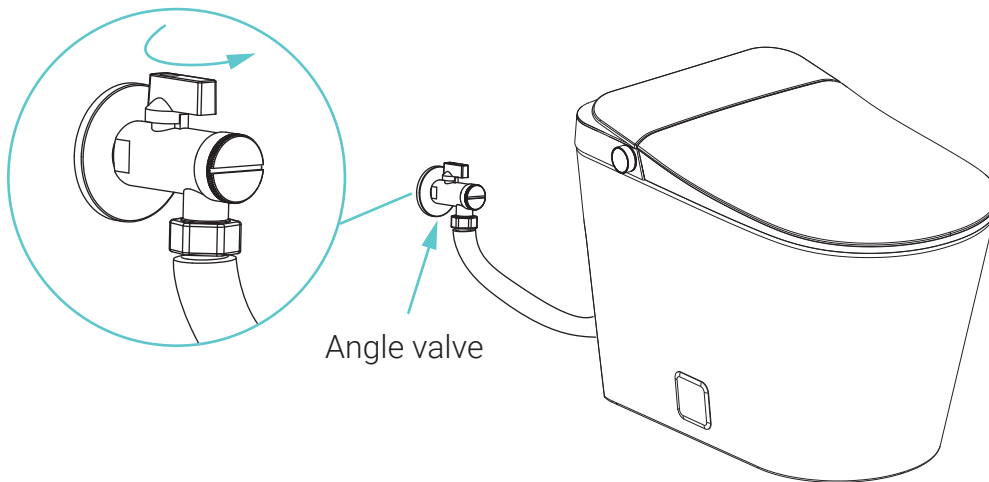

### 2 Power Connection

- Insert the leakage protection plug into a power socket, press the reset switch, plug indicator lights up, indicating that the power is on.

**Note:**

Press the test button prior to usage, the reset switch pops up indicating that the leakage protection function is normal.

Press the TEST button (then RESET button) every month to assure proper operation.

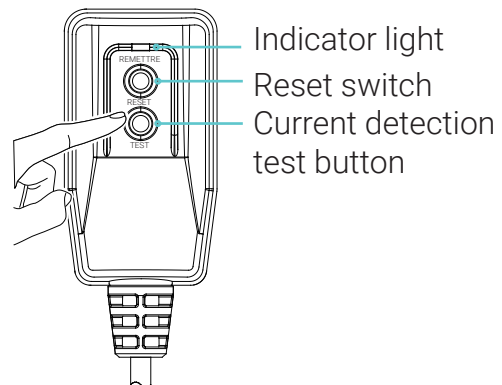

### 3 Self-inspection

- a. Once power is connected, the buzzer beeps. The knob lights up in white, and the self-inspection starts.
- b. The buzzer beeps again, then the self-inspection completes.
- c. The product is ready to use.

## CONTROL KNOB FUNCTIONS

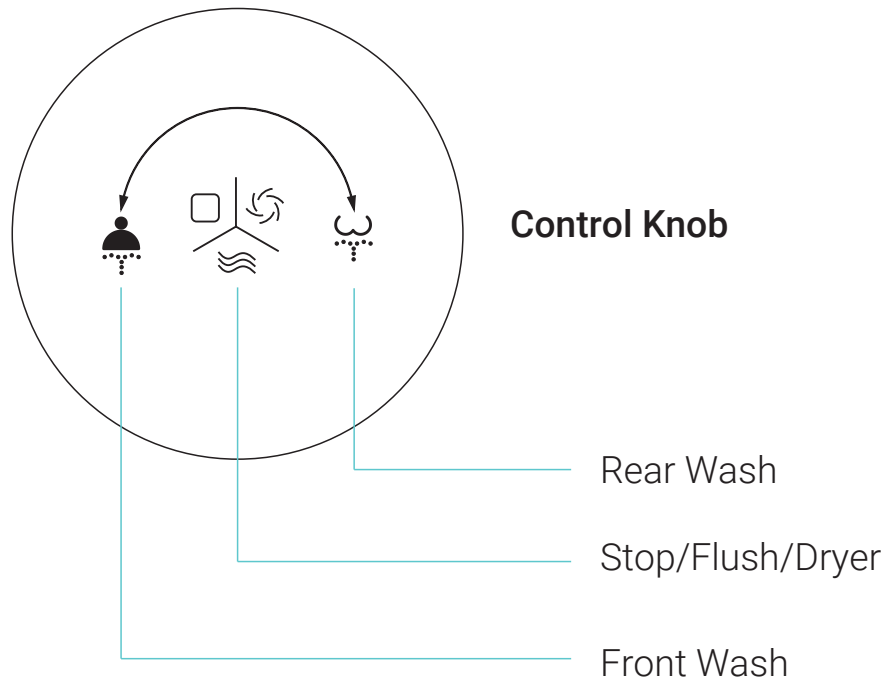

### When the toilet is not occupied:

- Press the knob to flush.
- Press and hold the knob for 5 seconds to power on/off the toilet.

### When the toilet is occupied:

- Turn the knob clockwise to activate spray wand and start rear wash.
- Turn the knob counterclockwise to activate spray wand and start front wash.
- Press and hold the knob for 3 seconds, the toilet will first activate the flushing function before drying.
- One-Key Mode: Turn the knob towards the Rear Wash/ Front Wash direction and hold for 3 seconds to activate the one-key mode. The product will automatically perform the following steps: Rear Wash/ Front Wash → Flushing → Drying.

## FUNCTION ADJUSTMENTS

### Setting Auto Flush When Leaving the Seat (Default: ON)

In standby mode, long-press the "STOP" button to power off. Then, long-press the "FLUSH" button on the remote control for over 3 seconds until a prompt tone sounds. Release the button, and the seated indicator will blink, indicating entry into adjustment mode. Briefly press the "SEAT TEMP" button to enable auto flush when leaving the seat. Briefly press the "WATER TEMP" button to disable auto flush when leaving the seat. After setting, wait for 15 seconds, then press and hold the STOP button on the remote control to power on.

### Adjusting Flush Duration

In standby mode, long-press the "FLUSH" button for over 3 seconds until the seated indicator blinks, entering flush duration adjustment.

Press "FORWARD" to increase time by 0.5 seconds per press; press "BACKWARD" to decrease by 0.5 seconds.

Briefly press the "FLUSH" button again to enter sewage flush time adjustment.

Use "FORWARD"/"BACKWARD" to adjust  $\pm 0.5$  seconds per press.

Briefly press "FLUSH" again to enter refill time adjustment. Adjust via "FORWARD"/"BACKWARD" ( $\pm 0.5$  seconds).

Briefly press the "STOP" button to confirm settings and exit.

During adjustment, briefly press "WATER PRESSURE +" to restore default settings.

### Setting User Approach Sensor Distance

In standby mode, long-press the "COVER" button for over 3 seconds until a prompt tone sounds and the seated indicator blinks, entering sensor distance adjustment. Six distance levels are available (0-5). Default: Level 3. Level 0 disables the sensor. Press "SEAT TEMP" to increase level; press "WATER TEMP" to decrease level.

Long-press "COVER" again to exit (indicator turns off).

Level 0 = OFF

Level 1 = around "8" inches

Level 2 = around "16" inches

Level 3 = around "24" inches

Level 4 = around "32" inches

Level 5 = around "40" inches

### **Disabling User Approach Sensor Function**

In standby mode, long-press "COVER" for over 3 seconds until a prompt sound is heard and the indicator blinks, indicating entry into adjustment mode.

Press "WATER TEMP" five times to disable the sensor.

Long-press "COVER" to exit (indicator turns off).

### **Enabling User approach Sensor Function (Default: ON)**

In standby mode, long-press "COVER" for over 3 seconds until a prompt sound is heard and the indicator blinks, indicating entry into adjustment mode.

Press "SEAT TEMP" three times to enable the sensor.

Long-press "COVER" to exit (indicator turns off).

### **Adjusting Lid/Seat Opening/Closing Force**

In standby mode, long-press "COVER" for over 3 seconds until a prompt sound is heard and the indicator blinks, indicating entry into adjustment mode.

Press "DRYER TEMP" to increase lid opening force; press "FRONT" to decrease it.

Press "LIGHT" to increase lid closing force; press "Spa" to decrease it.

Press "+" to increase seat opening force; press "-" to decrease it.

Press "FORWARD" to increase seat closing force; press "BACKWARD" to decrease it.

Test results by pressing "COVER/SEAT" buttons. Long-press "COVER" to confirm and exit.

### **Enabling/Disabling Bowl Pre-Wetting (Default: ON)**

In standby mode, rotate the knob to the "REAR WASH" direction and hold for 3 seconds until a tone sounds. Release, then briefly press the "FLUSH" button on the remote control to turn the pre-wetting function OFF or ON.

### **Enabling/Disabling Foot Sensor (Default: ON)**

In standby mode, long-press "STOP" to power off, then long-press "FLUSH" for over 3 seconds until a prompt sound is heard. Release the button to enter adjustment mode. Press "REAR" to disable foot sensor; press "FRONT" to enable it.

After setting, wait for 15 seconds, then press and hold the "STOP" button on the remote control to power on.

### **Enabling/Disabling Energy-Saving Mode (Default: ON)**

In standby mode, long-press "STOP" to power off.

Briefly press "SEAT TEMP" to disable energy-saving (two beeps); press again to enable (one beep). After setting, Long-press "STOP" button to power on).

### **Foam Shield Function (Default: Manual Activation)**

Manual Mode: In standby mode, briefly press the "DRYER" button on the remote control to activate the Foam Shield, which produces foam for 20 seconds .

Auto Mode Toggle: In standby mode, long-press the "SPA" button to enable the Auto Mode (one beep confirms activation). Long-press the "SPA" button again to disable Auto Mode (two beeps confirm deactivation) .

Auto Mode Behavior: When Auto Mode is active, the Foam Shield automatically activates for 20 seconds upon detecting someone sitting down. A subsequent activation requires an interval of more than 5 minutes.

### **Pairing the Remote Control to the Toilet**

- On standby mode, rotate the knob towards the "REAR WASH" direction and hold it for about 3 seconds. After hearing the prompt sound, release it. Wait for about 2 seconds before hearing the prompt sound again, indicating that the remote control has entered the code matching mode. Press any button on the remote control to successfully match the code.
- Each remote control corresponds to a unique code. Before using the designated toilet, it is necessary to pair the remote control once in order to use it. Otherwise, the remote control will not operate.

### **Deodorizer**

The deodorizer uses activated carbon and operates automatically, with no manual action required.

### **Energy Saving Mode**

When the intelligent toilet is not used for 1 hour, it will automatically enter energy-saving mode, and the seat temperature will automatically adjust to 91°F, entering a low-temperature setting. Upon being seated, it will reheat to the preset temperature.

### **Automatic Flip Seat Cover** (This feature is unique to the automatic flip toilet)

- Automatic flip (toilet) seat cover open and close the seat cover by identifying the proximity/presence/departure of the human body
- When the human body is approximately 30-60cm away from the toilet, the cover will automatically open.
- When the cover is opened, it will automatically close 30 seconds after the user leaves the toilet.
- When the seat is lifted, both the seat and the toilet cover will automatically close and initiate a water flush upon user leaving the toilet.
- If the flushing function has already been activated during use, no additional flushing will occur after the cover is closed.

### **Ambient light** (This feature is unique to products with Ambient light)

The ambient light features seven lighting modes. Users can switch between different colors by long-pressing the 'LIGHT' button on the remote control. The colors cycle in the following order: multicolor flowing light, automatic color transition, white, orange, yellow, ice blue, and purple.

### **Foot Kick Flip the Cover And the Seat** (This feature is unique to the automatic flip toilet)

- When the cover is closed, kick the foot kick, it will automatically open the cover;
- When the cover is opened/the seat is closed, kick the foot kick it will automatically open the seat;
- When the seat is opened, kick the foot kick it will automatically close the cover, the seat and then flush.

### **Automatic Flush After Leaving**

When a user is seated more than five seconds and leaves the seat, it will automatically flush.

### **Power Outage Flushing**

The toilet is equipped with a backup battery. In the event of a power outage, short press the knob to activate the flushing function.

## LID AND SEAT AUTO OPEN/CLOSE

Only for the product with lid auto opening/closing function. If the auto lid open/close function is disabled, please use the remote control to enable this function.

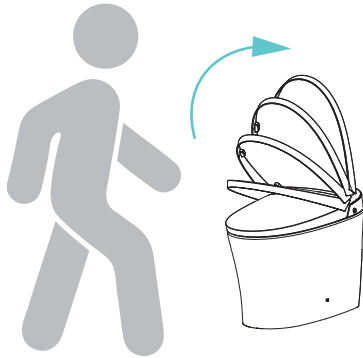

### Approaching the toilet

When user enters the sensing range, the seat lid opens automatically.

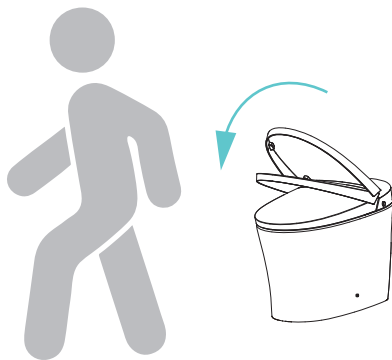

### Leaving the toilet

When a person leaves the toilet, the toilet lid automatically closes after the microwave detects a period of inactivity.

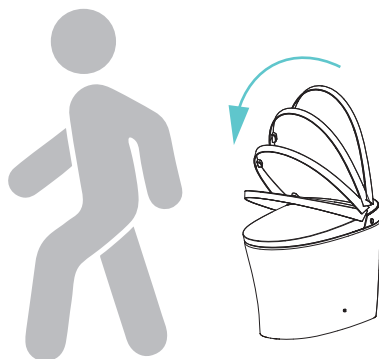

### Open and Close Toilet Seat

After leaving the toilet after use, the microwave detects human inactivity for a period of time, and the toilet lid and seat automatically close.

## FOOT SENSOR



When the lid and seat are both closed, touch the sensing area with foot to open the lid.

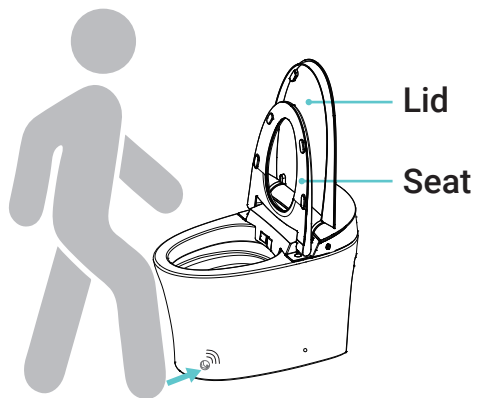

When the lid is open and seat closed, touch the sensing area with foot to open the seat.

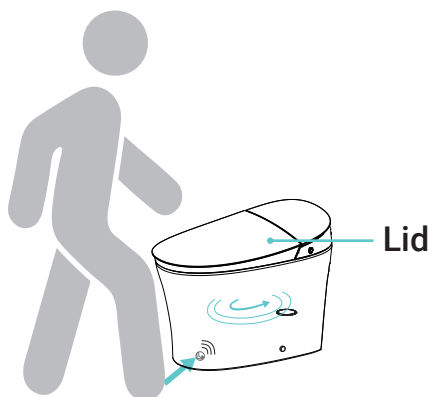

When the seat and lid are open, touch the sensing area with foot to close the seat and lid and activate a flush.

## MAINTENANCE

### Main unit care and maintenance

- Shut off power supply before doing maintenance.
- Use only a soft, damp cloth to clean.
- Avoid using harsh chemicals.
- Once cleaning is completed and all surfaces are dry, re-connect the power plug.

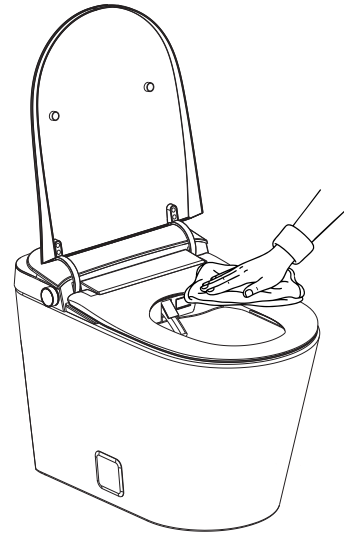

### Spray nozzle maintenance and care

- Open the cover and seat.
- With the product connected to water and electricity, rotate the knob towards the front wash direction and hold it until you hear the prompt sound. This will extend the nozzle and clean water will flow from the self-cleaning port.
- Gently brush the nozzle with a small brush.
- Short press the knob or press the "STOP" button on the remote control to retract the nozzle.

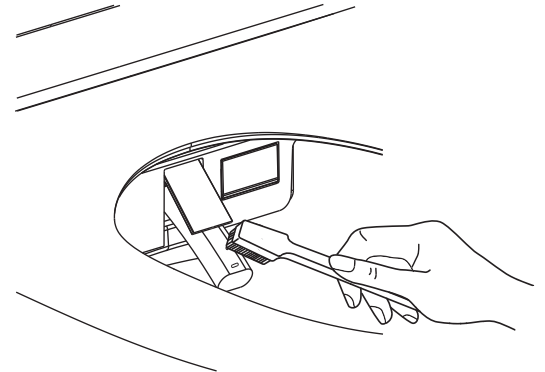

### Filter maintenance

If poor spray performance occurs under normal conditions:

1. Turn off power and the angle valve
2. Unscrew angle valve nut
3. Remove filter net
4. Clean out the filter net under running water using a toothbrush
5. Reinstall filter and angle valve nut.
6. Turn on the angle valve and connect power.

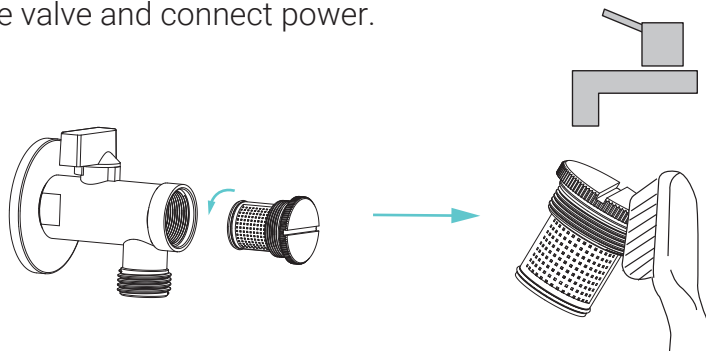

## TECHNICAL SPECIFICATION

Product Name	Smart Toilet
Rated Voltage	110-120V
Rated Frequency	60Hz
Rated Power	1150W
Flush Volume	1.06GPF(4LPP)
Waterproof Level	IPX4
Warm Water Temperature	4 levels (Room Temperature- 104°F)
Warm Air Temperature	4 levels (Room Temperature- 140°F)
Heated Seat Temperature	4 levels (Room Temperature- 105°F)
Operating Temperature	41-104°F
Warm Water Heating Method	Instant Heating
Water Entry Temperature	33.8-95°F
Supply Water Pressure	11.6-73 PSI ( 0.08MPa-0.5MPa)
Codes/Standards	ASME AII2.4.2-2021/CSA B45.16:21 ASME AII2.19.2-2024/CSA B45.1:24

### Power value testing condition

Water Pressure	29 PSI (0.2 MPa)
Inlet Water Temperature	59°F
Water Flow	0.17 gpm (650 ml/min)
Power cord length	1.5M (59.05 inch)
Power outlet	Equipped with a GFCI plug, suitable for 15A circuits
Maximum Hygiene Temperature	107°F

## TROUBLESHOOTING GUIDE

Problem	Cause	Solution
No Water from Nozzle	Water inlet hose bent causing water blocking	Adjust the inlet hose to a minimum bend radius
	Inlet valve is off	Turn on the inlet valve
	Water supply is cut off	Connect water supply and wait for the water
	The sensor does not work	Adjust your sitting position to make sure sensor is activated
Weak water cleaning	Water inlet hose bent causing partial blocking	Adjust the inlet hose to a minimum bend radius
	Inlet valve is not fully turned on	Turn on the inlet valve fully
	Inlet filter blocked	Clean the filter
Low water temperature	The water temperature is set to normal temperature level	Reset the water temperature
Low seat temperature	The seat temperature is set to normal temperature level	Reset the seat temperature
Low wind temperature	The wind temperature is set to normal temperature level	Reset the wind temperature
Stops in the middle of use	Dryer features stop automatically after 3 minutes of continuous use	Restart the dryer function
	Cleansing features stop automatically after 2 minutes of continuous use	Restart the Cleansing function
	Seat sensor fails to detect user presence	Adjust your sitting position to ensure the sensor is activated
Spray rod cannot retract	Power off	Push back the rod lightly and wait for power to be restored
	Get stuck by impurities	Clear away the impurities

Problem	Cause	Solution
Spray rod cannot extend	Power is off	Gently push the spray rod forward and wait for the power to be restored
	Not seated in the sensing area	Sit properly within the sensing area
Remote control display not functioning	Battery polarity reversed	Reinsert the battery with correct polarity
Toilet leaking	Close the angle valve, inspect all water pipes, and contact a professional.	
 Caution	If the problems cannot be resolved using the methods above, please turn off the power and the angle valve, then contact service providers for maintenance.	
	If the leakage circuit breaker frequently trips, indicating electrical leakage, turn off the power and the angle valve, then contact the service provider for maintenance.	

REMOTE CONTROL OPERATION:

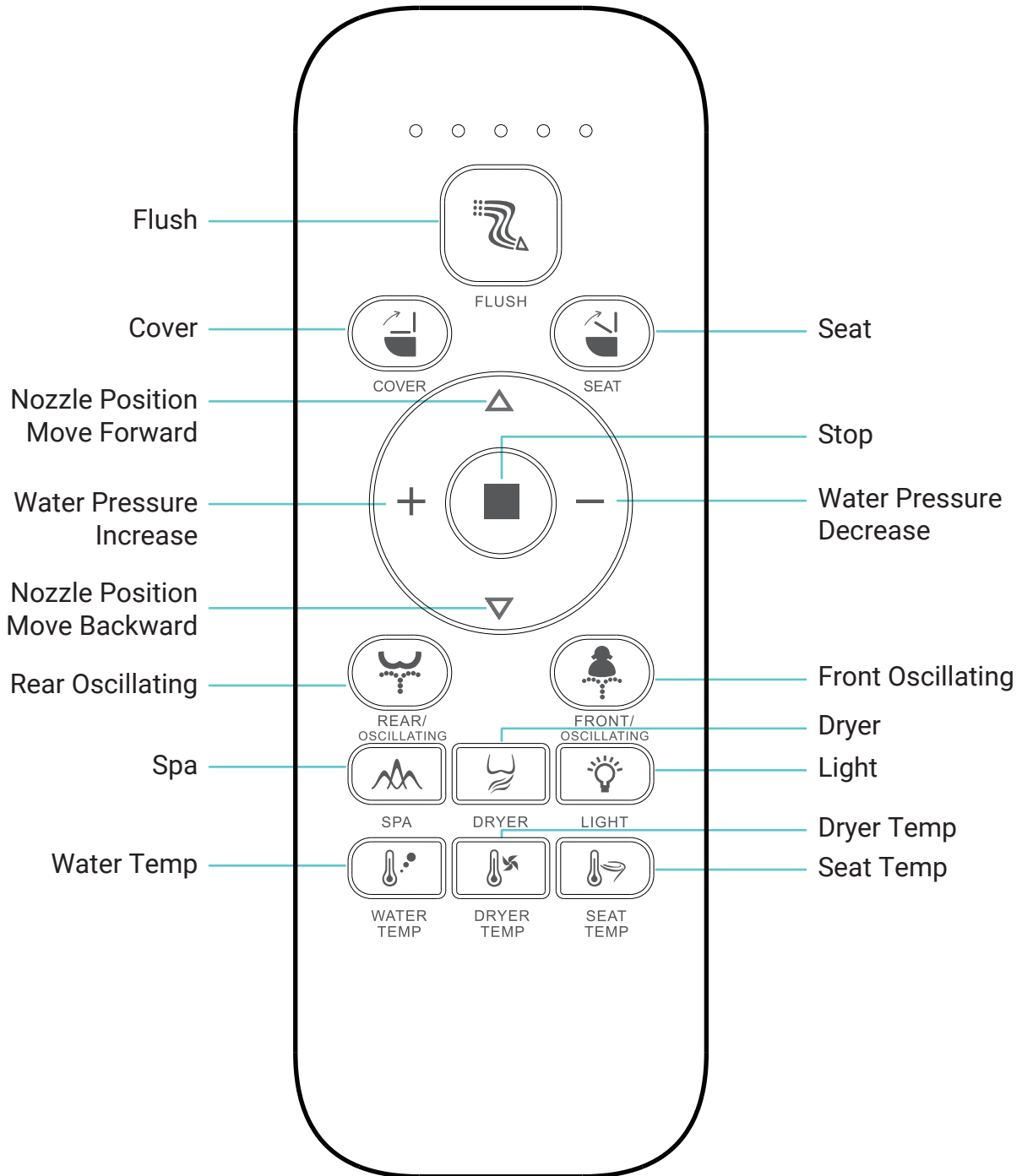

## REMOTE CONTROL FUNCTIONS:



### Rear Wash/Oscillating

Rotate the control knob to the "REAR WASH" mode, or press the "REAR" button on the remote control. The water spray from the rear nozzle will start. Press the button again to activate the "OSCILLATING" mode, in which the washing area is expanded, and the water moves forward and backward. The washing function will automatically cease after 2 minutes.



### Front Wash/ Oscillating

Rotate the control knob to the "FRONT WASH" mode, or press the "FRONT" button on the remote control. Activation of the water spray from the front outlet of the wand will occur. Press the button again to activate the "OSCILLATING" mode, in which the washing area is expanded, and the water moves in a forward and backward motion. The washing function will automatically cease after 2 minutes.



### Warm Air Dryer

The warm air dryer should be used after cleansing. Press and hold the knob for 3 seconds or press the "DRYER" button to activate the warm air dryer. The warm air dryer feature will automatically shut off after 3 minutes.



### Flushing By Remote Control

Press the "FLUSH" button to manually flush the toilet. Press the "FLUSH" button twice quickly to initiate a low-volume water flush.



### Water Temperature

Press the "WATER TEMP" button to adjust the cleaning water temperature. Press once to display the current temperature. Press again to adjust to the desired level. There are 4 levels of water temperature (close/around 93°F- 104°F).



### Warm Air Temperature

Press the "DRYER TEMP" button to adjust the air dryer temperature. Press once to display the current temperature. Press again to adjust to the desired level. There are 4 levels of air temperature (close/around 122°F- 140°F).



### Seat Temperature

Press the "SEAT TEMP" button to adjust the seat temperature. Press once to display the current temperature. Press again to adjust to the desired level.

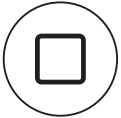

### Stop

Press the "STOP" button to terminate the function of "REAR/FRONT /DRYER".



### Auto Open/ Close Lid (only apply to model with the automatically lid open feature)

Press the "COVER" button on the remote control to open/ close lid.



### Auto Open/ Close Seat (only apply to model with the automatically lid open feature)

Press the "SEAT" button on the remote control to open/close seat.



### Hot And Cold Water Massage

Press the "SPA" button briefly during the cleansing feature to activate the massage, which alternates hot and cold water. Press the "STOP" button to terminate all features.



### Pulsate Massage

Press and hold the "SPA" button for 3 seconds during the cleansing feature to activate the pulsate massage, with water pressure changing alternately. Press the "STOP" button to terminate all features.



## Turn on/ off night lights and Atmosphere light

When approaching the toilet, the night light will turn on automatically when the cover opens. Press the "**LIGHT**" button on the remote control to turn on and off the night light and Atmosphere light.

Press and hold "light" button to enter ambient light programming.

To switch between options **1** through **9** you must long press the "light" button each time.

For example, one long press switches to setting **1**, a second long press will switch to setting **2**. When you find the desired light mode, short press the "**Light**" button and the selected mode will remain on.

- **0 = off.** Only the night light inside bowl will operate when pressing "light" button
- **1= Rainbow effect.** The LED trim will glow in a rainbow sequence permanently.
- **2 = pulsating light rotation.** The LED trim will glow slowing off and on as it rotates through the preset colors
- **3 to 9 = fixed colors.** The LED trim will glow one solid color.

## THREE-YEAR LIMITED WARRANTY

Swiss Madison® products are made with quality materials and excellent craftsmanship to provide our customers with beautiful, durable, long-lasting products. Should there be any defects in materials or craftsmanship under regular use that are discovered within the first year after delivery, Swiss Madison® will provide replacement parts at no charge, or at its discretion, replace any product or part of the product that is deemed defective, under normal installation, use, service or maintenance. This warranty applies only to the original purchaser. Proof of purchase must be submitted with any warranty claim.

Swiss Madison® recommends that all installations of Swiss Madison® products to be conducted by a licensed plumber or contractor. Swiss Madison® will not be held responsible for any damage or product failure due to improper installation, misuse, or failure to utilize a licensed plumber or contractor for installation. Swiss Madison® is not responsible for any installation or removal costs.

### THIS THREE-YEAR LIMITED WARRANTY WILL BE VOIDED IF:

- The installation instructions were not followed by the installer
- The product has been moved from its initial place of installation
- The product has in any way been modified from its original condition
- The product has been subjected to improper maintenance, abuse, misuse, excessive use of chemicals, accidents, or other damages

Swiss Madison® makes no warranty that its products comply with any local building or plumbing codes. It is the consumer's responsibility and obligation to determine local code compliance prior to and during installation.

Swiss Madison® is not responsible for any special, incidental or consequential damages associated with the installation, replacement, return or use of the original purchaser's product. This includes, but is not limited to: freight costs, labor, travel time, lost profit, home damages and other contingent liabilities and costs (including, without limitation, costs associated with 'professionals' or 'experts', investigations, audits, analyses, attorneys and any other professional/hired services). Some states do not allow the exclusion or limitation of incidental or consequential damages, so the above limitation or exclusion may not apply to you.

The Swiss Madison® warranty is a comprehensive and explicit limit of liability. All other warranties are hereby disclaimed and waived.

**QUESTIONS OR CONCERNS?** Please contact us directly at: 1-434-MADISON (623-4766)



### **WARNING:**

Contents of your order may contain sharp and possibly other harmful pieces and may cause hazard to children and adults. Swiss Madison® is not responsible in any way for personal injuries or damages.