



ELR-12511

Peek-a-Boo Caterpillar

For assistance or replacement parts please contact:

ECR4Kids, LP
2245 San Diego Ave, #125
San Diego, CA 92110

Date Code on Carton: _____

Model #: _____

Date of Purchase: _____



SAVE THIS DOCUMENT FOR FUTURE REFERENCE

INTENDED FOR USE BY CHILDREN FROM AGES 2 – 6 YEARS.

MAXIMUM FALL HEIGHT FOR THIS PRODUCT IS 23 INCHES.

OBSERVE ALL STATEMENTS AND WARNINGS TO REDUCE THE LIKELIHOOD OF SERIOUS OR FATAL INJURY.

THIS CONFORMS TO ASTM F1148, CONSUMER SAFETY PERFORMANCE SPECIFICATION FOR HOME PLAYGROUND EQUIPMENT.



WARNING:

CHOKING HAZARD

· Small parts. Sharp points. Adult assembly required.



WARNING:

SERIOUS HEAD INJURY OR DEATH CAN OCCUR.

· Falls to a hard surface can result in serious injury or death.
· Do not install playground equipment over hard surfaces such as concrete asphalt, packed earth, grass, carpet or any other hard surface. Adult supervision required.



WARNING:

BURN HAZARD

· Always check the temperature of the product before letting your children play with it.
· Remember that the product may cause burns if left in direct sunlight.
· Always be aware of the sun and weather conditions, and do not assume that the equipment is safe because the air temperature is not very high.



WARNING:

STRANGULATION HAZARD

Serious injury or death can occur.

DO NOT:

Attach jump ropes, clothes lines, pet leashes or other loose hanging items not specifically designed for use with this equipment.

Allow children to wear scarves, mittens with cords through the sleeves, or clothing such as capes, ponchos, or items with drawstrings at the neck.

Allow children to wear helmets while playing on equipment.

Allow children to wear items around their necks such as necklaces, canteens, backpacks, handbags and binoculars.

SAFETY INFORMATION:

1. Create an obstacle-free site to reduce injury. Maintain a minimum distance of 6 feet (2 m) from structures or obstructions. Examples: a fence, buildings, garages, houses, low hanging branches, tree stumps/roots, large rocks, bricks, concrete, laundry lines, or electrical wires.
2. Choose a level location for the equipment to reduce the likelihood of the play set tipping over and loose fill surfacing materials from washing away during heavy rains.
3. Check to be sure all connections are tight. **DO NOT** allow children to play on the product until it is fully assembled.

OPERATION INSTRUCTIONS:

MAXIMUM NUMBER OF OCCUPANTS 6

MAXIMUM WEIGHT CAPACITY 300 LBS

PROVIDE ADULT SUPERVISION AT ALL TIMES.

Instruct children to:

1. Not use the equipment in a manner other than intended.
2. Not to climb on equipment when it is snow-covered or wet.
3. Dress appropriately, including wearing well-fitting shoes that fully protect feet. Do not to allow children to wear inappropriate items, such as but not limited to, loose fitting clothing, hood and neck drawstrings, scarves, cord-connected items, capes and ponchos. These items can cause death by strangulation.
4. Not to attach items to the playground equipment that are not specifically designed for use with the equipment, examples: jump rope, clothes lines, pet leashes, cables or chains.
5. Remove bike or other sports helmet before playing on the equipment.
6. Not to use this product when temperatures fall below 32°F (0°C). Plastic materials may become brittle and crack, creating an unsafe condition.

MAINTENANCE:

1. Check twice a month during play season. Tighten all hardware and replace worn or damaged components. Contact ECR4Kids for replacement parts.
2. Rake and check the depth of loose fill protective surfacing materials to prevent compaction and to maintain appropriate depth. Replace as necessary.
3. Take indoors or do not use when the temperature drops below 32°F (0°C).
4. Owners shall be responsible for maintaining the legibility of the warning labels and for children removing the warning label from the product.

DISPOSAL INSTRUCTIONS:

Disassemble so that no unreasonable hazards exist. Please recycle when possible. Disposal must be in compliance with all government regulations.

COLORS:
COLORES:
COLEURS:

B: blue, azul, bleu
R: red, rojo, rouge
G: green, verde, vert
O: orange, naranja, orange

A



1x

B

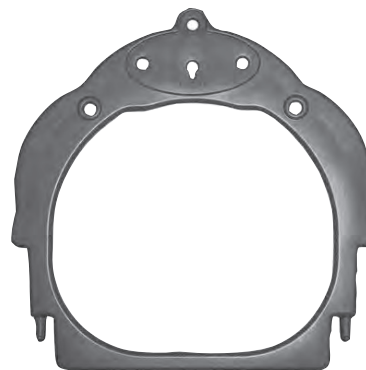

1x

C



1x

D



4x

E



14x
4x-O
4x-G
4x-R
2x-B

F

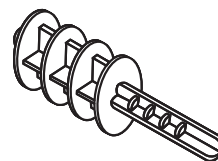

1x

G



3x

H



3x

I



15x

J



1x

K



4x

L



4x

M

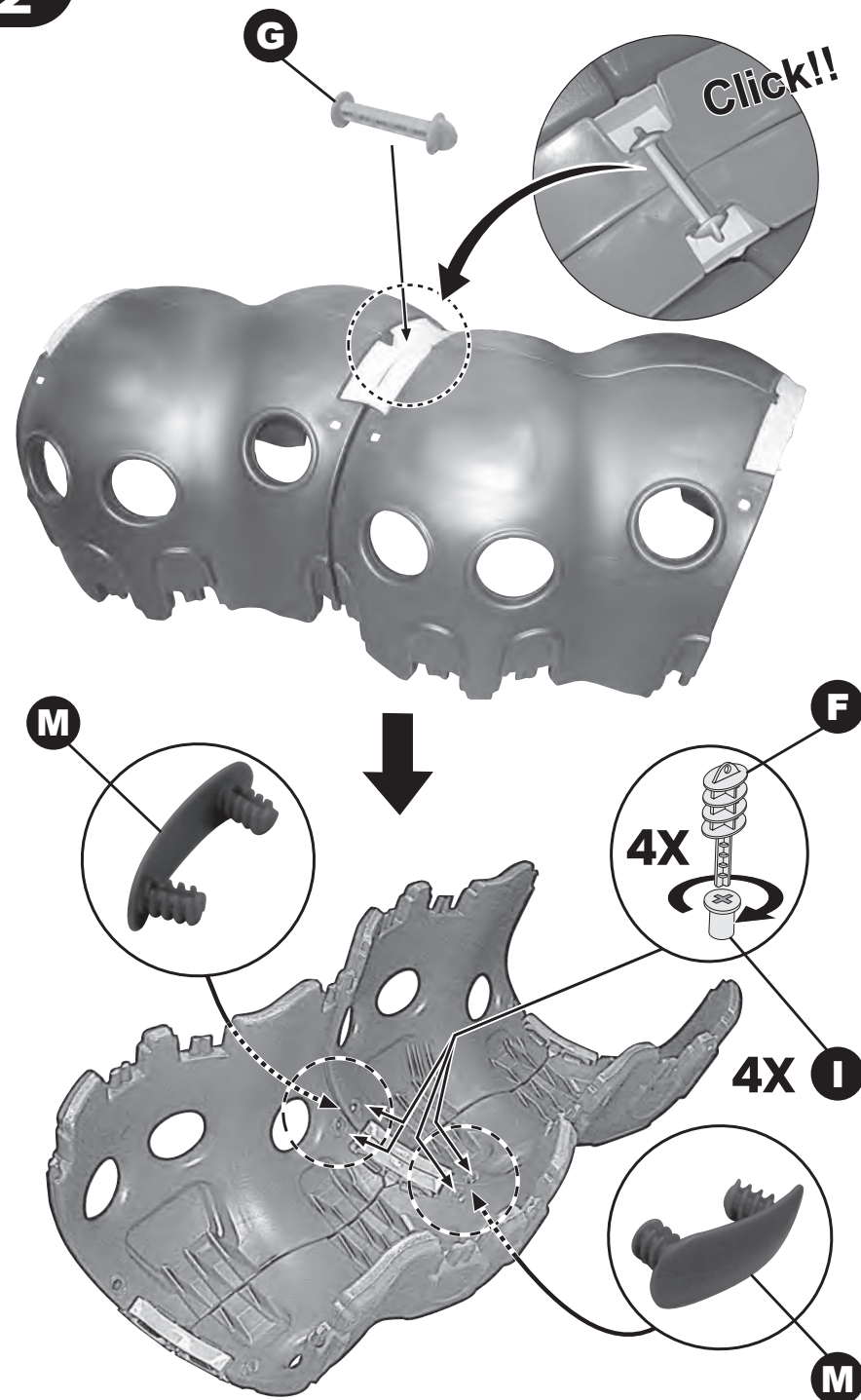

2x

1**2X****2**

3

L

L

I

F

2X

4

G

F

I

C

Click!!

5

G

F

I

B

Click!!

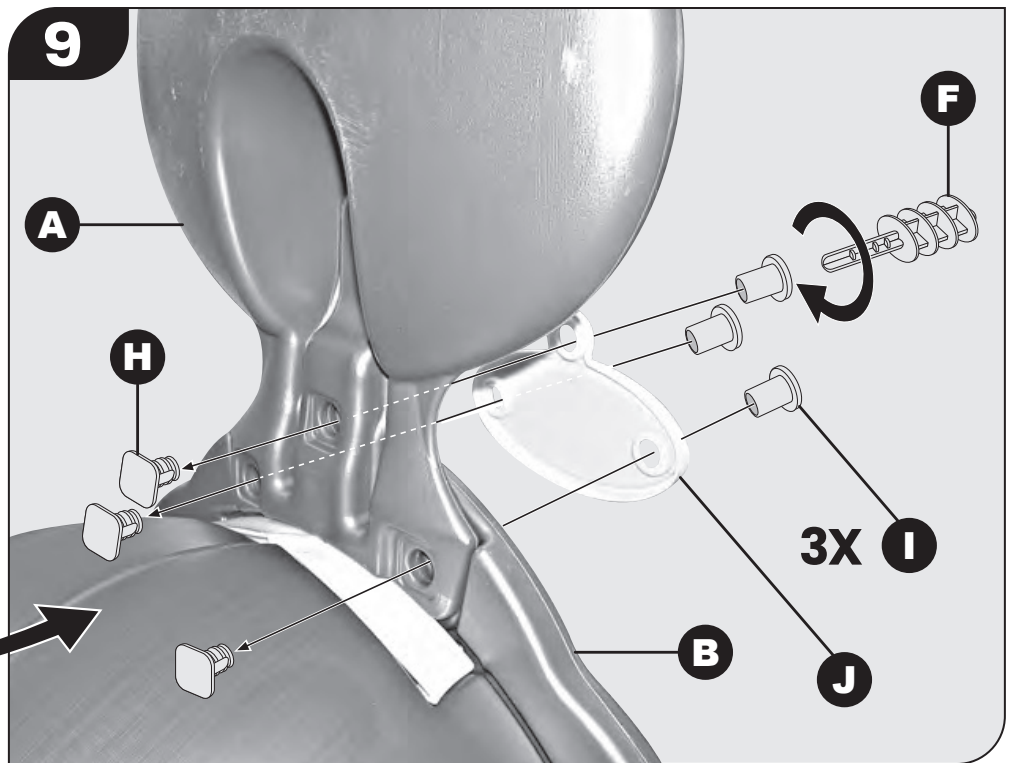
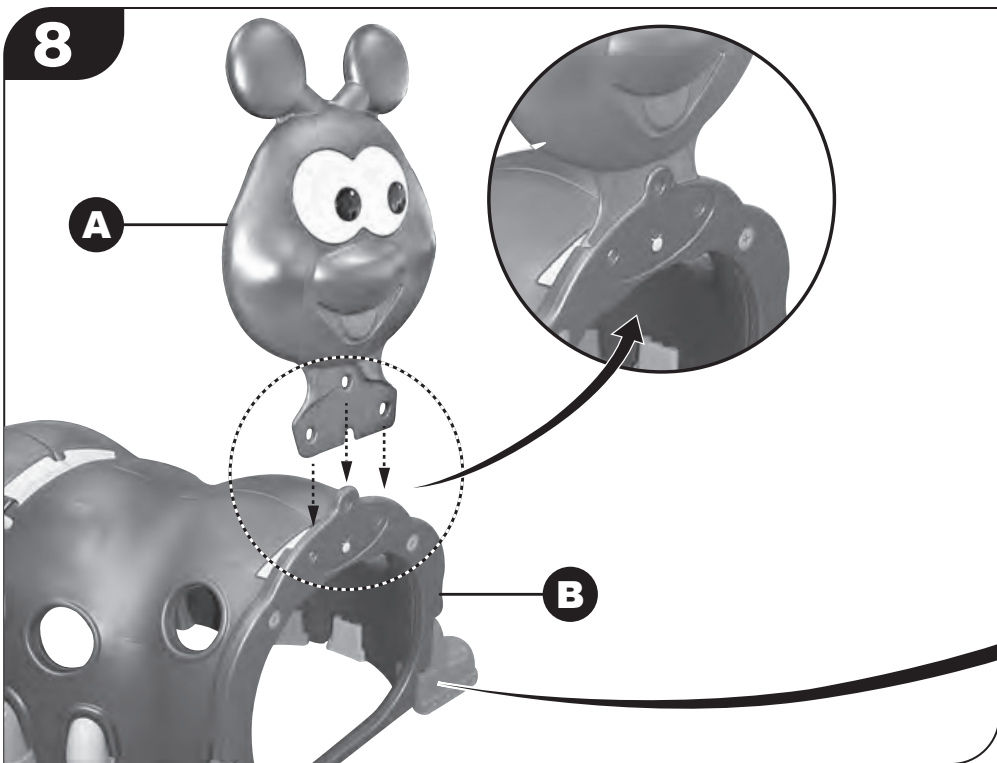
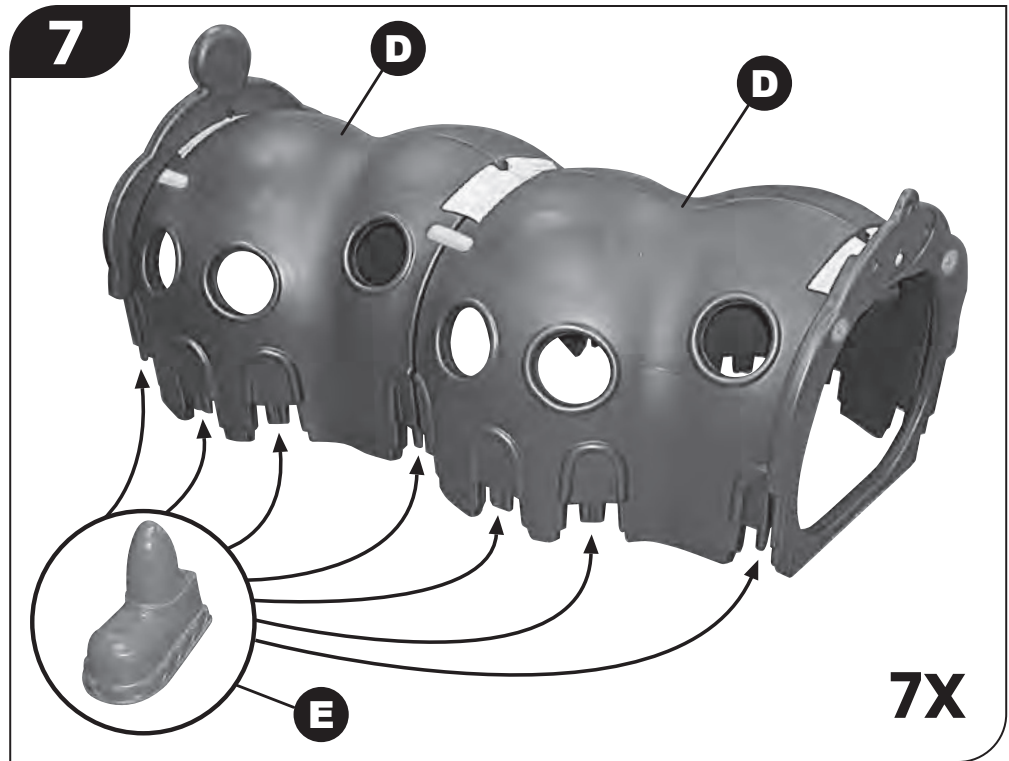
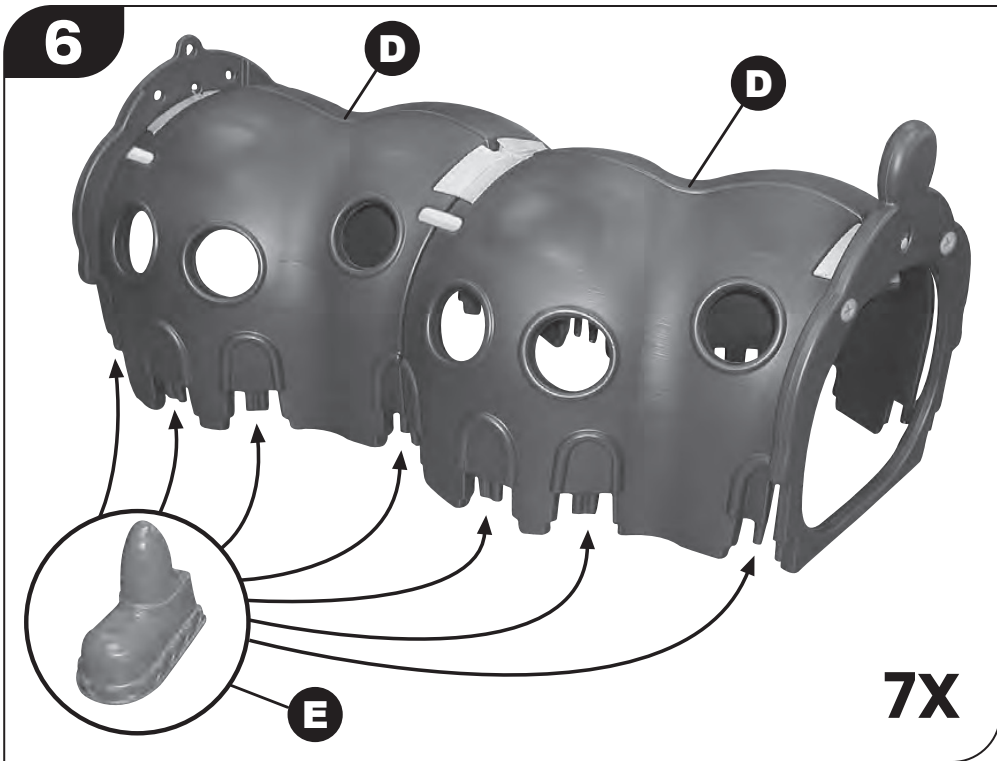

WARNING LABEL APPLICATION:

Clean and dry area thoroughly. Placement on back of front/head.
Apply pressure from center to outer edge.

⚠ WARNING:

RISK OF SERIOUS HEAD INJURY OR DEATH DUE TO FALLS
FROM EQUIPMENT PLACED OVER HARD SURFACES.
THIS PRODUCT IS INTENDED FOR USE BY CHILDREN FROM
AGES 3 TO 6.

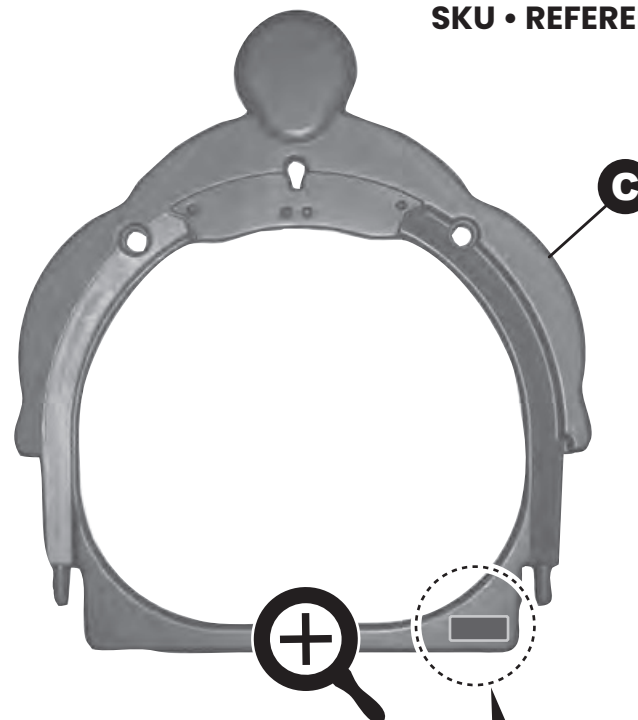
SKU • REFERENCIA • RÉFÉRENCE

SKU - Referencia - Référence