

## MULTICOLOR USB GLOW CHARGER USB SWIVEL WALL TAP

**TR14A42U  
GT400PUWH**

### USER GUIDE

#### SAVE THESE INSTRUCTIONS

Please read this user guide and follow the instructions for installation and use.

#### Package contents

- USB Glow Charger
- USB Swivel Wall Tap
- Power Adapter w/ 5ft Power Cord
- User Guide

#### USB GLOW CHARGER

##### Specifications

|                       |                   |
|-----------------------|-------------------|
| Product               | USB Glow Charger  |
| Input                 | DC Power Jack     |
| Output                | 5V/4.2Amp (total) |
| Dimensions            | 2.6*2.6*1.6 in    |
| Weight                | 66g/ 0.15lb       |
| Operation Temperature | 0 to 40 °C        |
| Storage Temperature   | -10 to 60 °C      |
| Housing               | Plastic           |

1

#### Installation & Functions

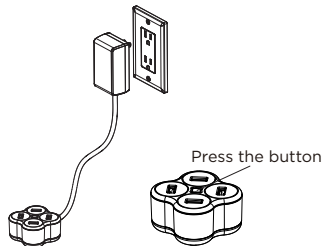

1. Connect the power cord to the USB Glow Charger and a wall socket.
2. Connect the USB cable to your mobile device and the USB Glow Charger.
3. Your devices are now being charged.
4. Press the button to turn on the glowing light. The glow LED lights that cycle through a rainbow of colors.
5. Press this button again to fix the light color to select your favorite.
6. Press this button again to activate the light to the default color cycle.
7. Long press the button to turn off the glowing light.

2

#### Caution

- Only connect or disconnect the adapter to USB Glow Charger when removed from the AC power supply.
- Only use the provided adapters. Check if the voltage indicated on the adapters and chargers matches the local voltage before connecting to the USB Glow Charger.
- Only use the USB Glow Charger in an upright position.
- Always remove the plug from the cord when the USB Glow Charger is not being used.
- Never open the casing of the USB Glow Charger to prevent electric shock.

#### USB SWIVEL WALL TAP

##### Specifications

|                       |   |
|-----------------------|---|
| Product               | USB Swivel Wall Tap                         |
| Input                 | AC 125Vac/15A (total)                       |
| Output                | Outlet- 125Vac/15A<br>USB-5V/4.2Amp (total) |
| Dimensions            | 2.17*4.02*5.35 in                           |
| Weight                | 272.16g/ 0.6lb                              |
| Operation Temperature | 0 to 35 °C                                  |
| Storage Temperature   | -15 to 45 °C                                |
| Housing               | Plastic                                     |

3

## Installation

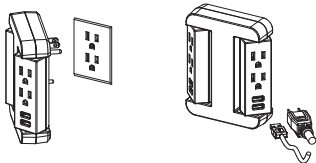

1. Plug the USB Swivel Wall Tap into a standard grounding wall receptacle by fully inserting the plug and ensure that there are no exposed conductors.
2. Make sure electronic equipment is turned off before plugging into the USB Swivel Wall Tap outlets. Do not use extension cords to connect equipment to the USB Swivel Wall Tap.
3. Connected equipment can now be turned on.

## Caution

- TO REDUCE THE RISK OF ELECTRIC SHOCK - Use only in dry locations and only indoors. DO NOT plug into another relocatable power tap.
- DO NOT "daisy chain" USB Swivel Wall Taps.
- DO NOT use with any aquarium equipment.
- DO NOT use if properly grounded outlets are not available.
- DO NOT install this device if there is not at least 10 meters (30 feet) or more of wire between the electrical outlet and electrical service panel.
- DO NOT plug devices over 2.4A for each USB ports.

## One-Year Limited Product Warranty

CyberPower warrants this Charging Station to be free from defect in material or manufacture for one year. If a defect results in product failure during its normal use, CyberPower's sole responsibility is to repair or replace (at its sole option) the charging station. The foregoing limited warranty is the consumer's sole and exclusive remedy and excludes any incidental or consequential damages. Some states do not allow the exclusion or limitation of incidental and consequential damages, so certain of the above limitations or exclusions may not apply to you (the Consumer). This limited warranty gives specific legal rights; the consumer may have other rights which vary from state to state. To make a limited warranty claim:

1. Pack and ship the charging station with a dated Proof-of-Purchase receipt to CyberPower at 4241 12th Ave E., STE 400, Shakopee, MN 55379.
2. Clearly indicate on the outside of the packaging that this is a WARRANTY RETURN.
3. Clearly include your name and address
  - (a) On the outside packaging and
  - (b) On a sheet of paper enclosed in the box with the charging station that is being returned.
4. You MUST prepay all shipping costs and you are responsible for packaging and shipment.

CyberPower will inspect and examine the charging station. If the charging station is defective in material or workmanship, CyberPower will repair or replace it and return it to you at CyberPower's expense at the place you have indicated. Feel free to contact our Tech Support department with installation, troubleshooting, or general product questions.

## CyberPower Technical Support

Phone: 1-877-297-6937

Email: [tech@cpswww.com](mailto:tech@cpswww.com)

Web: [www.cyberpowersystems.com](http://www.cyberpowersystems.com)

Address: 4241 12th Ave. E., STE 400, Shakopee, MN 55379

Hours of Operation: Monday - Friday,  
7:00am - 6:00pm (CST)

## Conformance Approvals

**This device complies with part 15 of the FCC Rules. Operation is subject to the following two conditions: (1) This device may not cause harmful interference, and (2) this device must accept any interference received, including interference that may cause undesired operation.**

This equipment has been tested and found to comply with the limits for a Class B digital device, pursuant to Part 15 of the FCC Rules. These limits are designed to provide reasonable protection against harmful interference in a residential installation. This equipment generates uses and can radiate radio frequency energy and, if not installed and used in accordance with the instructions, may cause harmful interference to radio communications. However, there is no guarantee that interference will not occur in a particular installation. If this equipment does cause harmful interference to radio or television reception, which can be determined by turning the equipment off and on, the user is encouraged to try to correct the interference by one or more of the following measures:

- Reorient or relocate the receiving antenna.
- Increase the separation between the equipment and receiver.
- Connect the equipment into an outlet on a circuit different from that to which the receiver is connected.
- Consult the dealer or an experienced radio/TV technician for help.

**Warning: Changes or modifications to this unit not expressly approved by the party responsible for compliance could void the user's authority to operate the equipment.**

**Cyber Power Systems (USA), Inc.**

[www.cyberpowersystems.com](http://www.cyberpowersystems.com)