

INDY

900972FMB-NWA

INDY 72" FAN

| DETAILS | |
|---------------|-------------|
| FAN FINISH: | Matte Black |
| BLADE COUNT: | 3 |
| SLOPE DEGREE: | 20 |

| DIMENSIONS | |
|------------|-------|
| WIDTH: | 72" |
| HEIGHT: | 13.3" |

| LIGHT SOURCE | |
|--------------|------|
| VOLTAGE: | 120v |

| MOUNTING | |
|------------|---------|
| CANOPY: | 6" Dia. |
| LEAD WIRE: | 1 X 76" |

| SHIPPING | |
|----------------|------|
| CARTON LENGTH: | 34.5 |
| CARTON WIDTH: | 11 |
| CARTON HEIGHT: | 10.5 |

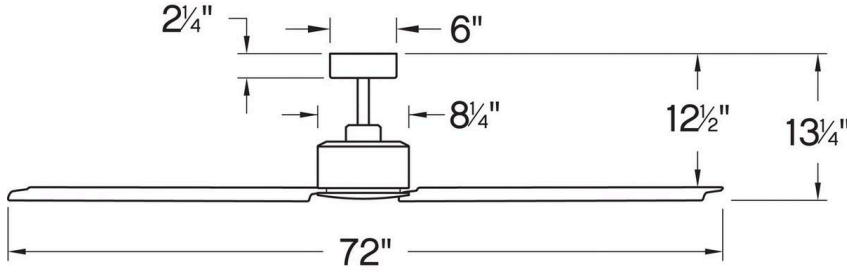

The raw, edgy style of Indy is the perfect complement for all modern industrial design-inspired rooms. Available in classic finishes with sleek coordinating blades, Indy is so versatile; it can be used for both indoor and outdoor spaces.

PRODUCT DETAILS:

- Can be hung on a sloped ceiling
- This item includes a 6" down rod (other lengths of down rods are available)
- Control your fan's power, light, speed, direction, and so much more from the Hinkley Home Automation app
- Fan Control included, Wall Control - 4 Speed Non-Reversing
- Motor carries a lifetime warranty
- Blades, controls, switches, capacitors and hardware carry a 1-year warranty
- Bold silhouette with dramatic details creates a modern statement
- Accessory controls are available that are compatible with your home's WiFi network

HINKLEY

HINKLEY
33000 Pin Oak Parkway
Avon Lake, OH 44012

PHONE: (440) 653-5500
Toll Free: 1 (800) 446-5539

hinkley.com

INDY 72" FAN

900972FMB-NWA

| PERFORMANCE SPECIFICATIONS | STANDARD | |
|----------------------------|------------|---------------|
| | HIGH SPEED | AVERAGE SPEED |
| Airflow | 6425 | 4465 |
| EnergyUse | 62.6 | 39 |
| EnergyCost | 18 | 11 |
| Efficiency | 103 | 115 |
| AMPS | 0.52 | 0.37 |
| RPMS | 83 | 72 |