

## Pantry

## IMPORTANT

Carefully remove all the parts from the carton and place them individually on a soft cloth to prevent scratches or other damage.

Carefully and strictly follow these assembly instructions to ensure a completed product as designed.

Do not use power tools above 8 volts to assemble.

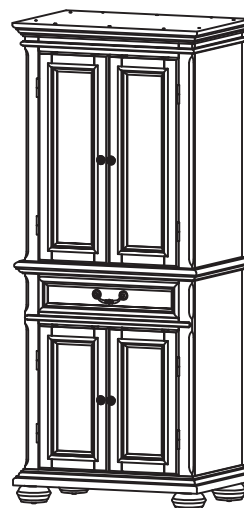

## Part List

A.  
Top  
1 pc.

B.  
Side Panel  
1 pc.

C.  
Side Panel  
1 pc.

D.  
Front Rail  
1 pc.

E.  
Shelf  
2 pcs.

G.  
Back Rail  
1 pc.

F.  
Back Rail  
1 pc.

I.  
Back Panel  
2 pcs.

H.  
Back  
Upright  
1 pc.

J.  
Door  
1 pc.

K.  
Door  
1 pc.

Carton 5528-652 is also needed for assembly.

Tool(s) required for assembly: Phillips screwdriver, Level, Pencil, Drill (8 volts or less), 3/8" Drill Bit

Home Styles Customer Service: [www.homestyles-furniture.com](http://www.homestyles-furniture.com),  
[servicedesk@homestyles-furniture.com](mailto:servicedesk@homestyles-furniture.com), 888-680-7460, 877-831-0319

## Assembly Instructions 2/14

### IMPORTANT

- Use a soft cloth between these parts and the floor.
- Do not use power tools above 8 volts to assemble.
- Do not tighten all the bolts until each part is properly assembled.
- The unit must be level to work properly. Use the included adjustable levelers to level.

### STEP 1

Attach Magnets to Front Rails (D) and (P) with 1/2" Round Head Screws. (See Figure 1)

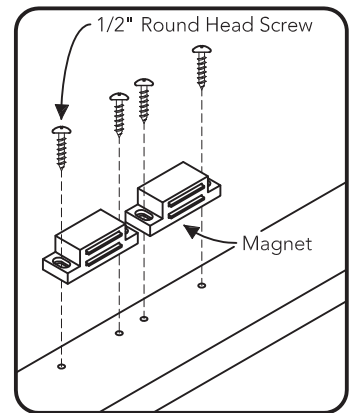
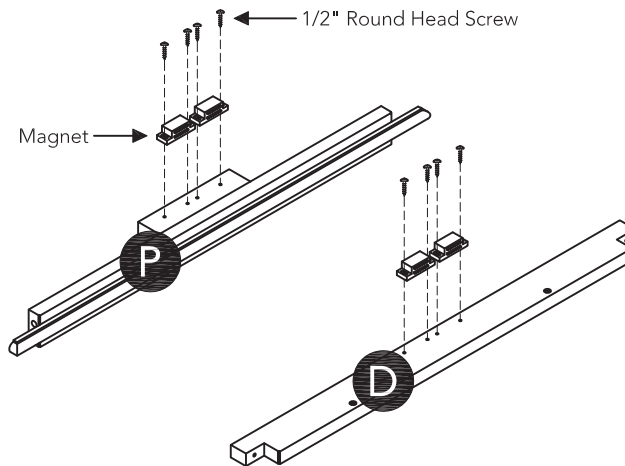
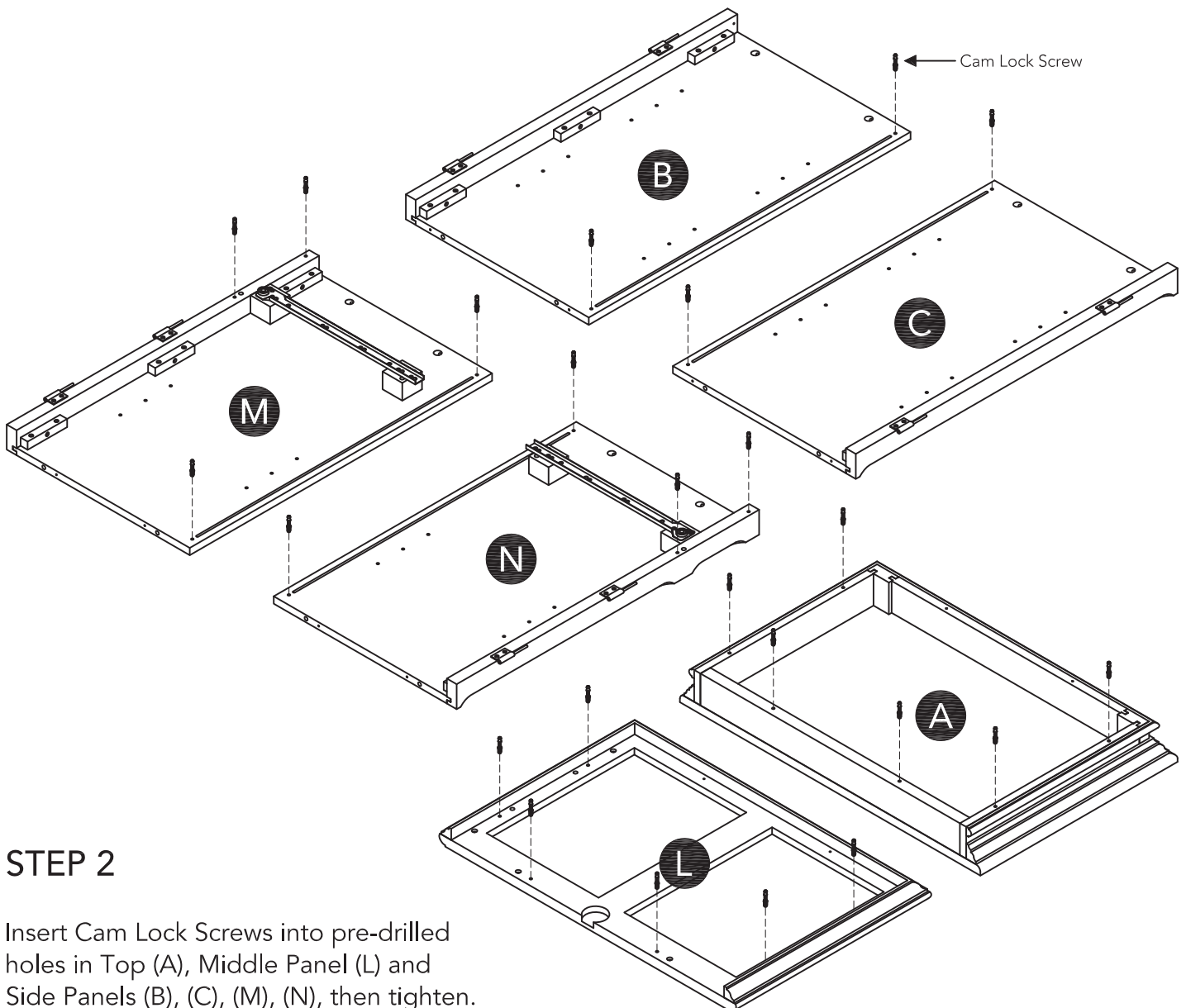

Figure 1



### STEP 2

Insert Cam Lock Screws into pre-drilled holes in Top (A), Middle Panel (L) and Side Panels (B), (C), (M), (N), then tighten.

## Assembly Instructions 3/14

### STEP 3

Attach Back Rails (F) and (G) to Back Upright (Q) with 1 1/4" Round Head Screws.

Slide Back Panels (R) into position.

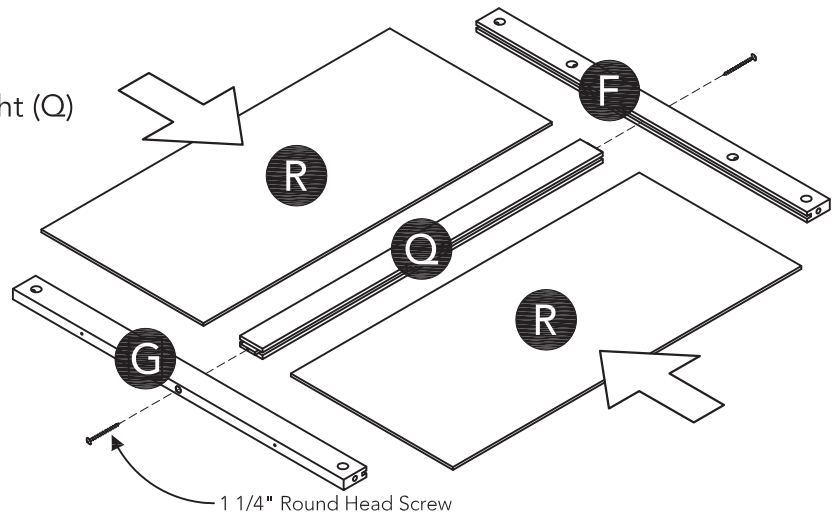

### STEP 4

Attach unit and Front Rails (O), (P) to Side Panel (M) with Cam Locks and Dowel.

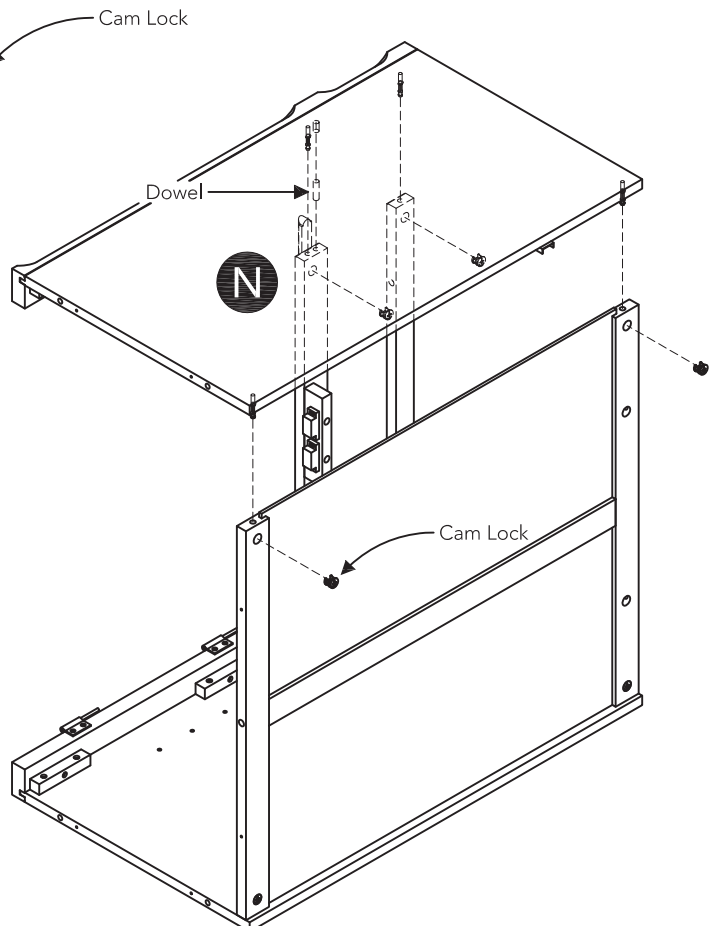
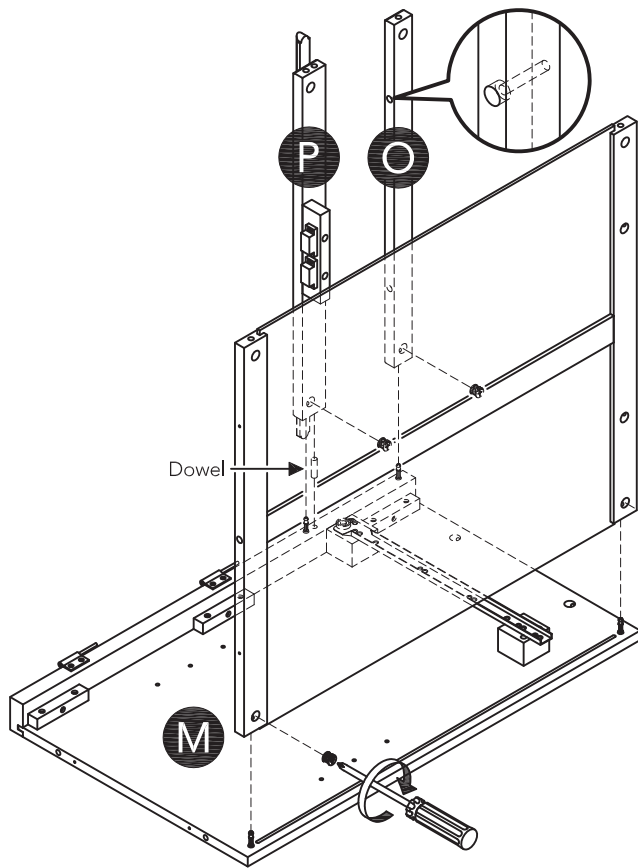

### STEP 5

Attach Side Panel (N) to unit with Cam Locks and Dowel.

## STEP 6

Attach Bottom (U) to unit with 2" Round Head Screws and Dowels.

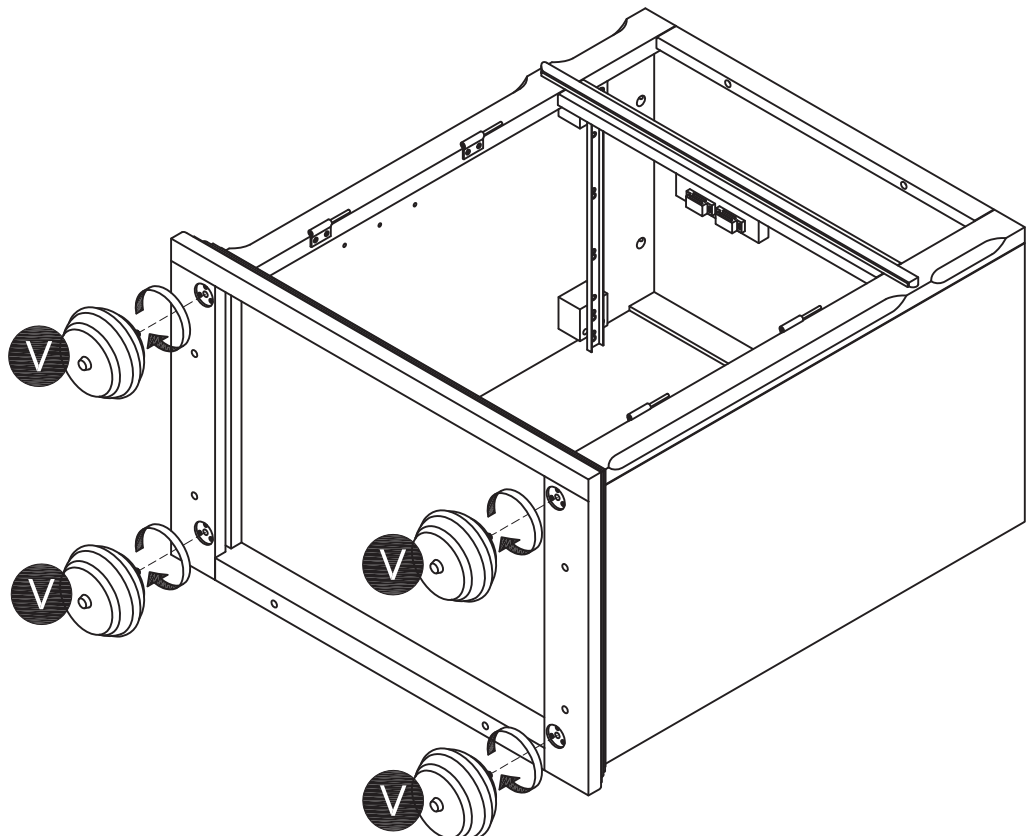
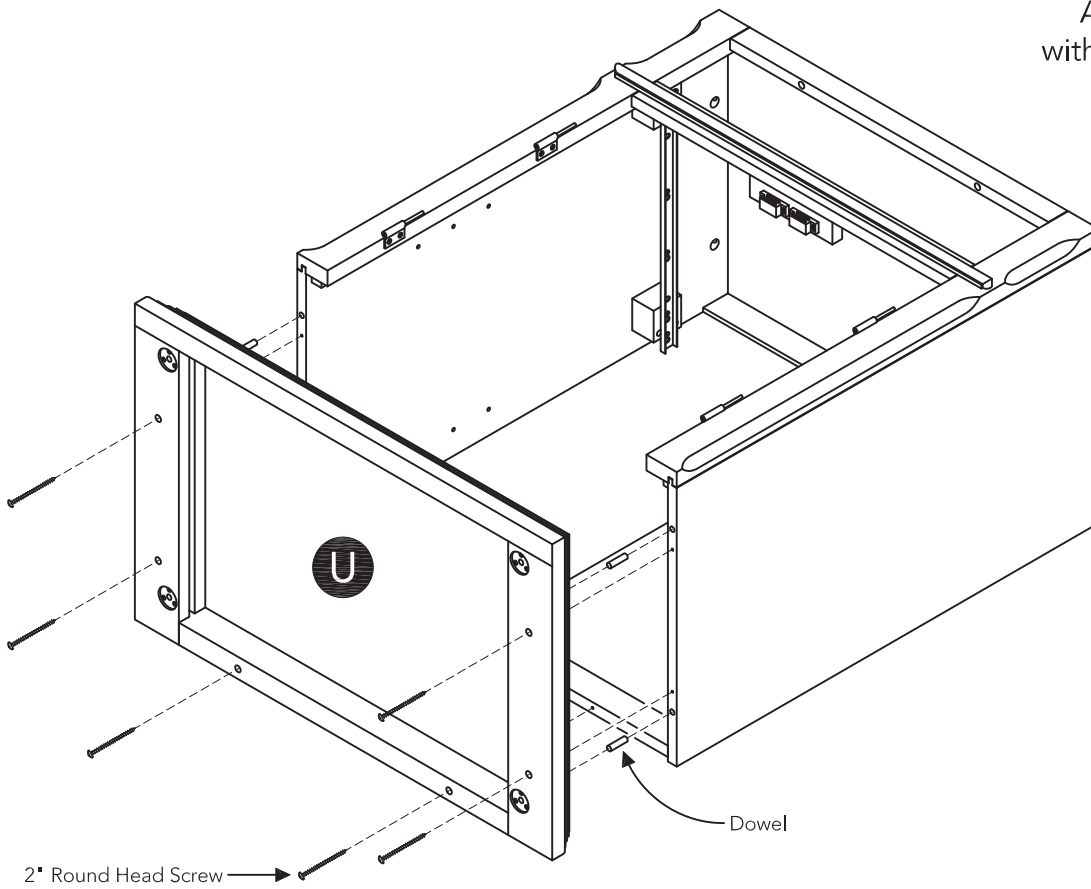

## STEP 7

Attach Feet (V) to unit.

## STEP 8

Attach Doors (S) and (T) to unit by sliding door hinges into side panel hinges.  
(See Figure 2)

Attach Knobs to Doors (S) and (T) with Machine Screws (Long).

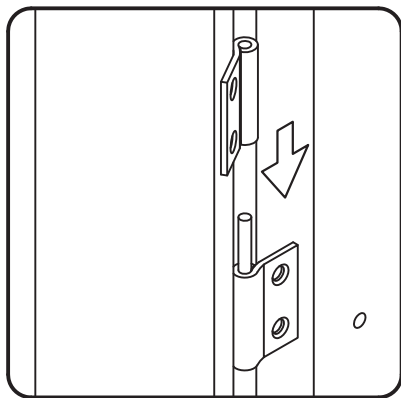
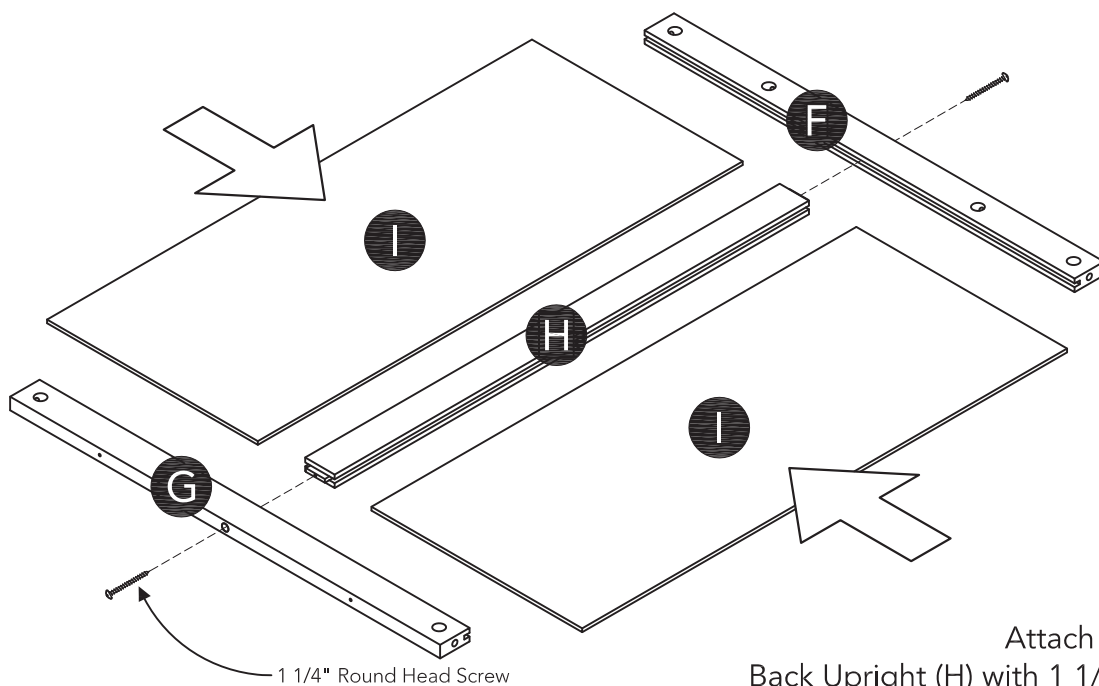
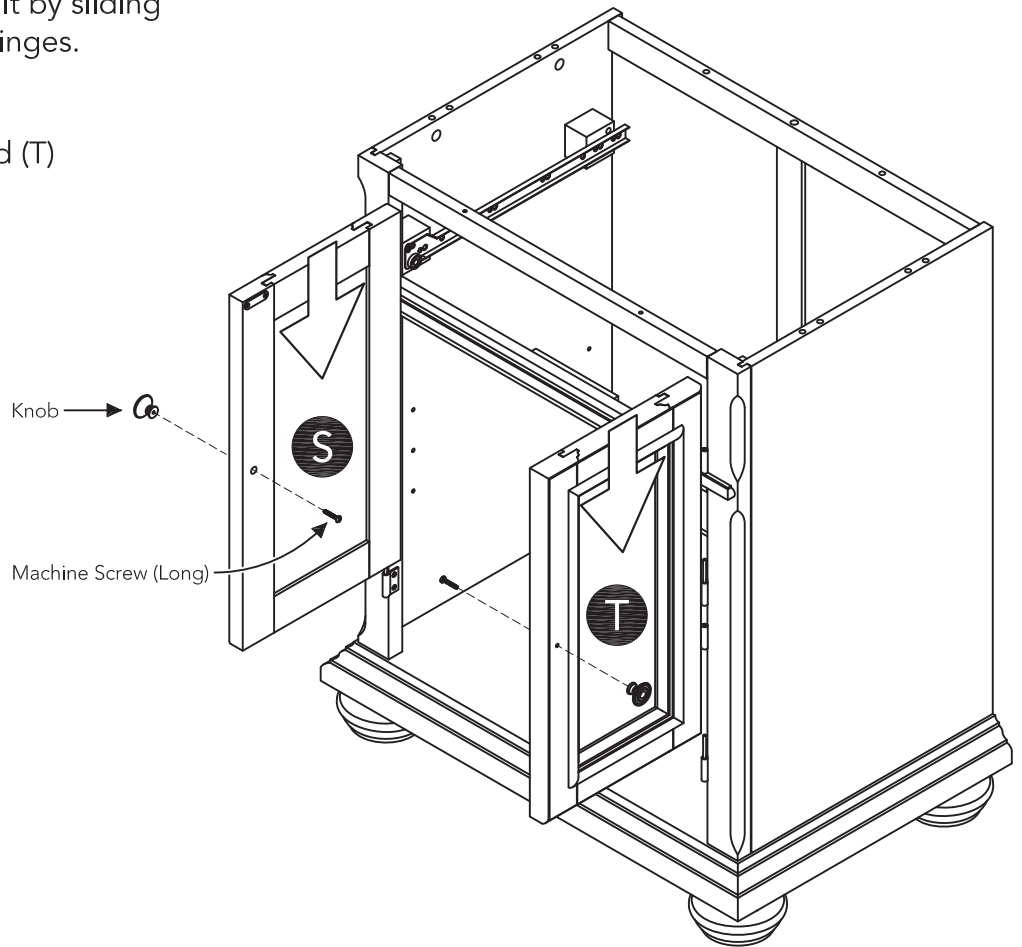

Figure 2



## STEP 9

Attach Back Rails (F) and (G) to Back Upright (H) with 1 1/4" Round Head Screws.

Slide Back Panels (I) into position.

## STEP 10

Attach unit and Front Rail (D) to Side Panel (B) with Cam Locks and 1 1/2" Round Head Screw.

Attach Side Panel (C) to unit with Cam Locks and 1 1/2" Round Head Screw.

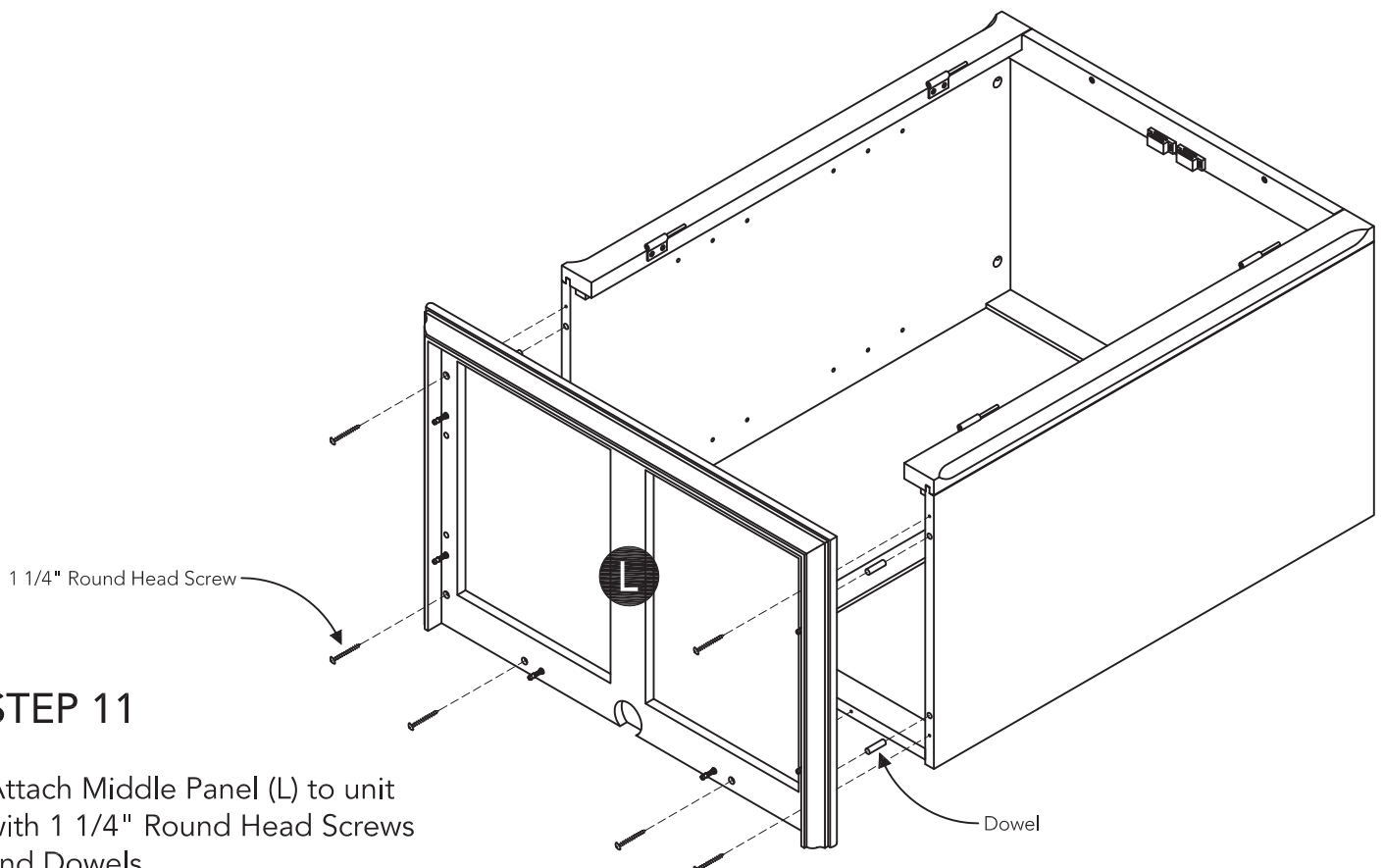
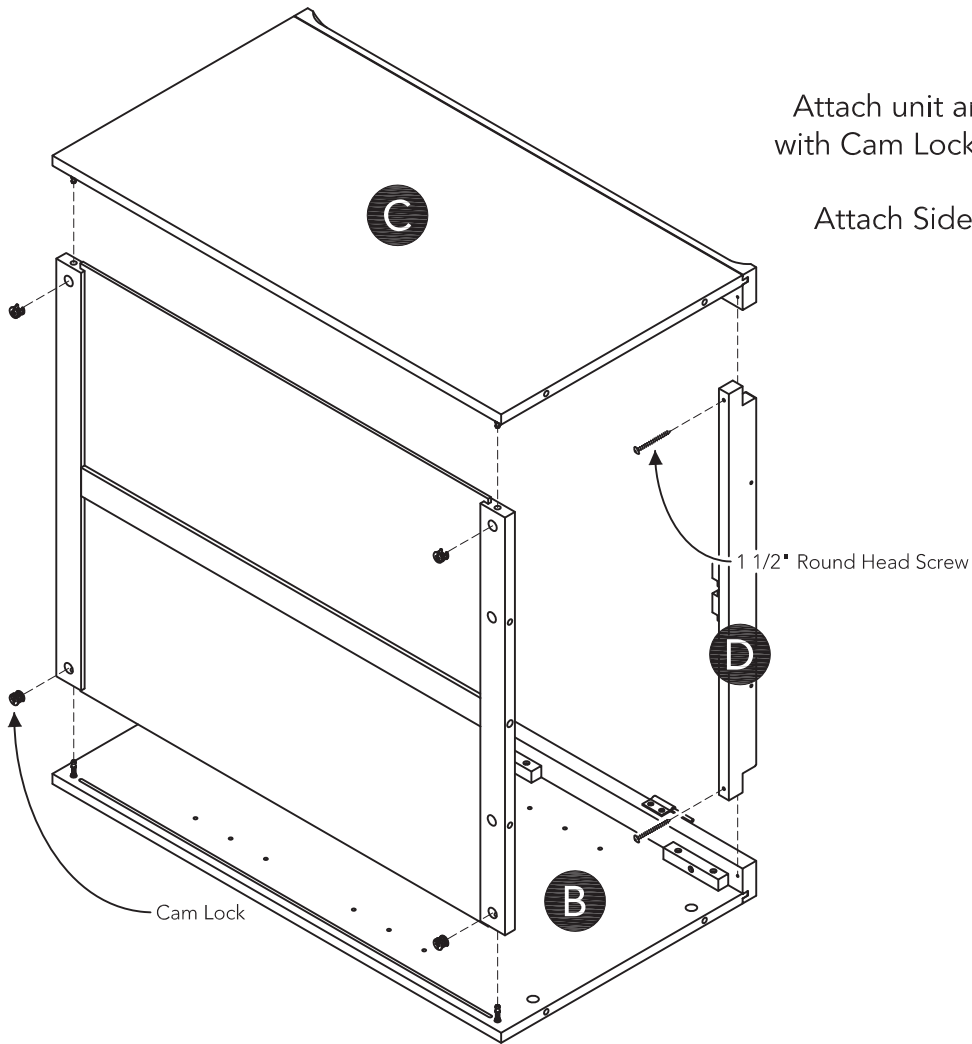

## STEP 11

Attach Middle Panel (L) to unit with 1 1/4" Round Head Screws and Dowels.

## STEP 12

Attach unit from Step 11 to unit from Step 8 with 1 1/2" Round Head Screws, Cam Locks and Dowels. (See Figure 3)

Note: A Phillips screwdriver 5" or less in length is recommended.

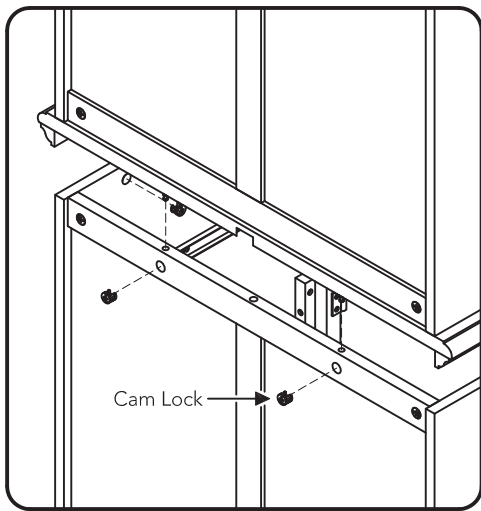
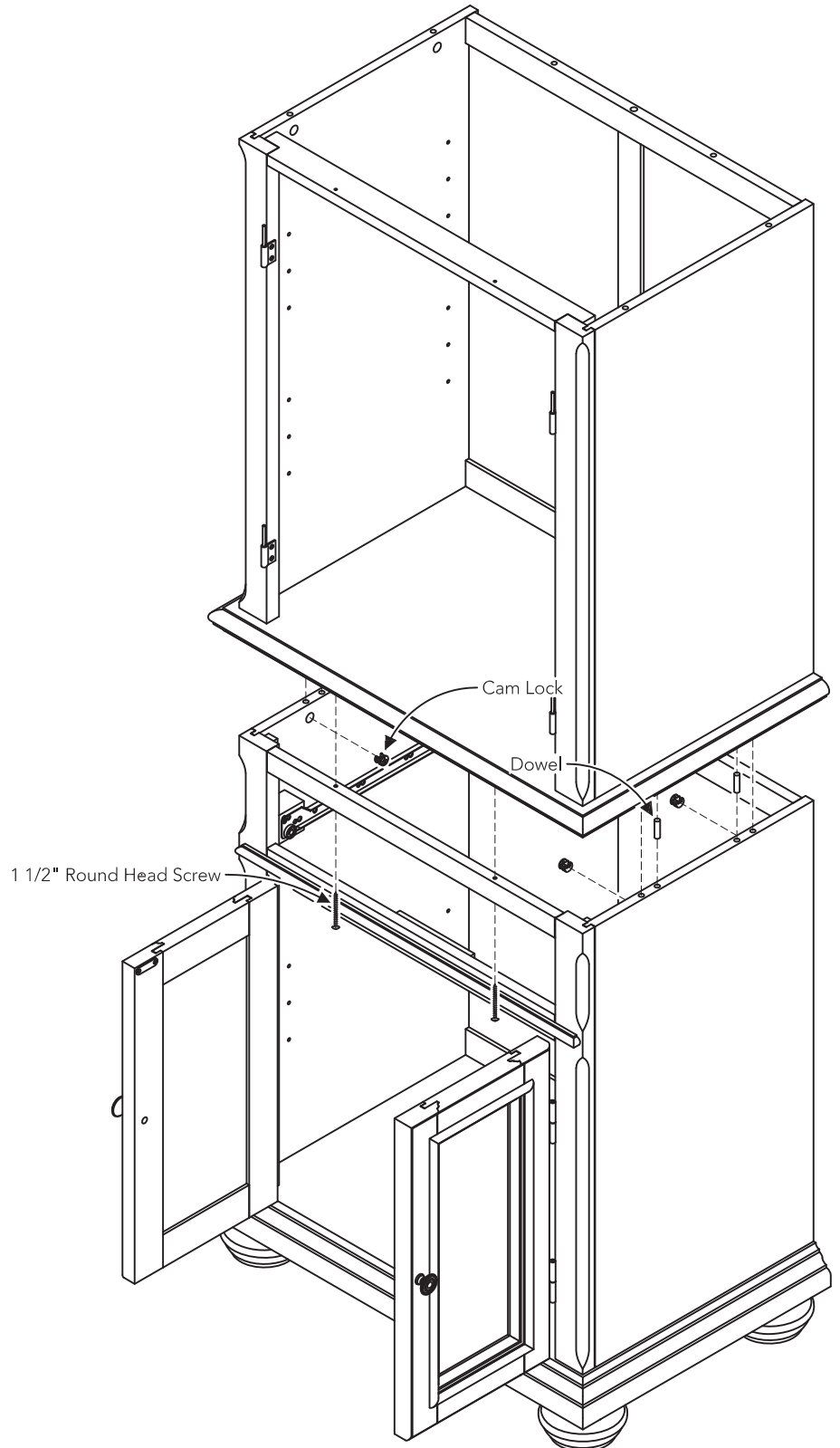

Figure 3



## STEP 13

Attach Doors (J) and (K) to unit by sliding door hinges into side panel hinges.

Attach Knobs to Doors (J) and (K) with Machine Screws (Long).

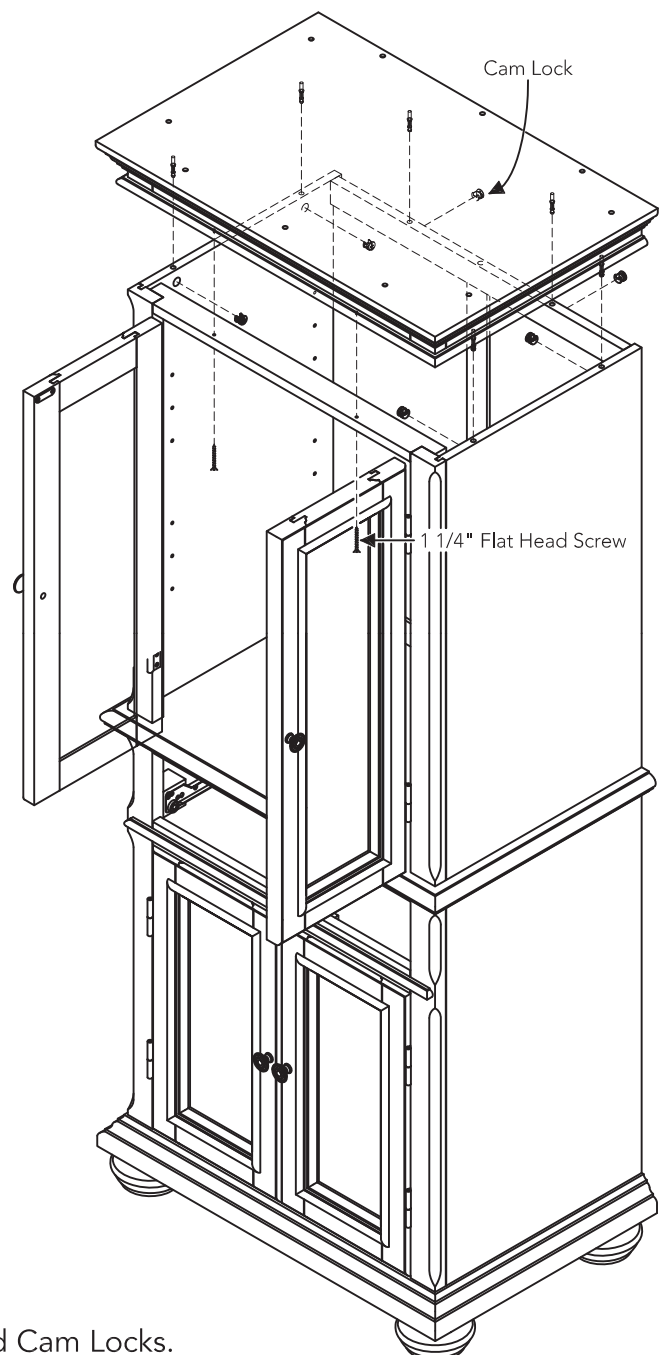
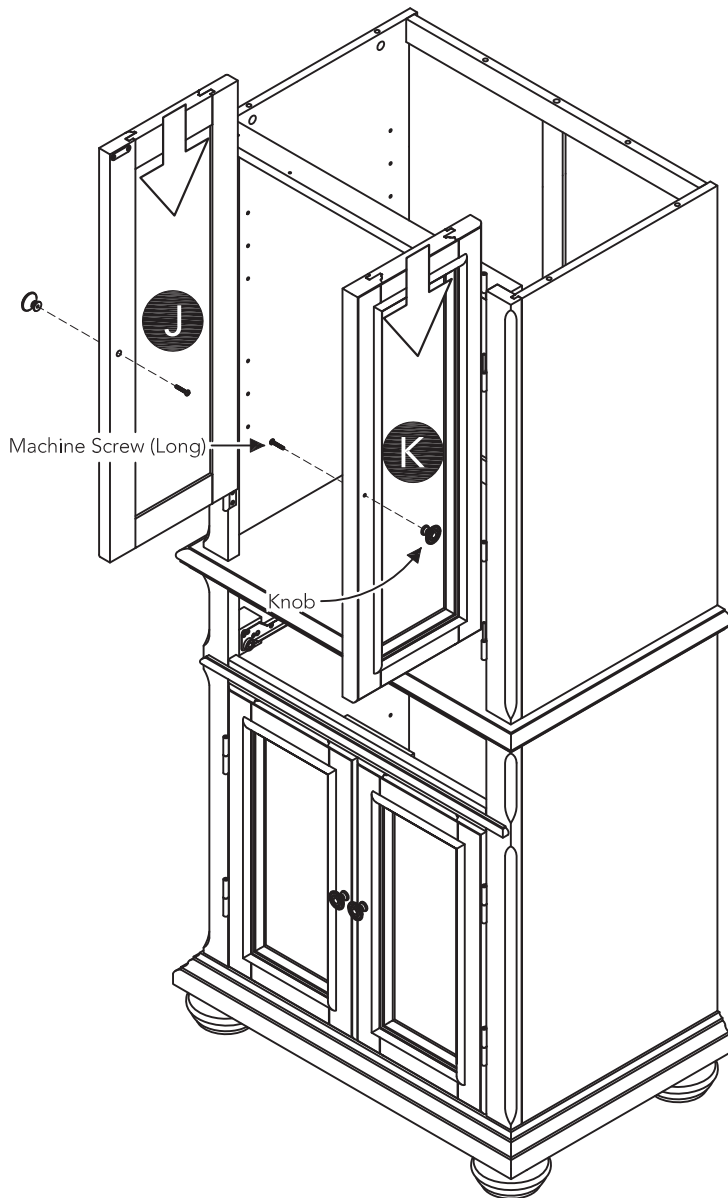

## STEP 14

Attach Top (A) to unit with 1 1/4" Flat Head Screws and Cam Locks.



### STEP 15

Level unit by adjusting the adjustable levelers on bottom of unit. (See Figure 4)

Note: Unit must be level to proceed.

Attach Wedges to unit with 1/2" Flat Head Screws. (See Figure 5)

Note: Unit must be level before attaching these wedges.

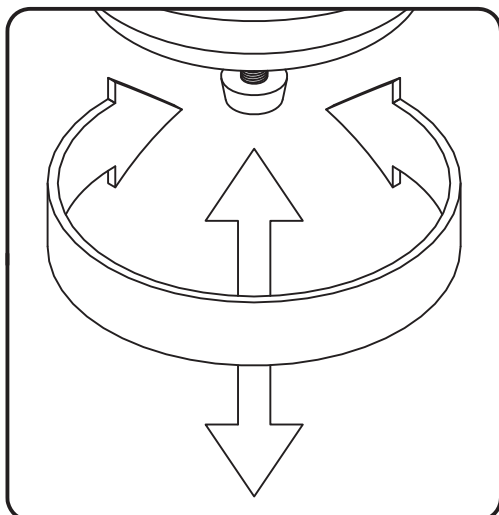
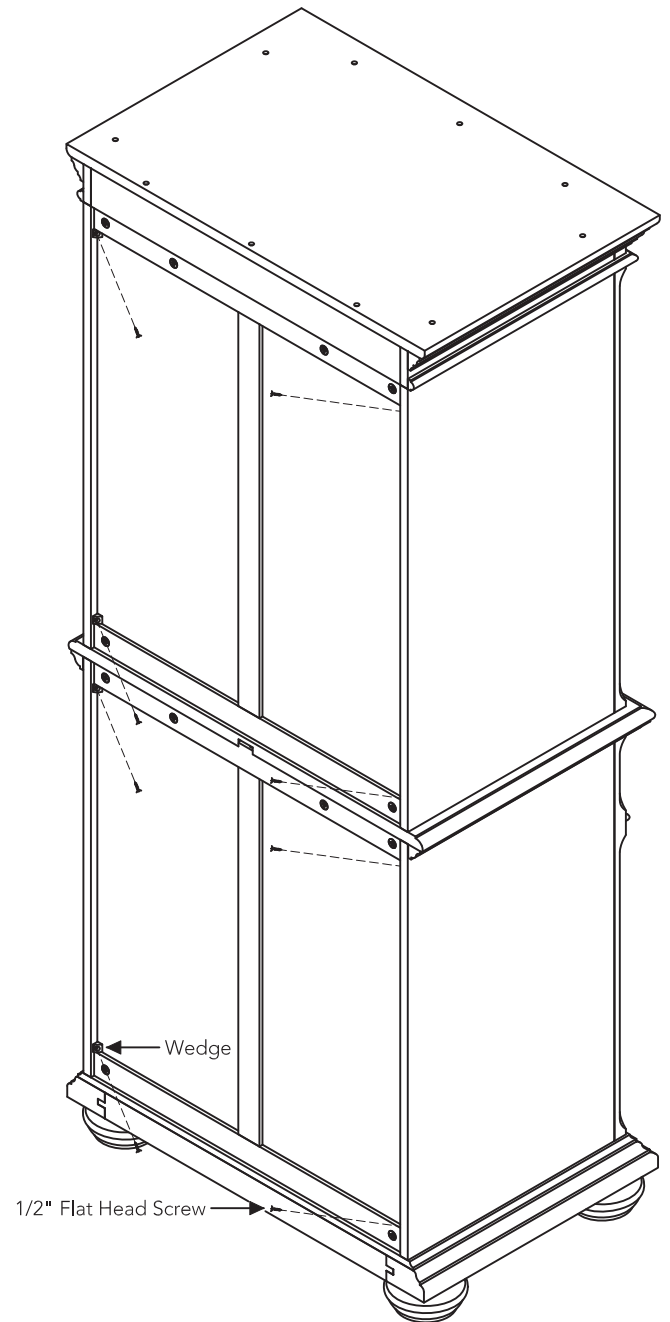

Figure 4

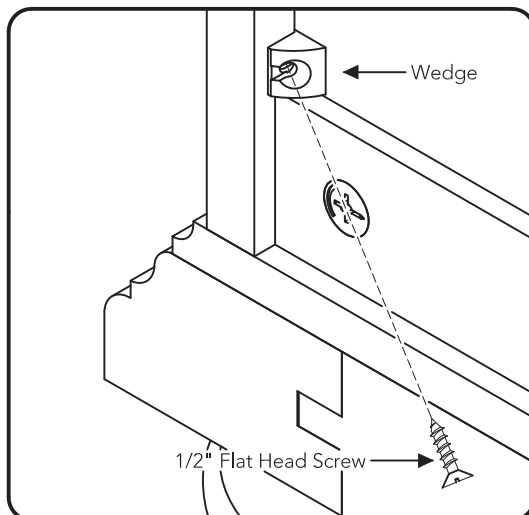

Figure 5

# Assembly Instructions 10/14

## IMPORTANT

- To help reduce the risk of the unit tipping over, the Tip-over Restraint must be installed following these instructions exactly.

## STEP 16

Place unit at desired location.

Mark wall with pencil in-line with hole in Middle Panel (L). (See Figure 6)

Move unit.

Drill a 3/8" hole in wall 1/2" below mark.

Insert Anchor into the wall hole and attach Tip-over Restraint to Anchor with 1 1/2" Round Head Screw and Flat Washer. (See Figure 7)

Move unit back into place and insert Tip-over Restraint into unit through hole in Middle Panel (L). (See Figure 8)

Attach Tip-over Restraint to unit with 1/2" Round Head Screw and Flat Washer. (See Figure 9)

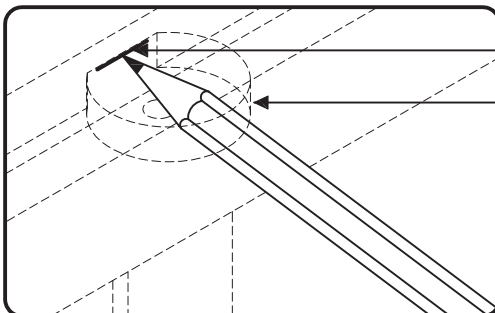
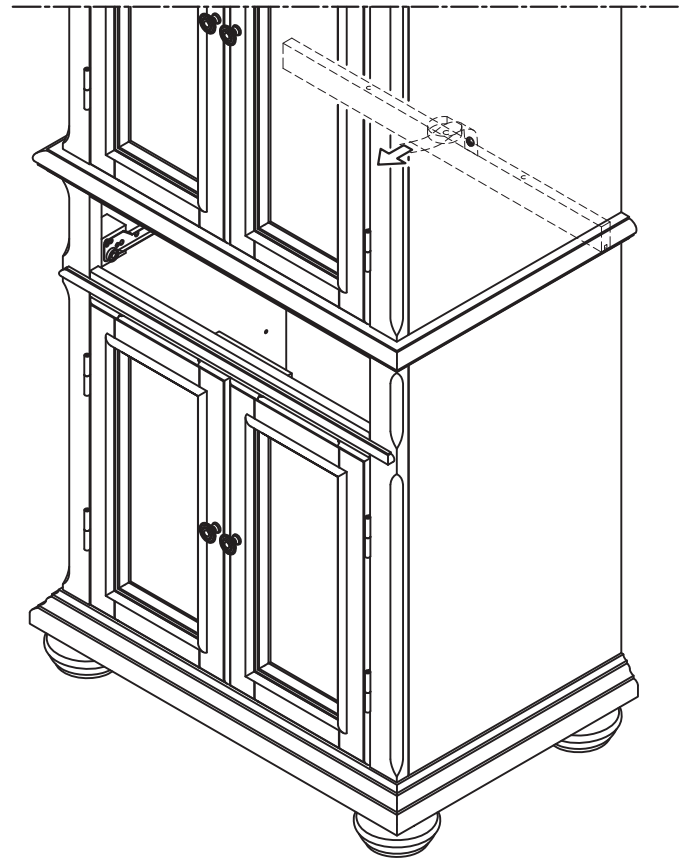

Figure 6

Pencil mark

Hole in Middle Panel (L)

3/8" wall hole

Anchor in wall

Tip-over Restraint

Flat Washer

1 1/2" Round Head Screw

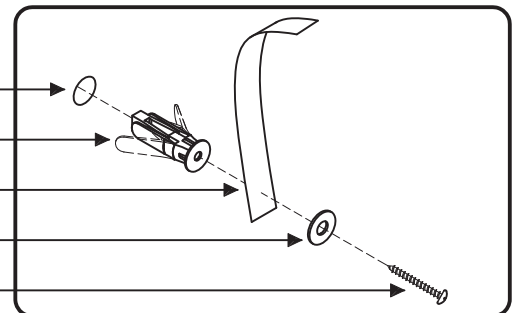

Figure 7

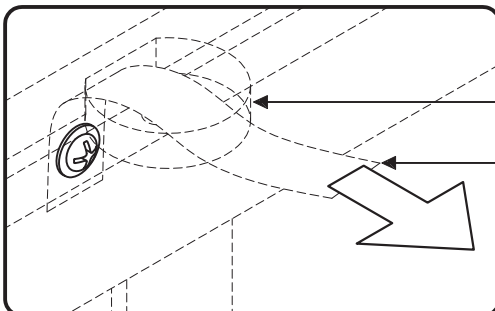

Figure 8

Hole in Middle Panel (L)

Tip-over Restraint

Tip-over Restraint

Flat Washer

1/2" Round Head Screw

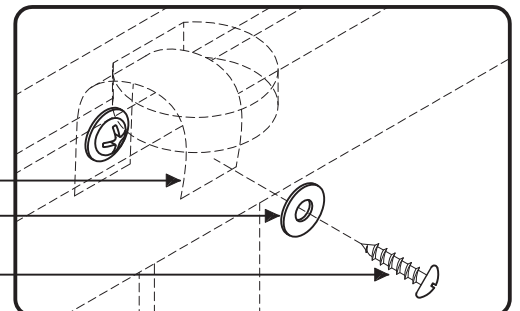
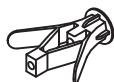

Figure 9

## Hardware List



Tip-over Restraint  
1 pc.



Anchor  
1 pc. (+1 extra)



M3x38  
1 1/2" Round Head Screw  
1 pc. (+1 extra)



M3x13  
1/2" Round Head Screw  
1 pc. (+1 extra)



Flat Washer  
2 pcs. (+1 extra)

## Drawer (W)

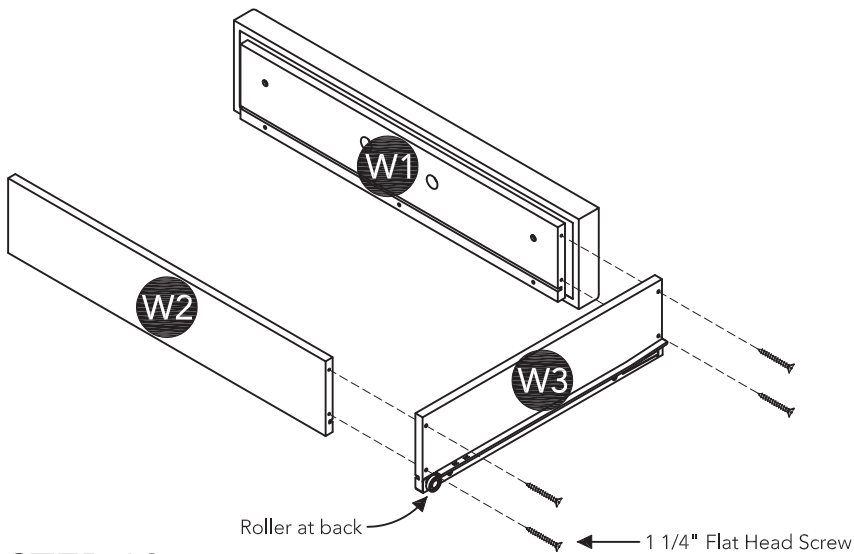

### STEP 17

Attach Drawer Side (W3) to Drawer Front (W1) and Drawer Back (W2) with 1 1/4" Flat Head Screws.

### STEP 18

Insert Drawer Bottom (W5) into groove.

Attach Drawer Side (W4) to unit with 1 1/4" Flat Head Screws.

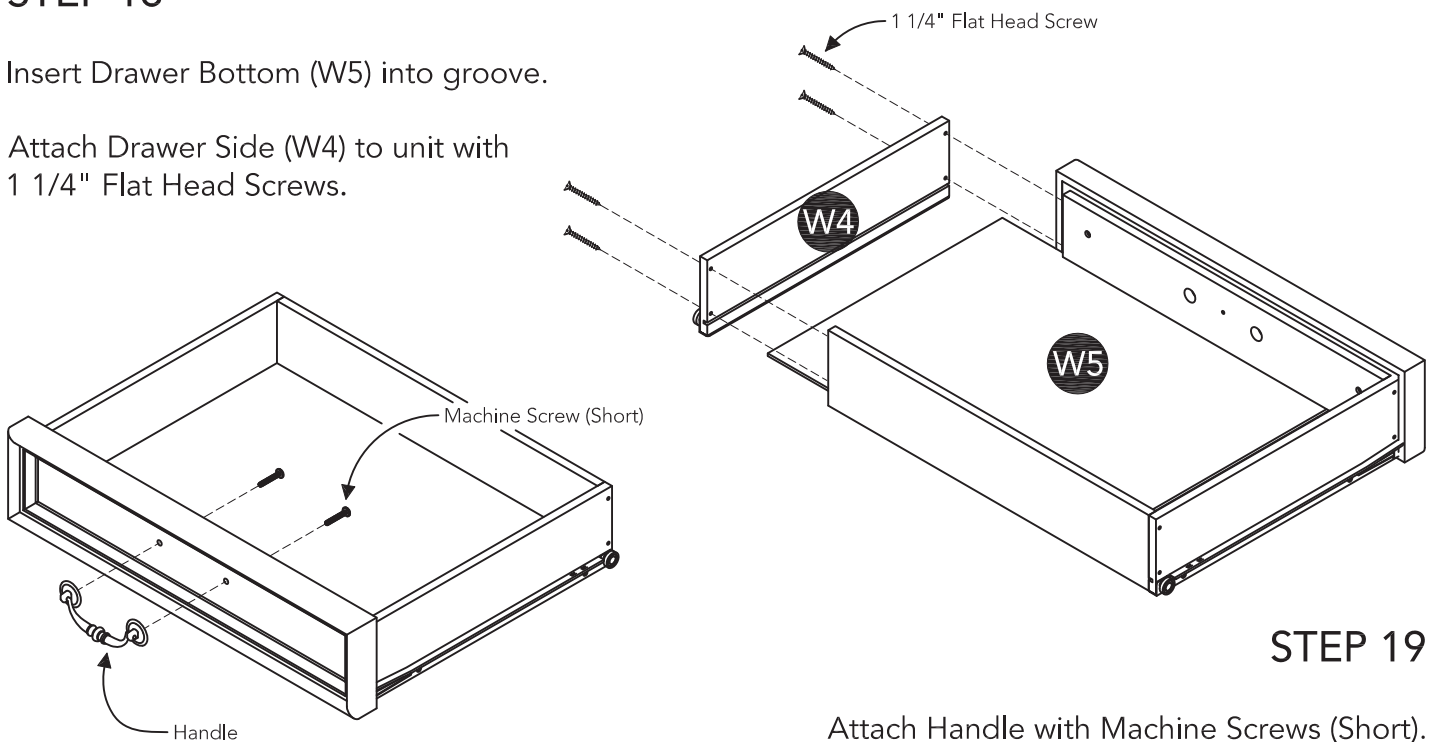

### STEP 19

Attach Handle with Machine Screws (Short).

Note: Drawer assembly is not complete until 3/4" Flat Head Screws are used in a later step.

### Part List

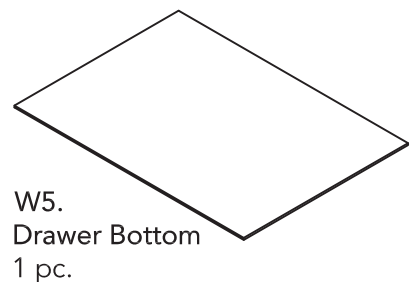
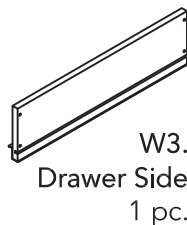
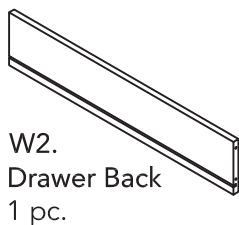
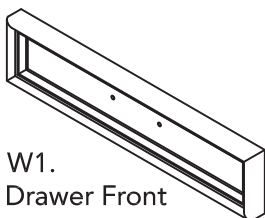

## STEP 20

Loosen slightly screws pre-installed on back of drawer front.

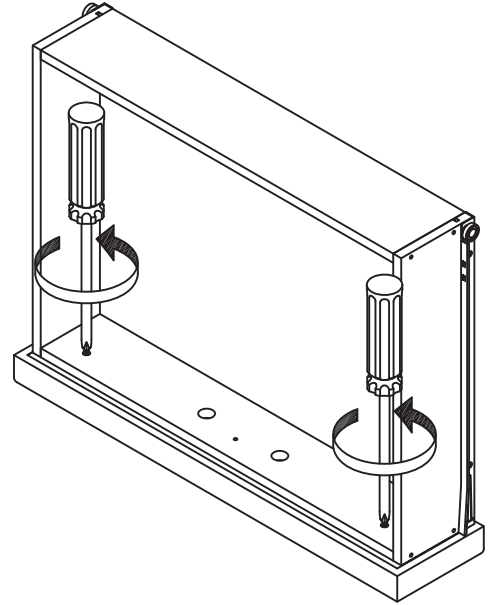

## STEP 21

Insert drawer into unit, then adjust drawer front panel left or right and up or down until drawer gaps are proportional.

## STEP 22

Pull drawer open slowly, then retighten screws loosened in Step 20.

Make sure drawer front panel does not move and lock drawer front panel into position with 3/4" Flat Head Screws.

Note: These 3/4" Flat Head Screws must be installed to complete the drawer assembly.

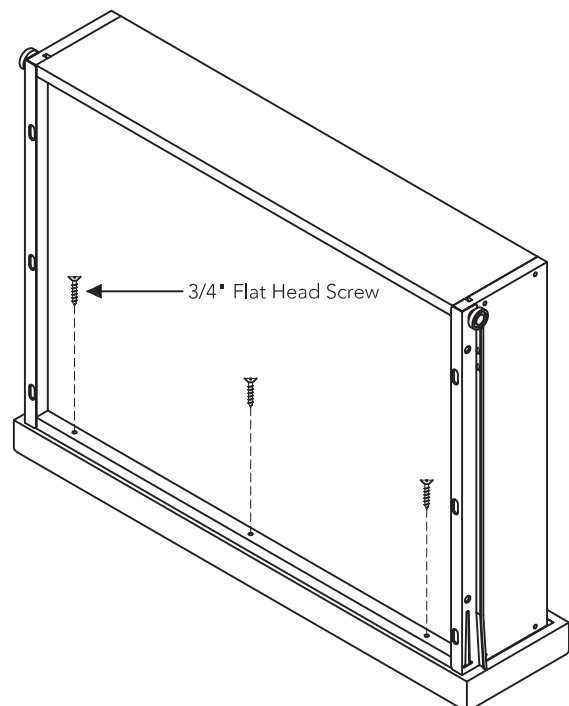
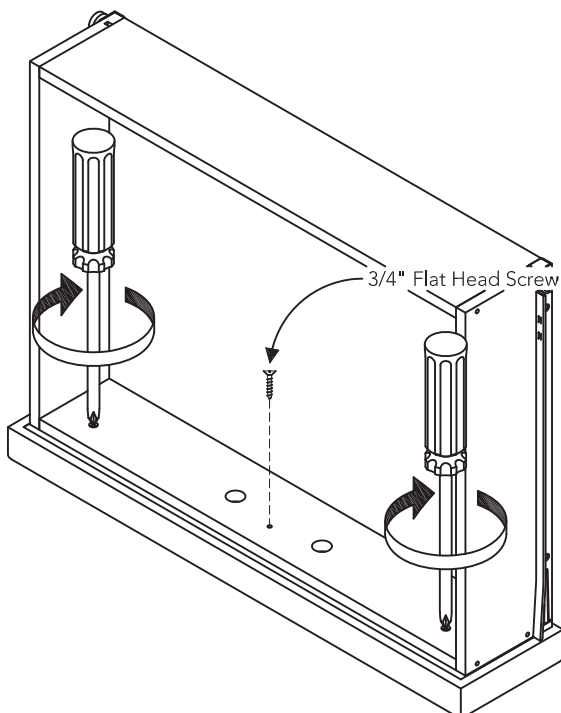

## STEP 23

Insert Adjustable Pins into side panels at desired level.  
(See Figure 10)

Place Shelves (E) into position.

Slide Drawer (W) into position.

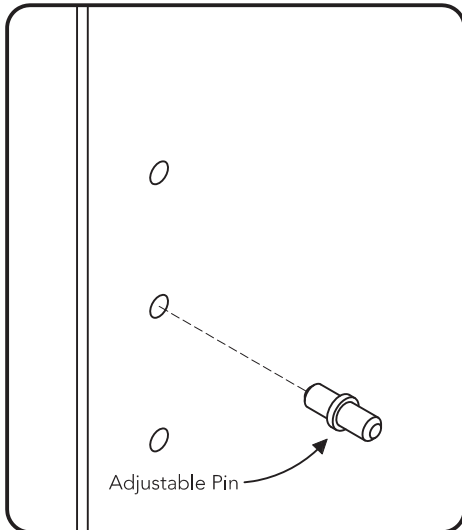
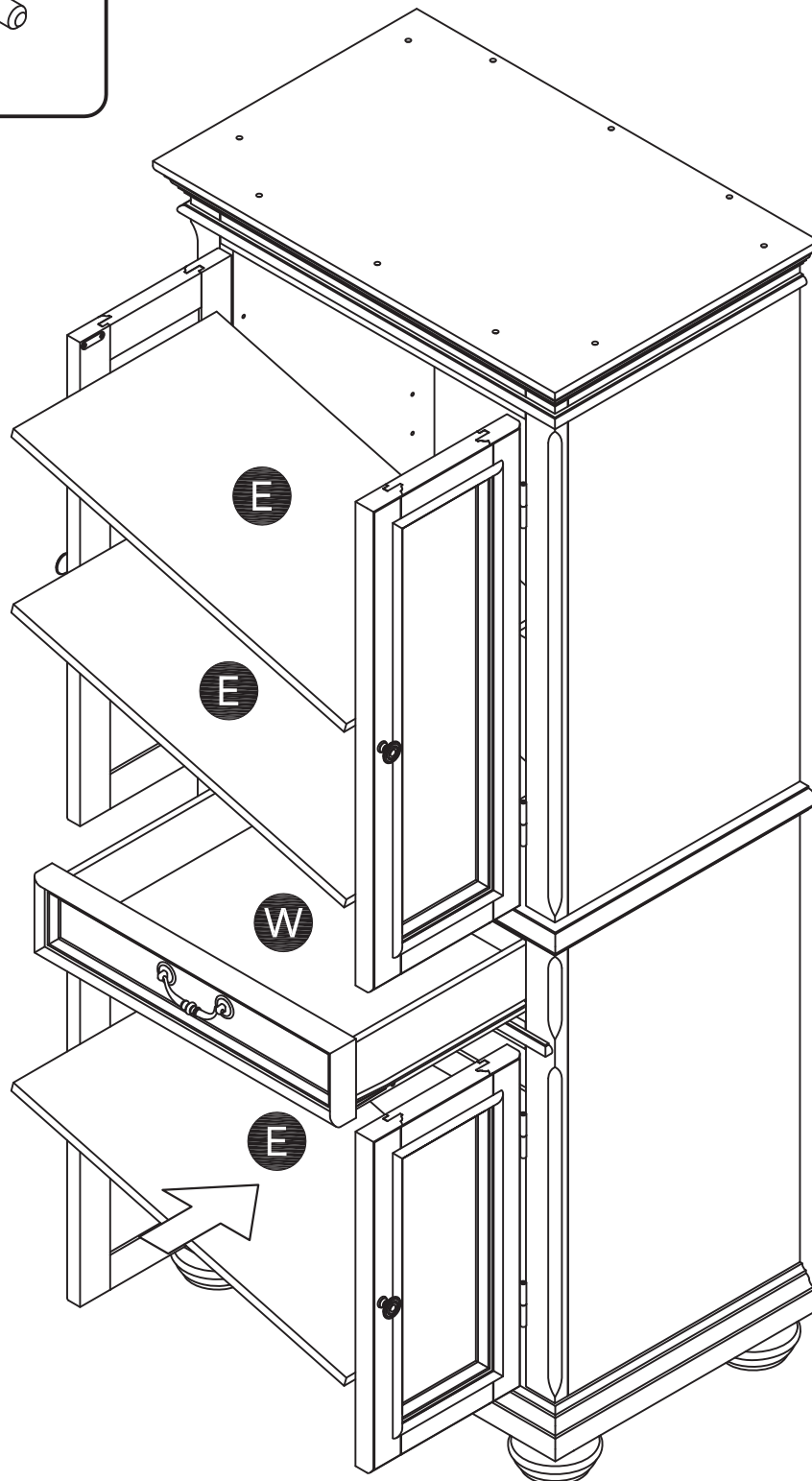

Figure 10



## Assembly Instructions 14/14

### IMPORTANT

- If magnetic door catches are too strong and door difficult to open, magnetic power can be reduced and door made easier to open by doing the following:

1

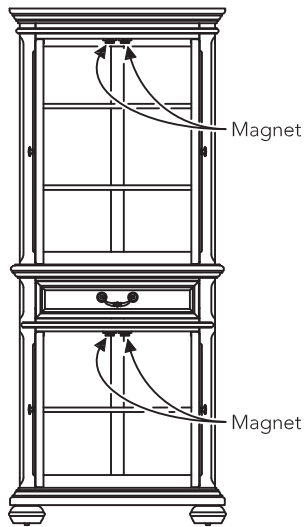

Magnet location.

2



Magnet position.

3

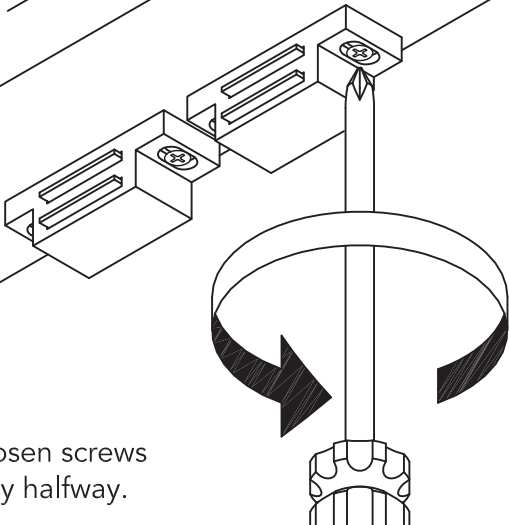

Loosen screws only halfway.

4

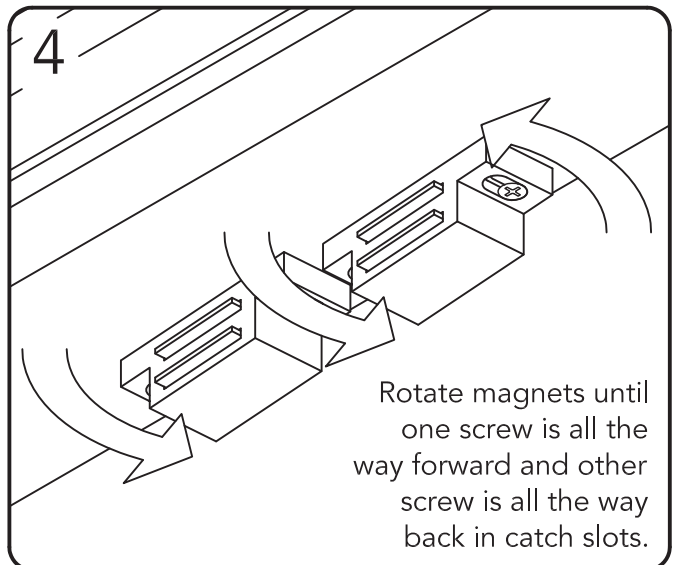

Rotate magnets until one screw is all the way forward and other screw is all the way back in catch slots.

5

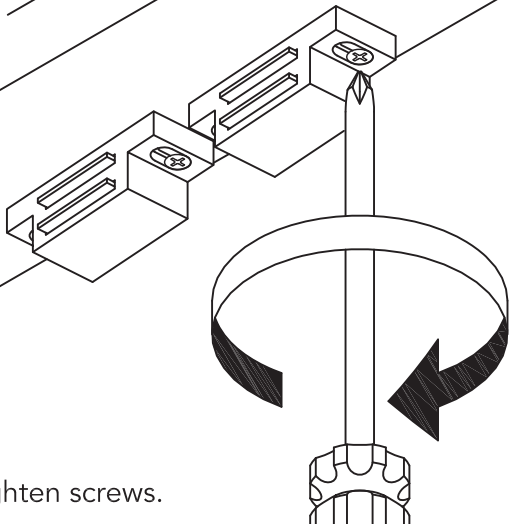

Tighten screws.

6



New position.



# CARE INSTRUCTIONS

## NEVER

allow liquids to remain on furniture.  
Absorption causes parts to warp  
and split and finishes to delaminate.

## NEVER

use glass cleaners on  
finished furniture. Ammonia  
chemically attacks the finish.



Do not use power tools  
above 8 volts to assemble.

**PREVENT  
CRACKING**



Do not place  
in direct sunlight.

**PREVENT  
FADING**



Do not write  
directly on surface.

**PREVENT  
MARKING**



Do not place hot  
objects on surface.

**PREVENT  
FINISH DAMAGE**



Do not use rubber  
based placemats.

**PREVENT  
DISCOLORING**



Do not use commercial  
waxes and polishes.

**PREVENT  
YELLOWING**

## CLEAN

with a soft cloth moistened  
in lukewarm soap and water.  
Buff with a dry clean cloth.



Home Styles will provide replacements free of charge for missing or damaged hardware or parts within 30 days of purchase. Digital images of the defective parts may be required. If the product was not purchased from an authorized retail affiliate, Home Styles is under no obligation to provide replacement parts. Parts are not available for fully assembled items nor are parts available for sale. Replacements for missing or damaged hardware or parts may be requested at:

[www.homestyles-furniture.com/customer-service/replacement-parts](http://www.homestyles-furniture.com/customer-service/replacement-parts)

Home Styles Customer Service: [www.homestyles-furniture.com](http://www.homestyles-furniture.com),  
[servicedesk@homestyles-furniture.com](mailto:servicedesk@homestyles-furniture.com), 888-680-7460, 877-831-0319

**IMPORTANT**

Carefully remove all the parts from the carton and place them individually on a soft cloth to prevent scratches or other damage.

Carefully and strictly follow these assembly instructions to ensure a completed product as designed.

Do not use power tools above 8 volts to assemble.

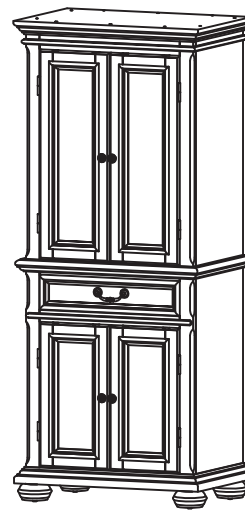
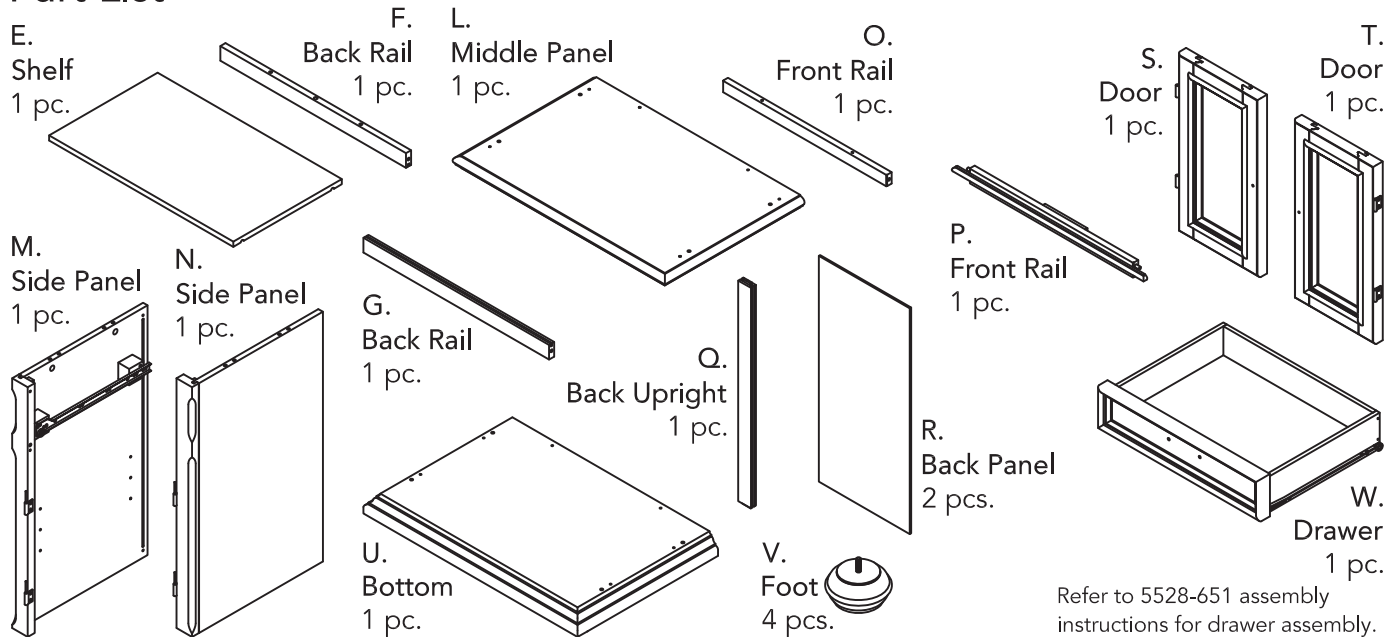
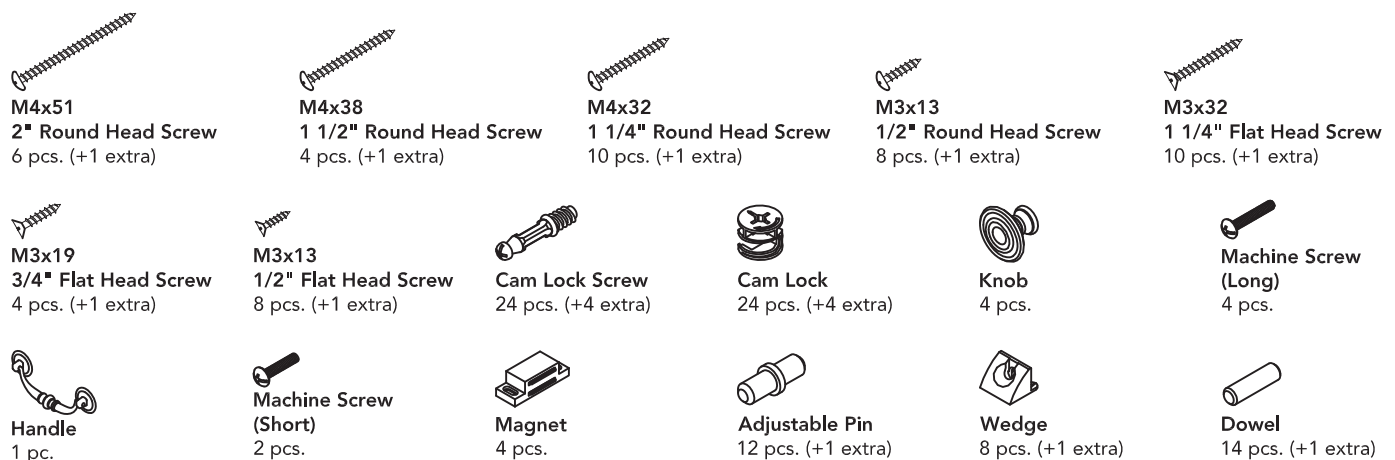
**Part List****Hardware List**

For assembly see instructions in carton 5528-651.

Home Styles Customer Service: [www.homestyles-furniture.com](http://www.homestyles-furniture.com),  
[servicedesk@homestyles-furniture.com](mailto:servicedesk@homestyles-furniture.com), 888-680-7460, 877-831-0319