

IMPORTANT

Carefully remove all the parts from the carton and place them individually on a soft cloth to prevent scratches or other damage.

Carefully and strictly follow these assembly instructions to ensure a completed product as designed.

Do not use power tools above 8 volts to assemble.

Part List

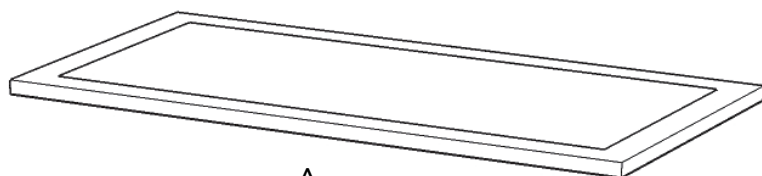

A.
Top
1 pc.

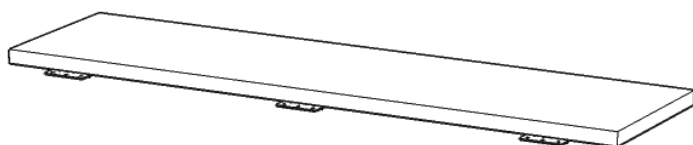

B.
Leaf Top
1 pc.

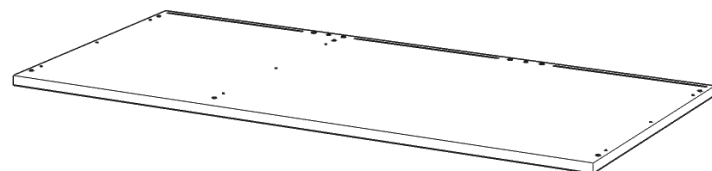

J.
Base
1 pc.

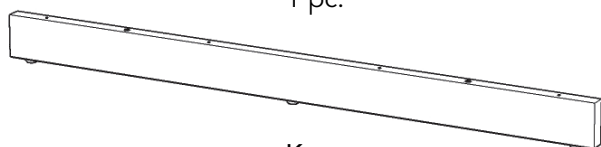

K.
Plinth
2 pcs.



L.
Plinth
2 pcs.

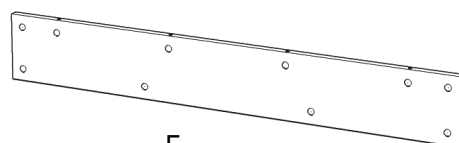

F.
Back Rail
1 pc.



G.
Front Rail
1 pc.



H.
Front Rail
1 pc.



N.
Back Upright
1 pc.



O.
Back Upright
1 pc.

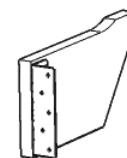

S.
Back Support
1 pc.

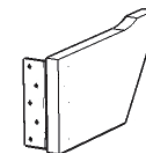

T.
Back Support
1 pc.

For assembly see instructions in carton 20 08000 0942.