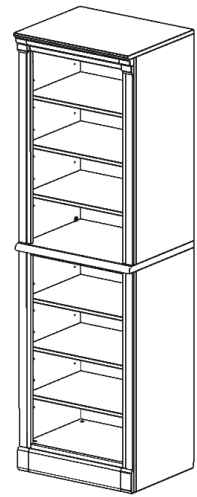

Closet Wall Shelf Unit

**IMPORTANT**

Carefully remove all the parts from the carton and place them individually on a soft cloth to prevent scratches or other damage.

Carefully and strictly follow these assembly instructions to ensure a completed product as designed.

Do not use power tools above 8 volts to assemble.

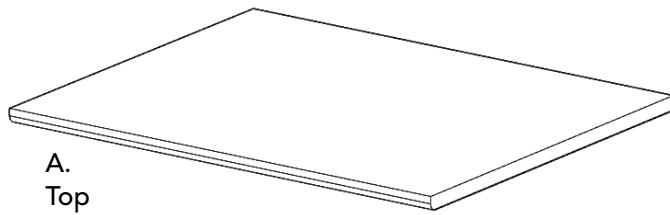
Part List

A.
Top
1 pc.

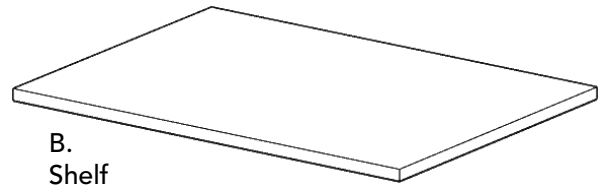

B.
Shelf
3 pcs.

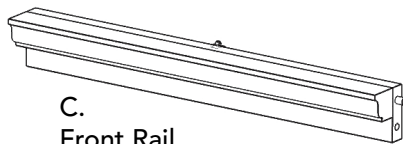

C.
Front Rail
1 pc.

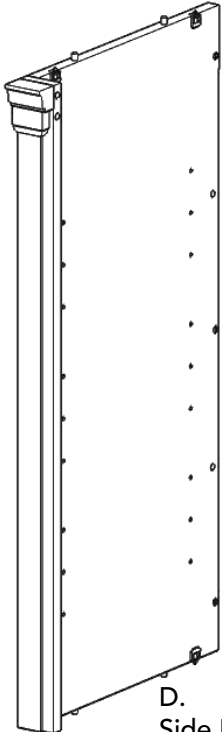

D.
Side Panel
1 pc.

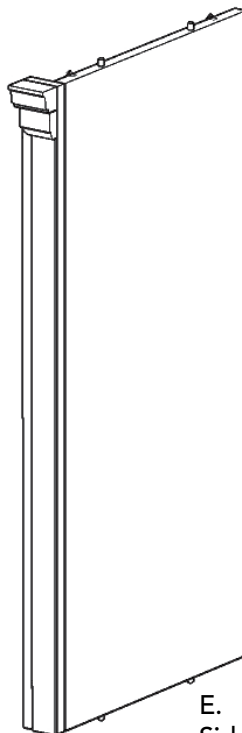

E.
Side Panel
1 pc.

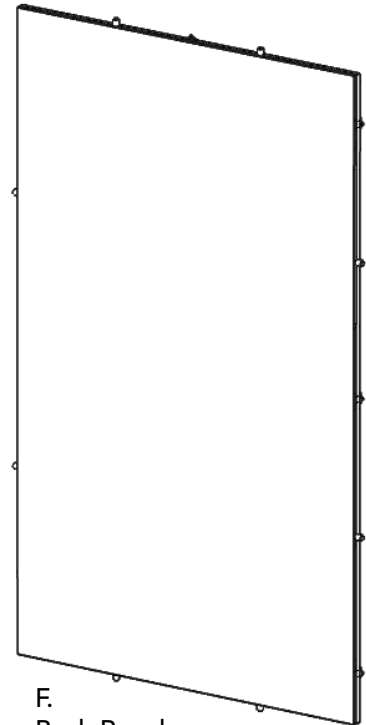

F.
Back Panel
1 pc.

For assembly see instructions in carton 20 05520 0762.