

# Pronto, Crossover

Booster Seat



KEEP INSTRUCTIONS FOR FUTURE USE.  
Read all instructions before using this booster seat.

**⚠ WARNING:** Failure to follow the warnings on the labels and in the instruction manual can result in serious injury or death to your child.



4358-7228  
3.18.19



## Overview

Welcome to the Safety 1st family and thank you for choosing this car seat, also known as a child restraint!

To help you get started using your child's new car seat, here are the 3 main tasks you'll need to complete.

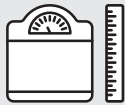

### Measure Your Child



### Place Booster Seat into Your Vehicle



### Buckle Up!

Your child's safety is worth the time it will take to read and follow these instructions.

#### Ready? Let's go!

**Pages 1-3** will introduce you to the parts of the car seat.

**Page 34** has our contact information. If at any point you would like assistance, please feel free to reach out to us.

## Quick Navigation



### BACKLESS BOOSTER SEAT

18-45 kg (40-100 lb) and  
102-145 cm (40-57 in.)

PAGE 4



### BACKED BOOSTER SEAT

18-45 kg (40-100 lb) and  
102-145 cm (40-57 in.)

PAGE 4



Preparing  
Booster Seat  
PAGE 5



Backless  
Booster Seat  
Child Fit

PAGE 17



Backed  
Booster Seat  
Child Fit

PAGE 21



Backless:  
Lap/Shoulder Belt

PAGE 18



Backed:  
Lap/Shoulder Belt

PAGE 22

# Contents

## Getting Started

Parts of the Booster Seat .....	1
Cup Holder Use .....	2
Booster Seat Requirements .....	3
Preparing Booster Seat For Use .....	5

## Making Adjustments to Booster Seat

Installing Backrest/Headrest .....	11
Removing Backrest/Headrest .....	12
Adjusting Headrest Height .....	13
Reclining Backrest .....	14

## Knowing Your Vehicle Belts .....

15

## Installation in Vehicle

Backless Booster Seat .....	16
Backless: Booster Seat Child Fit .....	17
Backless Booster: Lap/Shoulder Belt Use .....	18
Backed Booster Seat .....	20
Backed: Booster Seat Child Fit .....	21
Backed Booster: Lap/Shoulder Belt Use .....	22

## Car Seat Pad Use and Care

Removing Seat Pad Set for Cleaning .....	24
--	----

## Safety Information

Replacement and Expiration of Car Seat .....	27
Aircraft Information .....	28
Child Restraint Use .....	28
Installation in Vehicle .....	29
Vehicle Seating Position .....	29
Transport Canada Regulations .....	29
Registration and Safety Notices .....	31

## Additional Information

Warranty .....	32
Replacement Parts List .....	33
Dorel Juvenile Group Information .....	34

1



## Parts of the Booster Seat

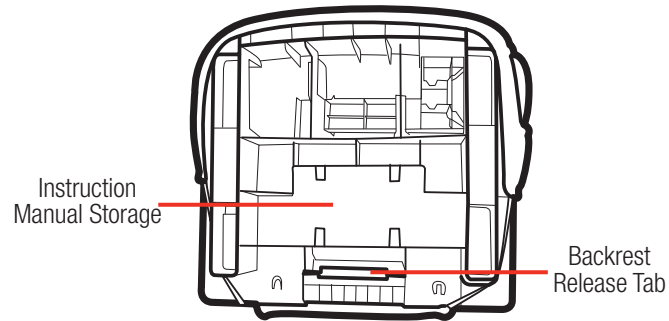
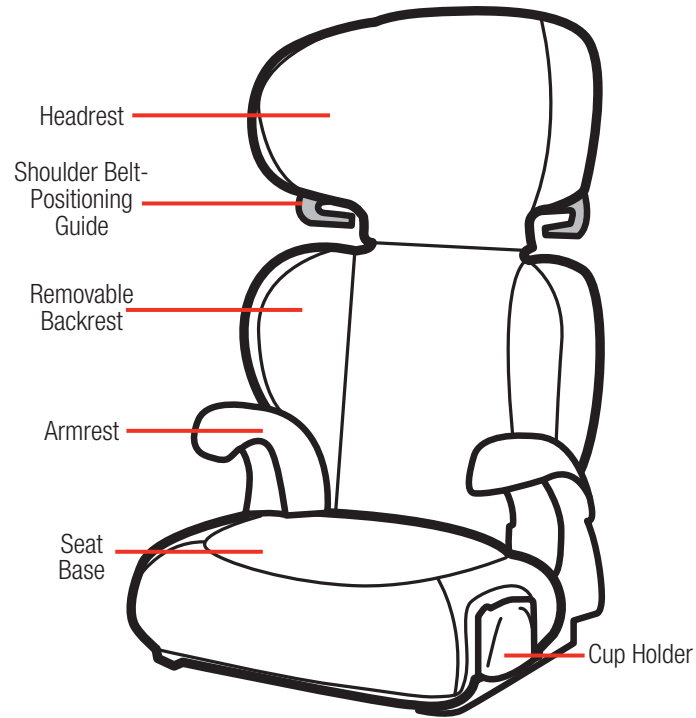

2

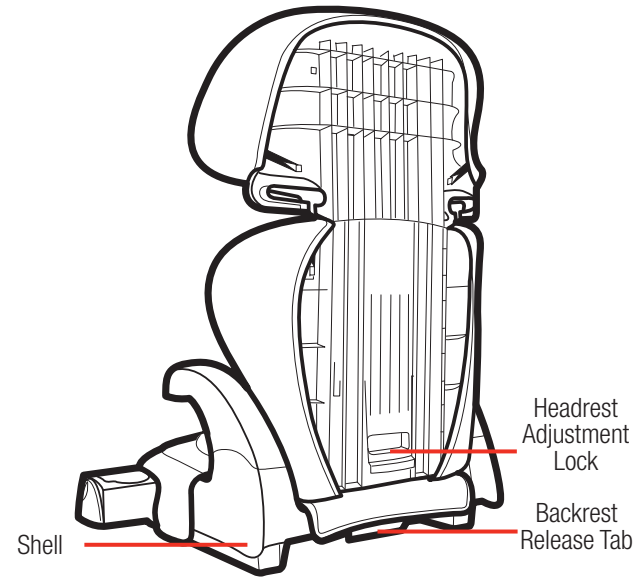

## Cup Holder Use

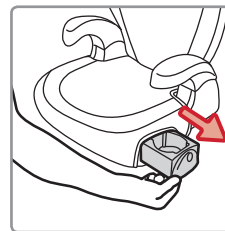

Pull out cup holder to use.

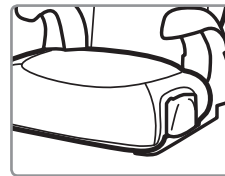

Push the cup holder in when not in use.

**⚠ WARNING**

**Measure your child's weight and height (do not guess) before using this booster seat.**

Your child's height, weight, and age determine how a car seat should be placed in the vehicle.

Children vary widely in body size, shape, and temperament—**please consult your doctor before switching between any types or modes of a car seat within the limits and fit requirements of the seat.**

**State/Province Laws**

Please be certain to follow your state's or province's laws regarding car seat use.

**American Academy of Pediatrics Recommendations****Infants and Toddlers**

Should ride in a rear-facing car seat as long as possible, until they reach the highest weight or height allowed by their seat.

**Toddlers and Preschoolers**

Once they are facing-forward, children should use a forward-facing car seat with a harness for as long as possible, until they reach the height and weight limits for their seats.

**School-Aged Children**

Once they have outgrown their forward-facing car seat, children should use a belt-positioning booster seat until the vehicle's lap and shoulder seat belt fits properly. This is often when they have reached at least 4 feet 9 inches in height and are 8 to 12 years old.

**Older Children**

All children younger than 13 years should be restrained in the rear seats of vehicles for optimal protection.

**BACKLESS BOOSTER SEAT**

**18-45 kg (40-100 lb) and  
102-145 cm (40-57 in)**

Your child can remain in this Booster Seat until they outgrow any one of the following:

- **Weight Limit:** 45 kg (100 lb); **OR**
- **Height Limit:** 145 cm (57 in.); **OR**
- **Booster Seat** child fit requirements. See page 17.

**BACKED BOOSTER SEAT**

**18-45 kg (40-100 lb) and  
102-145 cm (40-57 in)**

Your child can remain in this Booster Seat until they outgrow any one of the following:

- **Weight Limit:** 45 kg (100 lb); **OR**
- **Height Limit:** 145 cm (57 in.); **OR**
- **Booster Seat** child fit requirements. See page 21.

5



## Preparing Booster Seat for Use

Remove the headrest from the backrest in order to install the headrest and backrest pads.

### Removing Headrest from Backrest

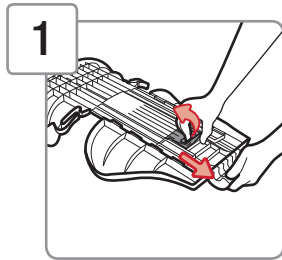

#### 1 Unlock Headrest from Backrest

With the headrest and backrest facing down, lift headrest adjuster lock up and pull headrest up out of all locked positions.

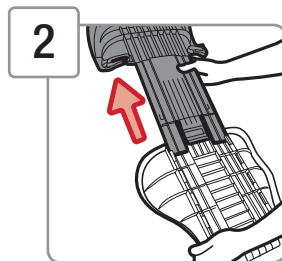

#### 2 Separate Headrest from Backrest

Slide the headrest out of the track on the backrest.



6

If your pad comes in a plastic bag, remove the pad from the plastic bag and discard the plastic bag.

### Installing Seat Pad

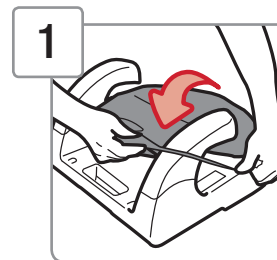

#### 1 Install Seat Pad

Slide seat pad onto the front of the seat base.

Slide the elastic strap over each armrest.

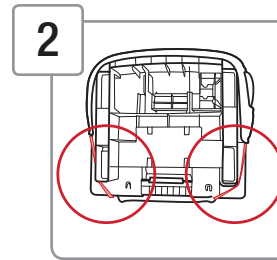

#### 2 Wrap Elastic Straps Under Back Corners of Seat Base

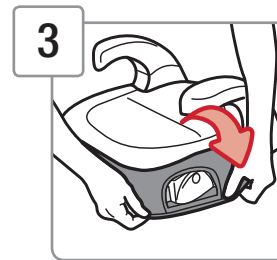

#### 3 Pull Seat Pad Around Cup Holder

*continued on next page*



To use the booster seat with backrest/headrest, follow the instructions below to install the backrest/headrest pads.

### Determine Style of Headrest Pad

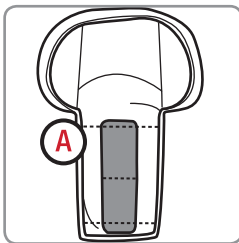

If back of headrest pad has a sewn on plastic piece (image A), follow steps for Installing Backrest/Headrest Pads Version A. See step 1 below.

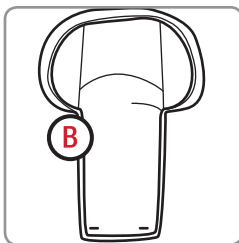

If the headrest pad does not have plastic piece (image B), follow steps for Installing Backrest/Headrest Pads Version B. See page 9.

### Installing Backrest/Headrest Pads Version A

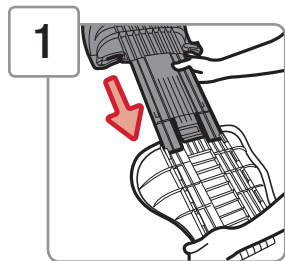

#### Attach Headrest to Backrest

With the headrest and backrest facing down, slide the headrest into the track on the back of the backrest.

2

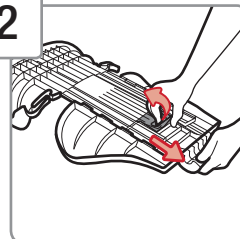

#### Lock Headrest

Lift headrest adjuster lock up and pull headrest down into a locked position.

3

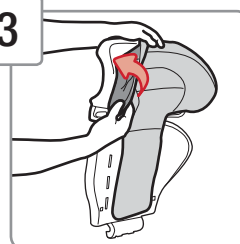

#### Install Headrest Pad

Slide the pad over one side of the headrest.

Repeat for other side.

4

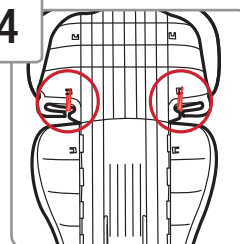

#### Attach the Elastic Straps

From the back of headrest, attach the elastic straps to the hooks above the shoulder belt-positioning guides as shown.

5

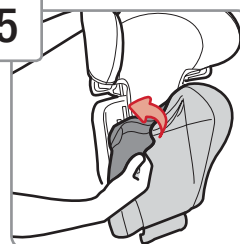

#### Install Backrest Pad

Slide backrest pad onto one side of the backrest. Pull pad tight and slide the pad over the other side of backrest. Bottom of the headrest pad should be behind the backrest pad as shown.

To install backrest/headrest to booster seat, see page 11.





## Installing Backrest/Headrest Pads Version B

1

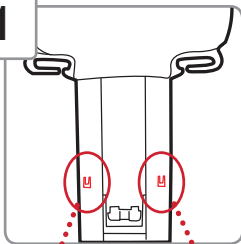

### Install Headrest Pad

Attach headrest pad by attaching bottom of pad to tabs near the bottom of the headrest.

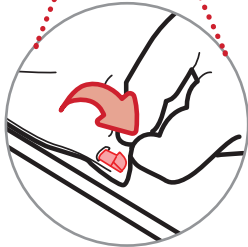

2

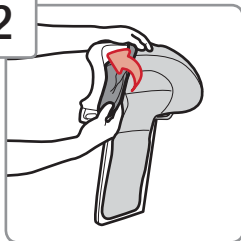

### Slide the Pad Over One Side of the Headrest

Repeat for other side.

3

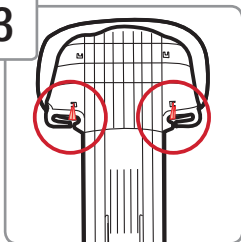

### Attach the Elastic Straps

From the back of headrest, attach the elastic straps to the hooks above the shoulder belt-positioning guides.



4

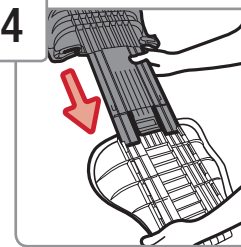

### Attach Headrest to Backrest

With the headrest and backrest facing down, slide the headrest into the track on the back of the backrest.

5

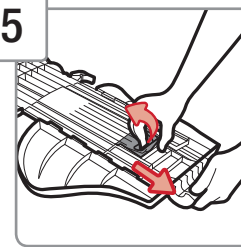

### Lock Headrest

Lift headrest adjuster lock up and pull headrest down into a locked position.

6

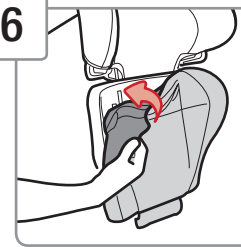

### Install Backrest Pad

Slide backrest pad onto one side of the backrest.

Pull pad tight and slide the pad over the other side of backrest.

To install backrest/headrest to booster seat, see page 11.



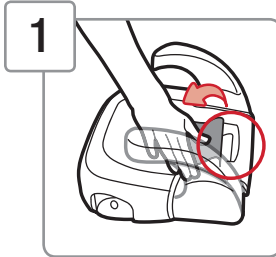

### 1 Locate the Backrest Opening in Seat Base

Hold down the rectangular shaped flap at the rear of the seat base pad to fully reveal the backrest opening.

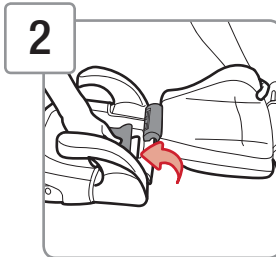

### 2 Attach Backrest to Seat Base

With the backrest laying flat (horizontal), insert the backrest hook into the backrest opening at the rear of the seat base.

Make sure the seat base pad does not get caught between the moving parts.

The backrest may not connect properly if the pad is in the way.

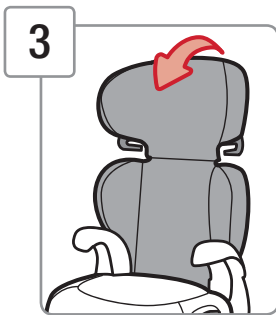

### 3 Rotate Backrest Up

Rotate backrest all the way up into the locked position. In the locked position, the backrest will remain upright.

Tuck flap on seat base pad under backrest pad.

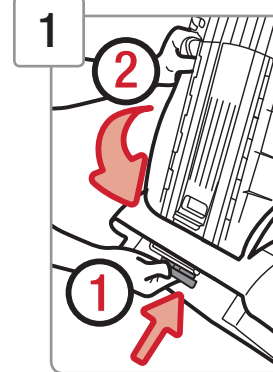

### 1 Lay Backrest Flat

To remove backrest/headrest from seat base, backrest needs to be in the most upright position. See page 14.

Press firmly on backrest release tab (1) and rotate seat back until it lays flat (2).

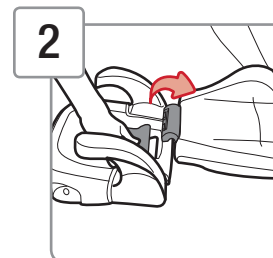

### 2 Remove Backrest/Headrest

Lift backrest hook out of opening in seat base.

Lay flap on seat base pad over backrest opening.

Store backrest/headrest for future use.

To remove headrest from backrest, see page 5.

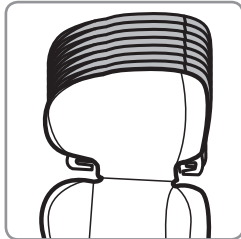

### Headrest Has Multiple Height Positions

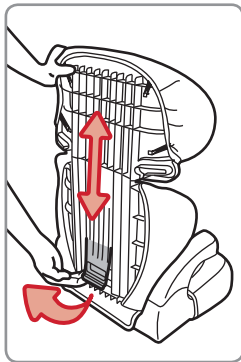

### To Raise or Lower Headrest

Grasp the top of the headrest with one hand and push down on the headrest while pulling out on the headrest adjustment lock with the other.

Raise or lower headrest to selected position. Release the headrest adjustment lock into one of headrest heights.

Check to make sure the headrest is locked by pushing and pulling headrest up and down.

Headrest will move slightly when it is locked.

For Backed Booster Seat Child Fit, see page 21.



The headrest and backrest must always be used together.

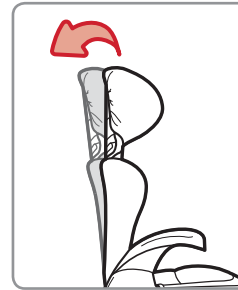

### Backrest Has 2 Positions

Backrest has an upright and semi-reclined position.

The semi-reclined position is to be used only to install the booster seat flush against the vehicle seat back, if needed.

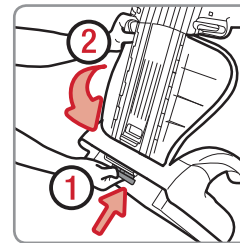

### To Recline Backrest

Push firmly on the backrest release tab and rotate top of seat back about 2.5 cm (1 in.).

The backrest is now in the semi-recline mode.

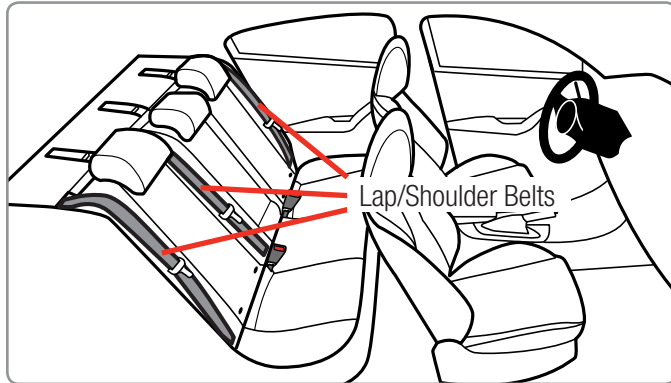

Your vehicle's features may be considerably different than those pictured here.



**Not all vehicle belts and seating positions will work with child restraints.**



**You must review your vehicle owner's manual.** It will let you know which vehicle belts and seating positions child restraints can be installed in.

### Must Use With This Booster Seat

Lap/Shoulder Belts



### Never Use With This Booster Seat

Lap Only Belts



Inflatable Seat Belts



**18-45 kg (40-100 lb) and  
102-145 cm (40-57 in.)**



Lap/Shoulder  
Belt

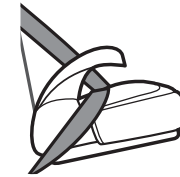

Keep booster  
seat belted when  
not in use.

### ⚠ WARNINGS

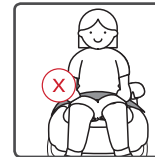

Use only the vehicle's lap and shoulder belt system when restraining the child in this booster seat. Do not use only the lap belt when using this booster seat.

The shoulder belt must always be adjusted snugly across the child's chest. **NEVER** place shoulder belt under the child's arms or behind their back.

Do not use this booster seat if the tops of your child's ears are above the top of the vehicle's seat back or vehicle's headrest.

Failure to follow these warnings can result in serious injury or death.

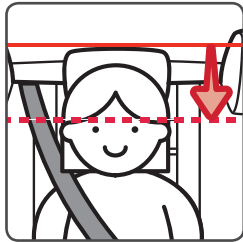

### Head Position

Tops of child's ears below the top of your vehicle's seat back or vehicle's headrest.



### Shoulder Belt Position

The shoulder belt should lay snugly across the center of the child's shoulder and across the chest and not on their face or neck.

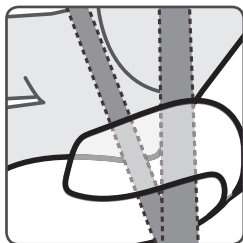

### Lap Belt Position

The lap belt should lay snugly across the child's hips and not on their stomach.

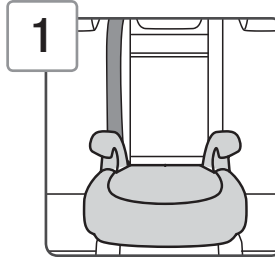

### Place Booster Seat Forward-Facing in Back Seat

Vehicle seat back must be upright.

The back of the booster seat should be flat against the vehicle seat back.

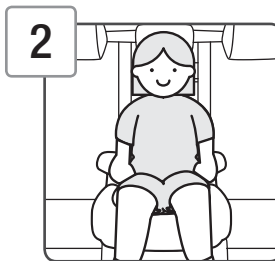

### Have Child Sit in Booster Seat

Child should sit with their back flat against the vehicle seat and their bottom flat against the seat base.

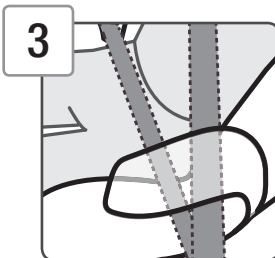

### Position Lap Belt on Child

Route lap portion of the lap/shoulder belt under both armrests.

The shoulder belt should go under the armrest on the vehicle buckle side only.

The lap belt should lay snugly across the child's upper thighs and not on the stomach.

*continued on next page*



4

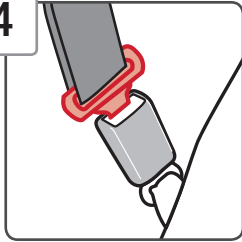

### Buckle the Vehicle Belt

Pull up on lap belt to tighten.

5



### Position Shoulder Belt on Child

Pull up on shoulder belt to tighten.

The shoulder belt should lay snugly across the center of the child's shoulder and across the chest and not on their face or neck.



### Finished!

Check periodically to make sure your child has not moved out of position and loosened the shoulder belt.



18-45 kg (40-100 lb) and  
102-145 cm (40-57 in.)



Lap/Shoulder Belt



Keep booster seat belted when not in use.

### ⚠ WARNINGS

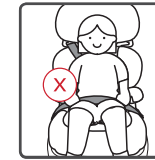

Use only the vehicle's lap and shoulder belt system when restraining the child in this booster seat. Do not use only the lap belt when using this booster seat.

The shoulder belt must always be adjusted snugly across the child's chest. NEVER place shoulder belt under the child's arms or behind their back.

Do not use this booster seat if the tops of your child's ears are above the top of the booster seat's headrest.

Do not use this booster seat if the tops of your child's ears are above the top of the vehicle's seat back or vehicle's headrest.

Failure to follow these warnings can result in serious injury or death.

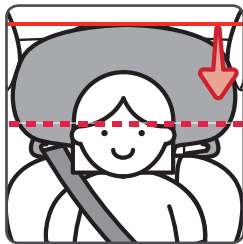

### Head Position

Tops of the child's ears should never be above the top of the headrest.

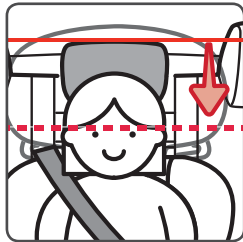

Tops of child's ears below the top of your vehicle's seat back or vehicle's headrest.

Adjust headrest if needed, see page 13.



### Shoulder Belt Position

The shoulder belt should lay snugly across the center of the child's shoulder and across the chest and not on their face or neck.

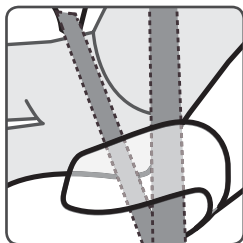

### Lap Belt Position

The lap belt should lay snugly across the child's hips and not on their stomach.



To install the backrest/headrest, see page 11.

The headrest and backrest must always be used together.

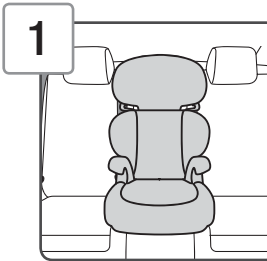

### Place Booster Seat Forward-Facing in Back Seat

Vehicle seat back must be upright.

The back of the booster seat should be flat against the vehicle seat back.

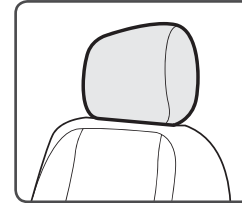

**NOTE: If your vehicle seat has a headrest that interferes with achieving a flush car seat fit,** check your vehicle owner's manual to see if it can be removed, adjusted, or if there are other possible seating locations.



### Have Child Sit in Booster Seat

Child should sit with their back flat against the vehicle seat and their bottom flat against the seat base.

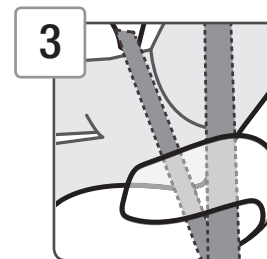

### Position Lap Belt on Child

Route lap portion of the lap/shoulder belt under both armrests.

The shoulder belt should go under the armrest on the vehicle buckle side only.

The lap belt should lay snugly across the child's upper thighs and not on the stomach.

*continued on next page*



4

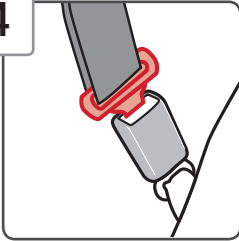

### Buckle the Vehicle Belt

Pull up on lap belt to tighten.

5



### Position Shoulder Belt on Child

Pull up on shoulder belt to tighten. The shoulder belt should lay snugly across the center of the child's shoulder and across the chest and not on their face or neck.



Only use the shoulder belt-positioning guide in the headrest if necessary to help position the shoulder belt correctly on the child.



### Finished!

Check periodically to make sure your child has not moved out of position and loosened the shoulder belt.

1

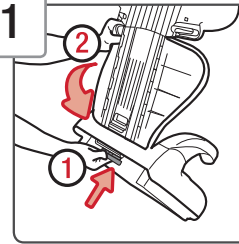

### Lay Backrest Flat

To remove backrest/headrest from seat base, backrest needs to be in the most upright position. See page 14.

Press firmly on backrest release tab (1) and rotate seat back until it lays flat (2).

2

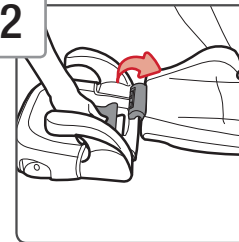

### Remove Backrest/Headrest

Lift backrest hook out of opening in seat base.

Lay flap on seat base pad over backrest opening.

3

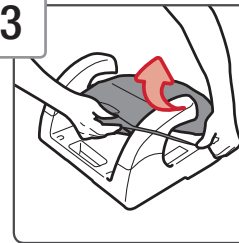

### Remove Pad from Seat Base

Pull elastic straps out from under the seat base and pull the pad off the seat base.

*continued on next page*

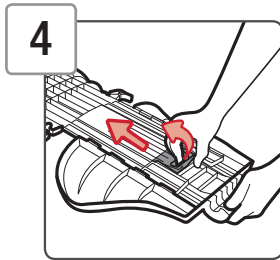

#### 4 Unlock Headrest from Backrest

With the headrest and backrest facing down, lift headrest adjuster lock up and pull headrest up out of all locked positions.

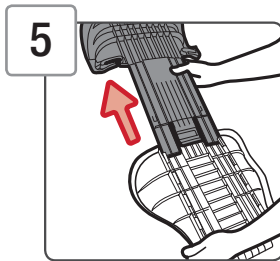

#### 5 Separate Headrest from Backrest

Slide the headrest out of the track on the backrest.

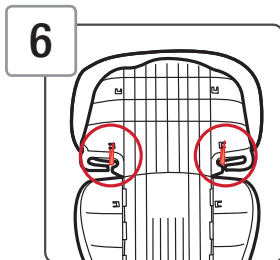

#### 6 Remove Pad from Headrest

From the back, remove the elastic straps from the back of the headrest.

Pull pad off of headrest.

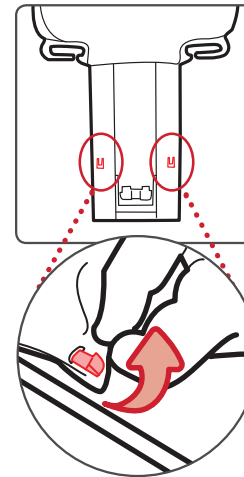
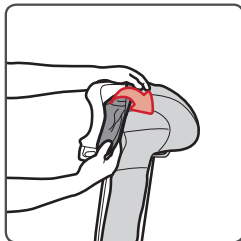

Depending on your model, you may need to unhook bottom of headrest pad from tabs near bottom of headrest.

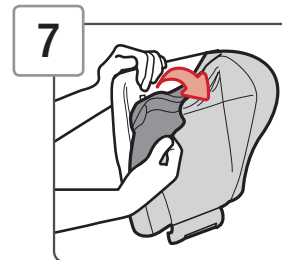

#### 7 Remove Pad from Backrest

From the side, pull pad off of backrest.

#### Cleaning Pad Set

Machine wash separately with cold water on a gentle cycle. Do not use bleach. Tumble dry separately for 10-12 minutes on low heat. Remove immediately.

**⚠️ WARNINGS:** Do not use booster seat without the seat pad. Failure to do this can result in serious injury or death.

#### Installing Seat Pad

See pages 6-10 and follow instructions that are applicable to the type of seat pad set you have.





## Replacement and Expiration of Car Seat

### Do not risk your child's safety.

To keep your child as safe as possible, Dorel Juvenile Group strongly recommends replacing the car seat even after a minor crash; even if it was not occupied at the time.

### Replacement After a Minor Crash

The National Highway Traffic Safety Administration states that for a crash to be considered minor **ALL of the following must be true:**

- Vehicle able to drive away from the crash site; **AND**
- Vehicle door nearest the car seat was not damaged; **AND**
- No passengers were injured; **AND**
- Airbags did not deploy; **AND**
- There is no visible damage to the car seat.

If the crash your car seat was involved in meets **ALL** the criteria, you may not need to replace the car seat.

If one or more of these criteria are not true or if you are uncertain of any of your answers, replace the car seat immediately.

### Replacement After a Moderate to Severe Crash

You **must** replace this car seat if it has been in a moderate to severe car crash.

This car seat is intended to protect a child in a single crash. During a crash, the car seat and all of its parts absorb crash energy which can deform or weaken it. Damage is not always visible. A damaged car seat must be replaced immediately.

### Expiration



On the side of the child restraint there is a date of manufacture label as shown.

Do not use this child restraint more than 10 years after the date of manufacture.



This restraint is not certified for aircraft use because aircraft seats do not have shoulder belts.

### ! Booster Seat Use

**Never take your child out of the booster seat while the vehicle is moving.**

**Never leave child unattended. Placing your child in a hot booster seat may result in burns.**

**Do not use a booster seat with damaged or missing parts.**

**Do not substitute parts or try to modify the booster seat in any way.**

**Do not use any booster seat accessory except those approved by Dorel Juvenile Group.**

**Never allow any child to play with this child restraint; it is not a toy.**

**Do not remove or cover up any of the warning labels or other labels on the booster seat .**

**This booster seat has been certified for use in passenger vehicles. Do not use in a boat, on a motorcycle or in a cargo van or bus where there are no seat belts.**

**Read all instructions for additional warnings.**



### ⚠ Installation in Vehicle

Check the vehicle belt before each use. Use only if the belt can be tightened properly and securely.

This booster seat should be securely belted in the vehicle even when not in use. In a crash or sudden stop, an unsecured child restraint could injure occupants.

### ⚠ Vehicle Seating Position

Check the vehicle owner's manual for more information about air bag/booster seat use.



Use the booster seat only on vehicle seats that face forward.

Do not use on seats that face the sides or rear of the vehicle.



For vehicles without a back seat, refer to your vehicle owner's manual.

### Transport Canada Regulations

Transport Canada Road Safety Directorate regulates children's restraint systems under the Motor Vehicle Restraint Systems Safety Regulations (RSSR).

The regulations require the manufacturer and/or importer to certify the restraint to the applicable safety standards and place specified warnings and information on the labels fastened to each restraint and in this instruction manual.



Children are safer when properly restrained in rear seating positions than in the front seating positions.

According to accident statistics, children in rear seating positions are statistically safer, whether you have air bags, advanced air bags, or no air bags at all.

**If you are not sure where to place the child restraint in your vehicle:** consult your vehicle owner's manual or contact Dorel Juvenile Group Consumer Care Department.

**To avoid your child being seriously burned, take the following precautions:**

1. Park in the shade or where sun does not directly hit the child restraint.
2. Cover the child restraint with a sheet or blanket when not in use.
3. Check for hot seat and buckles before placing child in child restraint.

To help protect your vehicle seat's upholstery from damage, use a single layer towel underneath and behind child restraint.



Although child restraints are tested, evaluated, and certified by the manufacturer and tested by Transport Canada, it is possible that a safety-related problem may be found. If there is ever a safety issue with your child restraint, we use registration information to reach owners.

Tear Off and Mail This Part or Register Online Débranchez et postez cette partie ou enregistrez en ligne 4359-4117E

**Consumer:** Just fill in your name, address and email. Please print.  
**Client:** Simplement inscrire votre nom, adresse et courriel. S.V.P. imprimez.

Your Name/Votre nom: \_\_\_\_\_

Your Street Address/Votre adresse: \_\_\_\_\_

City/Ville: \_\_\_\_\_ Province \_\_\_\_\_ Postal Code/Code Postal: \_\_\_\_\_

Email Address (optional)/Courriel (optionnel): \_\_\_\_\_

AB123CDE SF CARSEAT 2015/05/16

Date of Purchase/Date d'achat: \_\_\_\_\_

Example of model number, manufacture date, and line code.



If you don't have the card or if your address changes, you will find the model number, manufacture date, and line code on the label located on the side of the shell.

There are three additional ways to register your information:

**Online:** [www.djgusa.com/registration/carseat/can](http://www.djgusa.com/registration/carseat/can)

**Telephone:** 1-800-544-1108

**Mail:** Send your name, address and your child restraint's model number, manufacture date, line code, and date of purchase to:

**Dorel Juvenile Canada  
 Consumer Care Department**  
 2855 Argentia Road, Unit 4  
 Mississauga, ON L5N 8G6

Please do not send in your registration card if you have registered your child restraint online. For information on safety-related problems, you can also call Transport Canada's Road Safety Dept. at: 1-800-333-0371.

Dorel Juvenile Group, Inc. (DJG) warrants this product to the original retail purchaser as follows: This product is warranted against defective materials or workmanship for one year from the date of original purchase.

**An original receipt is required to validate your warranty.**

DJG will, at its option, provide replacement parts or replace this product. DJG reserves the right to substitute if the part or model has been discontinued.

To make a claim under this warranty, please contact our Consumer Care Department by phone: 1-800-544-1108; text: 1-812-652-2525; or chat with us: [www.safety1st.com](http://www.safety1st.com).

Our hours of operation are from 8:00 a.m. to 6:00 p.m. EST Monday through Thursday and from 8:00 a.m. to 4:30 p.m. on Friday.

**Proof of purchase is required and shipping charges are the responsibility of the consumer.**

**Warranty Limitations:** This warranty does not include damages which arise from misuse or abuse of this product.

**Limitation of Damages:** The warranty and remedies as set forth are exclusive and in lieu of all others, oral or written, expressed or implied.

In no event will DJG or the dealer selling this product be liable to you for any damages, including incidental or consequential damages, arising out of the use or inability to use this product.

**If requested color is not available, similar color will be substituted. Prices are subject to change. Applicable tax and shipping & handling will also be added.**

<u>Part</u>	<u>Cost</u>
Seat Pad Set.....	\$29.99

**For parts availability and questions**, please call:  
1-800-544-1108; text: 1-812-652-2525; or chat with us:  
[www.safety1st.com](http://www.safety1st.com).

**Hours of Operation:**

M-TH from 8:00 AM to 6:00 PM EST  
FRI from 8:00 AM to 4:30 PM EST

**If you already know which parts you need**, you may complete your order with a credit card by calling us at 1-800-544-1108.

**See list above for available parts. We accept Visa or MasterCard.**

Thank you for choosing this child restraint. The DJG family is committed to creating child restraints with the most comfort and convenience available today.

Remember, parents are a child's first teachers and examples. If you always buckle your seat belt, your child will think it is the natural thing to do. Make it a firm rule that the vehicle does not go until everyone is buckled up. Make no exceptions.

No one can predict if use of a child restraint will prevent injury or death in a particular crash. However, when combined with careful driving, proper use of a child restraint can lower a child's risk of injury or death in most crashes.

If you still have questions or have any concerns with this child restraint, please contact our Consumer Care Department:

**Call:** 1-800-544-1108

**Text:** 1-812-652-2525

**Chat:** [www.safety1st.com](http://www.safety1st.com)

**Hours of Operation:**

M-TH from 8:00 AM to 6:00 PM EST  
FRI from 8:00 AM to 4:30 PM EST