

SIDES	BOTTOM
2 3/4" KNOCKOUTS	2 1/2" KNOCKOUTS
7 1/2"-3/4" MOON KNOCKOUTS	2 3/4" KNOCKOUTS
	1 Ground Hump
2 PCS #8-32x1/2 Screws Installed	
Material: Steel-0.0625"-G60 Galvanized	

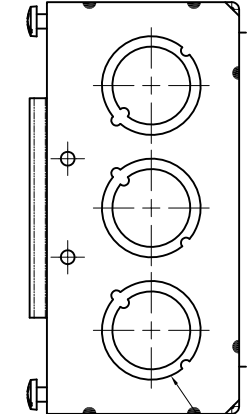
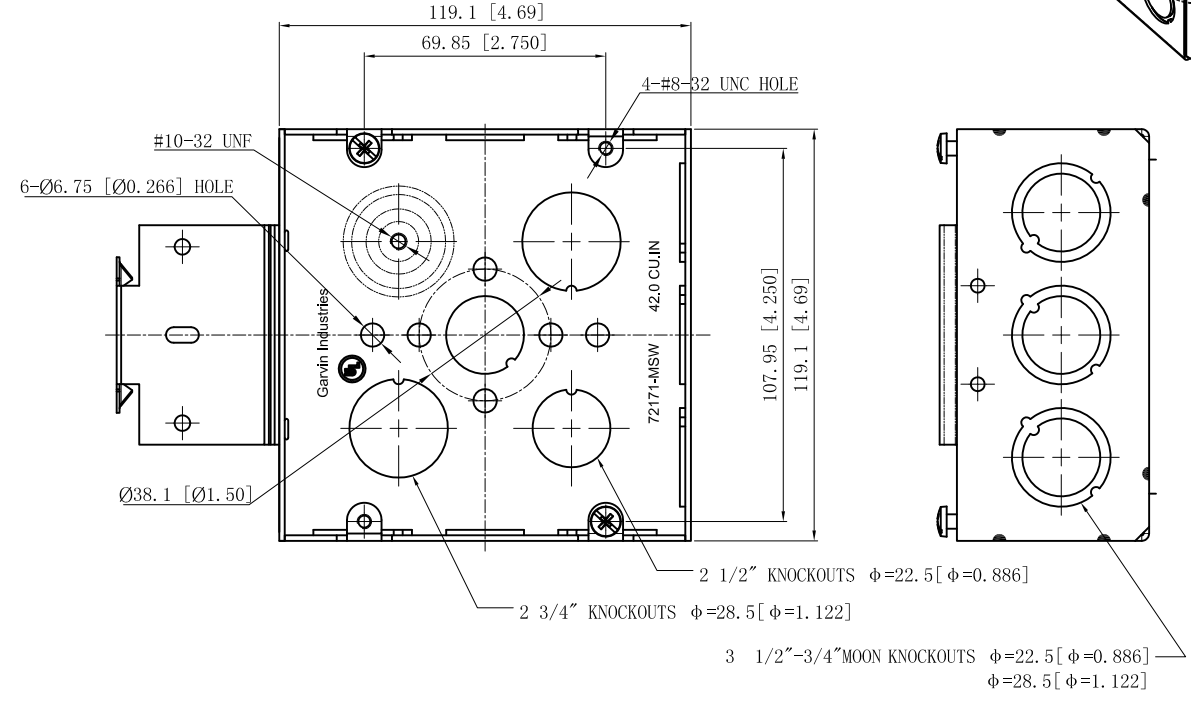
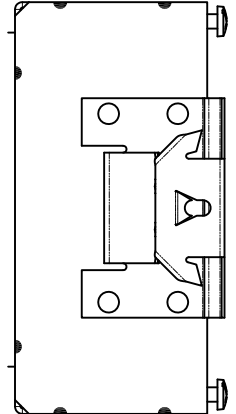
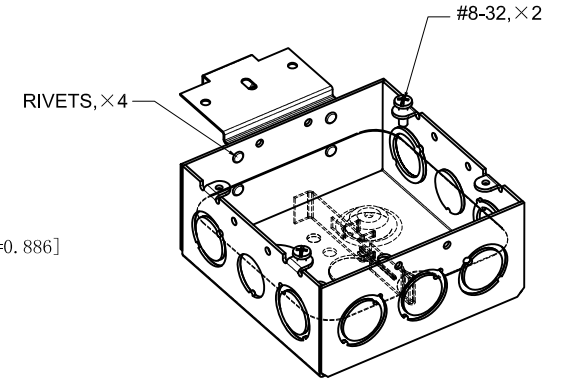
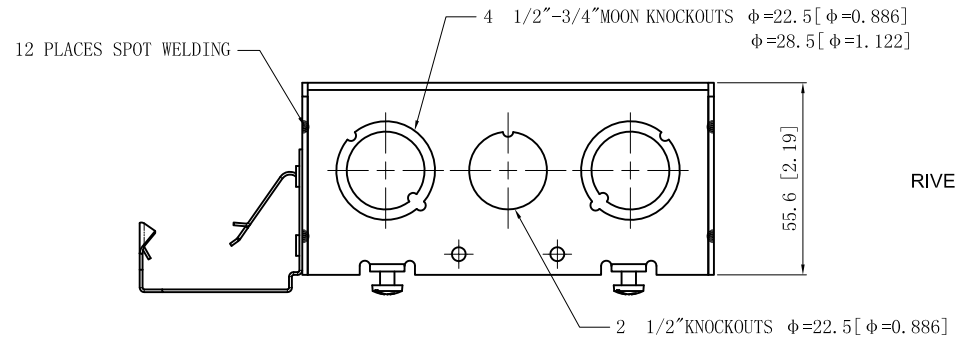

This data sheet is for reference only. GARVIN INDUSTRIES reserves the right to make changes to the design without prior notice.

DESCRIPTION
TRADE REFERENCE TERMS

STANDARD PACKING	<h1 style="margin: 0;">GARVIN INDUSTRIES</h1>			
25 PCS				
TITLE	4-11/16" SQUARE EXTENSION RINGS 2-1/8" DEEP			
SIZE	A4	DWG NO.	72171-MSW	REV A
		DATA SHEET		