

ONE COLL. DINING TABLE ASSEMBLY INSTRUCTIONS

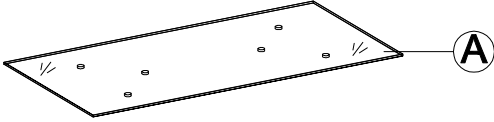

PARTS PACKING CONFIGURATIONS

BOX #1:
A. TABLE TOP 1PC



BOX #2:
B. LEG 2PCS

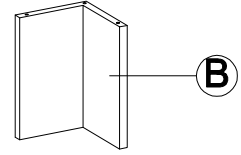

HARDWARE KIT PACKED IN BOX #2

NO.	DESCRIPTION	IMAGE	Q'TY
1	THREADED BOLT SLEEVE (17x50mm)		6 PCS
2	ALL-THREADED BOLT(1/4"x20mm)		6 PCS
3	PLASTIC WASHER (30mm)		6 PCS

FULLY ASSEMBLED

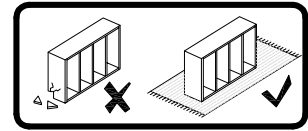
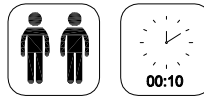
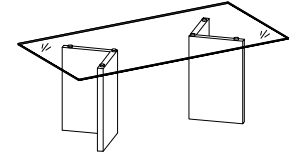

Step 1:

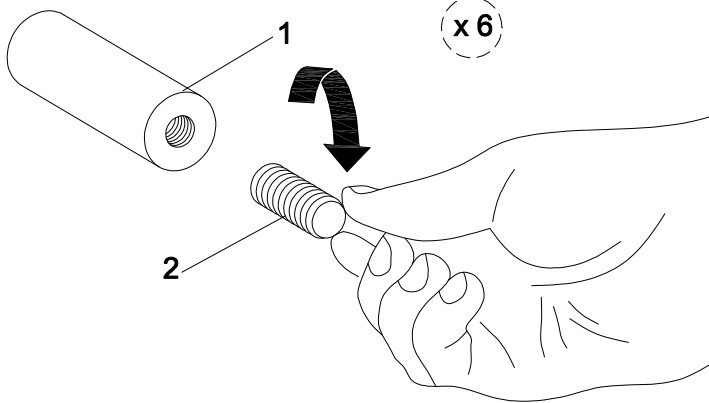
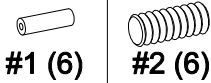

Step 2:

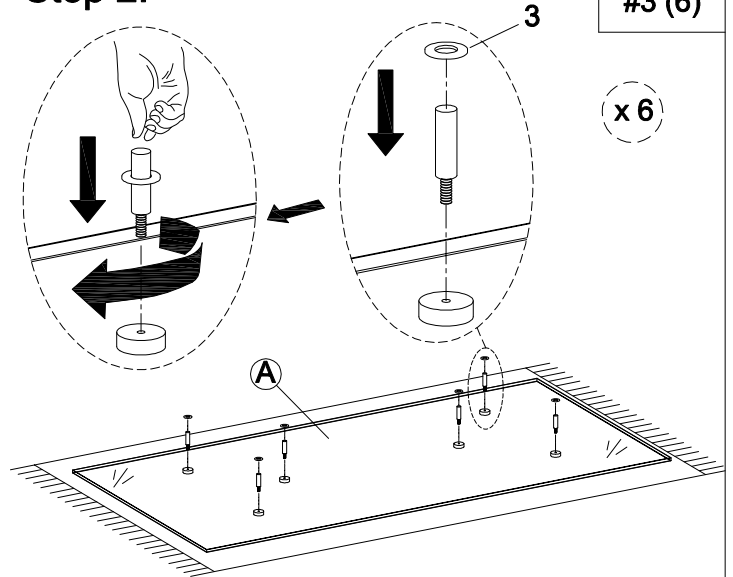

Step 3:

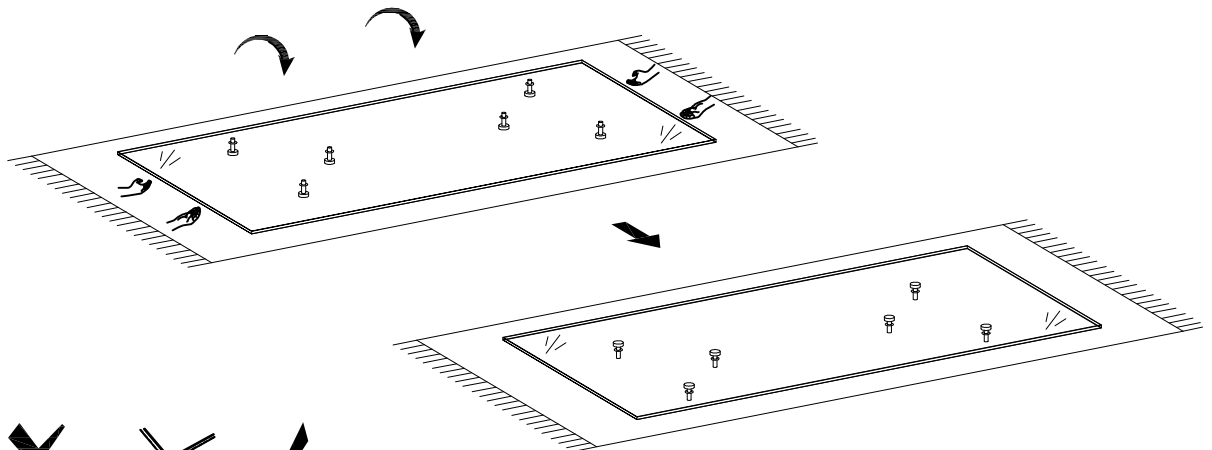

ONE COLL. DINING TABLE ASSEMBLY INSTRUCTIONS



Step 4:

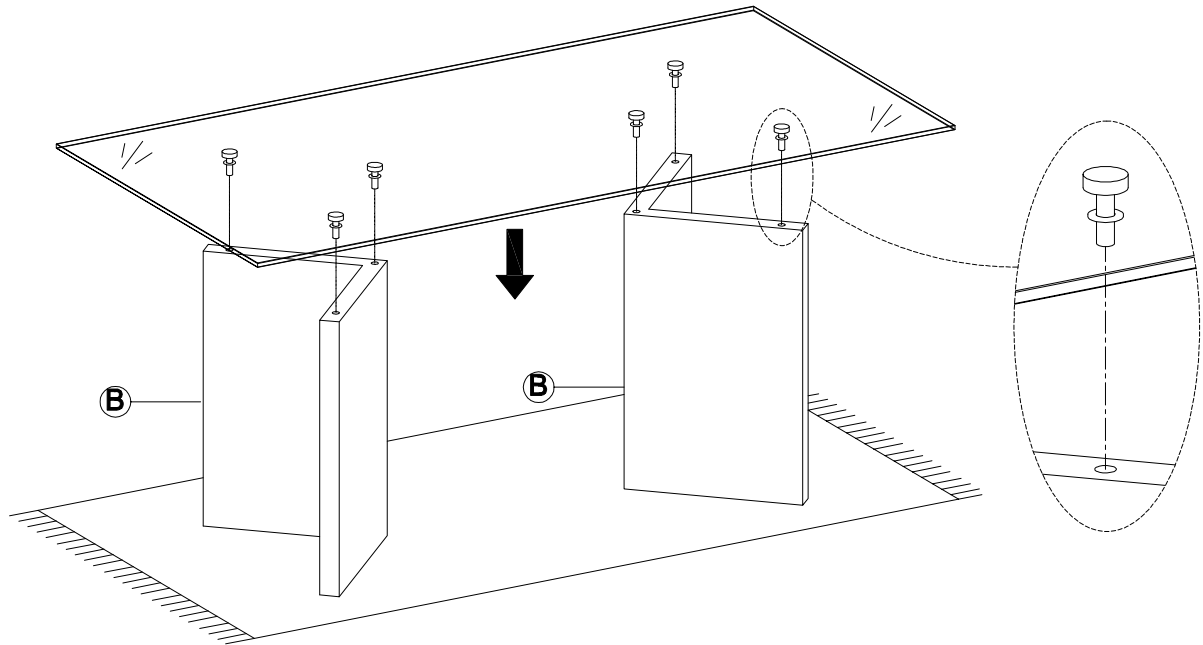

ASSEMBLY COMPLETE

