

SIDES	BOTTOM
1 PCS #1/4"-20 Hex Nut Installed	
Material:Steel-0.0625"-Galvanized Steel	

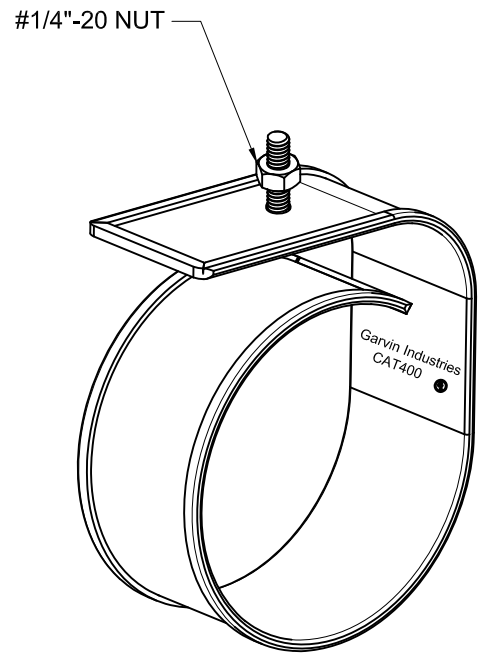
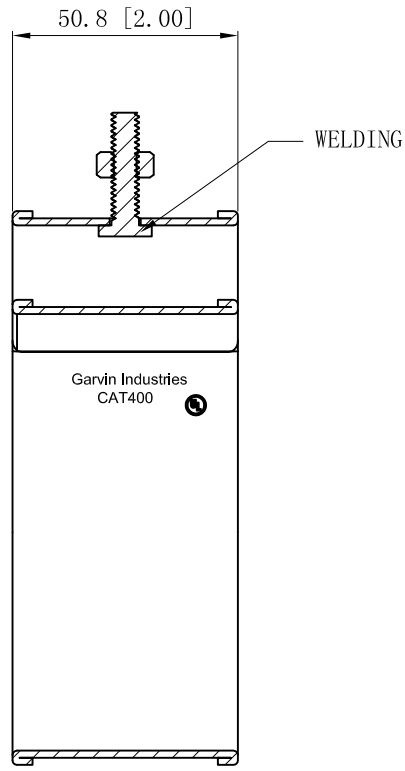
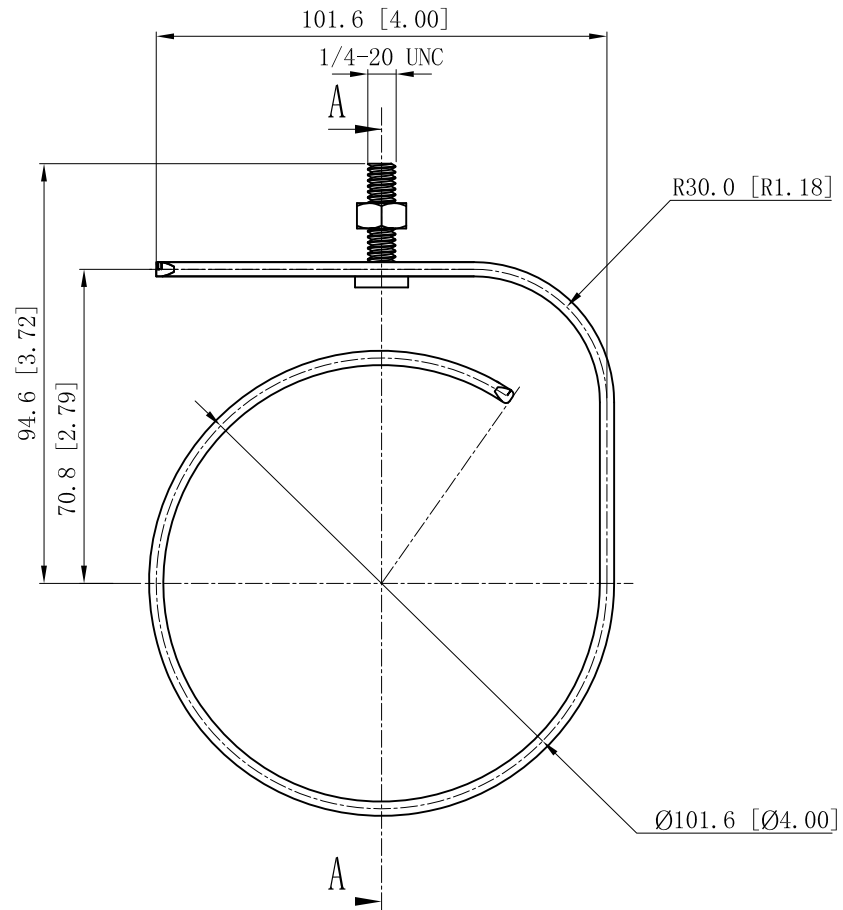

CUTAWAY VIEW A-A

This data sheet is for reference only .GARVIN INDUSTRIES reserves the right to make changes to the design without prior notice.

DESCRIPTION
TRADE REFERENCE TERMS

STANDARD PACKING	GARVIN INDUSTRIES		
25 pcs			
	TITLE	CAT WIRE RINGS	
	SIZE	DWG NO.	REV
	A4	CAT400	D
	DATA SHEET		
	www.garvinindustries.com		