

**PRODUCT SPECIFICATIONS**

Drain Fitting 5-1/2" Stainless Steel Dome / Flat Grid Strainer. Overall dimensions are 5-5/16" x 5-5/16" x 3-1/4". Made of Chrome-plated Brass.

<b>Material:</b>	Chrome-plated Brass
<b>Finish:</b>	Chrome (CR)
<b>Dimensions:</b>	5-5/16" x 5-5/16" x 3-1/4"
<b>Shipping Weight:</b>	2 lbs.

- Chrome-plated, brass-body drain outlet fitting for 4-15/16" (125mm) opening.
- Field adjustable stainless steel, flat-grid strainer or dome strainer with 5-5/16" (135mm) O.D. top diameter.
- 3-5/8" (92mm) I.D. x 4" (102mm) O.D. tailpiece.
- Designed to attach to 3" (76mm) I.P.S. pipe utilizing caulk or epoxy.



A Century of Tradition and Quality.  
For more than 100 years, Elkay has been making innovative products and providing exceptional customer care. We take pride in offering plumbing products that make life easier, inspire change and leave the world a better place.



**Product Compliance:** ASME A112.18.2/CSA B125.2

[Clean and Care Manual \(PDF\)](#)  
[Warranty \(PDF\)](#)

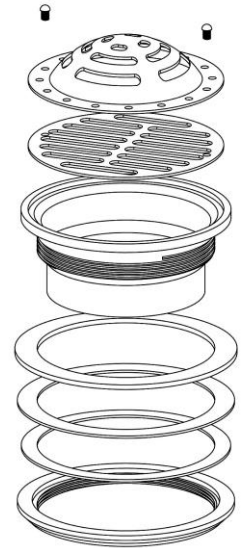
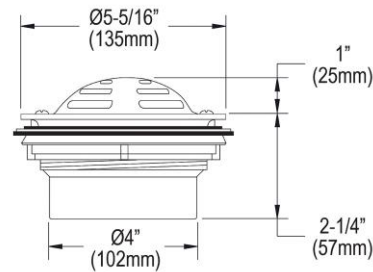

PART: \_\_\_\_\_ QTY: \_\_\_\_\_  
 PROJECT: \_\_\_\_\_  
 CONTACT: \_\_\_\_\_  
 DATE: \_\_\_\_\_  
 NOTES: \_\_\_\_\_  
 APPROVAL: \_\_\_\_\_

*In keeping with our policy of continuing product improvement, Elkay reserves the right to change product specifications without notice. Please visit [elkay.com](http://elkay.com) for the most current version of Elkay product specification sheets. This specification describes an Elkay product with design, quality, and functional benefits to the user. When making a comparison of other producers' offerings, be certain these features are not overlooked.*