

CARE AND MAINTENANCE

- Periodically clean the fixture and diffuser using a mild, non-abrasive cleaner and soft cloth. When cleaning the fixture, make sure the power is turned off. Do not spray cleaner directly onto any part of the fixture or LEDs.

TROUBLESHOOTING

PROBLEM	POSSIBLE CAUSE	CORRECTIVE ACTION
Security light cycles ON and OFF continuously	1. Dusk-to-Dawn sensor is sensing reflected light from the security light.	<ol style="list-style-type: none"> Change the position of the light head, aim light away from the reflecting surfaces. Put a small piece of black electrical tape over the Dusk-to-Dawn sensor. Relocate the security light to a different location where it no longer causes reflected light.

CAUTION

WARNING: Risk of fire. Use only on 120 volt 60Hz circuits. Suitable for wet locations. Do not use with dimmers. Before installing your lighting fixture, thoroughly review enclosed installation manual. If you do not have sufficient electrical wiring experience, please refer to a do-it-yourself wiring handbook or have your fixture installed by a qualified licensed electrician. All electrical connections must be in accordance with Local and National Electrical Code (NEC) Standards. Reliable operating temperature is 0°F –120°F. For more information visit www.feit.com or call our toll free number 1-866-326-BULB.

LIMITED WARRANTY

This product is warranted to be free from defects in workmanship and materials for up to one year from date of purchase. If the product fails within the warranty period, please contact Feit Electric at info@feit.com, visit feit.com/contact-us or call 1-866-326-BULB (2852) for instructions on replacement or refund. REPLACEMENT OR REFUND IS YOUR SOLE REMEDY. EXCEPT TO THE EXTENT PROHIBITED BY APPLICABLE LAW, ANY IMPLIED WARRANTIES ARE LIMITED IN DURATION TO THE DURATION OF THIS WARRANTY. LIABILITY FOR INCIDENTAL OR CONSEQUENTIAL DAMAGES IS HEREBY EXPRESSLY EXCLUDED. Some states and provinces do not allow the exclusion of incidental or consequential damages, so the above limitation or exclusion may not apply to you. This warranty gives you specific legal rights, and you may also have other rights which vary from state to state or province to province.

FCC STATEMENT

This device complies with part 15 of the FCC Rules. Operation is subject to the following two conditions:

(1) This device may not cause harmful interference, and (2) this device must accept any interference received, including interference that may cause undesired operation.

Note: This equipment has been tested and found to comply with the limits for a Class B digital device, pursuant to part 15 of the FCC Rules. These limits are designed to provide reasonable protection against harmful interference in a residential installation. This equipment generates, uses and can radiate radio frequency energy and, if not installed and used in accordance with the instructions, may cause harmful interference to radio communications. However, there is no guarantee that interference will not occur in a particular installation. If this equipment does cause harmful interference to radio or television reception, which can be determined by turning the equipment off and on, the user is encouraged to try to correct the interference by one or more of the following measures: Reorient or relocate the receiving antenna. Increase the separation between the equipment and receiver. Connect the equipment into an outlet on a circuit different from that to which the receiver is connected. Consult the dealer or an experienced radio/TV technician for help. Any changes or modifications not expressly approved by the manufacture could void the user's authority to operate the equipment.

MODEL S10DFL/3WY/DD/SS

WITH QUICK CONNECT



LED Dual Head Flood Light Instructions

READ BEFORE INSTALLATION

SAVE THESE INSTRUCTIONS



WARNING: This product may present a possible shock or fire hazard if improperly installed or attached in any way. Product should be installed in accordance with the owners manual, current electrical codes and/or the current National Electric Code (NEC).

RISK OF ELECTRIC SHOCK: TURN OFF THE MAIN POWER AT THE CIRCUIT BREAKER BEFORE INSTALLING.

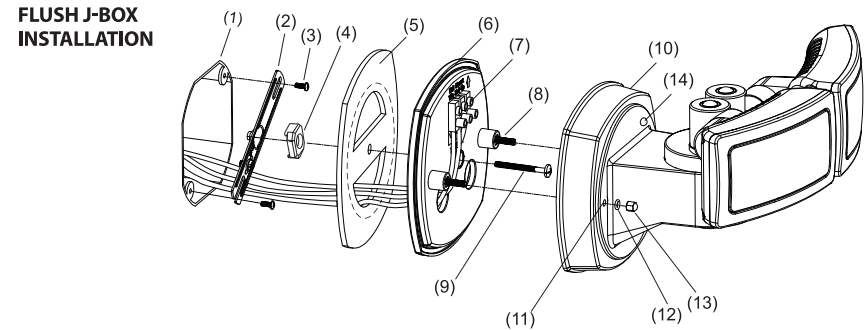
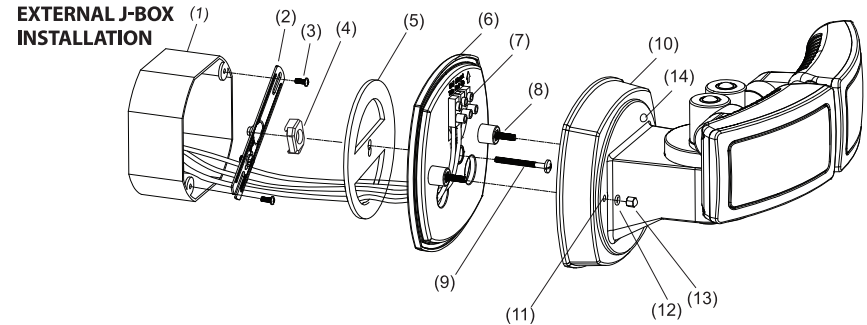

- | | | | |
|-------------------------|--------------------------|------------------------|-------------------------|
| 1. J-box (not included) | 5. Mounting gasket | 9. Mounting bar screw | 13. Decorative nuts |
| 2. Mounting bar | 6. Mounting plate | 10. Fixture body | 14. Dusk To Dawn Sensor |
| 3. J-box screws | 7. Terminal block | 11. Mounting holes | |
| 4. Spacers | 8. Mounting plate screws | 12. Decorative washers | |

HARDWARE THAT IS PRE-INSTALLED

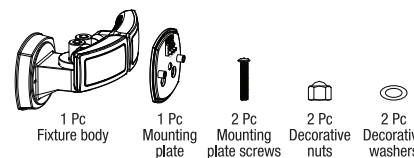

PARTS IN THE BAG

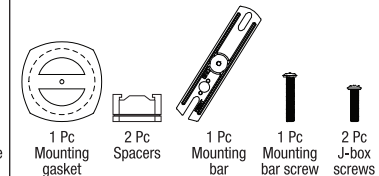

TOOLS REQUIRED (NOT INCLUDED)

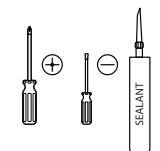

PRE-INSTALLATION (FOR ALL INSTALLATION METHODS)

Turn the power OFF at the switch box and fusebox or the circuit breaker.
Remove the existing light fixture and disconnect house power supply wires.

EXTERNAL J-BOX INSTALLATION

1. Install the mounting bar (2) to an external j-box (1) using j-box screws (3). If there is a gap between the mounting bar and the mounting plate, add one of the spacers (4) provided to eliminate the gap.

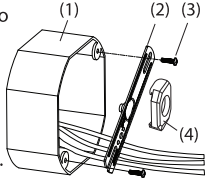

2. Extend and feed the j-box wires through the openings on the mounting gasket (5) and the mounting plate (6).

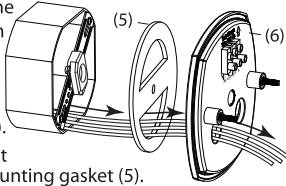

NOTE: Tear away at perforation on mounting gasket (5).

3. Secure the mounting gasket (5) and the mounting plate (6) to the mounting bar (2) using the mounting bar screw (9). Do not over tighten.

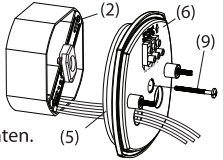

4. Connect the power supply wires directly to the terminal block (7). Secure the wires to the terminal block by using a small screwdriver.

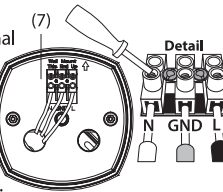

CONNECT:
Black wire to "L" input.
Ground wire to "GND" input.
White wire to "N" input.

5. Position and align the mounting holes (11) on the fixture body (10) to the mounting plate screws (8). Secure the fixture body to the mounting plate using decorative washers (12) and decorative nuts (13).

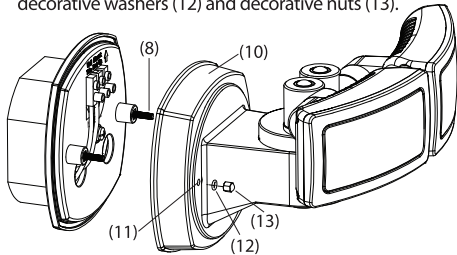

7. Once the fixture is tightly secured to the j-box, apply a silicone sealant around the base of the fixture to prevent moisture from reaching the connections.

FLUSH J-BOX INSTALLATION

1. Install the mounting bar (2) to a J-Box (1) using j-box screws (3). If needed, add one of the spacers (4) provided to eliminate the gap between the mounting bar and the mounting plate.

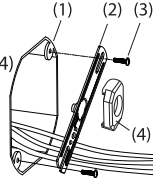

2. Extend and feed the j-box wires through the openings on the mounting gasket (5) and the mounting plate (6).

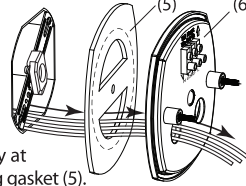

NOTE: Do not tear away at perforation on mounting gasket (5).

3. Secure the mounting gasket (5) and the mounting plate (6) to the mounting bar (2) using the mounting bar screw (9). Do not over tighten.

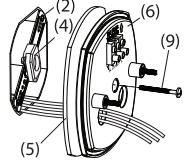

4. Connect the power supply wires directly to the terminal block (7). Secure the wires to the terminal block by using a small screwdriver.

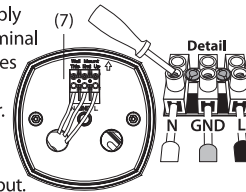

CONNECT:
Black wire to "L" input.
Ground wire to "GND" input.
White wire to "N" input.

5. Position and align the mounting holes (11) on the fixture body (10) to the mounting plate screws (8). Secure the fixture body to the mounting plate using decorative washers (12) and decorative nuts (13).

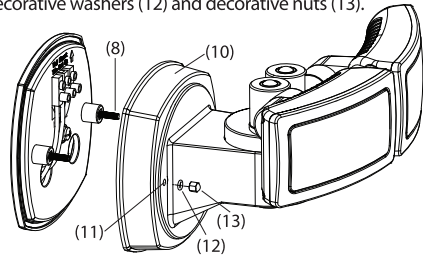

7. Once the fixture is tightly secured to the j-box, apply a silicone sealant around the base of the fixture to prevent moisture from reaching the connections.

POST-INSTALLATION (FOR BOTH INSTALLATION METHODS)

Turn the power ON at the switch box and fusebox or the circuit breaker and check for proper operation.

COLOR CHANGE SETTINGS

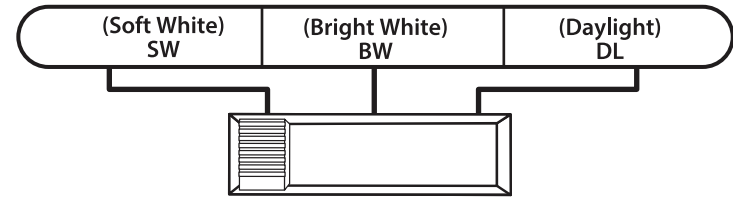

1. You can lock in one color temperature depending on your preference (Fig K).
2. Soft White - Bright White - Daylight
3. When the slide switch is set to SW (Soft White), the color temperature fixes at 3000K.
4. When the slide switch is set to BW (Bright White), the color temperature fixes at 4000K
5. When the slide switch is set to DL (Daylight), the color temperature fixes at 5000K.

(Fig K)

